

22035
22036
22037
22038

22011
22012

22009
22010
22039
22040
22041
22042

520053
Denny
82K/14

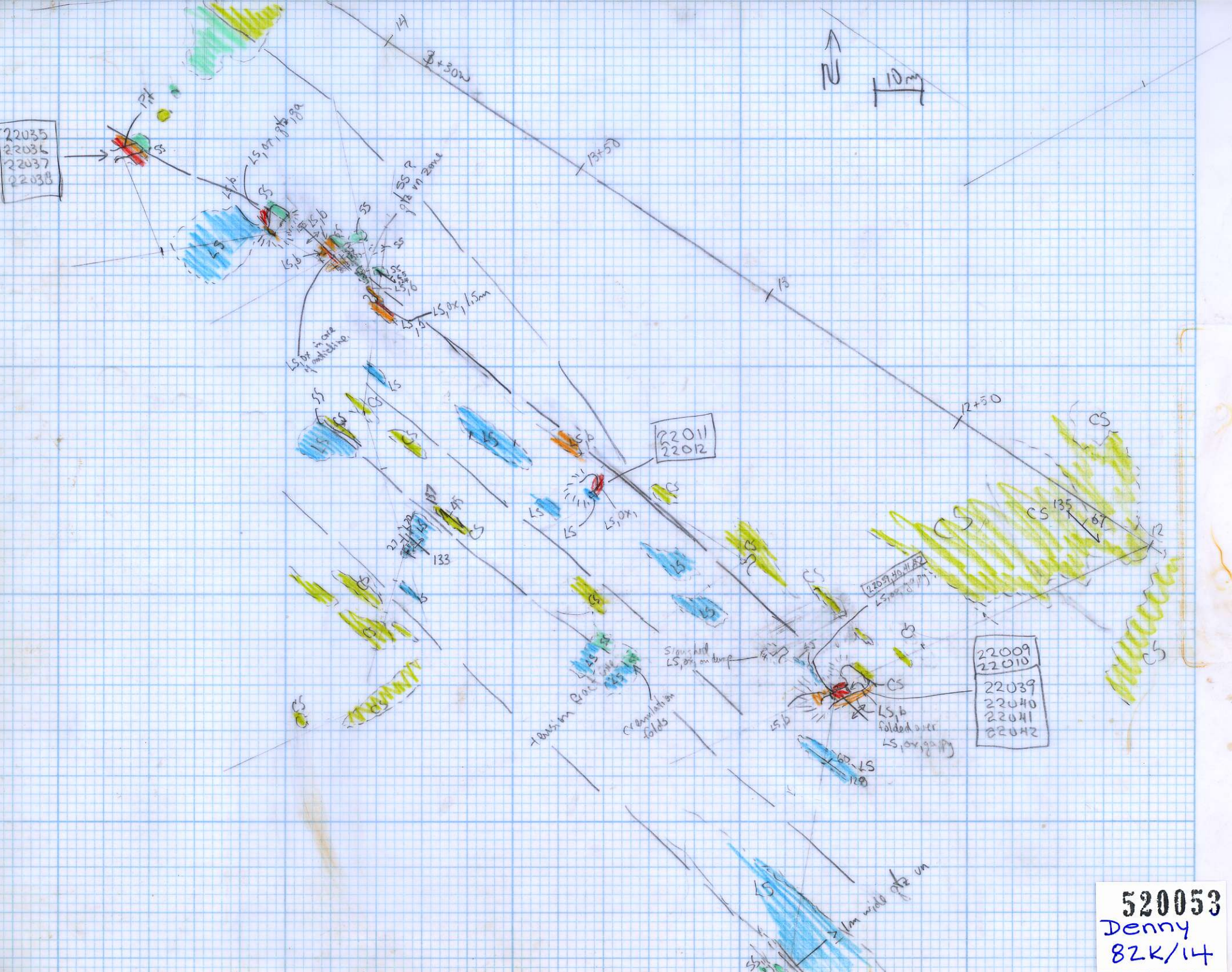

+22+70N

22050
LS04194

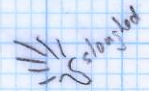

L22+00N

22043
22044
22045
22046

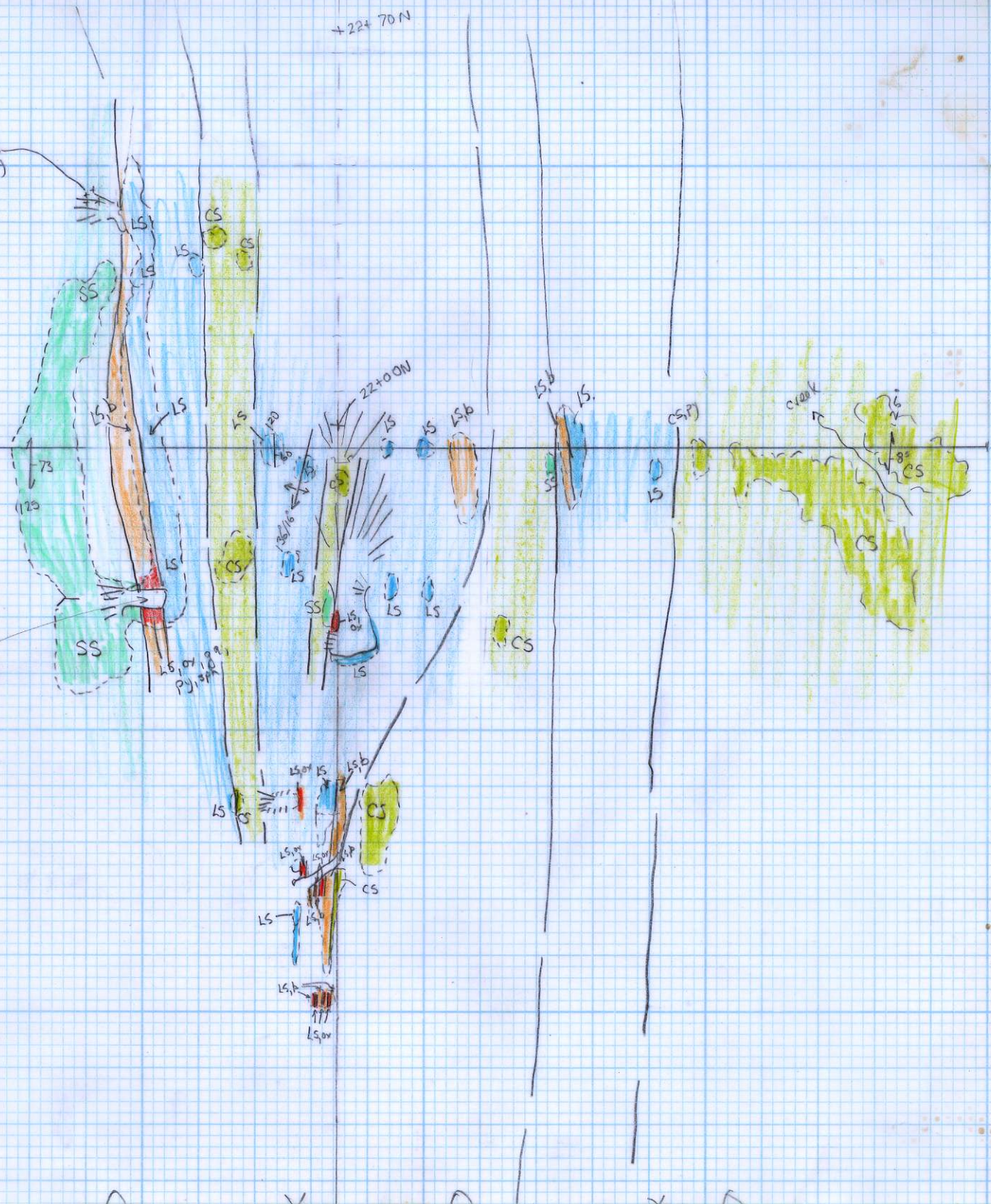

creek

LS04188
LS04189

LS04187

LS04186

LS04185

22+00N

CS17

22

22

22

22

22

22

22

22

22

22

22

22

W

24+00N

+

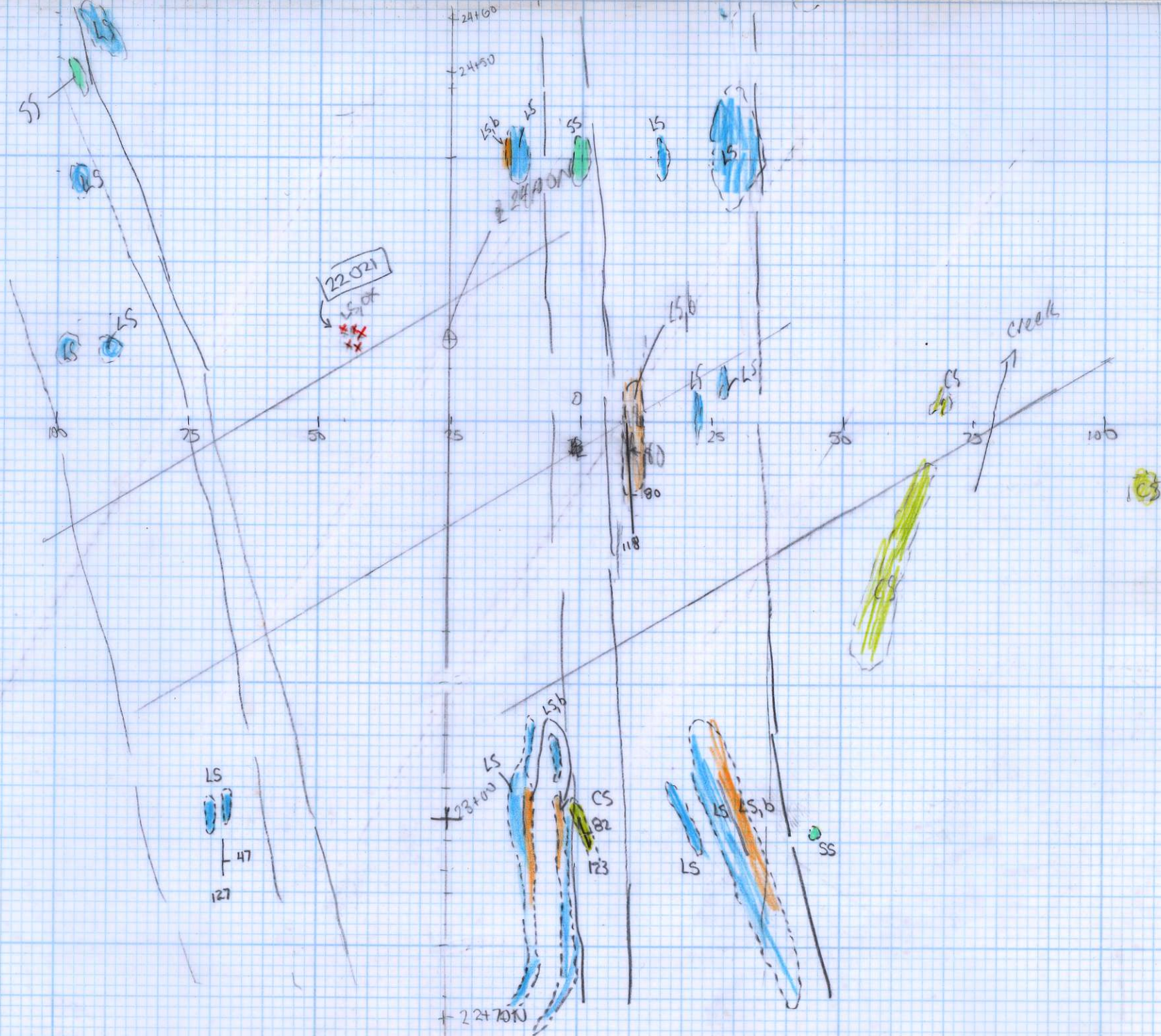

26+00 N

CS
100
LS

75

50

25

LS, b 26+70

22049

LS, b
26+50
LS

SS?

123

70

25

28

CS/Py

CS

75

100

1100

LS
110

22047
22048

SS
LS, b

LS, b

25+00

24+70

6

LS

LS, b

123

65

CS
Py

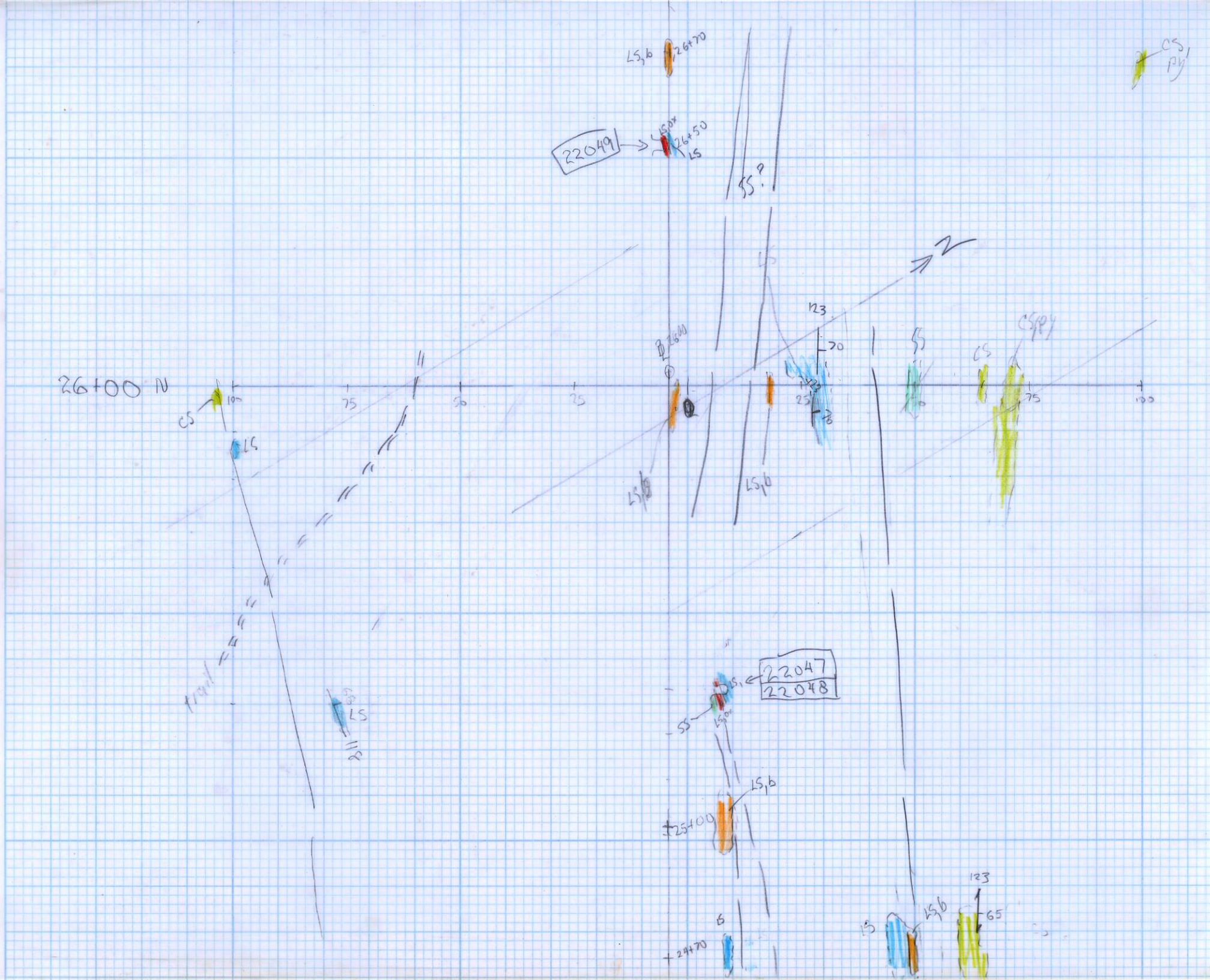

+28+80

+28+50

28+00 N

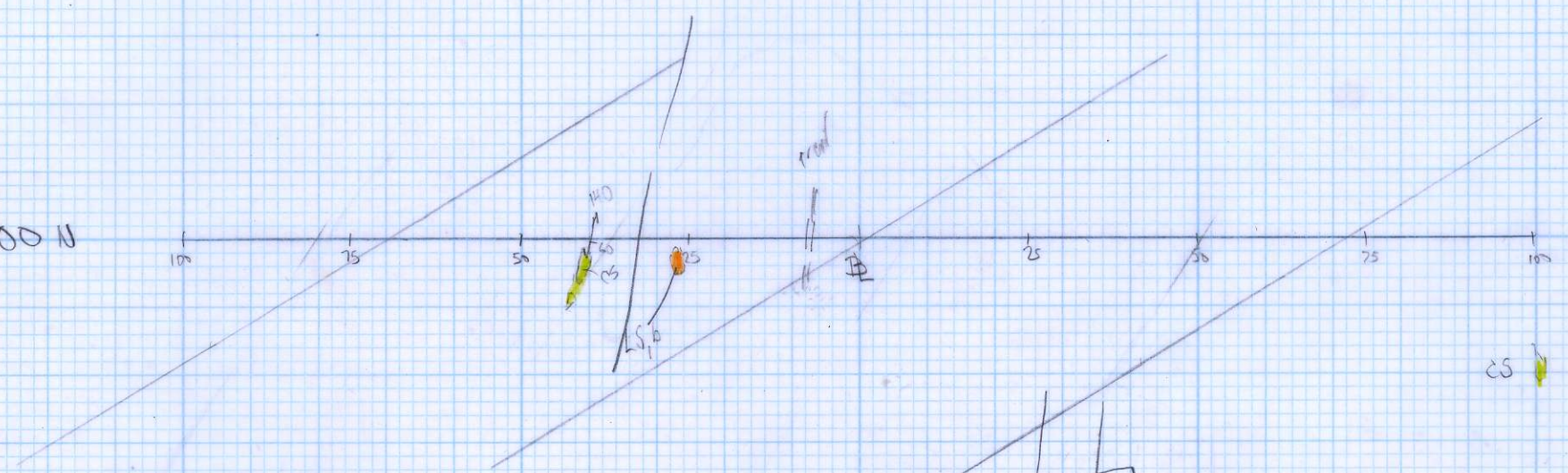

+27+50

22022

+27+00

+26+70



CS
CS
CS

CS
120

L30+00N

100W
+

50
|

BL
0
+

CS
PS
75

CS
100
+

CS
100
+

LS
P

+ 31+00

+ 31+50

30+50

NSD
T

L30N
100G
+

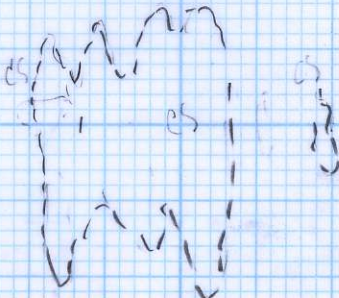

+ 29+30



CS
PS

CS
PS

CS
PS

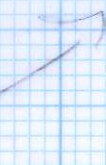

L32+00 N

W

199

LS 6

51

road = 211

LS 27

32+70

CS

50 CS

CS

31+50

CS

31+30

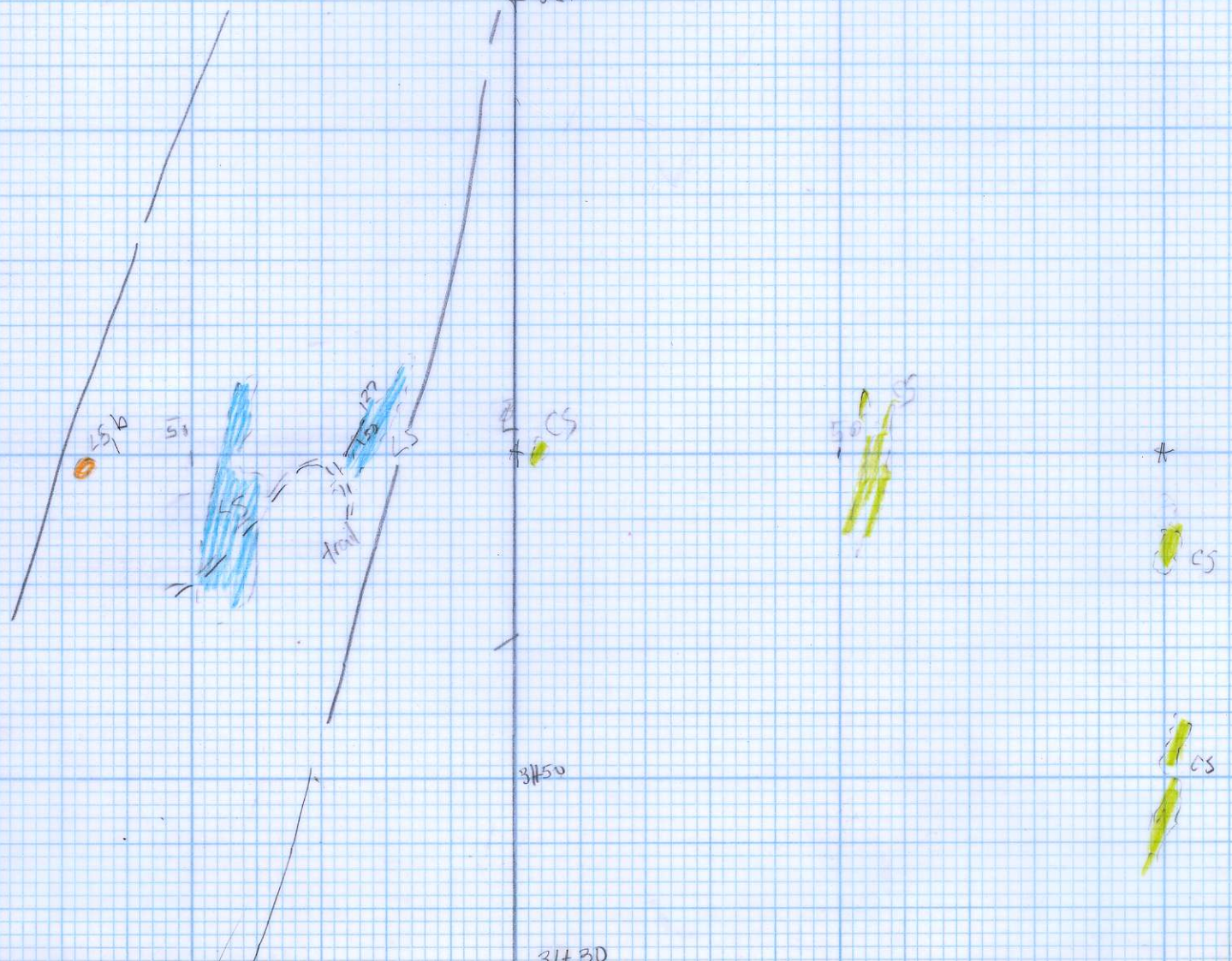

L34+00 N

110m

20m

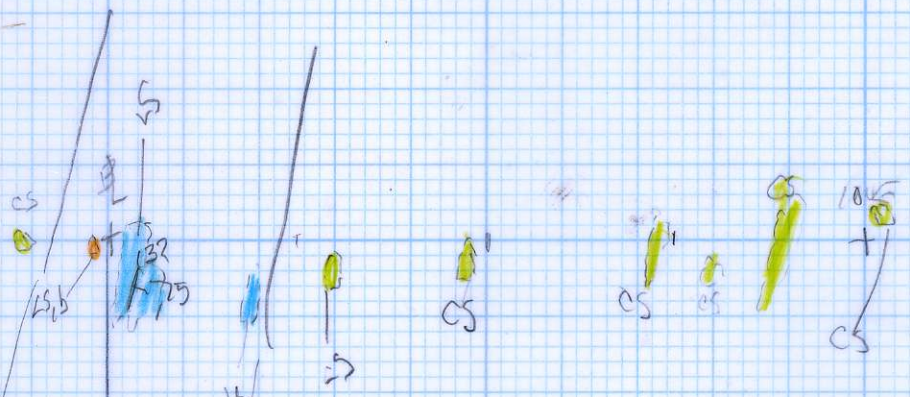

33+00

32+70

Sept 16 /
①

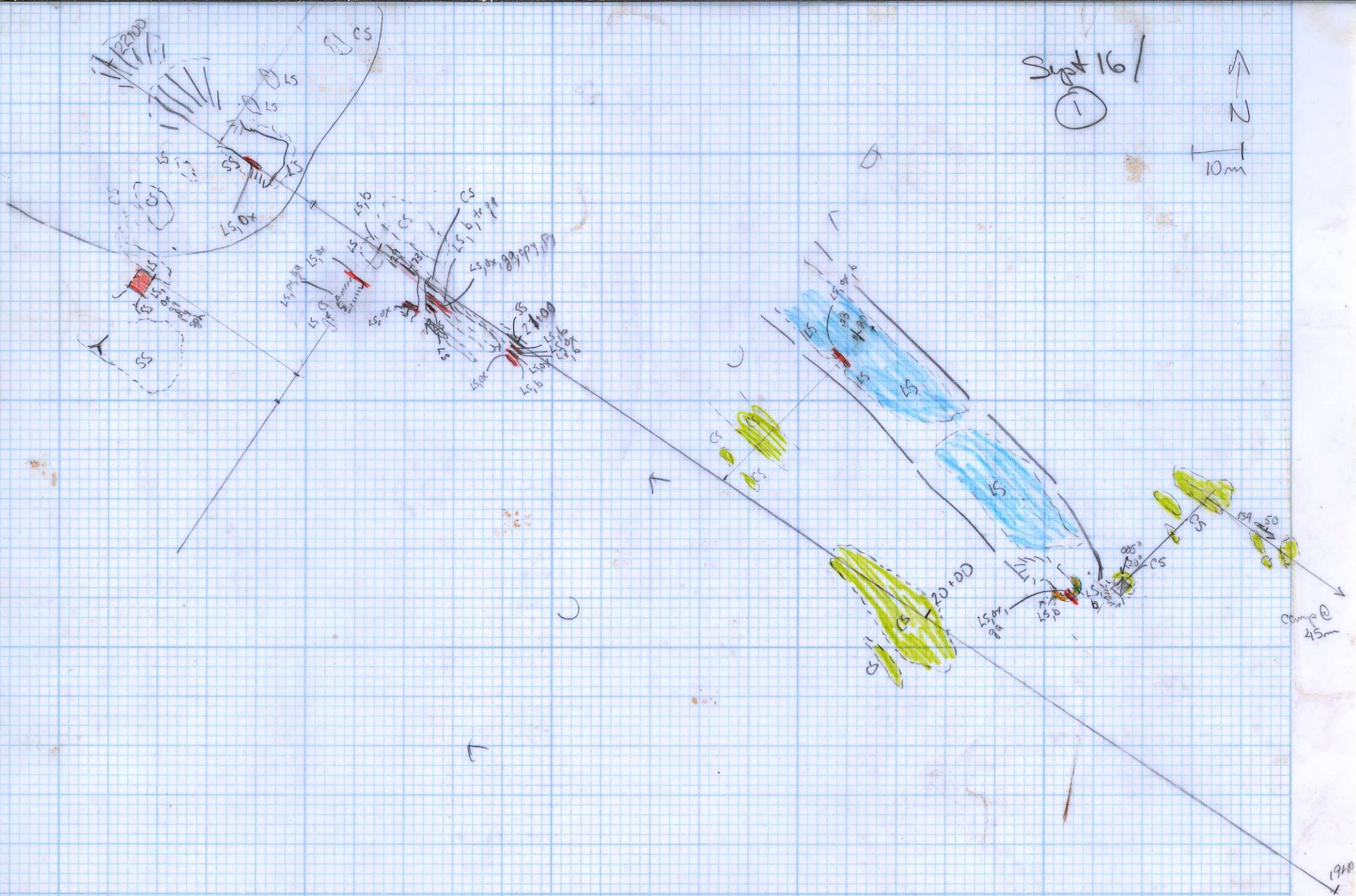
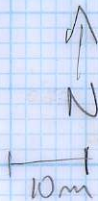

Sept 16
②

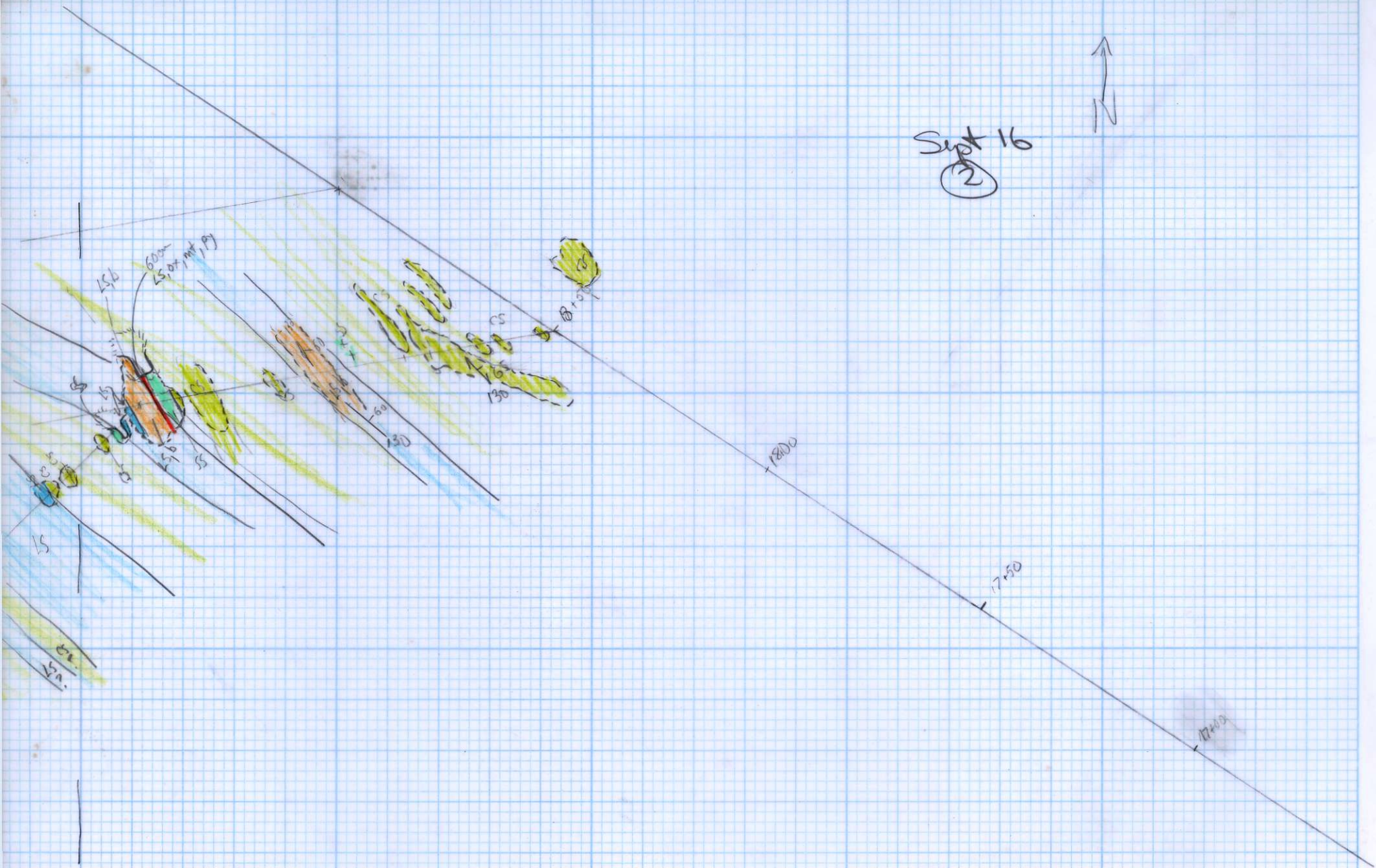

34
52

Sept 16
3

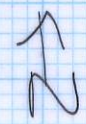

0.3m LS 8x 80 PJ
22032

22033
1.5m LS 8x 80 PJ
Highly degraded

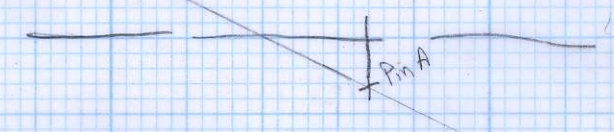
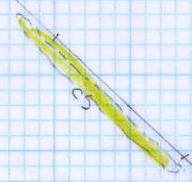
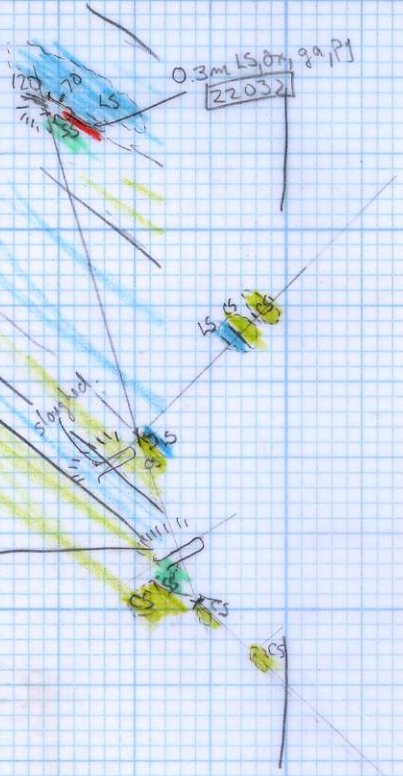

47
120



Sept 16 / (4)

Pin A

x

CS

x

stony lead
SS outcrop

SS

x

x

22034
LS, or P, or

LS, b

LS

LS, b

CS

Pin B

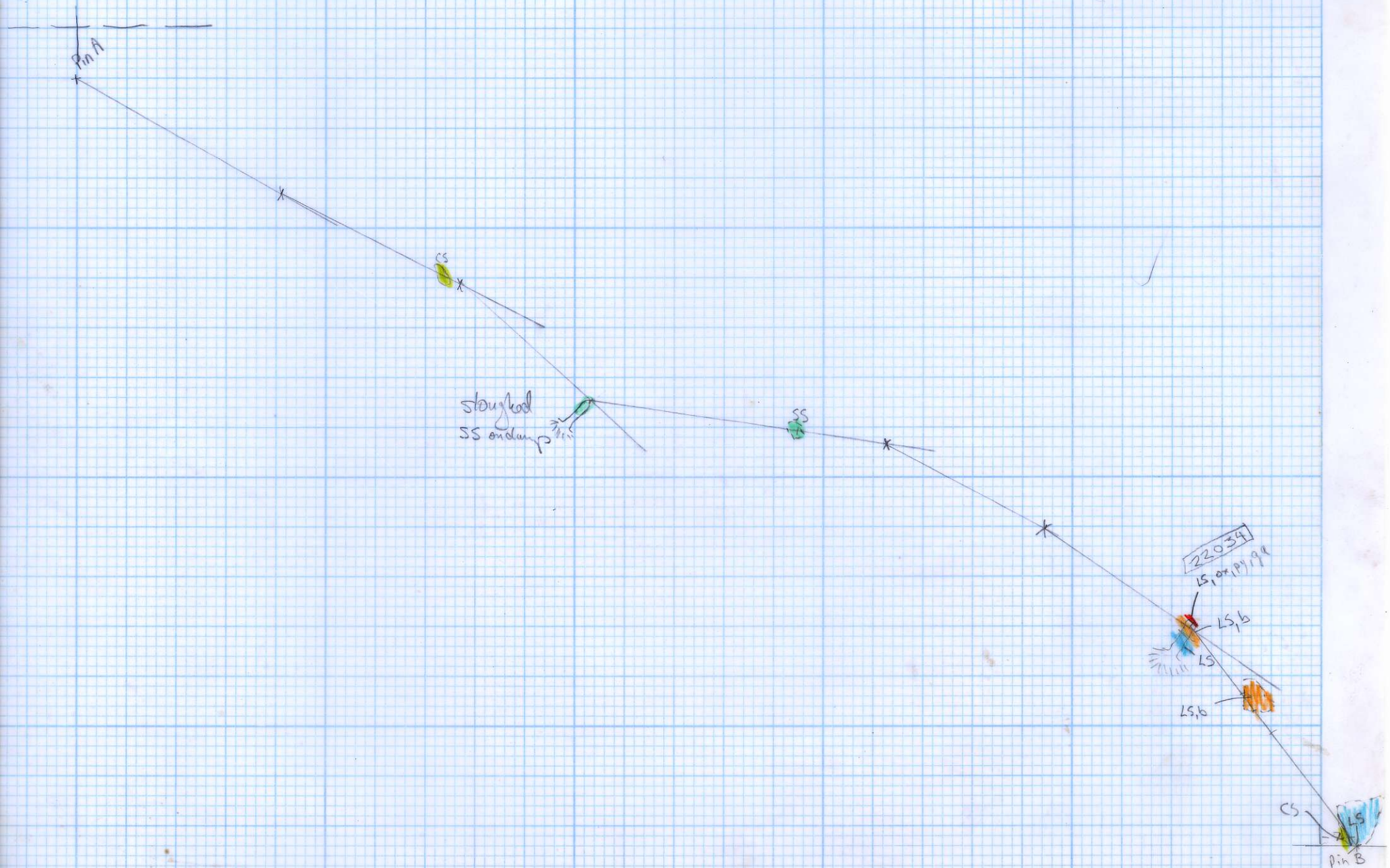

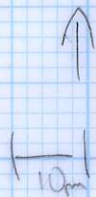
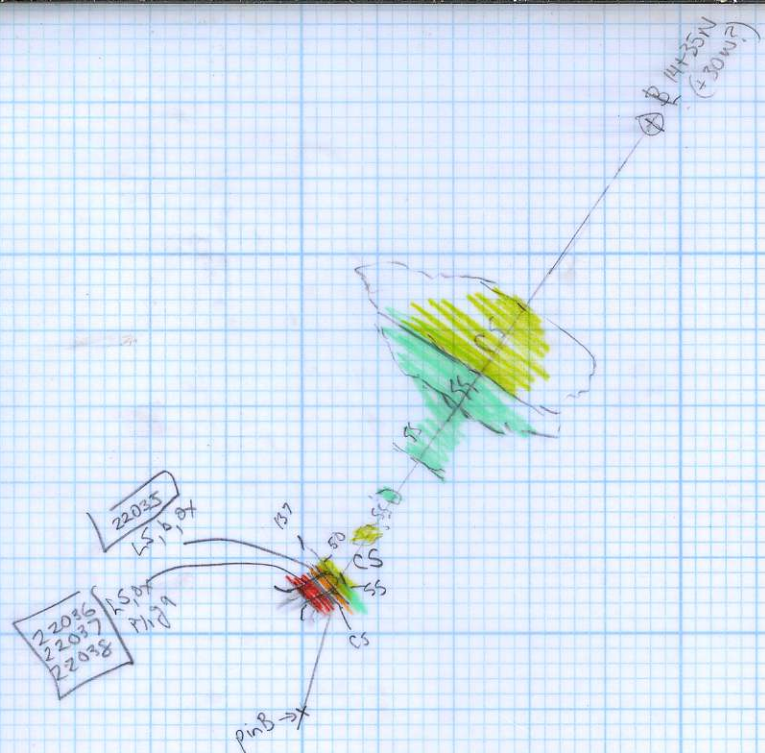

Sept 16

⑤

17+60

16+50

16

15+50
SS

15+00
30W

14+50 30W

Sept 16
⑥

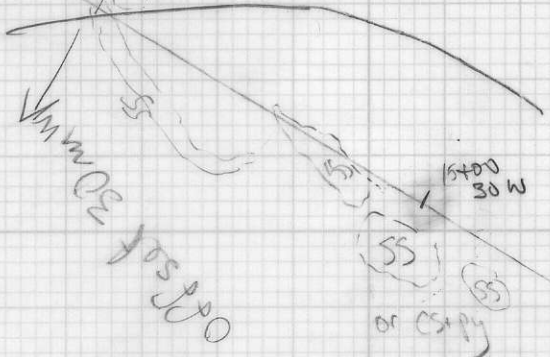
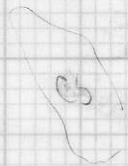
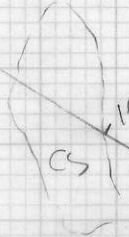

15+00
30W
of CS+PY

15+00
30W
of CS+PY

14+50 30W

22+00N

22050
LS 0.1 PJ

LS in plenty scattered



very steep
down

rotate outcrop
pattern 50°

N

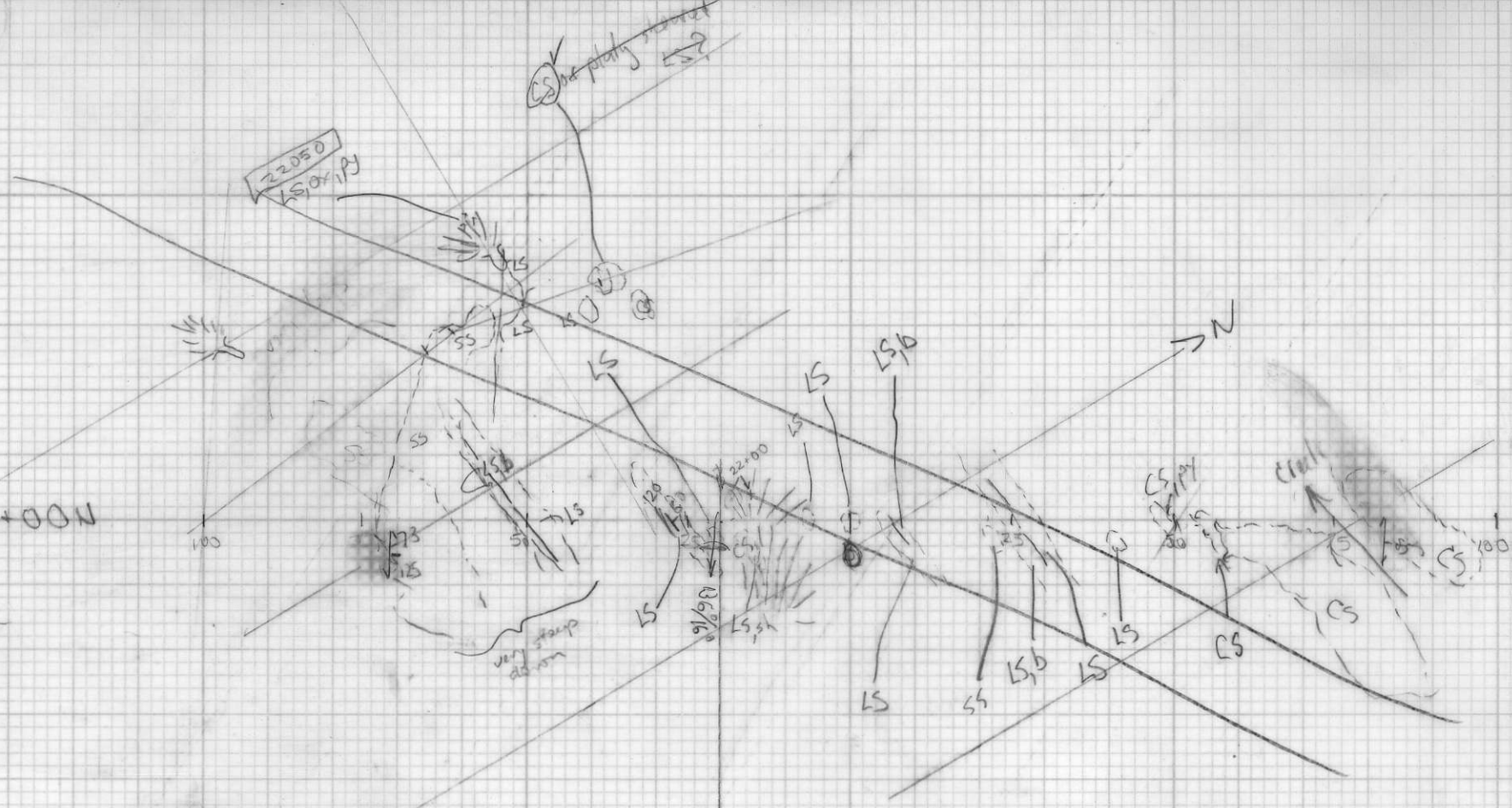

20+00N

W 100

75

50

25

250

50

75

100

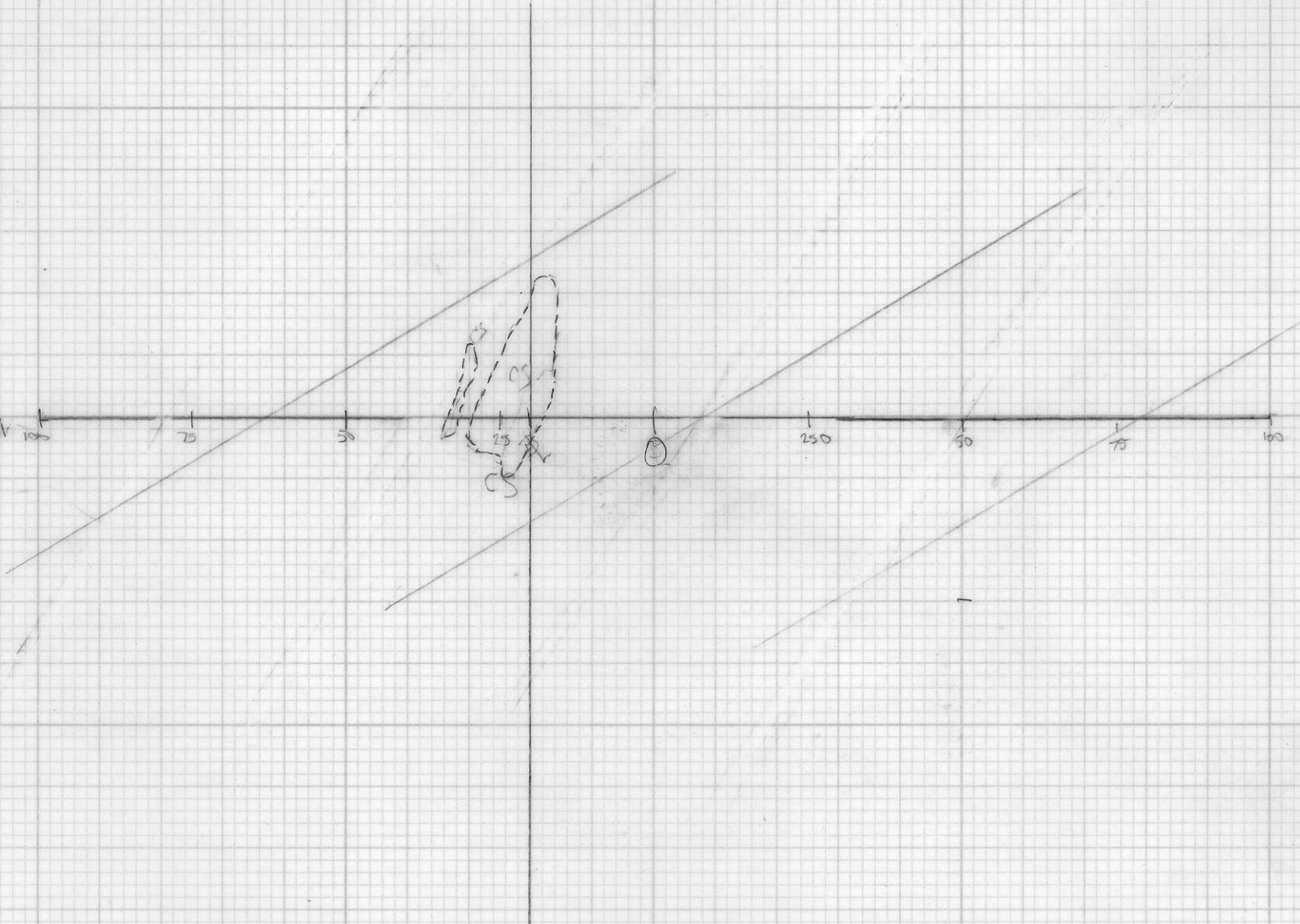

CS

L 21+00N

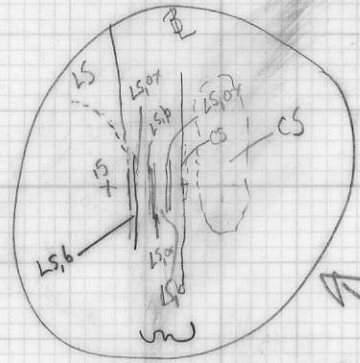

22060 to 22064

baseline plotted wrong, replotted

CS
CS
CS
150W

100W
36
67
CS

50W

LS
110
100

50S

float { LS
LS10
LS07

LS, b, ox, etc



L23+00N

150W

100W

302°

tension fracture, P

~27m to/c CS.

CS

