

Church No. 1
for GEM 1971

GEOLOGY OF THE LEXINGTON PORTAL AREA

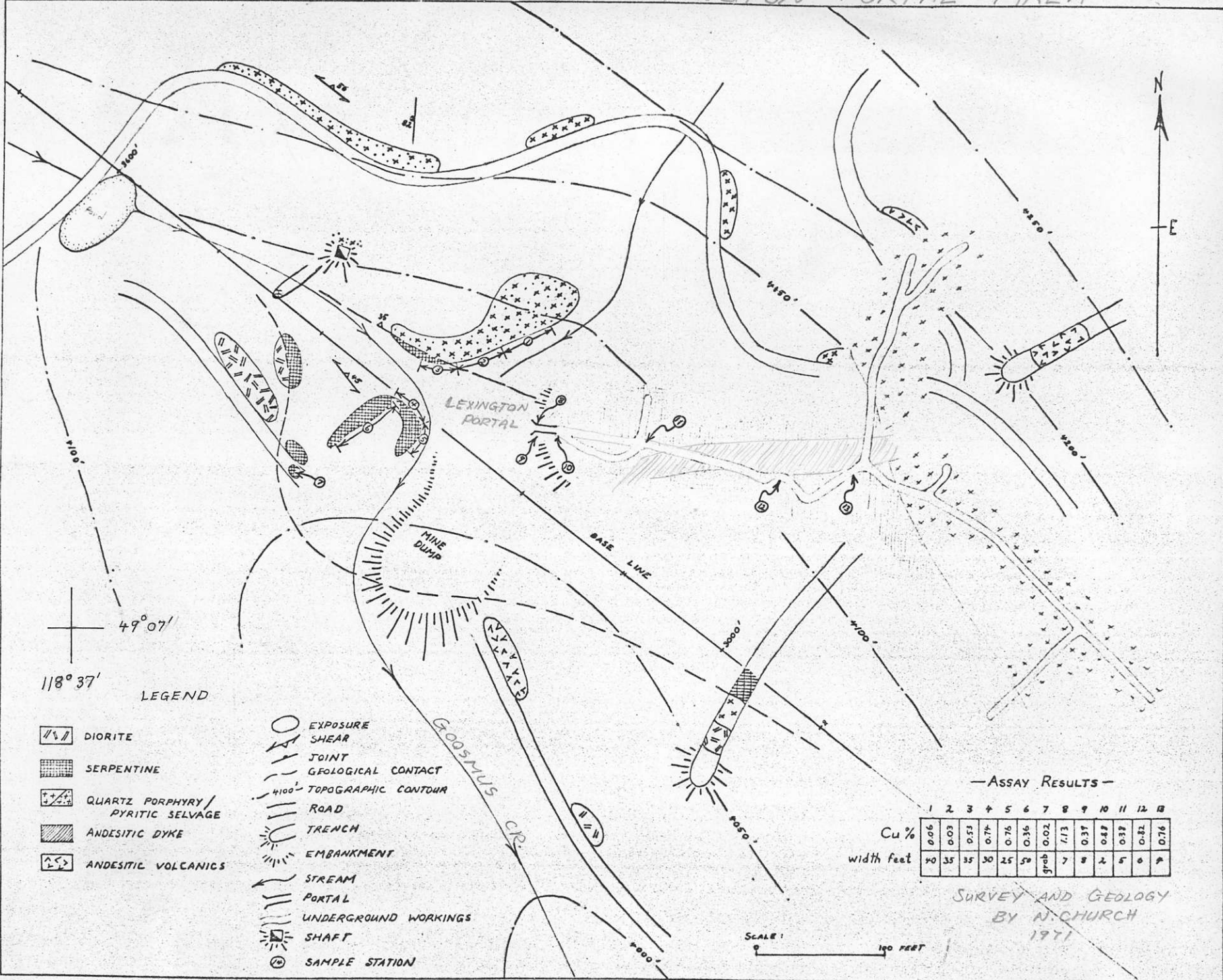

49° 07'
118° 37'

LEGEND

- DIORITE
- SERPENTINE
- QUARTZ PORPHYRY / PYRITIC SELVAGE
- ANDESITIC DYKE
- ANDESITIC VOLCANICS

- EXPOSURE
- SHEAR
- JOINT
- GEOLOGICAL CONTACT
- TOPOGRAPHIC CONTOUR
- ROAD
- TRENCH
- EMBANKMENT
- STREAM
- PORTAL
- UNDERGROUND WORKINGS
- SHAFT
- SAMPLE STATION

— ASSAY RESULTS —

	1	2	3	4	5	6	7	8	9	10	11	12	13
Cu %	0.06	0.03	0.53	0.74	0.76	0.36	0.02	1.13	0.37	0.43	0.33	0.82	0.76
width feet	40	35	35	30	25	50	grab	7	8	2	5	6	7

SCALE: 1" = 100 FEET

SURVEY AND GEOLOGY
BY N. CHURCH
1971

021774