

021268

82fsw 381

021686

ACME ANALYTICAL LABORATORIES LTD.

852 E. HASTINGS ST. VANCOUVER B.C. V6A 1R6

PHONE 253-3158

DATA LINE: 251-1011

ASSAY CERTIFICATE

1.00 GRAM SAMPLE IS DIGESTED WITH 50ML OF 3-1-2 OF HCL-HNO₃-H₂O AT 95 DEG. C FOR ONE HOUR.
AND IS DILUTED TO 100ML WITH WATER. DETECTION FOR BASE METAL IS .01%.

- SAMPLE TYPE: ROCK CHIPS AU: 10 GRAM REGULAR ASSAY

DATE RECEIVED: NOV 25 1986 DATE REPORT MAILED: Dec 5/86 ASSAYER: D. Toye... DEAN TOYE. CERTIFIED B.C. ASSAYER.

DICKENSON MINES FILE # 86-3818

PAGE 1

SAMPLE#	Mo %	Cu %	Pb %	Zn %	Ag OZ/T	Ni %	Co %	Mn %	Fe %	As %	U %	Th %	Cd %	Sb %	Bi %	Au OZ/T	
361	.002	.20	5.75	6.84	12.02	.01	.01	.20	24.57	.01	.002	.01	.070	.010	.090	.002	Shaft vein
362	.001	.93	72.01	2.28	23.39	.01	.01	.01	5.72	.33	.002	.01	.020	.050	.010	.048	Main vein

← Helena vein
100 metres S. of shaft.

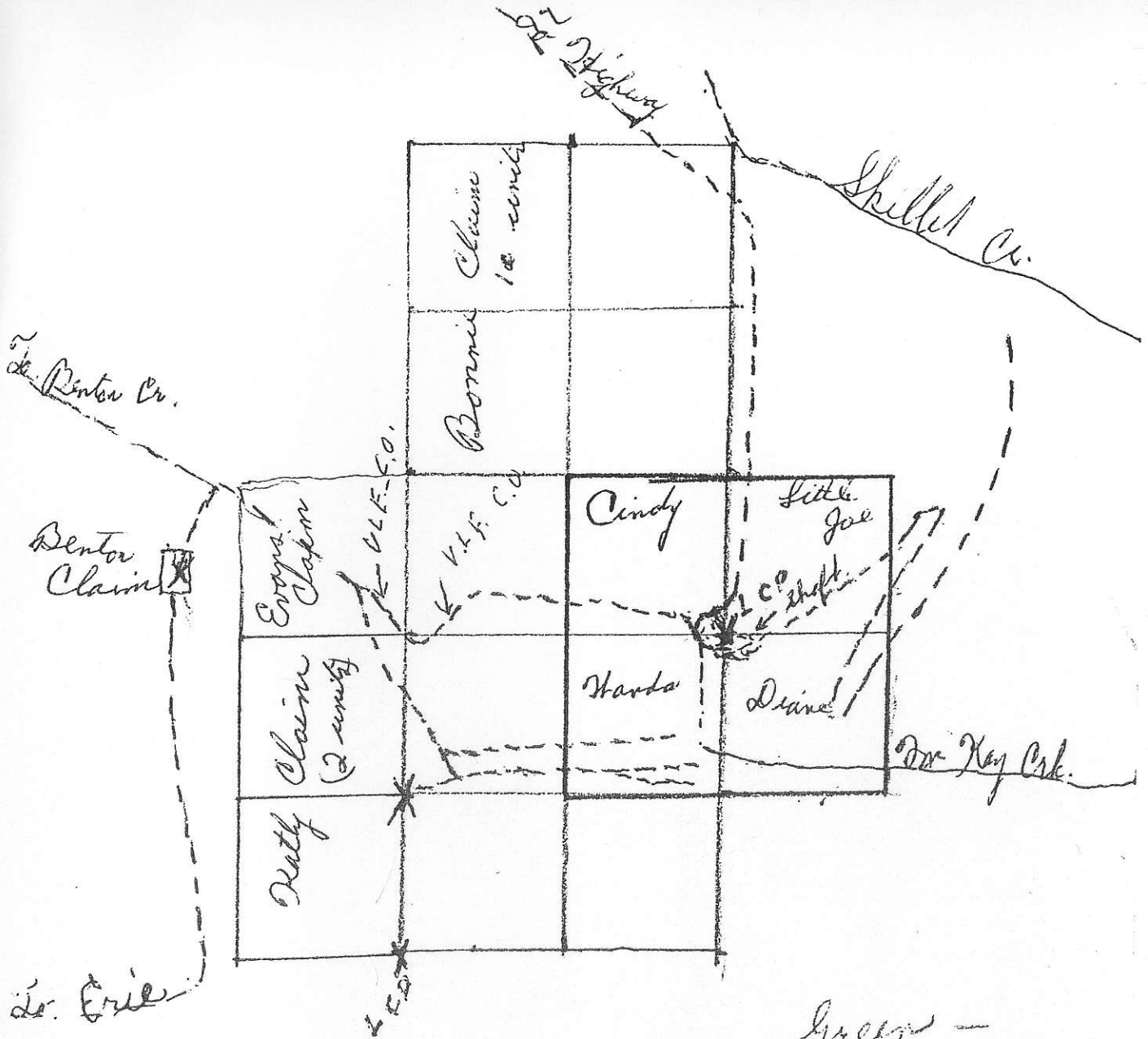

Green -
Marilyn Group.

→ N

711

S. P. Readings
Top switchback.

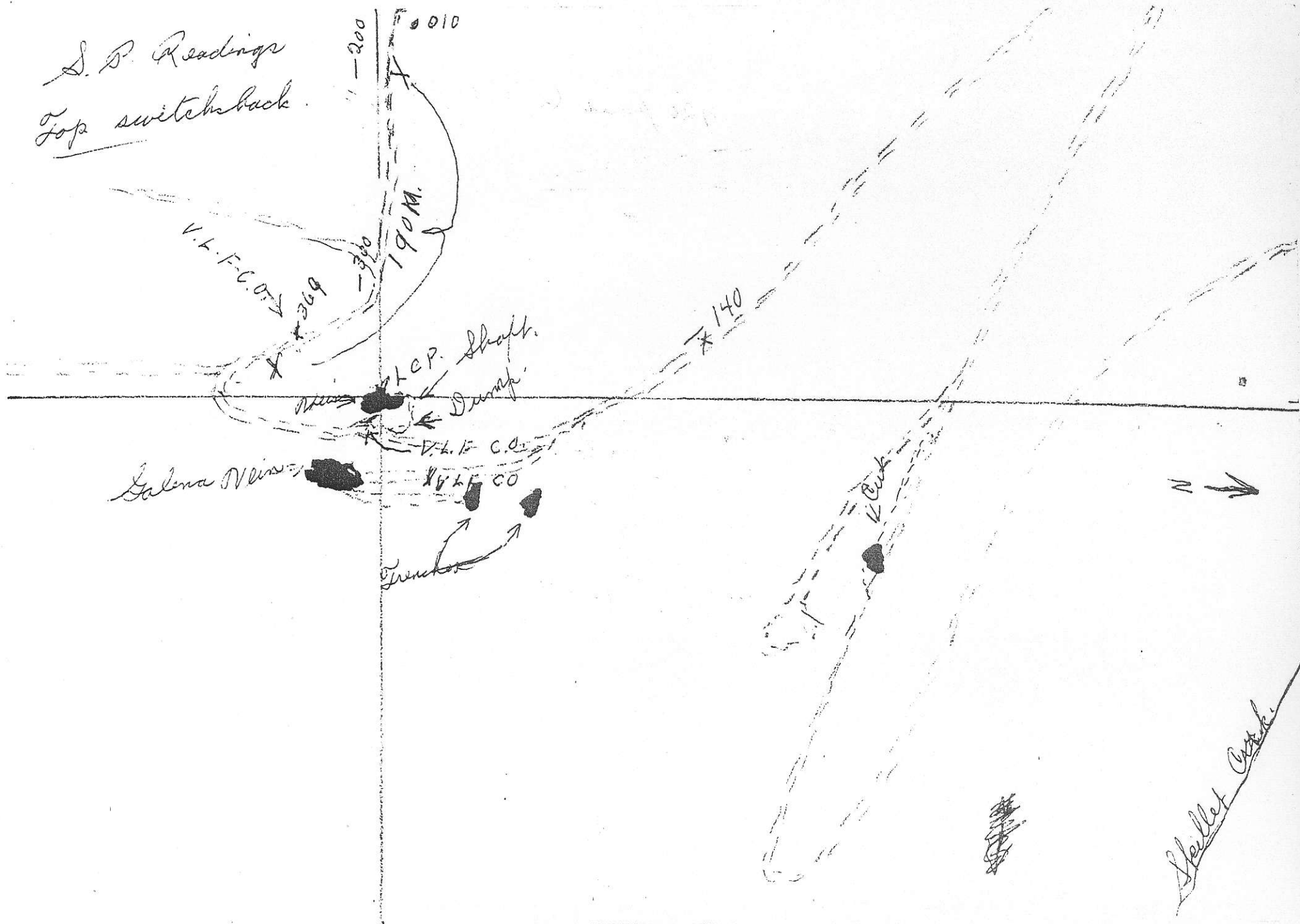

S. P. Reading -
Lower Road

420 paces @ 2 ft. per pace - 840 ft.

X - 097 to -311 (340 ft.)
170 paces

X - 311 to -496 (140 ft.)
70 paces

above - 220 70 paces

- 248 to -122

X 180 paces (360 ft.)

50 ft. above - 400

Vein as per

Comins map

X - (160 ft.) (50 ft.)

X 80 paces X 25 paces

- 563 to -320 to -489

- 236 to -144

105 paces = 210 ft.

N

↓

(Pyroclite Dike)

STIV
600

killer Creek