

Face 9-1-29

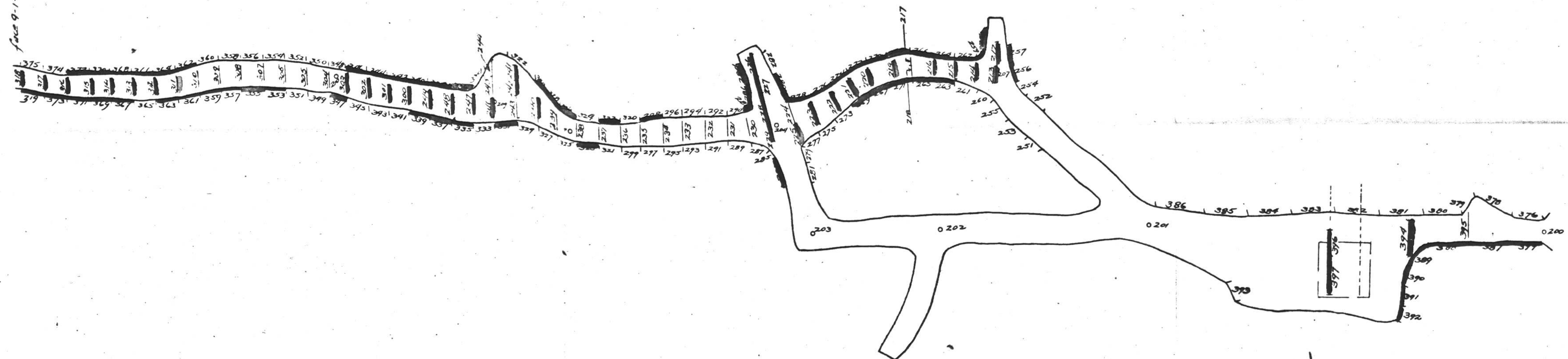

Sample No	Width	fu	fg	\$	Sample No	Width	fu	fg	\$	Sample No	Width	fu	fg	\$	Sample No	Width	fu	fg	\$
Back Samples					Back Samples					Wall Samples					Wall Samples				
W-212	52	26	147	13.65	W-317	42	62	6.5	16.15	W-319	52	21	2.3	12.72	W-374	52	22	1.2	1.22
W-213	38	10	6.8	5.27	W-318	42	40	3.3	9.20	W-320	52	26	7.4	5.45	W-375	52	21	3	1.2
W-214	42	60	30.5	29.65						W-321	52	21	0.3	3.27	W-376	85	25	8.0	5.40
W-215	45	2.22	37.5	91.72						W-322	52	21	0.3	9.28	W-377	70	25	17.2	17.52
W-216	35	22	14.8	23.66						W-323	52	21	0.3	1.78	W-378	112	25	1.8	4.46
W-217	20	18	5	6.5						W-324	52	21	2.3	1.22	W-379	52	21	1.8	1.22
W-218	50	7	4	2.3	W-251	42	7	3	1.2	W-325	52	21	6.5	5.22	W-380	102	21	1.8	1.22
W-219	48	10	8.8	6.62	W-252	52	7	1.2	1.2	W-326	52	21	4	3.2	W-381	102	21	1.8	1.22
W-220	51	2	20.3	18.30	W-253	52	7	1.2	1.2	W-327	52	21	4	3.2	W-382	102	21	1.8	1.22
W-221	42	4	18	13.62	W-254	38	7	1.2	1.2	W-328	52	21	4	3.2	W-383	102	21	1.8	1.22
W-222	52	30	27.2	22.04	W-255	52	7	1.2	1.2	W-329	52	21	4	3.2	W-384	102	21	1.8	1.22
W-223	42	18	17.1	13.24	W-256	48	10	10.2	7.47	W-330	52	21	4	3.2	W-385	102	21	1.8	1.22
W-224	52	18	9.8	8.23	W-257	38	10	48.4	57.28	W-331	52	21	4	3.2	W-386	122	21	1.8	1.22
W-225	28	0.07	6.3	4.92	W-258	42	15	32	5.20	W-332	72	21	5	3.2	W-387	102	21	1.8	1.22
W-226	35	23	6.4	8.28	W-259	30	11.3	46.16	44.16	W-333	52	21	5	3.2	W-388	112	21	1.8	1.22
W-227	35	23	9.5	11.66	W-260	42	7	36.5	2.2	W-334	52	21	1.5	2.15	W-389	52	21	1.8	1.22
W-228	81	11.7	12.0	11.70	W-261	42	10.7	1.8	2.02	W-335	52	21	0.3	1.5	W-390	52	21	1.8	1.22
W-229	28	1.27	9	5.13	W-262	52	20	9.3	7.27	W-336	52	21	2.5	4.82	W-391	52	21	1.8	1.22
W-230	42	10	9	7.2	W-263	52	20	20.1	14.36	W-337	52	21	4	4.0	W-392	35	21	2.2	8.27
W-231	42	1.9	1.27	1.27	W-264	52	2.44	59.2	7.14	W-338	52	21	7.2	7.14	W-393	62	21	3.8	2.25
W-232	42	1.2	1.22	1.22	W-265	52	19.2	16.15	16.15	W-339	52	21	7.2	21.15	W-394	52	21	16.5	24.04
W-233	40	0.1	4.5	3.2	W-266	52	22	22.2	19.25	W-340	52	21	6.1	7.2	W-395	92	21	5.8	7.2
W-234	42	0.1	5.1	2.2	W-267	52	25.2	22.2	22.2	W-341	52	21	1.2	3.2					
W-235	42	7	6	3.4	W-268	52	12	2.3	4.2	W-342	52	21	1.5	1.2					
W-236	38	18	5.6	3.22	W-269	52	12	13	13	W-343	52	21	1.8	5.7					
W-237	42	2	2.8	2.5	W-270	52	10.2	10.2	10.2	W-344	52	21	1.8	8.22					
W-238	42	1.2	1.2	1.2	W-271	52	1.08	52	55.2	W-345	52	21	2	2					
W-239	35	10.2	1.3	2.5	W-272	52	34	30.8	24.2	W-346	52	21	2.2	7.15					
W-240	42	10.2	12.2	12.2	W-273	52	7	2.2	2.2	W-347	42	21	2.2	6.2					
W-241	30	11	8.5	7.2	W-274	52	25	24.2	17.2	W-348	42	21	1.2	3.2					
W-242	35	11.2	9.2	9.2	W-275	52	25	25	17.2	W-349	52	21	1.2	3.2					
W-243	41	15	4.1	5.36	W-276	52	25	15.2	13.8	W-350	52	21	2	3.2					
W-244	38	7	5	3.9	W-277	42	7	7	11	W-351	52	21	2	3.2					
W-245	42	7	7	7	W-278	42	7	7	11	W-352	52	21	2	3.2					
W-246	45	2	4.2	6.28	W-279	42	7	7	11	W-353	52	21	2	3.2					
W-247	32	22	8.2	10.2	W-280	52	15	17.2	13.2	W-354	52	21	2	3.2					
W-248	45	17.2	13.2	17.2	W-281	52	15	15	13.2	W-355	52	21	2	3.2					
W-249	52	10.2	10.2	12.2	W-282	52	15	7.2	6.2	W-356	52	21	2	3.2					
W-250	42	6.2	6.2	11.2	W-283	52	15	2.2	6.2	W-357	52	21	2	3.2					
W-251	42	8.2	8.2	12.2	W-284	52	15	6.2	6.2	W-358	52	21	2	3.2					
W-252	42	13.2	13.2	13.2	W-285	52	2	2	1.2	W-359	52	21	2	3.2					
W-253	52	2	9.2	9.2	W-286	62	7	16.1	13.2	W-360	52	21	2	3.2					
W-254	42	2	2	2	W-287	42	7	7	11	W-361	52	21	11.2	14.2					
W-255	35	7	11	11	W-288	32	10.2	13.2	9.4	W-362	52	21	7.2	9.2					
W-256	42	2	2	2	W-289	52	7	7	11	W-363	52	21	7.2	7.2					
W-257	42	1.2	1.2	1.2	W-290	52	7	7	11	W-364	52	21	8.2	8.2					
W-258	42	2.2	2.2	2.2	W-291	52	7	7	11	W-365	52	21	1.2	2.2					
W-259	42	2.2	2.2	2.2	W-292	52	7	7	11	W-366	52	21	5.1	9.2					
W-260	42	2.2	2.2	2.2	W-293	52	7	7	11	W-367	52	21	2.2	11.2					
W-261	42	2.2	2.2	2.2	W-294	52	7	7	11	W-368	52	21	9.2	9.2					
W-262	42	2.2	2.2	2.2	W-295	52	7	7	11	W-369	52	21	7.2	9.2					
W-263	42	2.2	2.2	2.2	W-296	52	7	7	11	W-370	52	21	6.2	9.2					
W-264	42	2.2	2.2	2.2	W-297	52	7	7	11	W-371	52	21	2.2	2.2					
W-265	42	2.2	2.2	2.2	W-298	52	7	7	11	W-372	52	21	2.2	2.2					
W-266	42	2.2	2.2	2.2	W-299	52	7	7	11										
W-267	42	2.2	2.2	2.2															
W-268	42	2.2	2.2	2.2															
W-269	42	2.2	2.2	2.2															
W-270	42	2.2	2.2	2.2															
W-271	42	2.2	2.2	2.2															
W-272	42	2.2	2.2	2.2															
W-273	42	2.2	2.2	2.2															
W-274	42	2.2	2.2	2.2															
W-275	42	2.2	2.2	2.2															
W-276	42	2.2	2.2	2.2															
W-277	42	2.2	2.2	2.2															
W-278	42	2.2	2.2	2.2															
W-279	42	2.2	2.2	2.2															
W-280	42	2.2	2.2	2.2															
W-281	42	2.2	2.2	2.2															
W-282	42	2.2	2.2	2.2															
W-283	42	2.2	2.2	2.2															
W-284	42	2.2	2.2	2.2															
W-285	42	2.2	2.2	2.2															
W-286	42	2.2	2.2	2.2															
W-287	42	2.2	2.2	2.2															
W-288	42	2.2	2.2	2.2															
W-289	42	2.2	2.2	2.2															
W-290	42	2.2	2.2	2.2															
W-291	42	2.2	2.2	2.2															
W-292	42	2.2	2.2	2.2															
W-293	42	2.2	2.2	2.2															
W-294	42	2.2	2.2	2.2															
W-295	42	2.2	2.2	2.2															
W-296	42	2.2																	