

114 P 005
O'Connor River Gypsum

LEGEND FOR SECTION

- LS Limestone ALS - argillitic limestone
- G Gypsiferous material
- bd Altered basaltic to ? dioritic dyke or sill?
- sh Shale, argillite
- P Purple beds

VALUES - (D.D.H. #)
 50' of 80.64 Gy, 3.04 An
 128' of 91.67 Gy, 5.10 An

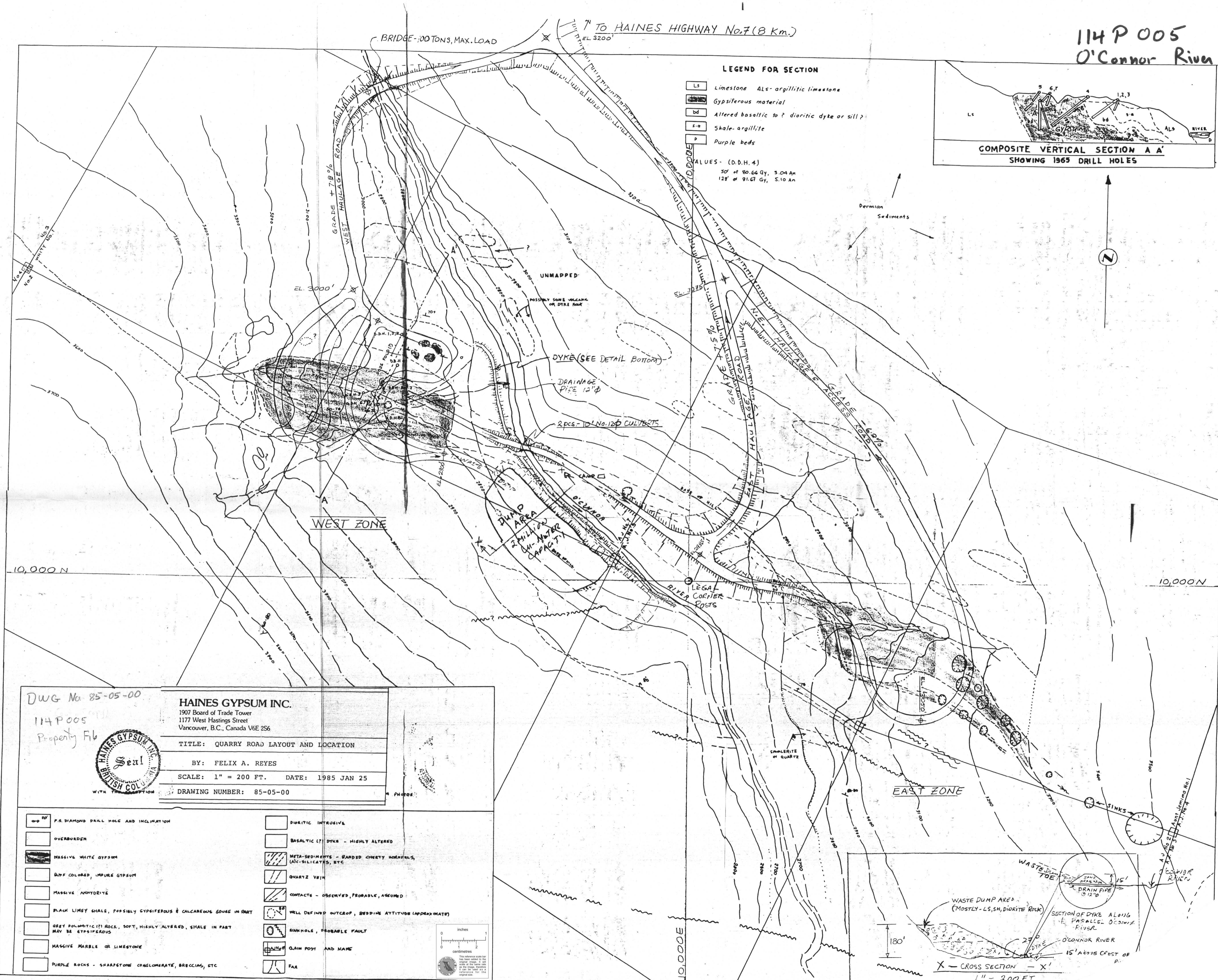
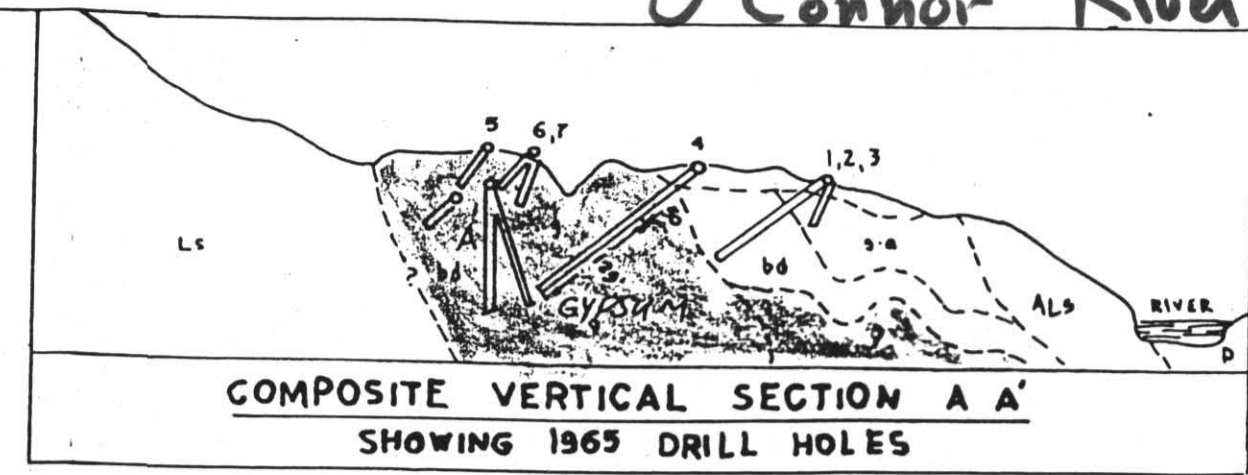

DWG No 85-05-00

114 P 005
Property File

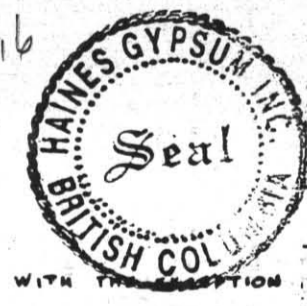

HAINES GYPSUM INC.
 1907 Board of Trade Tower
 1177 West Hastings Street
 Vancouver, B.C., Canada V6E 2S6

TITLE: QUARRY ROAD LAYOUT AND LOCATION
 BY: FELIX A. REYES
 SCALE: 1" = 200 FT. DATE: 1985 JAN 25
 DRAWING NUMBER: 85-05-00

- | | | | |
|--|--|--|---|
| | P.S. DIAMOND DRILL HOLE AND INCLINATION | | DIORITIC INTRUSIVE |
| | OVERBURDEN | | BASALTIC (?) DYKE - HIGHLY ALTERED |
| | MASSIVE WHITE GYPSUM | | META-SEDIMENTS - BANDED CHERTY NODULES, (AL-SILICATES, ETC) |
| | BUFF COLORED, IMPURE GYPSUM | | QUARTZ VEIN |
| | MASSIVE ANHYDRITE | | CONTACTS - OBSERVED, PROBABLE, ASSUMED |
| | BLACK LIMY SHALE, POSSIBLY GYPSIFEROUS & CALCAREOUS SILTSTONE IN PART | | WELL DEFINED OUTCROP, BEDDING ATTITUDE (APPROXIMATE) |
| | GREY VOLCANIC (?) ROCK, SOFT, HIGHLY ALTERED, SHALE IN PART MAY BE GYPSIFEROUS | | SINKHOLE, PROBABLE FAULT |
| | MASSIVE MARBLE OR LIMESTONE | | CLAIM POST AND NAME |
| | PURPLE ROCKS - SOAPSTONE CONGLOMERATE, BRECCIAS, ETC | | PILLAR |

