

"AN EXTRACT FROM - BOB WILMS -1980 REPORT - VETERAN PROSPECTOR AND MINER - IN THE MCDAME CREEK VALLEY SINCE 1924 - NORTHERN BRITISH COLUMBIA, MORE PARTICULARLY IN RESPECT TO BASIC YARDAGE TO BE CONSERVATIVELY EXPECTED BASED ENTIRELY LONG FIELD EXPERIENCE AND SURFACE TESTS MADE, AND BACKED BY A FEW KEYSTONE-DRILL HOLES THAT RAN \$1.50 to \$2.60 per yard @ \$35.00 GOLD. THIS VALLEY-FLOOR AREA IS COVERED BY 13 PLACER GOLD MING LEASES -GRANTED BY THE B. C. MINES DEPARTMENT, VICTORIA, B. C. AND KNOWN AS THE "HOLLOWAY BAR CONSOLIDATION GROUP" OF 5 P.M.LEASES, ON THE WEST (upstream end) AND "JEEP CONSOLIDATION GROUP" OF 6 P.M.LEASES ON THE EAST (downstream end), controlled by WILMS - THERE ARE 4 P:M.Leases roughly in the center of this $6\frac{1}{2}$ mile section NOT owned by WILMS, BUT THIS REPORT INCLUDES THEM AS WELL.

There are 13 Placer Gold Mining Leases covering $6\frac{1}{2}$ miles of the McDame Valley Floor - 9 of these leases controlled by WILMS - 3 of these Leases are held by independant operators in the CENTERVILLE AREA, (AND PRODUCING GOLD) and 1 Lease held independantly on the EAST (down-stream) end (producing interesting Gold Calues). LINEAL MEASUREMENT.

It has recently (1980) come to my attention, (Independant of the Shell Company Drilling Fiasco on the JEEP GROUP 1980) - that two operators were testing for GOLD VALUES - with small Back-hoes - at both EAST and WEST ENDS of our Lease Holdings - as follows:

1. Mr. Gunter Amman, (whom I know personally) had staked a Gold Placer Lease on our WEST-End presumed to be an extension (upstream) of our final P.M.Lease #1598 (this was an error in location caused by incorrect Government Mapping). Unknowingly, he did his testing on our P.M.Lease #1598 - and got very good results with his "Back-Hoe" in fairly shallow digging - running an average of \$7.00 per cu. yd., both on a sizeable ISLAND and on the NORTH shore of the STREAM-bed. He is willing to verify these above statements, if needed. Also willing to buy this Lease this winter - if we will sell it?

2. Now immediately below our Leases on the EAST end (the Dredgeing area), Mr. Oliver Leckie (whom I know personally, and a foreman at Cassiar Asbestos) - did considerable testing with his BACKHOE" and a 3 yard steel Washing-Plant ALL SUMMER (but only on week-ends) he ran a "DRAIN" into a 10 foot working-face - resulting in an AVERAGE OF \$10.00 per cu. yard. This was verified by an Engineer, who estimates \$5,000,000.00 GOLD CONTENT on his lease. (This can be verified).

(See over-leaf - for Calculations and MAP - Wilms).

PROPERTY FILE

1097 600

Knowing this $6\frac{1}{4}$ mile McDame Creek Area verly well - I decided to do some EXTREMELY CONSERVATIVE CALCULATING, as follows:

1980 "TESTED & RECOVERED GOLD VALUES" - West End - - - -	\$7.00 per cu yd.
1980 " " " " East End - - - -	<u>10.00</u> "
	\$17.00

Devide this testing recoveryby 2 - gives Average of - - \$8.50 Per cu yd.

KNOWING THE RECOVERY ON THIS $6\frac{1}{4}$ mile area in the past - - THIS EVALUATION IS * EXTREMELY LOW*.

HOWEVER, ESTIMATING * VOLUME * OF PAY-GRAVELS IN THIS $6\frac{1}{4}$ mile Area: (see map attached) - as to wide areas, and narrow Areas, are very conservatively estimated (from memory) - and "DEPTH" over-all is calculated at "21- feet" which I know exists - as a happy average:

TOTAL GOLD BEARING GRAVELS in $6\frac{1}{4}$ miles (LOW) * 10,906,000
CUBIC YARDS
ESTIMATED AVERAGE GOLD VALUE @ \$8.50 (LOW) gives:

* \$92,701,000.00

Calculations are based on GOLD value of \$600.00 - U.S.
(But REMEMBER that this includes 4 P. M. Leases - we do not OWN).

IT IS IS OF INTEREST TO NOTE THESE FACTS:

In 1940 period I was working on our "Jeep Placer Leases" and handling a full 45 foot FACE on the 90 foot Bench Level - handling 10 ft. of overburden and 15 ft. of under-burden - effevting a DIRECT-CROSS-CUT. I handled 9000 cu. yds. - it averaged 60 cents - top to bottom - - or today @ \$600.00 gold - this average would be \$12.00 per yard. Today - after continued operation the top 30 feet of this 90 fy. bench level averages - \$8.75 - per cubic yard - conservatively.

During the "MOCCASIN MINES OPERATION" in the McDame Creek bottom area in 1948 - DIGGING IN THE WATER - whereby the management estimated they recovery showed a 50% LOSS - Still their OVER-ALL recovery was - 46 cents - or \$9.20 per yard - their total recovery for 1948 and 1949 - was nearly $\frac{1}{2}$ million dollars @ \$35.00 per ounce - or \$10,000,000.00 TODAY - - So, it is very plausible to believe - that by re-working the "Moccassin Operations Tailings" - a further \$10,000,000.00 would result - IF THIS AREA WAS DRAINED * AND WORKED "DRY". OR BUCKET-LINE-DREDGED?

ALL THE ABOVE CALCULATIONS ARE GIVEN SO THAT "YOU CAN SHARPEN YOUR OENCIL" and do some figuring too - IF YOU A RE INTERESTED?

FOR EXAMPLE: In the uppertwo Placer Gold Mining Leases #1598 & #780 - 80 Acres each - there is approximately - 3,000,000 cubic yards @ my reduced evaluation of \$8.50 per cu.yd. - - - - - gives \$26,550,000.00.*

Respectfully submitted by,

Bob Wilms

Ps. You can DIG GOLD HERE in 1981 - if you want to! BOB WILMS. (1981)

ROUGH ESTIMATE OF GRAVEL * VOLUME *
IN * 6 1/2 LINEAL MILES * OF MCDAME
CREEK VALLEY * VERY CONSERVATIVELY

ESTIMATED AT * * 10,906,000 cu. yards.
VERY LOW.

TESTS MADE BY * AMMAN - WEST END - \$7.00
average - per cubic yard.

TESTS BY LECKIE * EAST END - - - - 10.00

VERY CONSERVATIVE AVERAGE * * \$8.50 p.cu. yd.
VERY LOW.

ESTIMATED THE * TOTAL VALUE OF * GOLD PLACERS *
IN THIS * 6 1/2 Mile * SECTION * RIVER BOTTOM
AREA * ONLY * * AT: \$92,701,000.00 based on
U.S. \$600.00 per ounce.

Bob Wilms

To Cassion
RD. 11

Highway #391

Mile #66
To Watson Lake
BOM

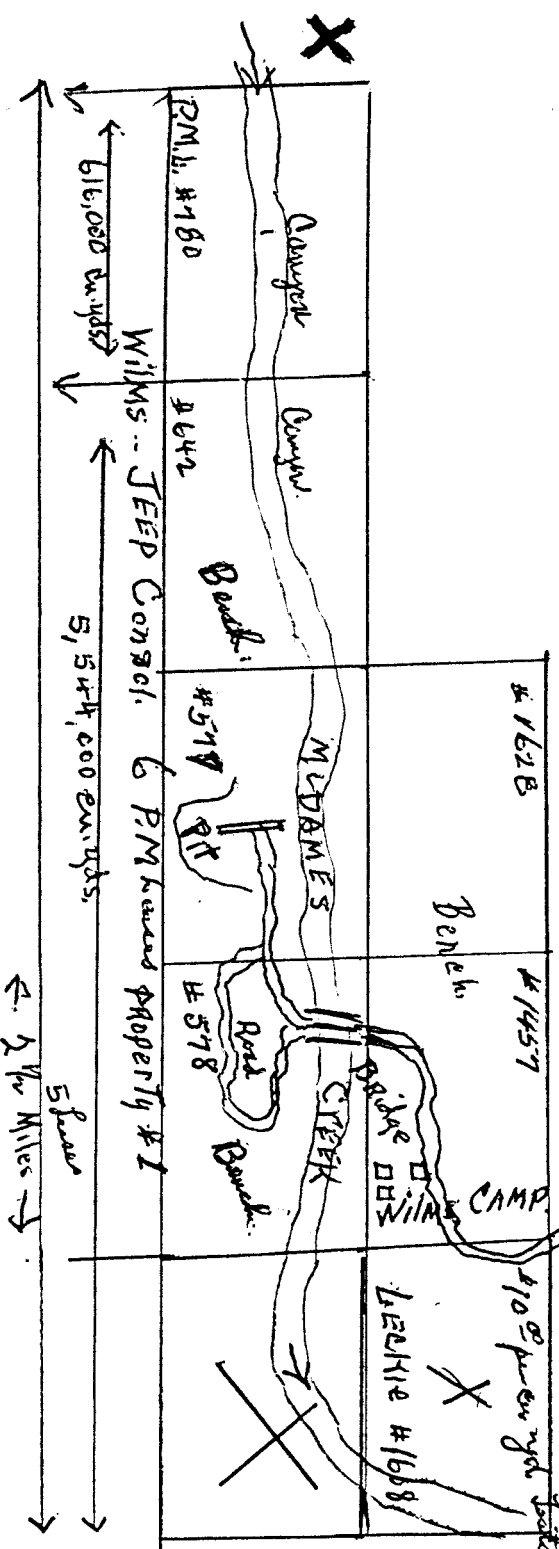
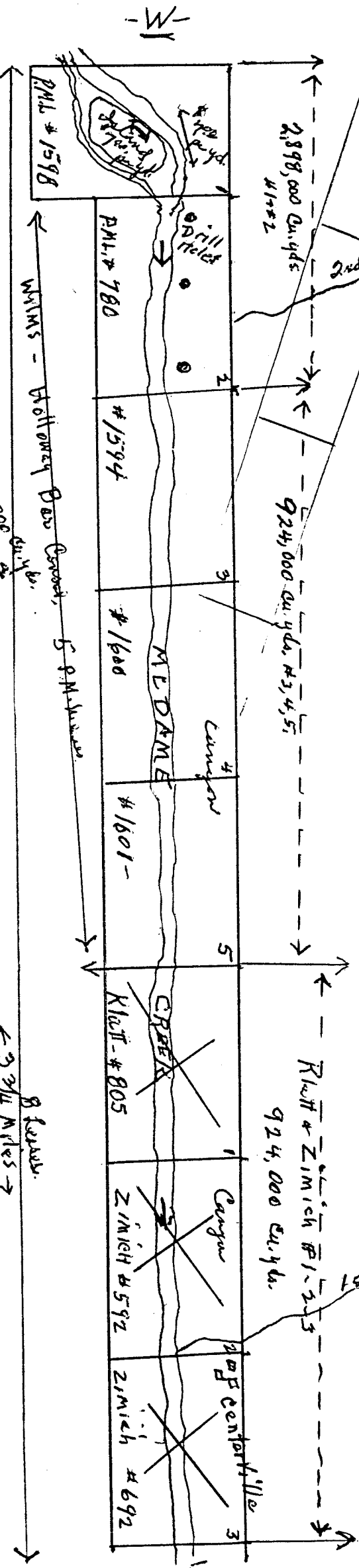

Property #2.
possible \$850,000.00
@

Joins Above X