

GEM N° 1

GEM N° 3

GEM N° 2

GEM N° 4

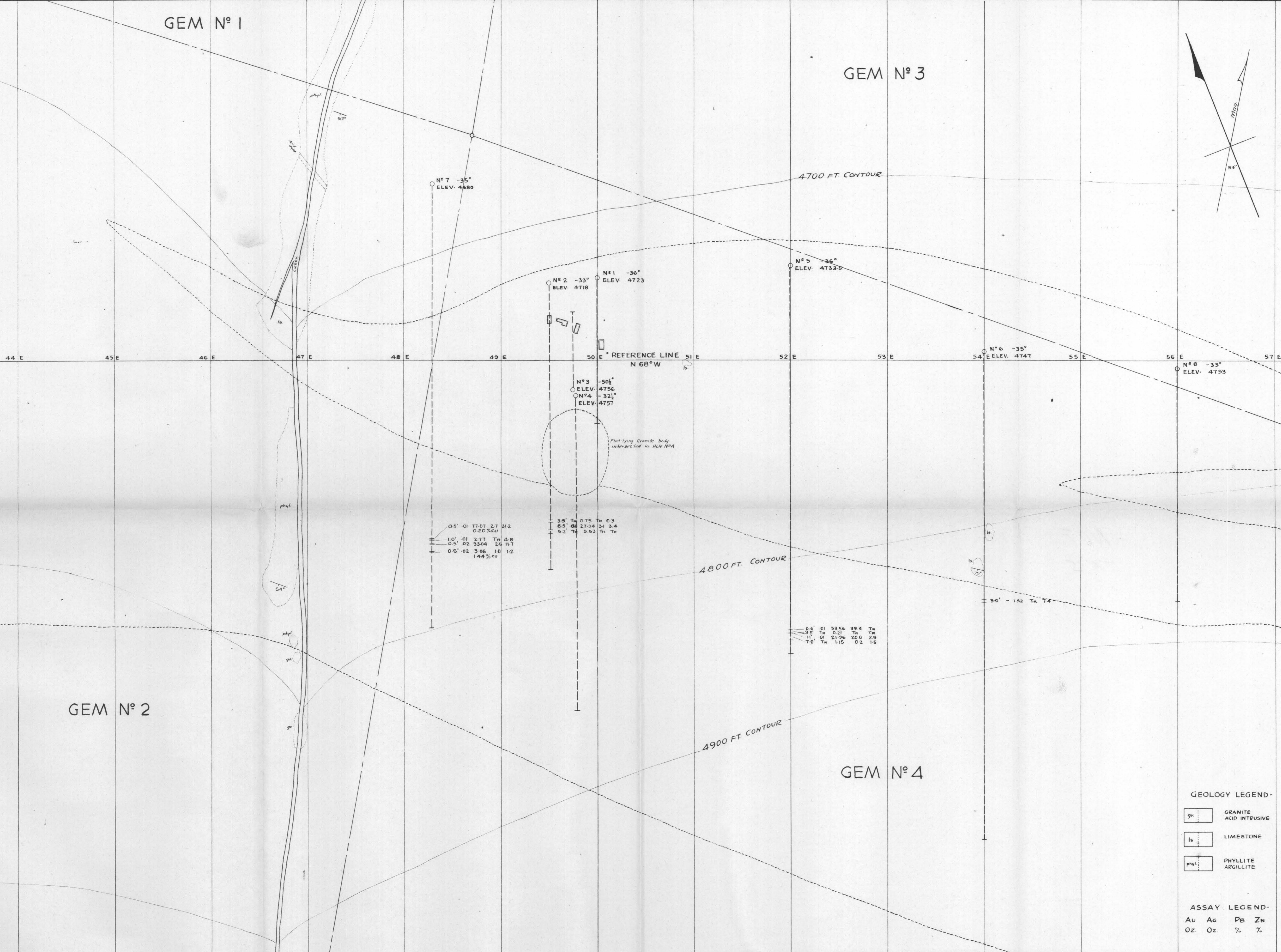
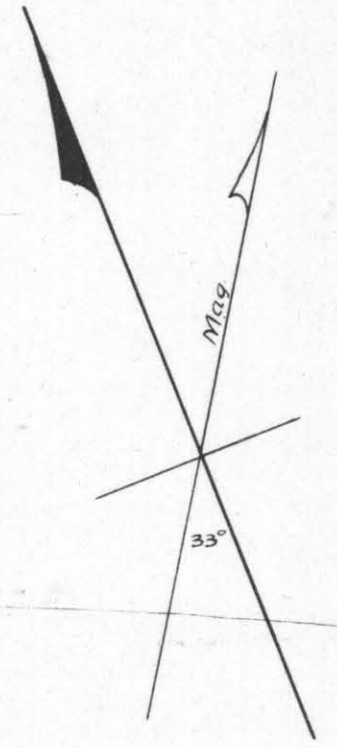

N° 7 -35°
ELEV. 4680

N° 2 -33°
ELEV. 4718

N° 1 -36°
ELEV. 4723

N° 5 -36°
ELEV. 4733.5

N° 6 -35°
ELEV. 4747

N° 8 -35°
ELEV. 4753

N° 3 -50°
ELEV. 4756

N° 4 -32°
ELEV. 4757

REFERENCE LINE
N 68° W

Flint lying granite body
intersected in Hole N° 4

0.5'	01	77.07	2.7	31.2
				0.20% Cu
1.0'	01	2.77	Tr	4.8
0.5'	02	33.03	2.5	11.7
0.5'	02	3.66	1.0	1.2
				1.44% Cu

3.5'	Tr	0.75	Tr	0.3
6.5'	01	27.54	5.1	3.4
9.2'	Tr	9.53	Tr	Tr

4800 FT. CONTOUR

4900 FT. CONTOUR

30' - 1.52 Tr 7.4

6.5'	01	33.56	39.4	Tr
3.5'	Tr	0.21	Tr	Tr
11'	01	21.96	20.0	2.9
7.0'	Tr	1.15	0.2	1.5

GEOLOGY LEGEND-

- gr GRANITE ACID INTRUSIVE
- ls LIMESTONE
- phyl PHYLLITE ARGILLITE

ASSAY LEGEND-

- Au Oz. Ag Oz. Pb % Zn %

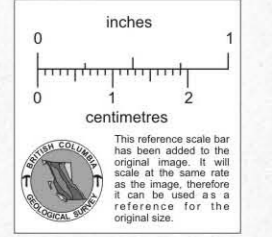

1049/16W

AUGUST 1949.	DIAMOND DRILL PLAN GEM CLAIMS BRITISH COLUMBIA	HUDSON BAY MINING & SMELTING CO. LTD. FLIN FLON OFFICE	SCALE 1 IN. = 50 FT.
DRAWN - KAG			A-381
TRACED - KAG			