

SOUTHWEST FLANK
OF
MT. SISTER MARY

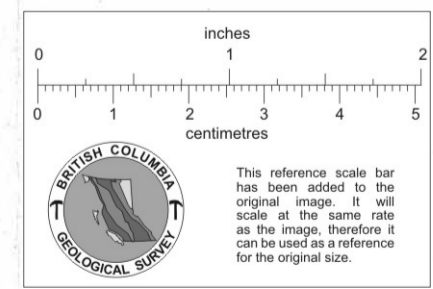

- LEGEND
- 6 ppm Molybdenum
 - Greater than 10 p.p.m.
 - Bulldozer trench
 - 4 Copper occurrence, location number

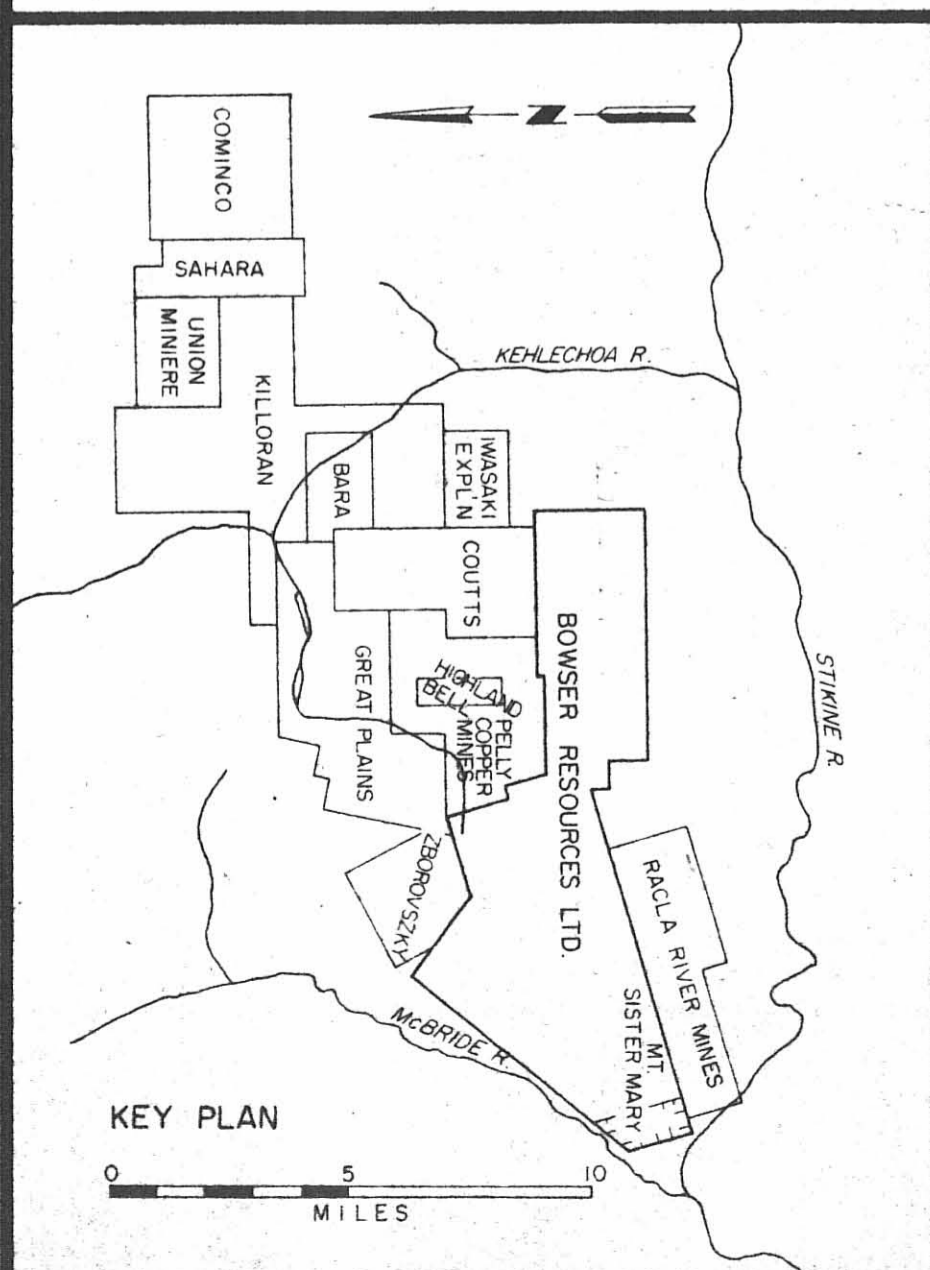
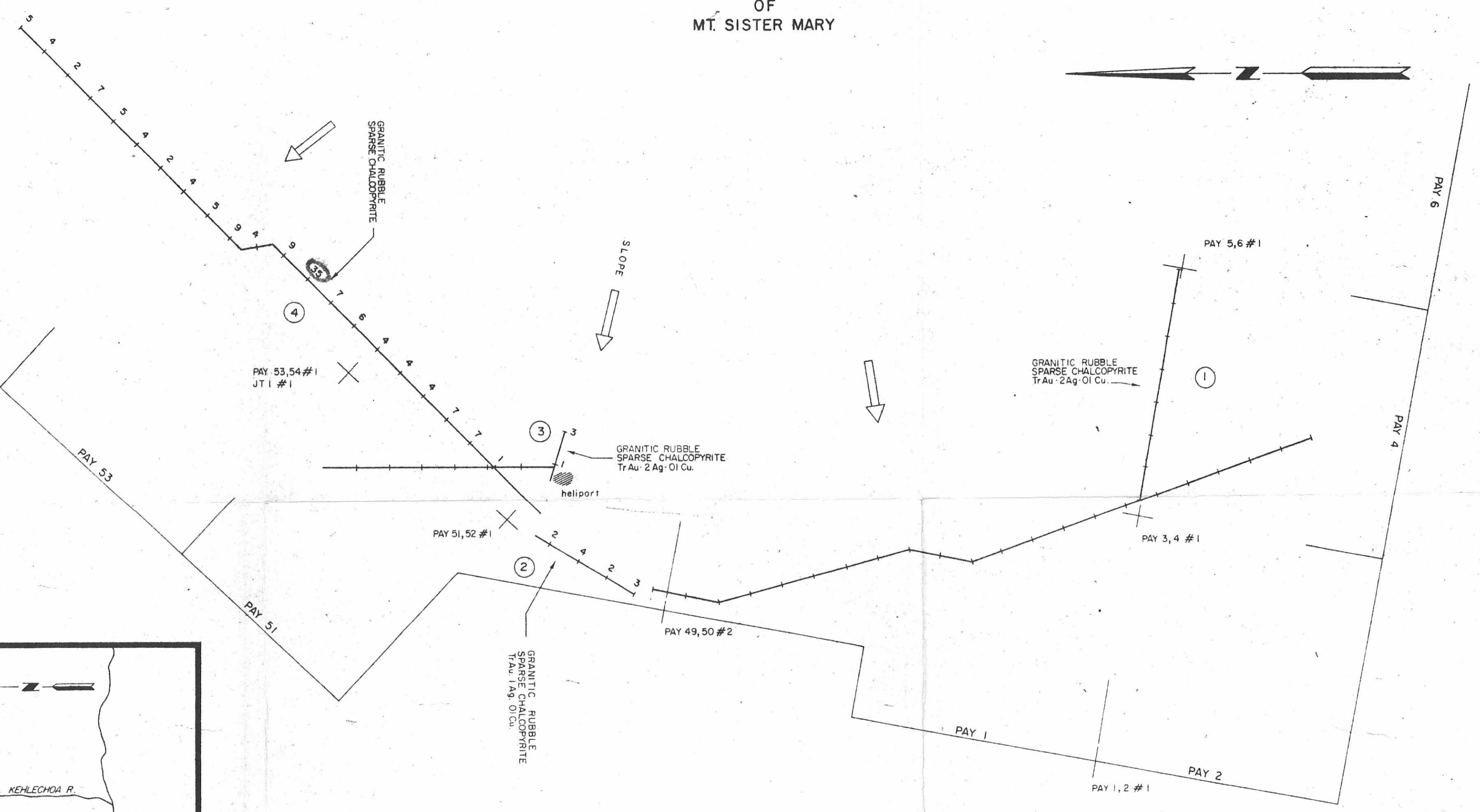

BOWSER RESOURCES LTD.	
McBRIDE RIVER PROJECT DEASE LAKE AREA	SOIL GEOCHEMISTRY MOLYBDENUM SISTER MARY AREA
ACCOMPANIES <u>McBride River Project</u> Summary 1969. R. G. Gifford, Nov. 4/69	
SIGNED	
M.D. LIARD	N.T.S. 104 I-3/H-14
SCALE	DRAWN R.G.G. Oct. /69

019726