

PELLEY COPPER MINES

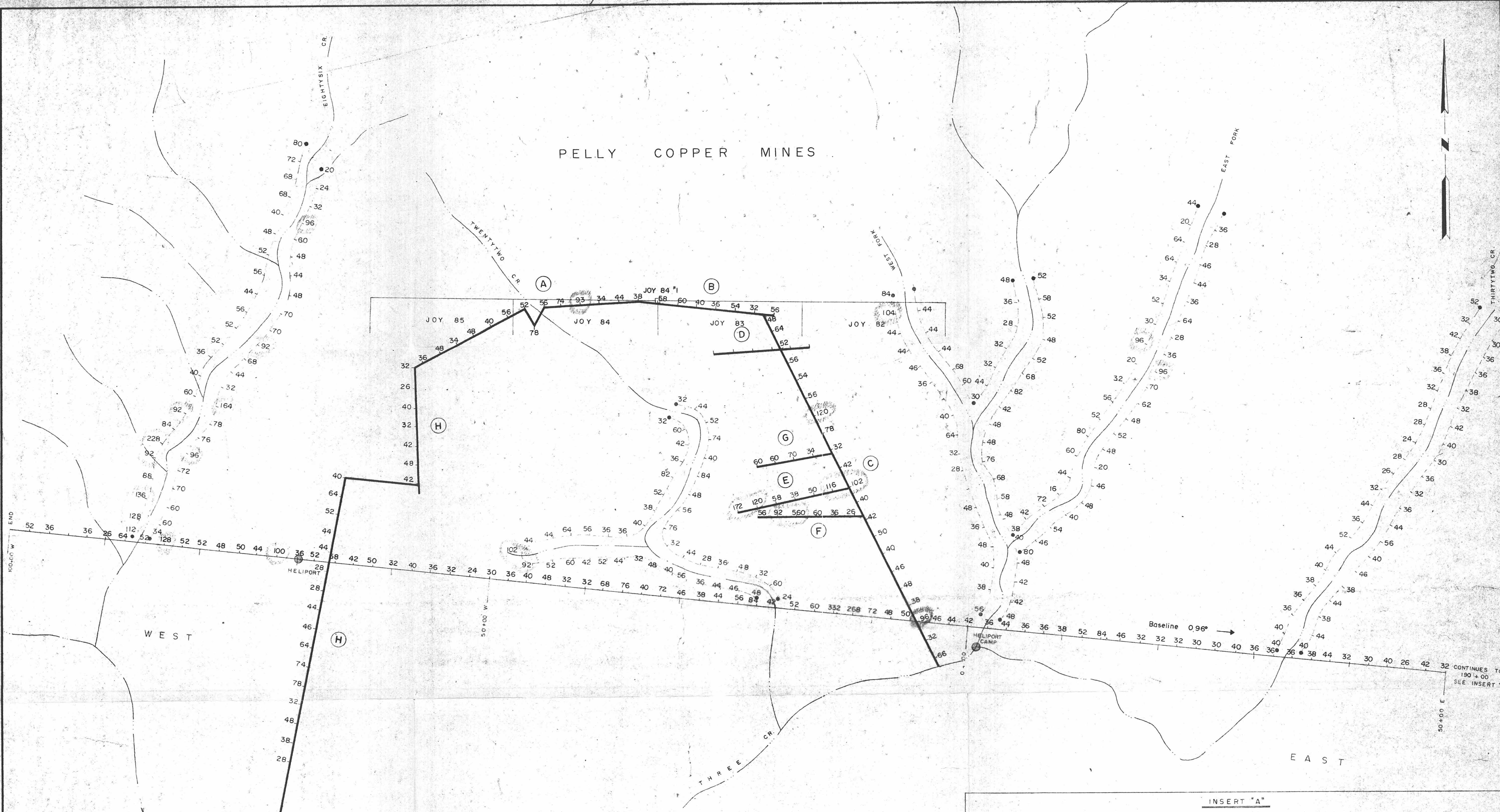

LEGEND

- 40 p.p.m. Copper
- 332 Greater than 90 p.p.m.
- Bulldozer trench

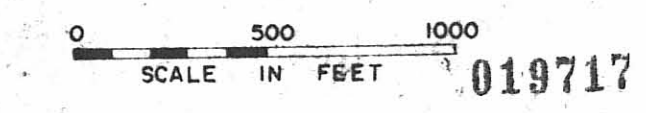
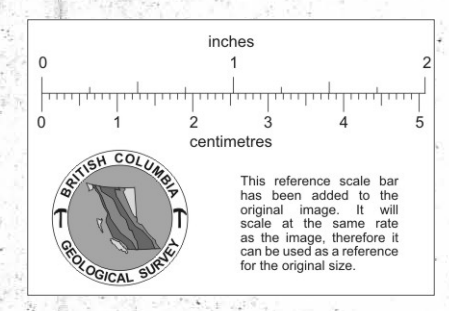
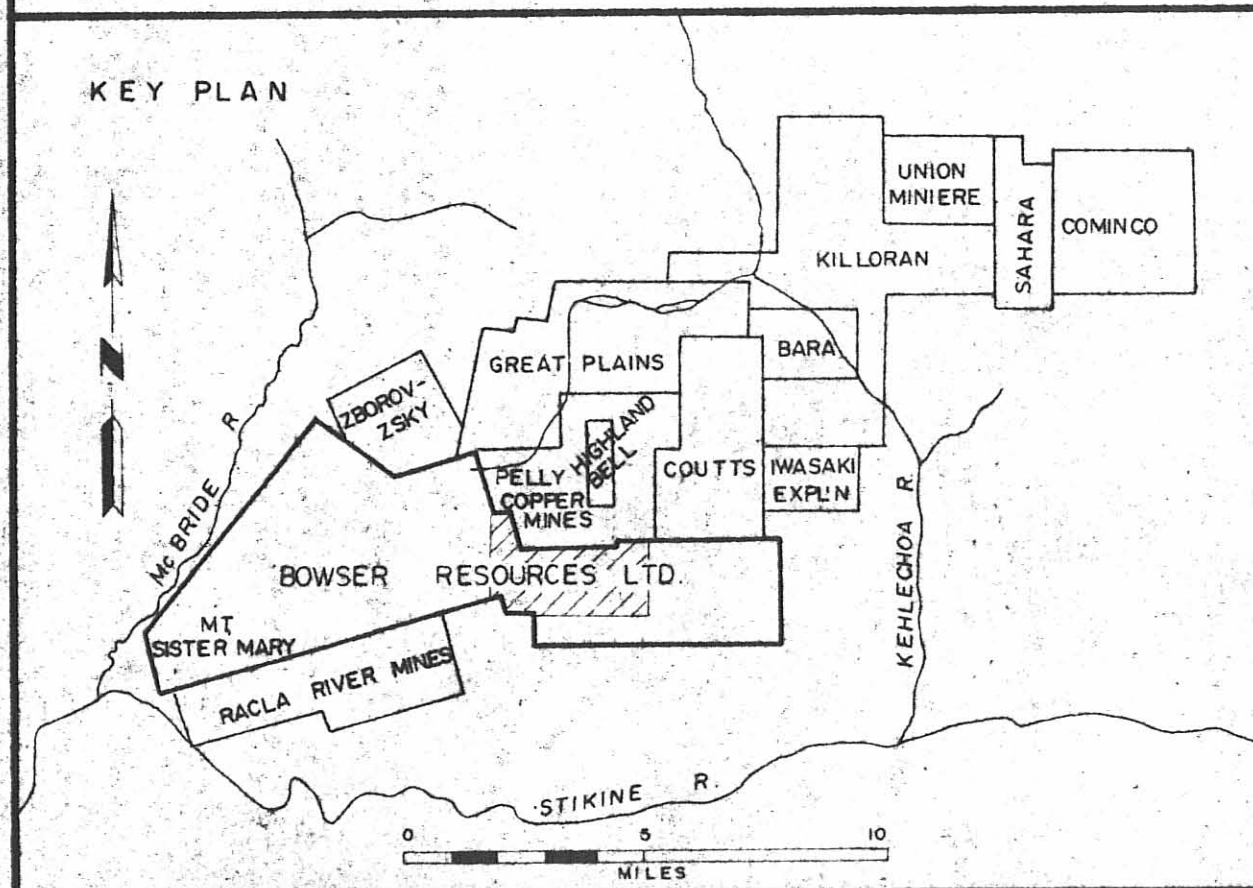
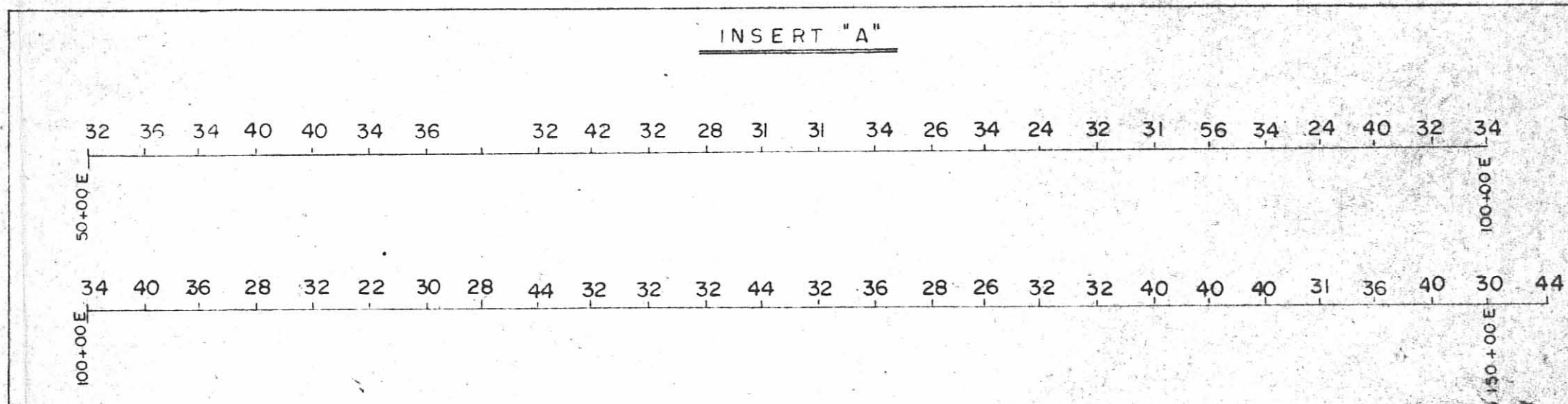

<b>BOWSER RESOURCES LTD.</b>	
McBRIDE RIVER PROJECT DEASE LAKE AREA	SOIL GEOCHEMISTRY <b>COPPER</b> SEC GRID
REPORT McBride River Project Summary 1969. R.G.Gifford, Nov. 4/69	
SIGNED	
LIARD	NTS. 104-1-3 / H-14
SCALE 1" = 500'	DRAWN R.G.G. Oct 69