

019239

104B-089 Iskut 1  
104B 312 Iskut 2

SUPERINTENDENT OF BROKERS  
AND  
VANCOUVER STOCK EXCHANGE  
STATEMENT OF MATERIAL FACTS [#43-88]

EFFECTIVE DATE: May 19, 1988

D.L.

PROPERTY FILE

Iskut River 104B/11E  
104B089 ISKUT 1 (JOAN)

MERIDOR  
RESOURCES LIMITED (the "Issuer")  
19 West Hastings Street  
Vancouver, British Columbia, V6C 2W2 687-6600  
ISSUER, ADDRESS OF HEAD OFFICE AND TELEPHONE NUMBER

← host report by Dandy (1988)

Head Office and 10th Floor, 595 Howe Street  
Office: Vancouver, British Columbia, V6C 2T5  
OFF REGISTERED AND RECORDS OFFICES OF ISSUER

TRUST COMPANY  
1111 West 11th Street, Vancouver, British Columbia, V6E 4B6  
ADDRESS OF REGISTRAR & TRANSFER AGENT FOR ISSUER'S SECURITIES IN  
BRITISH COLUMBIA

OFFERING: 600,000 SHARES

	ESTIMATED PRICE TO PUBLIC	AGENT'S COMMISSION	NET PROCEEDS TO BE RECEIVED BY ISSUER
PER SHARE	\$0.90	\$0.0675	\$0.8325
TOTAL:	\$540,000	\$40,500	\$499,500

The Offering price of the shares will be a fixed price determined by the Issuer and the Agent in accordance with the rules of the Vancouver Stock Exchange.

ADDITIONAL OFFERING: 200,000 SHARES

The Agent will receive Agent's warrants entitling it to purchase a total of 200,000 shares in return for guaranteeing the sale of the shares offered hereby. These shares are hereby qualified for sale. See "Plan of Distribution" for further information concerning the sale of these shares.

The securities offered hereunder are speculative in nature. Information concerning the risks involved may be obtained by reference to this document; further clarification, if required, may be sought from a broker.

104B 076 - Ray (Hemlo West 16)  
PROPERTY FILE

M E R I D O R   R E S O U R C E S   L T D .

GEOLOGICAL REPORT  
ON THE  
ISKUT RIVER PROPERTY  
LIARD MINING DIVISION

JANUARY 1988

NTS 104B/11E  
LATITUDE:  $56^{\circ}42' N$   
LONGITUDE:  $131^{\circ}12' W$

BY

L. DANDY, B.Sc., F.G.A.C., MARK MANAGEMENT LTD.

TABLE II - continued  
LITHOGEOCHEMICAL SAMPLES  
DESCRIPTIONS AND RESULTS

Note: L = less than  
G = greater than

SAMPLE	AU(ppb)	LOCATION	DESCRIPTION
16406	35	75metres east of 16402	Pyrite in chlorite altered argillite
16407	65	75metres east of 16406	Pyrite in chert
16408	135	Trench A on western claim boundary	Wall rock, pyrite in argillite
16409	900	Trench A	0.3 to 0.5 metre wide pyrite and sphalerite zone
16410	3050 (0.078oz/T)	Trench A	Secondary mineralization, pyrite and sphalerite, intense weathered biotite
16411	3050 (0.098oz/T)	Trench B on western claim boundary	3 to 30 cm wide chalcopyrite and bornite vein
16412	G10,000 (0.202oz/T)	Trench B	Pyrite mineralization parallel to 16411
16413	G10,000 (1.910oz/T)	Trench B	20 cm wide zone with pyrite running parallel to 16411
16414	970	L17+50E, 12+25N	Shaly argillite with pyrite and malachite
16415	375	20 m east of L17+50E, 12+55N	Quartz veins in folded rock face with chalcopyrite, pyrite and malachite. Veins up to 12cm
16416	300	L17+50E, 12+30N	30cm quartz vein with chalcopyrite, malachite, pyrite and galena
16417	400	4 metres east of 40352	10 cm wide folded quartz vein with chalcopyrite, malachite and pyrite

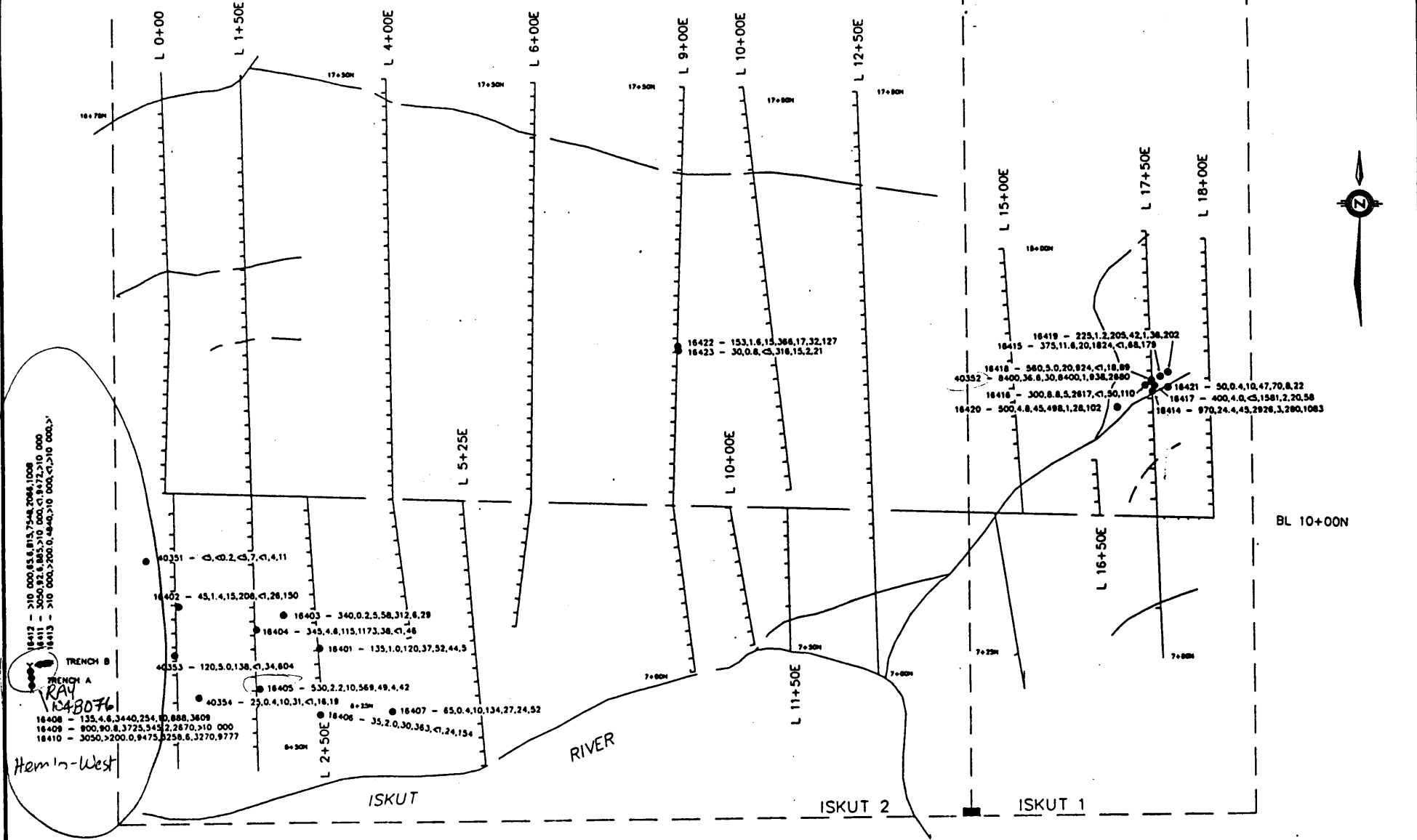

18412 - >10 000,65.6,815,7548,2086,1008  
 18411 - >5050,92.8,885,>10 000,<1,947,2,210 000  
 18413 - >10 000,>200,0,4840,>10 000,<1,310 000,  
 TRENCH B  
 TRENCH A  
 RAY  
 1048076  
 Hem In-West

LEGEND:

- SAMPLE LOCATION  
 40351 - <3, <0.2, <3, 7, <1, 4, 11
- ROCK SAMPLE NUMBER  
 Au(ppm), Ag(ppm), As(ppm), Cu(ppm), Mo(ppm), Pb(ppm), Zn(ppm)

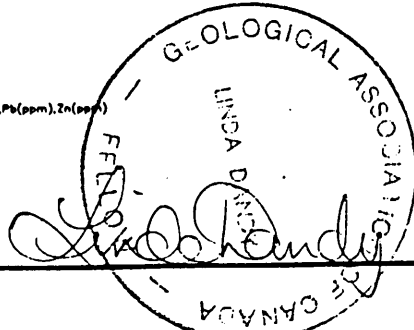

MERIDOR RESOURCES LTD.	
ISKUT RIVER PROPERTY	
LIARD MINING DIVISION, B.C.	NTS: 104 B/11 E
GEOCHEMISTRY SURVEY ROCK SAMPLE RESULTS	
DATE: DECEMBER, 1987	FIGURE No. 3
BY: L.D./rwr	

Prepared by: RWR MINERAL GRAPHICS LTD.