

DD.N.	FROM	TO	ORAN	ORAN
1	0	5435	W	W
2	0	5435	W	W
3	0	5435	W	W
4	0	5435	W	W
5	0	5435	W	W
6	0	5435	W	W
7	0	5435	W	W
8	0	5435	W	W
9	0	5435	W	W
10	0	5435	W	W
11	0	5435	W	W
12	0	5435	W	W
13	0	5435	W	W
14	0	5435	W	W
15	0	5435	W	W
16	0	5435	W	W
17	0	5435	W	W
18	0	5435	W	W
19	0	5435	W	W
20	0	5435	W	W
21	0	5435	W	W
22	0	5435	W	W
23	0	5435	W	W
24	0	5435	W	W
25	0	5435	W	W
26	0	5435	W	W
27	0	5435	W	W
28	0	5435	W	W
29	0	5435	W	W
30	0	5435	W	W
31	0	5435	W	W
32	0	5435	W	W
33	0	5435	W	W
34	0	5435	W	W
35	0	5435	W	W
36	0	5435	W	W
37	0	5435	W	W
38	0	5435	W	W
39	0	5435	W	W
40	0	5435	W	W
41	0	5435	W	W
42	0	5435	W	W
43	0	5435	W	W
44	0	5435	W	W
45	0	5435	W	W
46	0	5435	W	W
47	0	5435	W	W
48	0	5435	W	W
49	0	5435	W	W
50	0	5435	W	W
51	0	5435	W	W
52	0	5435	W	W
53	0	5435	W	W
54	0	5435	W	W
55	0	5435	W	W
56	0	5435	W	W
57	0	5435	W	W
58	0	5435	W	W
59	0	5435	W	W
60	0	5435	W	W
61	0	5435	W	W
62	0	5435	W	W
63	0	5435	W	W
64	0	5435	W	W
65	0	5435	W	W
66	0	5435	W	W
67	0	5435	W	W
68	0	5435	W	W
69	0	5435	W	W
70	0	5435	W	W
71	0	5435	W	W
72	0	5435	W	W
73	0	5435	W	W
74	0	5435	W	W
75	0	5435	W	W
76	0	5435	W	W
77	0	5435	W	W
78	0	5435	W	W
79	0	5435	W	W
80	0	5435	W	W
81	0	5435	W	W
82	0	5435	W	W
83	0	5435	W	W
84	0	5435	W	W
85	0	5435	W	W
86	0	5435	W	W
87	0	5435	W	W
88	0	5435	W	W
89	0	5435	W	W
90	0	5435	W	W
91	0	5435	W	W
92	0	5435	W	W
93	0	5435	W	W
94	0	5435	W	W
95	0	5435	W	W
96	0	5435	W	W
97	0	5435	W	W
98	0	5435	W	W
99	0	5435	W	W
100	0	5435	W	W

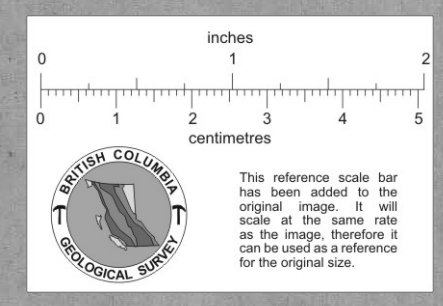

SAMPLE No.	LOCATION	WIDTH OF SAMPLE	REMARKS
1	No. 5 Cut Silverton No. 3 M.C.	6" Tr. - 18"	
2	do	5" - 18"	
3	do	5" - 18"	
4	do	5" - 18"	
5	do	5" - 18"	
6	No. 4 Cut Silverton No. 3 M.C.	4.5" - 11.25"	2.5% Zn
7	do	2" - 5"	13.70% Cu, 2.2% Pb, Picked Sample
8	do	1.5" - 3.75"	Country Blank
9	do	1.5" - 3.75"	
10	At Camp Silverton No. 3 M.C.	1" - 2.5"	
11	do	1" - 2.5"	
12	do	1" - 2.5"	
13	Stone M.C. as marked	6.5" - 1.625"	
14	No. 1 Cut Spring No. 2 M.C.	6" - 1.5"	
15	do	6" - 1.5"	
16	do	6" - 1.5"	
17	do	6" - 1.5"	
18	No. 2 Cut Spring No. 2 M.C.	6" - 1.5"	
19	do	6" - 1.5"	
20	do	6" - 1.5"	
21	do	6" - 1.5"	
22	do	6" - 1.5"	
23	do	6" - 1.5"	
24	do	6" - 1.5"	
25	No. 2 Cut Silverton No. 3 M.C.	2" - 4.25"	1.2% Pb, 1.2% Zn, Picked
26	do	2" - 4.25"	2.9% Zn
27	No. 2 Cut Silverton No. 3 M.C.	5" - 1.25"	2.2% Zn
28	do	5" - 1.25"	
29	do	5" - 1.25"	
30	do	5" - 1.25"	
31	do	5" - 1.25"	
32	do	5" - 1.25"	
33	do	5" - 1.25"	
34	do	5" - 1.25"	
35	do	5" - 1.25"	
36	Tunnel Hardwick M.C.	6" - 1.5"	
37	do	6" - 1.5"	
38	do	6" - 1.5"	
39	do	6" - 1.5"	
40	do	6" - 1.5"	
41	do	6" - 1.5"	
42	do	6" - 1.5"	
43	No. 2 Cut Hardwick M.C.	3" - 1.5"	
44	do	3" - 1.5"	
45	No. 1 Cut Hardwick M.C.	5" - 1.25"	
46	Caliste Cut, Potlatch M.C.	10" - 1.5"	
47	do	7" - 1.5"	
48	No. 3 Cut Spring No. 2 M.C.	4" - 1.25"	
49	do	4" - 1.25"	
50	do	4" - 1.25"	
51	do	4" - 1.25"	
52	do	4" - 1.25"	
53	No. 4 Cut Spring No. 2 M.C.	7" - 1.25"	
54	do	11" - 1.25"	
55	No. 5 Cut Tree M.C.	2" - 2.25"	2.2% Zn, 5.3% Zn
56	do	2" - 2.25"	
57	do	2" - 2.25"	
58	do	2" - 2.25"	
59	do	2" - 2.25"	
60	do	2" - 2.25"	
61	do	2" - 2.25"	
62	do	2" - 2.25"	
63	do	2" - 2.25"	
64	do	2" - 2.25"	
65	do	2" - 2.25"	
66	do	2" - 2.25"	
67	do	2" - 2.25"	
68	do	2" - 2.25"	
69	do	2" - 2.25"	
70	do	2" - 2.25"	
71	do	2" - 2.25"	
72	do	2" - 2.25"	
73	do	2" - 2.25"	
74	do	2" - 2.25"	
75	do	2" - 2.25"	
76	do	2" - 2.25"	
77	do	2" - 2.25"	
78	do	2" - 2.25"	
79	do	2" - 2.25"	
80	do	2" - 2.25"	
81	do	2" - 2.25"	
82	do	2" - 2.25"	
83	do	2" - 2.25"	
84	do	2" - 2.25"	
85	do	2" - 2.25"	
86	do	2" - 2.25"	
87	do	2" - 2.25"	
88	do	2" - 2.25"	
89	do	2" - 2.25"	
90	do	2" - 2.25"	
91	do	2" - 2.25"	
92	do	2" - 2.25"	
93	do	2" - 2.25"	
94	do	2" - 2.25"	
95	do	2" - 2.25"	
96	do	2" - 2.25"	
97	do	2" - 2.25"	
98	do	2" - 2.25"	
99	do	2" - 2.25"	
100	do	2" - 2.25"	

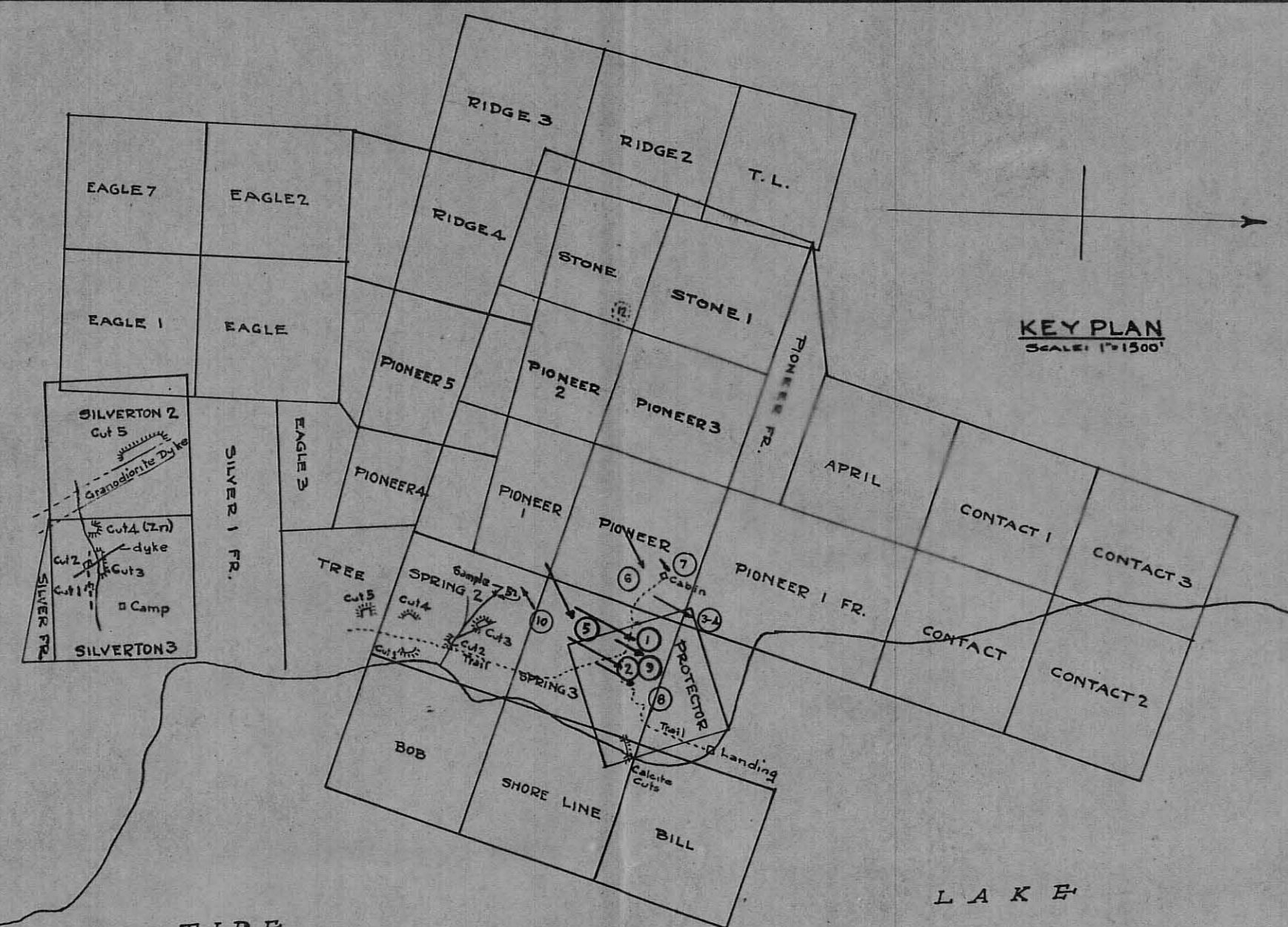
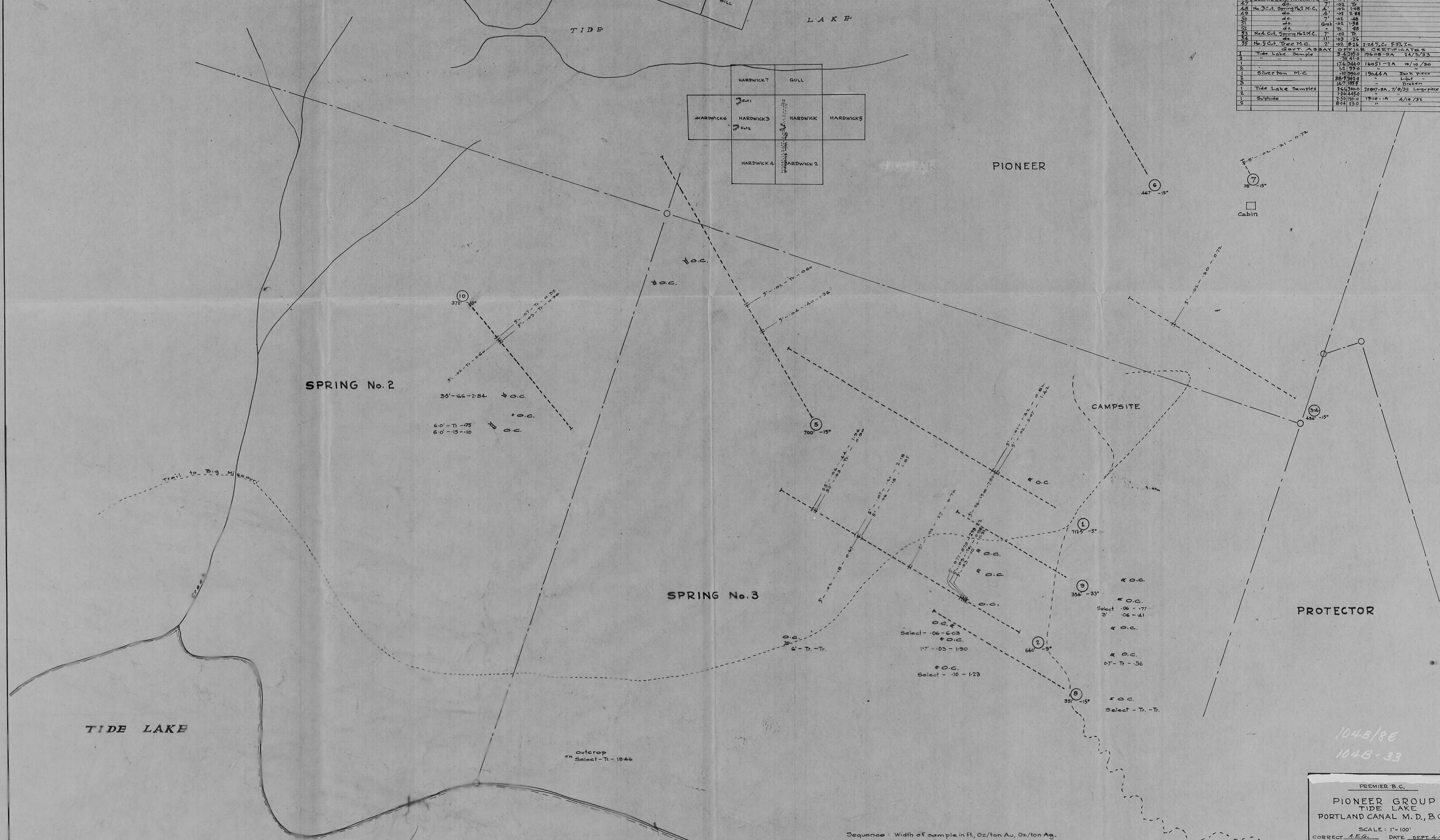

Sequence: Width of sample in Ft., Oz./ton Au., Oz./ton Ag.
 From C.M. & S. plans to accompany reports by P. Powell Sept 1930, & W.E. Aitchison Oct. 1929.

PREMIER B.C.
PIONEER GROUP
 TIDE LAKE
 PORTLAND CANAL M. D., B.C.
 SCALE: 1" = 100'
 CORRECT A.E.G. DATE SEPT. 4/36
 DRAWING No. 1219 MINE FILE 2-1919-2A

019116