

This reference scale bar has been added to the original image. It will scale at the same rate as the image, therefore it can be used as a reference for the original size.

NICHOLSON CREEK MINING CORPORATION

MINERAL CLAIMS NEAR USK, B.C. (UNSURVEYED)
OMINECA MINING DIVISION RANGE 5, COAST DISTRICT

COMPILED BY
J.A. Siefert, Mining Engineer-Geologist, From Data
Supplied by Fred Nash, B.C.L.S., Buckley Shannon and
J.A. Siefert.

Scale Ft. 0 500 1000 1500

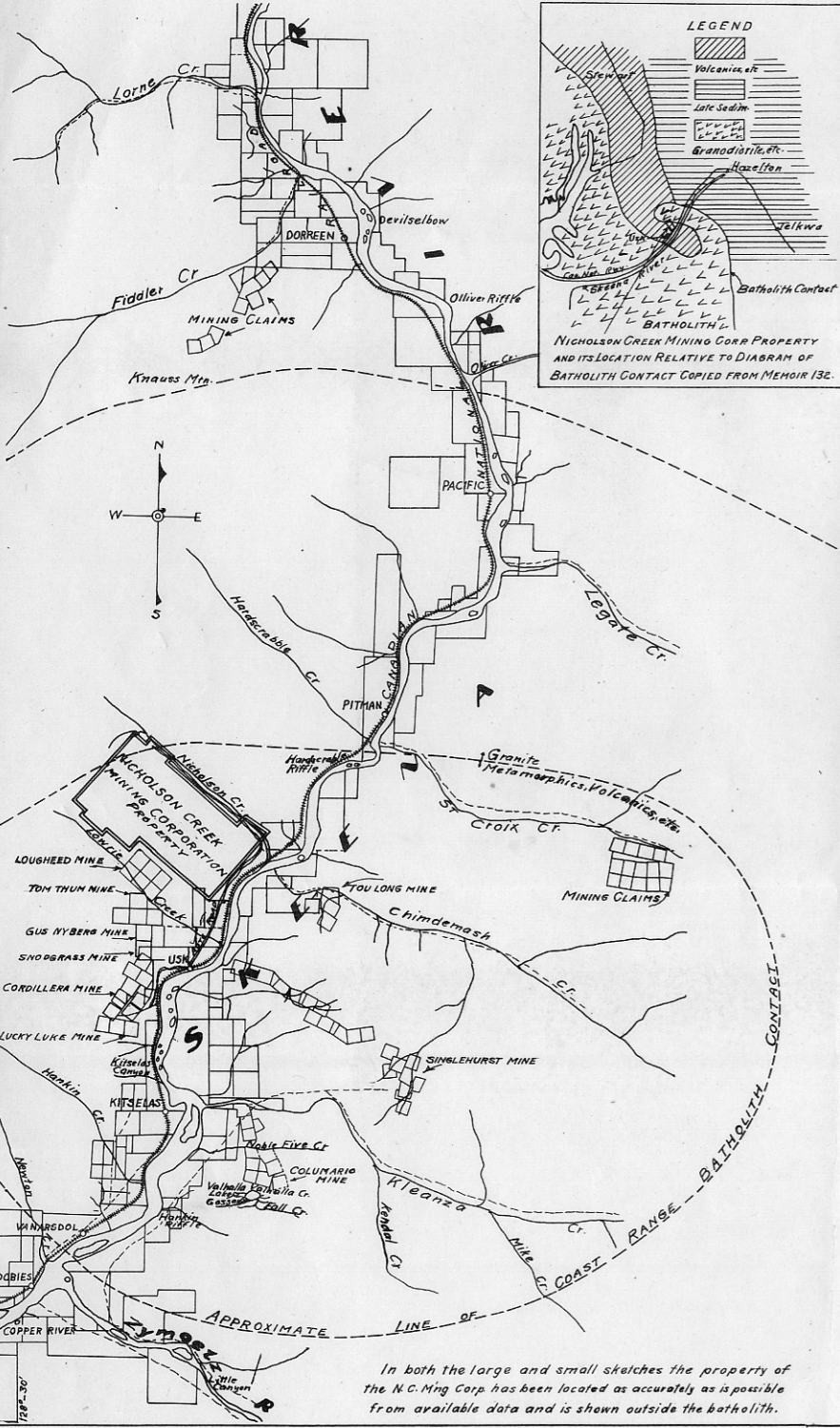
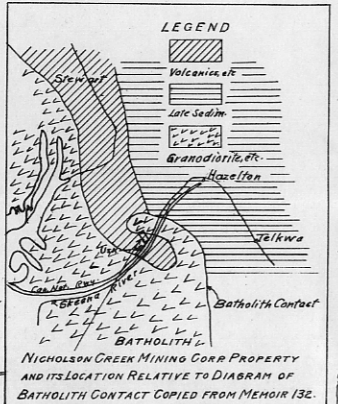

In both the large and small sketches the property of the N.C. Mining Corp. has been located as accurately as possible from available data and is shown outside the batholith.

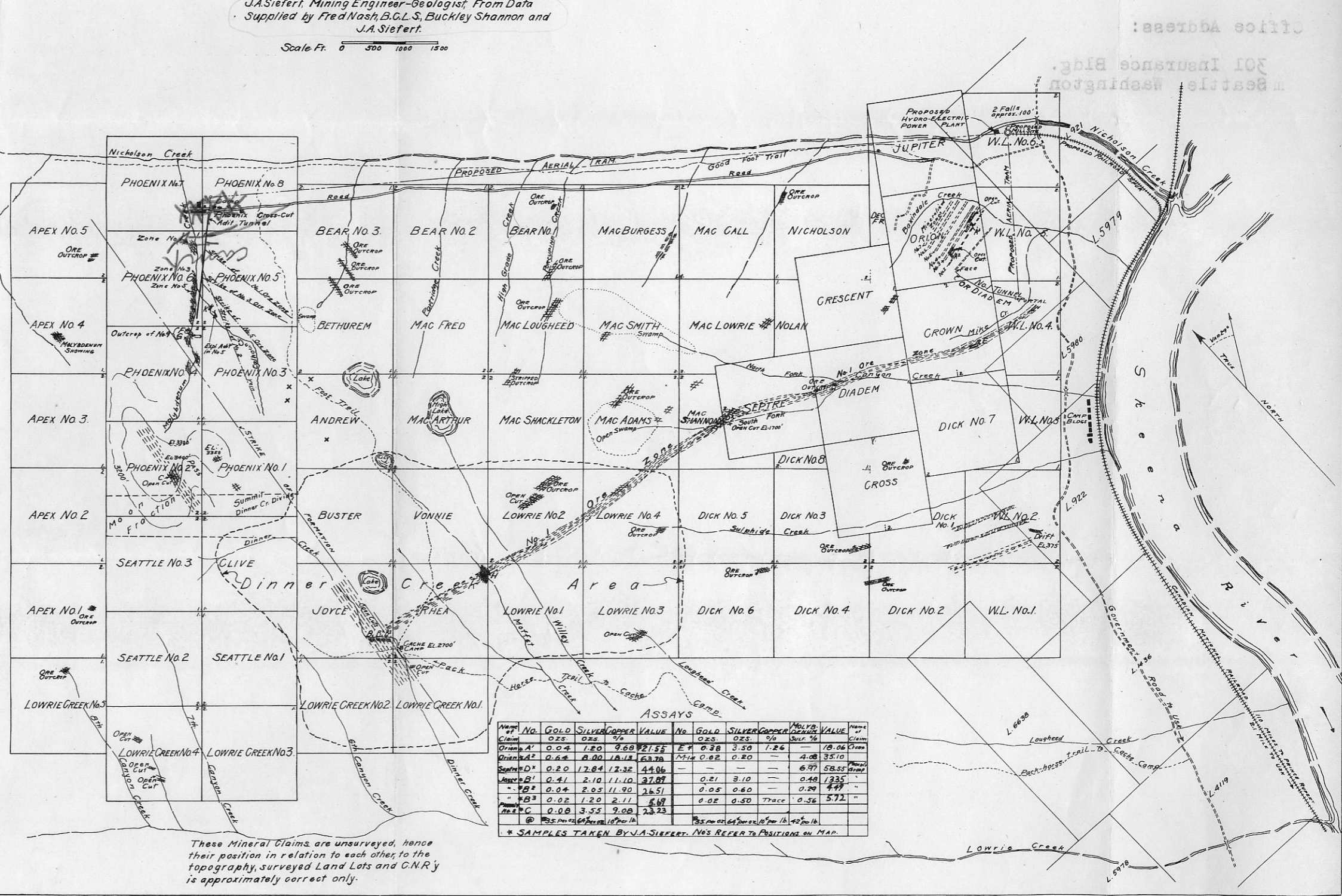

ASSAYS

Weight of Claim	No.	GOLD	SILVER	COPPER	VALUE	No.	GOLD	SILVER	COPPER	VALUE	MOLYB.	VALUE	Name of Claim
OZS.		OZS.	%			OZS.	%	%			Grain %		
0.04	A1	1.20	9.68	21.55	4.94	0.38	3.50	1.26	4.08	35.10		19.06	Orion
0.62	A2	0.00	18.12	62.78	12.12	0.02	0.20		4.08	35.10			Orion
0.20	D1	17.84	12.32	44.06					6.97	58.55			Diadem
0.41	B1	2.10	11.10	37.89		0.21	3.10		0.48	13.35			Diadem
0.04	B2	2.03	11.90	26.51		0.05	0.60		0.24	4.47			Diadem
0.02	B3	1.20	2.11	5.67		0.02	0.50	Trace	0.36	5.72			Diadem
0.00	C	3.55	9.00	23.23									Diadem

* SAMPLES TAKEN BY J.A. SIEFERT. NOS REFER TO POSITIONS ON MAP.

These Mineral Claims are unsurveyed, hence their position in relation to each other to the topography, surveyed Land Lots and C.N.R.'s is approximately correct only.

inches

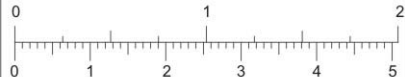

centimetres



This reference scale bar has been added to the original image. It will scale at the same rate as the image, therefore it can be used as a reference for the original size.

DIRECTOR - OTTO WICK
 Director - Dr. G. G. Thompson
 Director ----- A. M. MacNee
 Director ----- W. D. Galbraith
 ----- Earle E. Cleveland
 Director ----- Arthur Chantry
 Director ----- W. A. Schwalby
 Director ----- Buckley Shannon
 Director ----- M Kelly

Office Address:

301 Insurance Bldg.
 in Seattle, Washington