

017927

~~24933~~  
Revised Surf In Let  
PF 103H 027



File No. 13160-01-19

January 13, 1997

Rupert Resources Ltd.  
520 - 470 Granville Street  
Vancouver, British Columbia  
V6C 1V5

Dear Sirs:

**Re: Sea Anchor, Summit, Bonanza, Anaconda, etc. Mineral Claims  
Tenure Nos. 250833-250836, etc.  
Skeena Mining Division**

The exploration and development work recorded on Statement of Work #3099369 has been applied to the above mentioned claims. A copy of the statement bearing the issued document number indicating application of the work credits is enclosed for your records.

Pursuant to Section 29(1) of the Mineral Tenure Act and Section 1(5) of the Regulation, this Statement of Work must be substantiated by a technical report. Two copies of the report must be received on or before **April 14, 1997**.

Both copies of the report may be submitted directly to this office or any sub-recording office. A copy of the enclosed photocopy of the Statement of Work must be included with the reports. Pursuant to Section 29(2) of the Act, the failure to submit the required reports within the 90 day period may result in the cancellation of all exploration and development credit to the claims from the enclosed statement.

All inquires concerning the report should be directed to Mr. Gilbert McArthur of the Geological Branch in Victoria (604-952-0385). Inquires with respect to the Statement of Work are to be directed to this office.

Yours truly,

  
Gail Phillips  
Deputy Gold Commissioner

cc Gilbert McArthur, Assessment Report Geologist

Enclosures



**Mineral Tenure Act**

**STATEMENT OF WORK - CASH PAYMENT - RENTAL**  
Sections 25, 26, 27 & 45

Indicate type of title MINERAL (Mineral or Placer) \_\_\_\_\_ (Claim(s) or Lease(s))

Mining Division SLEENA

OFFICE USE ONLY

EVENT NO. 3099369

RECEIVED

15 JAN 10 13374175

Gold Commissioner's Office  
VANCOUVER, B.C.

Gold Commissioner Approval of \_\_\_\_\_

Physical Work : \_\_\_\_\_

PLEASE PRINT CLEARLY

CARL A. VON EINSIEDER  
(Name)  
210-470 GRANVILLE ST.  
(Address)  
VANCOUVER, B.C.  
V6C-1V5 (604) 649-5793  
(Postal Code) (Telephone)

Agent for RUPERT RESOURCES LTD.  
(Names of all recorded holders)  
520-470 GRANVILLE ST.  
(Address)  
VANCOUVER, B.C.  
(Postal Code) (Telephone)

Client Number 127981

Client Number 138330

If recording work, complete the following. If only paying cash in lieu or lease rental, turn to reverse and complete columns G to J and Q to T.

The recorded holder has performed, or caused to be performed, the work detailed below on the LOT 31 "DLS" Claim(s).

Tenure No.(s) \_\_\_\_\_ WORK PERMIT No. PENDING

Work was done from AUG 15 1996 to DEC 30 1996

**TYPE OF WORK**

**PHYSICAL:** Work such as trenches, open cuts, adits, pits, shafts, reclamation, and construction of roads and trails. Details as required under section 13, Part C, of the Regulations, including the map and cost statement must be given on or attached to this statement.

**PROSPECTING:** Details as required under section 9, Part C, of the Regulations must be submitted in a technical report. Prospecting work can only be claimed once by the same owner of the ground, and only during the first three years of ownership.

**GEOLOGICAL, GEOPHYSICAL, GEOCHEMICAL, DRILLING:** Details must be submitted in a technical report conforming to sections 5 through 8 (as appropriate), Part C, of the Regulations.

**PORTABLE ASSESSMENT CREDIT (PAC) WITHDRAWAL:** A maximum of 30% of the approved value of geological, geophysical, geochemical and/or drilling work on this statement may be withdrawn from the owner's or operator's PAC account and added to the work value on this statement as required under section 12, Part C, of the Regulations.

**NOTE:** Where required, the assessment report must be received within ninety days of the earliest due anniversary date on this statement.

TYPE OF WORK (Specify Physical (include details), Prospecting, Geological, etc.)	VALUE OF WORK			TOTALS
	Physical	Prospecting	Geological, etc.	
<u>GEOLOGICAL</u>			<u>200,000</u>	
<u>UNDERGROUND WORK AS PER ATTACHED REPORT TO FOLLOW</u>	<u>200,000</u>			
<u>PHYSICAL WORK REPORT TO FOLLOW:</u>				
<b>TOTALS</b>	<b>A</b>	<b>B</b>	<b>C</b>	<b>D</b> <u>200,000</u>
PAC WITHDRAWAL - Maximum 30% of Value in Box C Only from account(s) of _____				<b>E</b>
<b>TOTAL</b>				<b>F</b> <u>200,000</u>



PHYSICAL WORK REPORT

**RECEIVED**  
**APR 14 1997**  
Gold Commissioner's Office  
VANCOUVER, B.C.

PROGRESS OF OPERATIONS

SURF PROJECT

NTS Map Sheet: 103H2W

Reporting period breakdown: August 15, 1996 to December 30, 1996

Summary of technical program: Underground diamond drilling program on the Surf mine 900 level.

Project Operator: Rupert Resources Ltd.  
520 - 470 Granville Street  
Vancouver, B.C.

Project Manager: Ram Exploration Ltd.  
210 - 470 Granville Street  
Vancouver, B.C.

Report Author: C. von Einsiedel, P.Geo.

Date submitted: April 14, 1997

MINERAL SURVEY BRANCH  
REPORT

24,933

## TABLE OF CONTENTS

	Page
1.0 Summary of assessment filing no.3099369	1
2.0 Technical summary	1
3.0 List of mineral claims - Statement of Work No.30993669	3
4.0 Summary of work completed during 1996	4
5.0 List of all equipment and supplies currently on site	6
6.0 Statement of costs (August 15, 1996 to December 30, 1996)	8
7.0 References	16
8.0 Certificate of Qualifications	17

## LIST OF FIGURES

	Page
Fig.1 Location map showing Surf mine 900 level portal	18
Fig.2 Diagrammatic longitudinal drawing showing Surf mine workings	19
Fig.3 Diagrammatic longitudinal drawing showing area of proposed diamond drilling program	20

1.0 Summary of assessment filing no.3099369

Pursuant to Statement of Work No.3099369 filed January 10, 1997 the writer filed geological work totalling \$200,000 on the Surf Claim Group as per Grouping Notice No.30993668 recorded on January 10, 1997.

This filing is based on preparatory work involved in a proposed program of underground diamond drilling to be completed from a crosscut and drill station on the 900 level of the Surf mine.

This proposal is permitted under Approval Number SMI-95-0100067-171 and Reclamation Permit No. MX-1-447.

This filing reflects progress of operations as at December 30, 1996.

The proposed geological program of diamond drilling will be completed during the 1997 exploration season.

This report is designed to meet assessment requirements. It would be more appropriate to classify this interim statement of work as "Physical Work" rather than as geological work.

2.0 Technical summary (reproduced from the Magrum Report, dated Feb. 4, 1996)

Rupert Resources Ltd. owns a 100% interest in the Surf Inlet Project, one of British Columbia's largest past producing, lode-type gold mines. The total recorded production from two adjoining mines which form the property (termed the Surf and Pugsley Mines) is 1,091,245 tons at an average grade of 0.42 oz/ton gold. The majority of the production (921,245 tons) was from the Surf mine which had average stope widths of more than 3 meters.

The mines were in operation from 1915 to 1925 and again from 1935 to 1941. Metallurgy of the ores is very simple and recovery involved standard floatation techniques and shipment of gold concentrates to a smelter.

During 1994 Rupert Resources Ltd. submitted an S.M.F.(#82/94 - effective date November 1, 1994) to the Superintendent of Brokers and the V.S.E. complete with a technical report outlining a staged exploration program (report dated May 10, 1993 as amended) prepared by M. Magrum, P.Eng. and A. Burton, P.Eng.

In the Magrum - Burton report it is noted that "In the Surf Mine, previous drilling from the 1000 Level as well as structural control and mode of emplacement of ore shoots, indicates a new ore shoot may be present below this level north of the existing workings (ie. on the Wells Claims). The report further notes that "during mine development (circa 1900 - 1943) exploration for new ore zones ceased when the down dip or plunge extension of the Surf ore zone approached the boundary of a group of claims held by a man named Wells. As a deal with Wells could never be completed, this ground has never been explored (A.C. Freeze, 1986)". The present property package includes all areas adjacent to and down dip of the main ore body (Surf Mine). Plate 3.0 shows the position of the former Wells Claim boundary relative to the Surf mine workings and the results of drilling carried out in 1941-42 (adapted from Vulimiri, 1986).

/.

In addition to the potential for new discoveries in the Surf Mine area there are several known ore sources including: mine dumps at the Surf 550 Level estimated to contain 150,000 tons at a grade of approximately 0.1 oz/ton; mill tailings estimated at approximately 187,000 tons averaging 0.033 oz/ton; and, in situ underground reserves (at the Pugsley mine) of 47,250 tons at an average grade of 0.4 oz/ton gold. All of these estimates are quoted from a report prepared by M. Vulimiri, 1986. Although supporting documentation exists these estimates do not conform to current industry standards for ore reserve classification and cannot be classed as "proven" or "probable" ore sources.

In 1988, the previous operator (Surf Inlet Mines Ltd.) commenced an extensive exploration program with the primary objective being to drill test the "Wells Claims" from the 900 Level of the Surf mine workings. New access roads were built, a trailer camp was installed and much of the required underground rehabilitation work was completed however market interest declined in late 1988 and the proposed underground drill program was not carried out.

After taking into consideration the work completed in 1988, Magrum and Burton recommended a comprehensive, multi-stage exploration and development program at an estimated cost of approximately \$1,125,000. This program was designed to fully evaluate all of the known, potential ore sources on the Surf Inlet Property.

Although the program suggested by Magrum and Burton is justified, it is the author's opinion that the most promising exploration target on the property is the former Wells claim area. This area has potential to host a repetition of the main Surf orebody which produced almost one million tons at a grade of over 0.4 oz/ton gold.

In November 1994, the author submitted a technical report to Rupert Resources which outlined a two-stage program of underground rehabilitation and development and the completion of approximately 2,000 meters of diamond drilling from the 900 Level. The estimated cost of this program was 549,125 based on completion of both the preparatory work and the drill program within a single field season.

During September and October 1995, Rupert Resources completed the initial stages of this program including repair and rehabilitation of the access roads and the trailer camp and un-anticipated repairs to parts of the 900 Level. The total cost of this work was \$250,000.

After taking into account the work completed in 1995 it was estimated that it will cost approximately \$400,000 for equipment mobilization, completion of the necessary rehabilitation and development work and the initial, 2,000 meter diamond drilling program recommended in the November 1994 report.

Between January 15, 1996 and December 30, 1996 Rupert Resources commenced the preparatory work involved in the underground diamond drilling program. Total expenditures to date are approximately 4200,000. This report summarizes the work completed, the current disposition of equipment on the property sets out the actual expenditures incurred during 1996.



3.0 List of mineral claims

Crown granted claims (Prince Rupert Land Title Registry)

<u>Claim Name</u>	<u>Lot No.</u>
Bee	1915
Bench	35
Bluebell	2485
Bluff	34
Cassie	228
DLS	31
Excelsior	9
Granite	1916
Gulch	33
Independence Fr.	222
La Quivree	39
Lake Fr.	32
Lakeview	229
Marcia	2484
Mountain Fr.	37
Olive	227
Princess Royal	7
Sadie	8
Sea Fr.	1914
Twin Peaks	38
UTA Fr.	36

Recorded mineral claims (Skeena Mining Division)

<u>Claim Name</u>	<u>Record No.</u>	<u>Expiry</u>
Sea Anchor Fr.	1979	Jan.14/97
Summit	1980	Jan.14/97
Bonanza	1981	Jan.14/97
Anaconda	1982	Jan.14/97
Turner Fr.	1983	Jan.14/97
Homestake	1984	Jan.14/97
Seagull	1985	Jan.14/97
Little Tommy Fr.	1986	Jan.14/97
Brown Bear	1987	Jan.14/97
Sunlight Fr.	1988	Jan.14/97
Sea Lion	1989	Jan.14/97
Finn 1 Fr.	6329	Aug.25/97
PEH 2 Fr.	6330	Aug.25/97
PEH 1 Fr.	6331	Aug.25/97
RKB 2 Fr.	6332	Aug.25/97
RKB 1 Fr.	6333	Aug.25/97
Surf #1	5174	Feb.28/97
Surf #2	5175	Feb.28/97

4.0 Summary of work completed during 1996 in terms of mineral exploration, development or other potential disturbances.

On April 25, 1995 our firm, Ram Exploration Ltd. on behalf of Rupert Resources Ltd., made application to carry out a program of underground exploration work at the former Surf Inlet Mine. The proposed program involved approximately 50 meters of drill access crosscut development and diamond drilling from a station on the 900 mine level.

This program was permitted under Approval Number SMI-95-0100067-171 and Reclamation permit No: MX-1-447.

During October and November 1995 a 5 man crew carried out the following work on the site: construction of lake barging system (for details refer to memo no.4); clearing of alders and fallen logs on the access road from Paradise Creek to the 900 level portal landing area; delivery of basic mining equipment, track, timber and fuel to the 900 level landing; and, clean-up and timbering inside the portal. At the end of November, Rupert Resources authorized the crew to clean-up the landing area at the dam site near the north end of Surf Inlet. Several rusted fuel tanks, numerous rusted barrels and garbage from various previous operations was loaded onto trucks and barged to Vancouver for disposal. Photographs of the material removed from the site are attached.

In March, 1996 we advised your office that Rupert Resources intended to complete the program outlined in the notice of work dated April 25, 1995. As a result of financing delays and various problems we were unable to commence work until September, 1996.

Our original plan involved rehabilitation of the 900 level from where work was stopped by the previous operators in 1988 (station 6200N) to the end of the existing drift (station 6775N). A copy of the drift plan is included as part of section 5.0 which outlines the proposed ventilation system. We then proposed to drive a drill access crosscut tunnel approximately 50 meters in length.

During October and November of 1996, a 3 man underground crew continued the rehabilitation work on the 900 level. Clean-up from the portal to station 6200N (approximately 2,000 feet) involved only minor work however the stoped area between station 6250N and 6375N required extensive timbering. As shown on the attached plan we had initially planned to use the existing drift between station 6400N and 6500N however, on closer inspection our shift supervisor, Mr. Aichmeier, elected to bypass this stoped area by driving a short section of drift designed to break into the old drift immediately after the stoped section.

In a letter dated December 03, 1996 we advised your office that we were only able to partially complete the work involved in our proposed cross cut and diamond drill program.

A.

As indicated on our progress summary dated December 03, 1996 conditions required that a bypass drift be constructed around an old stope from station 6400N to station 6475. The majority of the work involved in the bypass drift has been completed however rehabilitation and retracking of this drift is still required between station 6475 and station 6775 prior to construction of the proposed drill crosscut.

Muck disposal for the bypass drift was as outlined in our application, partial disposal underground and partial disposal on the portal landing dump.

Prior to demobilization of the crew at the end of December, the portal was securely closed and crews transported additional fuel and track supplies to the landing.

A detailed listing of the equipment and supplies left on site is attached as memo no.2.

5.0 List of all equipment and supplies currently on site.

This section provides a summary of the equipment and supplies at each of the principal locations within the project area. Each location is numbered to match the location map attached to this section.

Location No.1: Access road from Surf Inlet to Cougar Lake

- 1981 Ford 5 ton flat deck (crane equipped)
- 1980 Ford 5 ton flat deck
- 1980 Ford 3/4 ton flat deck 4wd.
- 1976 Ford 3/4 ton crew cab 4wd.
- 1979 Chevrolet 3 ton van w/ hydraulic lift
- 1964 Chevrolet 2 ton flat deck
- utility camper trailer
- lumber and miscellaneous supplies
- approx. 40 pallets from fuel and auxilliary equipment
- approx. 100 pc. 2" galvanized pipe
- approx. 30 pc. 6" underground air service pipe

Location No.2: Cougar lake loading site

- floating platform and access ramp

Note: This platform is 15' x 25' in size and is constructed from galvanized steel with 45 gallon plastic barrels for floatation. During November, as a result of logging operations carried out by third parties, a large diameter log became jammed below our floating platform. Before leaving the site in December, 1996 our personnel secured the platform for the winter and we propose to remove the trapped log and repair damages immediately upon our return to the site.

Location No.3: Bear Lake loading site at Paradise Creek

- storage shed approx 6' x 10'
- floating platform and access ramp similar to equipment at Cougar Lake
- auxilliary 15' x 25' platform for use as lake barge
- 20' aluminum work boat equipped with 70 hp. Evinrude outboard
- asst'd lumber and building supplies
- 1976 Chevrolet Blazer 4wd
- tandem axle equipment trailers (2)

Location No.4: Surf Project camp and crew accommodations

- camp area consists of 8 Atco trailers  
(see attached photographs)
- 10 drums of furnace oil are stored approximately 100' from the bunkhouse
- 30 100 lb. propane bottles are stored approximately 100' from the diner

Note: The trailer camp is located between the Surf mine and the Pugsley mine. An additional trailer located approximately 300' north of the main camp was damaged by a storm during 1992 and will be disposed of as part of the current program.

Location No.5: Surf mine 900 level landing area

The Surf 900 level landing area is where the mining equipment, track, timber and diesel fuel supplies are stored. There is a small shop for dry storage (approximately 10' x 14') and we plan to construct a snow-roof style cover over the compressors.

Consumable supplies

- portal secured and track installed in portal landing area
- 2 tons 20lb. steel rail
- approx. 2,000 b.f. asst'd lumber and supplies
- 2 pallets shotcrete bags
- 75 45 gallon drums diesel fuel
- asst'd couplings, fittings, hoses
- asst'd

Mining equipment

- 1986 LeRoi 375 c.f.m. compressor
- 1978 Gardiner Denver 175 c.f.m. compressor
- Mancha 1.5 ton electric locomotives (2)
- Eimco 12B muck machine
- muck cars (7)
- Eimco double drum slushers (2)
- asst'd pumps, air drills, hoses etc.

Location No.6: Pugsley mine 900 level landing area

- portal secured and track installed in landing area

Note: No equipment or supplies presently stored at this site.

6.0 Statement of costs for the period August 15, 1996 to December 30, 1996

Prin	A1:IV16384			GST Calculation	
prin	A1:IV16384				
Gra	3:D293				
	520 - 470 Granville Street				
	Vancouver, B.C. V6C 1V5				
	<b>Project: Surf Inlet</b>				
	<b>Statement of Costs</b>				
	<b>Summary of suppliers invoices (excluding GST)</b>				
<b>1.</b>	Float aircraft support				
	Mid Coast Air, Invoice dated 9/26/96		\$690.00		
	Mid Coast Air, Invoice dated 11/14		\$800.00		
	Mid Coast Air, Invoice dated 11/15		\$575.00		
	Pacific Coastal Airlines, Invoice dated 9/20/96		\$1,382.61		
	Pacific Coastal Airlines, Invoice dated 9/20/96		\$1,312.50		
	Pacific Coastal Airlines, Invoice dated 9/26/96		\$7,630.02		
	Pacific Coastal Airlines, Invoice dated 10/09/96		\$1,312.50		
	Pacific Coastal Airlines, Invoice dated 10/16/96		\$1,907.50		
	Pacific Coastal Airlines, Invoice dated 10/25/96		\$1,907.50		
	Pacific Coastal Airlines, Invoice dated 11/01/96		\$1,907.50		
	Pacific Coastal Airlines, Invoice dated 11/12/96		\$1,312.50		
	Pacific Coastal Airlines, Invoice dated 11/19/96		\$1,907.50		
	Pacific Coastal Airlines, Invoice dated 12/03/96		\$2,167.50	\$24,812.63	\$1,623.26
		sub-total	\$24,812.63		
<b>2.</b>	Equipment maintenance and repair				
	Auto Wrecking		\$422.65		
	Christopher, Invoice #E101596		\$2,703.30		
	Canadian Tire		\$950.72		
	Imperial Motorcycles		\$41.68		
	Independent Diesel, Invoice #96-03309		\$1,256.66		
	Honda Centre, Invoice# 1355		\$45.95		
	KBC Tools		\$60.17		
	KS Maude, Invoice #11431		\$1,285.17		
	KS Maude, Invoice #11541		\$90.43		
	Kirk Auto, Invoice #462869-001		\$246.67		
	Lordship Marine		\$186.34		
	Napa Auto Parts		\$303.48		
	Nelson Machinery & Equipment, Invoice #7672		\$455.82		
	Nelson Machinery & Equipment, Invoice #7684		\$407.67		
	Nelson Machinery & Equipment, Invoice #7739		\$137.17		
	Nelson Machinery & Equipment, Invoice #7737		\$12.50		
	Nelson Machinery & Equipment, Invoice #7736		\$16.05		
	Nelson Machinery & Equipment, Invoice #7779		\$85.30		
	Nelson Machinery & Equipment, Invoice #7761		\$48.70		
	Nelson Machinery & Equipment, Invoice #7752		\$314.58		
	Nelson Machinery & Equipment, Invoice #7869		\$51.09		
	Nelson Machinery & Equipment, Invoice #7888		\$0.00		
	Nelson Machinery & Equipment, Invoice #7891		\$529.23		
	Nelson Machinery & Equipment, Invoice #7784		\$17.45		
	Nelson Machinery & Equipment, Invoice #7783		\$132.68		
	Nelson Machinery & Equipment, Invoice #7752		\$394.56		
	Nelson Machinery & Equipment, Invoice #7825		\$19.95		

Nelson Machinery & Equipment, Invoice #7824		\$9.35		
North Island Marine Centre, Invoice #103146		\$247.82		
North Island Marine Centre, Invoice #102918		\$756.19		
Paquin, Gerry, Engine Repair		\$1,950.00		
Paquin, Ronnie, Invoice #E112696		\$810.34		
Point Grey, Invoice #7885		\$510.18		
Port Hardy Auto Parts, Invoice dated 9/26/96		\$107.72		
Port Hardy Auto Parts, Invoice dated 10/7/96		\$19.97		
Port Hardy Auto Parts, Invoice dated 10/15/96		\$42.54		
Port Hardy Auto Parts, Invoice dated 10/15/96		\$147.31		
Port Hardy Auto Parts, Invoice dated 10/18/96		\$98.83		
Port Hardy Auto Parts, Invoice dated 10/24/96		\$349.49		
Port Hardy Auto Parts, Invoice dated 11/6/96		\$53.82		
Port Hardy Auto Parts, Invoice dated 11/23/96		\$709.53		
Port Hardy Marine, Invoice dated 10/31/96		\$102.21		
Summer Equipment, Invoice #36604		\$127.16	\$16,258.43	\$1,063.64
	sub-total	\$16,258.43		
Consumable Supplies - delivered to Bear Lake; Surf 900 portal				
(i) Fuel				
Aurora Charters, Invoice dated 10/24/96		\$1,719.63		
Aurora Charters, Invoice dated 10/29/96		\$1,366.83		
Chee - Chaa Enterprises, Invoice #E103196		\$260.64		
IGC Propane		\$105.00		
Kitasoo, Invoice #11260		\$520.00		
Petro Canada		\$111.87	\$4,083.97	\$285.88
	sub-total	\$4,083.97		
(ii) Field and camp supplies				
Fenwick Suppliers, Invoice dated 10/8/96		\$159.40		
Fenwick Suppliers, Invoice dated 10/24/96		\$240.80		
Fenwick Suppliers, Invoice dated 10/31/96		\$156.87		
Fenwick Suppliers, Invoice dated 11/13/96		\$237.13		
Fleck Brothers, Invoice dated 10/4/96		\$192.99		
Fleck Brothers, Invoice dated 10/4/96		\$27.40		
Fleck Brothers, Invoice dated 10/24/96		\$381.69		
Fleck Brothers, Invoice dated 10/29/96		\$110.47		
Fleck Brothers, Invoice dated 10/30/96		\$166.99		
Neville Crosby, Inc, Invoice #763901		\$37.45		
Neville Crosby, Inc, Invoice #769301		\$361.17		
Neville Crosby, Inc, Invoice #800401		\$239.95		
Neville Crosby, Inc, Invoice #867801		\$267.24		
Neville Crosby, Inc, Invoice #856301		\$267.50		
Neville Crosby, Inc, Invoice #875901		\$518.95		
Neville Crosby, Inc, Invoice #976801		\$1,452.89		
Neville Crosby, Inc, Invoice #969001		\$396.17		
Neville Crosby, Inc, Invoice #976802		\$8.95		
Northwest Wire Rop		\$643.65		
Ocean Construction Supplies		\$704.05		
Ono Trading		\$59.00		
Port Hardy Home Hardware, Invoice dated 9/6/96		\$38.46		
Port Hardy Home Hardware, Invoice dated 9/26/96		\$51.01		
Port Hardy Home Hardware, Invoice dated 10/15/96		\$79.09		
Port Hardy Home Hardware, Invoice dated 10/23/96		\$332.77		
Port Hardy Home Hardware, Invoice dated 11/12/96		\$225.96		
Port Hardy Home Hardware, Invoice dated 11/12/96		\$2.34		
Port Hardy Home Hardware, Invoice dated 11/15/96		\$39.61		

10.



Port Hardy Home Hardware, Invoice dated 11/15/96		\$43.61		
Port Hardy Home Hardware, Invoice dated 11/18/96		\$108.93		
Rite, Invoice#1480		\$15.56		
TruValue Hardware, Invoice dated 10/24/96		\$235.32		
TruValue Hardware, Invoice dated 10/31/96		\$32.09		
Weldco, Invoice #971018		\$356.20		
Weldco, Invoice #976002		\$318.53		
Weldco, Invoice #961583		\$14.50	\$8,524.69	\$557.69
	sub-total	\$8,524.69		
<b>(iii) Blasting Supplies</b>				
ICI Conex Explosives, Invoice #149117		\$58.60		
ICI Conex Explosives, Invoice #91096		\$10,545.99		
ICI Conex Explosives, Invoice #151125		\$88.28		
ICI Conex Explosives, Invoice #151124		\$1,198.94		
ICI Conex Explosives, Invoice #151123		\$70.00		
ICI Conex Explosives, Invoice #151122		\$110.00		
ICI Conex Explosives, Invoice #151275		\$110.00		
ICI Conex Explosives, Invoice #151274		\$1,161.40		
ICI Conex Explosives, Invoice #151273		\$476.11		
ICI Conex Explosives, Invoice #151208		\$39.00		
ICI Conex Explosives, Invoice #150451		\$110.00		
ICI Conex Explosives, Invoice #151956		\$220.00		
ICI Conex Explosives, Invoice #151957		\$110.00		
Paquin, Gerry, Blasting Supplies		\$880.00	\$15,178.32	\$992.97
	sub-total	\$15,178.32		
<b>(iv) Lumber</b>				
All Around Demolition Co		\$589.16		
Comox Builder's Supply		\$897.80		
Comox Builder's Supply, Invoice dated 10/23/96		\$99.48		
Fletcher Lumber, Invoice #180688		\$810.04		
Fletcher Lumber, Invoice #180689		\$213.47		
Lumberland, Invoice #273379		\$138.15	\$2,748.10	\$179.78
	sub-total	\$2,748.10		
<b>(v) Groceries</b>				
Giant Food, Invoice dated 10/24/96		\$378.94		
Giant Food, Invoice dated 10/31/96		\$92.16		
Overwaita, Invoice dated 9/19/96		\$346.23		
Overwaita, Invoice dated 9/25/96		\$522.89		
Overwaita, Invoice dated 9/26/96		\$397.29		
Overwaita, Invoice dated 9/27/96		\$463.97		
Overwaita, Invoice dated 10/6/96		\$385.05		
Overwaita, Invoice dated 10/15/96		\$406.51		
Overwaita, Invoice dated 10/15/96		\$343.39		
Overwaita, Invoice dated 10/24/96		\$1,208.19		
Overwaita, Invoice dated 10/29/96		\$64.30		
Overwaita, Invoice dated 10/30/96		\$4.01		
Overwaita, Invoice dated 10/31/96		\$33.73		
Overwaita, Invoice dated 11/11/96		\$76.06		
Overwaita, Invoice dated 11/12/96		\$2,079.68	\$6,802.40	\$34.01
	sub-total	\$6,802.40		
<b>Communications</b>				
Mobility Cellular, Oct 96		\$858.30		
Mobility Cellular, Nov 96		\$3,052.50		
Mobility Cellular, Dec 96		\$2,632.90	\$6,543.70	\$428.12
	sub-total	\$6,543.70		

<b>R</b>	<b>xploration, Ltd. miscellaneous expenses</b>			
(ii)	Freight	\$3,298.45	\$3,298.45	\$215.79
(iii)	Miscellaneous receipts - travel, taxi, hotel, etc.,	\$4,181.36		
	Miscellaneous receipts - van rental for crew travel, August 11 to December 3	\$1,140.00		
	Miscellaneous receipts - general liability insurance, July 24, 1996 to July 24, 1997	\$1,250.00		
	Miscellaneous receipts - Groceries, field supplies, camp supplies, etc.,	\$7,714.67	\$14,286.03	\$934.60
	sub-total	\$14,286.03		
	TOTAL	\$102,536.72		\$6,315.73

Ram Exploration, Ltd. field personnel for the period ending December 30, 1996				
Geological staff - actual wages plus holiday pay				
(i) Underground shift supervisor - Adolph Aichmeier August 1 to December 3, 1996			\$29,900.00	
Technical staff				
i) Aydon, Michael November 1 to 26, 1996 @ 150/d			\$4,056.00	
ii) Berry, Brock November 19 to December 3, 1996 @ 175/d			\$2,730.00	
iii) Berry, Christopher August 28 to December 3, 1996 @ 150/d - 175/d			\$16,718.00	
iv) Fleury, Andrea October 16 to November 11, 1996 @ 150/d			\$4,212.00	
v) Fleury, Rolland October 9 to November 19, 1996 @ 150/d - 175/d			\$7,462.00	
vi) Kerner, Beau August 11 to 28, 1996 @ 75/d			\$1,482.00	
vii) Paquin, Ronnie August 11 to November 30, 1996 @ 150/d - 175/d			\$11,441.04	
viii) Smith, Tony September 13 to November 19, @ 150/d			\$10,476.00	
	sub-total		\$88,477.04	\$6,193.39
Associated payroll expense				
i) UIC			\$1,457.96	
ii) CPP			\$1,227.66	
iii) WCB (payroll/sub-contractors @.07)			\$6,147.61	
	sub-total		\$8,833.23	\$618.33
	Total		\$97,310.27	\$6,811.72

**Summary of Ram Exploration Ltd. direct charges**

**See...ce equipment rentals for the period ending December 31, 1996**

Ford 18' flat deck @ \$250/mo.	\$750.00	
Ford crewcab with utility box @ \$250/mo.	\$750.00	
Chevrolet rear lift equipped 5 ton 14' van @ \$300/mo.	\$900.00	
Chevrolet 44x4 pick-up @ \$200/mo.	\$750.00	
utility box trailer @@@ \$250/mo.	\$750.00	
utility 12' flat trailer @ \$150/mo.	\$450.00	
utility 16' flat trailer @ \$150/mo.	\$450.00	
18' camper trailer @ \$150/mo.	\$450.00	
18' Raider aluminum skiff with cabin and 70 hp Evinrude @ \$1250/mo.	\$3,750.00	
45 gal. drum rentals; 101 units fuel delivery @ \$20/unit	\$2,020.00	
100 lb. propane tank rentals; 22 units propane delivery @ \$50/unit	\$1,100.00	
camp appliance rentals: washing machine, propane fridge, etc.	\$1,000.00	
equipment and industrial tooling:		
45 h.p. Mercury engines (2) @ \$250 ea./mo.	\$1,500.00	
7000 watt diesel generator @ \$350/mo.	\$1,050.00	
5000 watt Honda generator @ \$350/mo.	\$1,050.00	
55 h.p. Honda water supply pump @ \$150/mo.	\$450.00	
oxygen and acetylene tanks 2200 cu. ft.torches @ \$150/mo.	\$450.00	
1000' utility 1" Chicago coupling hoses @ \$100/mo.	\$300.00	
pallets, metal strapping and tooling @ \$75/mo.	\$225.00	
carpenters tool set @ \$200/mo.	\$600.00	
hoist, straps, slings, and utility equipment @@ \$200/mo.	\$600.00	
mechanics tool set @ \$200/mo.	\$600.00	
	sub-total	N/C
		\$0.00

**Mining equipment rentals for the period ending December 31, 1996**

Gardener Denver 175 c.f.m. compressor @ \$1500/mo.	\$4,500.00	
Le Roi 385 c.f.m. compressor \$\$\$ @ \$3500/mo.	\$10,500.00	
Mancha 11....55 ton trammer @ \$1675 /mo.	\$5,025.00	
40 volt battery @ \$250/mo.	\$750.00	
40 volt battery @ \$250/mo.	\$750.00	
40 volt battery @ \$250/mo.	\$750.00	
Eimco 12B muck machine @ \$1674/mo.	\$5,025.00	
1.25 ton muck car @ \$250. mo.	\$750.00	
1.25 ton muck car @ \$250. mo.	\$750.00	
timber car @ \$275/mo.	\$825.00	
Eimco double drum 10 h.p. slusher @ \$995/mo.	\$2,985.00	
Eimco double drum 10 h.p. slusher @ \$995/mo.	\$2,985.00	
slusher shovel @ \$250/mo.	\$750.00	
slusher shovel @ \$250/mo.	\$750.00	
jackleg drill @ \$390/mo.	\$1,170.00	
jackleg drill @ \$390/mo.	\$1,170.00	
stoper drill @ \$390/mo.	\$1,170.00	
stoper drill @ \$390/mo.	\$1,170.00	
ventilation fan 18" diameter @ \$175/mo.	\$525.00	
ventilation fan 18" diameter @ \$175/mo.	\$525.00	
receiver tank (internal) @ \$195/mo.	\$585.00	
Wilden air operated dewatering pump @ \$295/mo.	\$885.00	
C operated supply pump @ \$295/mo.	\$885.00	

14.

Remington air chainsaw w/spares @ \$295/mo.		\$885.00	
track jimcrow @ \$235/mo.		\$705.00	
ai s (6), valves, headers, etc. @ \$250/mo.		\$750.00	
man... 2", auxiliary air hoses @ \$250/mo.		\$750.00	
	sub-total	N/C	\$0.00
	Total	N/C	
<b>Total Statement of Costs</b>		<b>\$199,846.99</b>	<b>\$13,127.45</b>
GST on supplier invoices		\$6,315.73	
GST on equipment rentals and technical services		\$6,811.72	
	sub-total	\$13,127.45	
	<b>Grand Total</b>	<b>\$212,974.44</b>	

## 7.0 References

Freeze A.C. & Juras, S.

1981 COMPLAC Joint Venture, 1981 Termination Report. Private Report for Cominco Ltd., December 14, 1981. 12 pp.

Freeze A.C.

Exploration and Development Recommendations for the Surf Inlet Gold Project submitted to Fleet Developments Ltd., Vancouver, B.C. Consulting report prepared by Cominco Ltd. March 10, 1986. 12 pp.

Honsberger, J.C.

Report on the former Surf Inlet Consolidated Gold Mines Ltd. Property. Private report, Matachewan Consolidated Mines Ltd., July 20, 1973, 26 pp.

Gill, J.E. & Byers, A.R.

1948 Surf Inlet and Pugsley Mines in Structural Geology of Canadian Ore Deposits, Canadian Institute of Mining and Metallurgy, Special Volume., pp 99-104.

Magrum, M. & Burton, A.

Summary Report and Proposed Exploration Program. Surf Inlet Gold Project. Report dated May 10, 1993 as amended August 15, 1993 and September 24, 1993. Report included in Statement of Material Facts Number #82/94 dated November 1, 1994. 25 pp.

## 8.0 Certificate

I, CARL VON EINSIEDEL, do hereby certify that I am an independent Consulting Geologist with Ram Exploration Ltd. at 210 - 470 Granville St., Vancouver, B.C., V6C-1V5, Telephone No: (604) 649-5793

### I FURTHER CERTIFY THAT:

1. I am a geology graduate of the Carleton University of Ontario and am a registered Professional Geologist in B.C. with Certificate No.21474.
2. I have practised my profession for over 10 years as an independent consultant to junior mining companies in Canada and the United States.
3. I have reviewed published technical data regarding the Surf Inlet Property and I personally supervised the preparatory surveys completed during 1996.
4. I have no personal interest, directly or indirectly in the property or securities of Rupert Resources Ltd. nor do I expect to receive directly or indirectly any interest in such property or securities.
5. I give permission to Rupert Resources Ltd. to use this Report for underwriting purposes.

Dated this 14th day of April, 1997 in Vancouver, B.C.

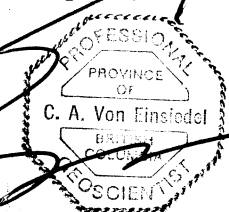
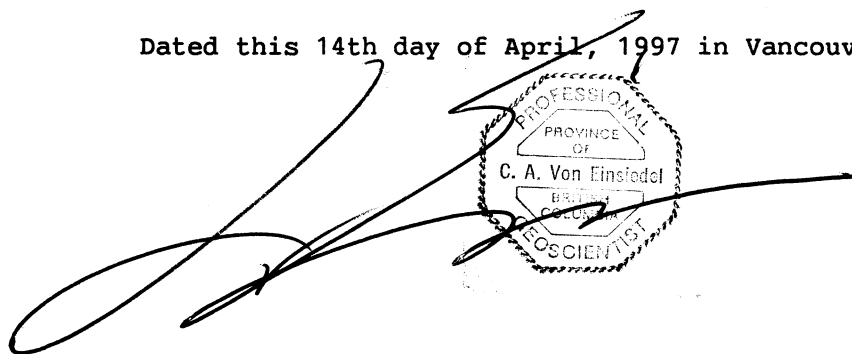

CARL VON EINSIEDEL, P.Ge.  
Consulting Geologist

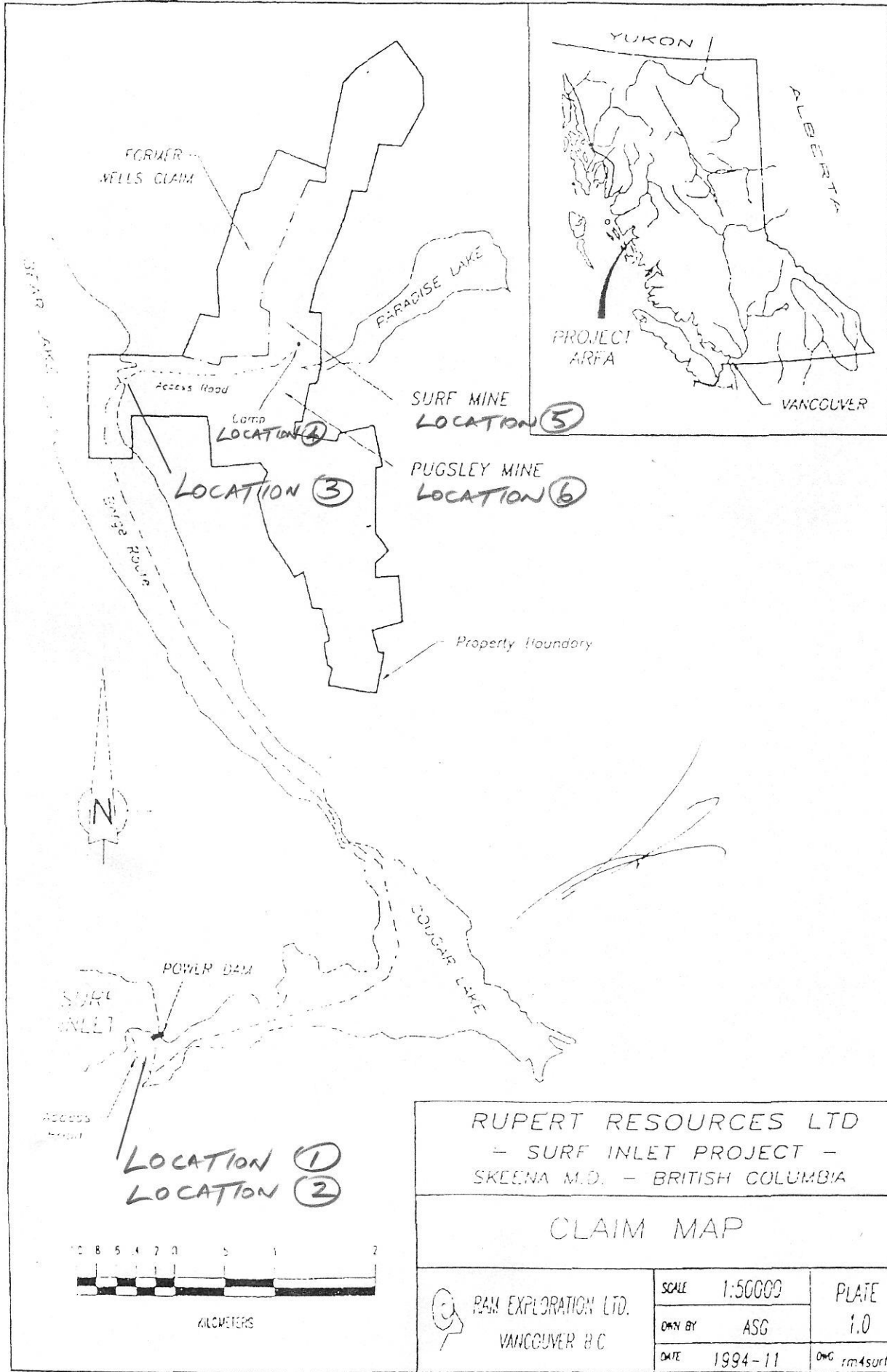

RUPERT RESOURCES LTD  
 - SURF INLET PROJECT -  
 SKEENA M.D. - BRITISH COLUMBIA

CLAIM MAP

 RAM EXPLORATION LTD. VANCOUVER B.C.	SCALE	1:50000	PLATE
	DRAWN BY	ASG	1.0
	DATE	1994-11	DWG



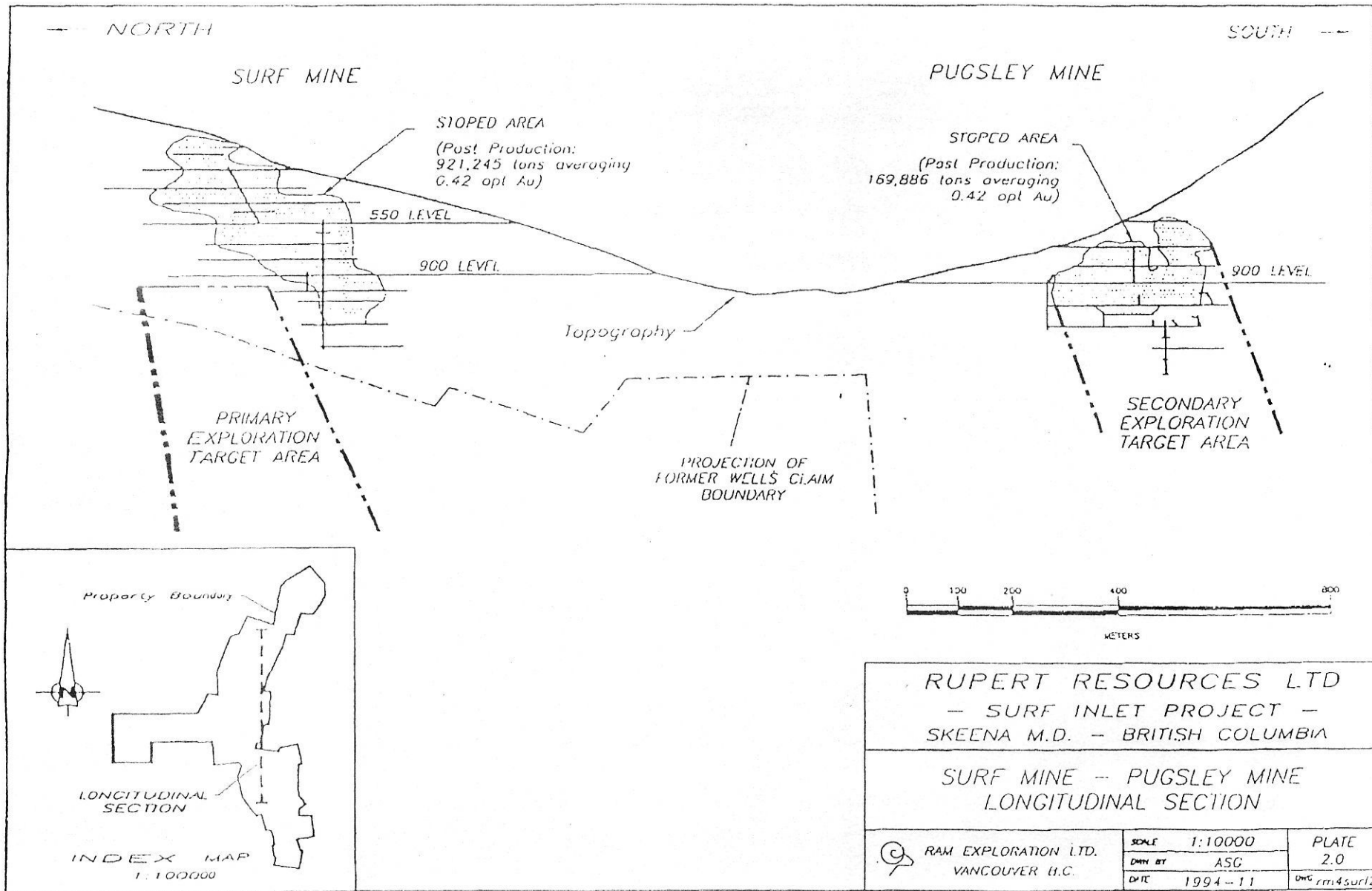

19.

--- NORTH

DRILLHOLE INTERCEPTS (1941--42)

(Reproduced from Vulimiri, 1986)

- narrow quartz stringers
- .16 opt Au / 0.5'
- qtz. py / 5.0'
- 0.26 opt Au / 1.7'
- 0.68 opt Au / 3.0'
- 0.19 opt Au / 10.0'
- sludge assay qtz. py
- 0.33 opt Au / 10.0'

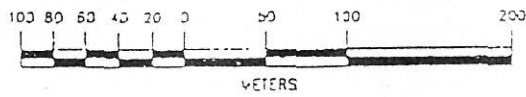
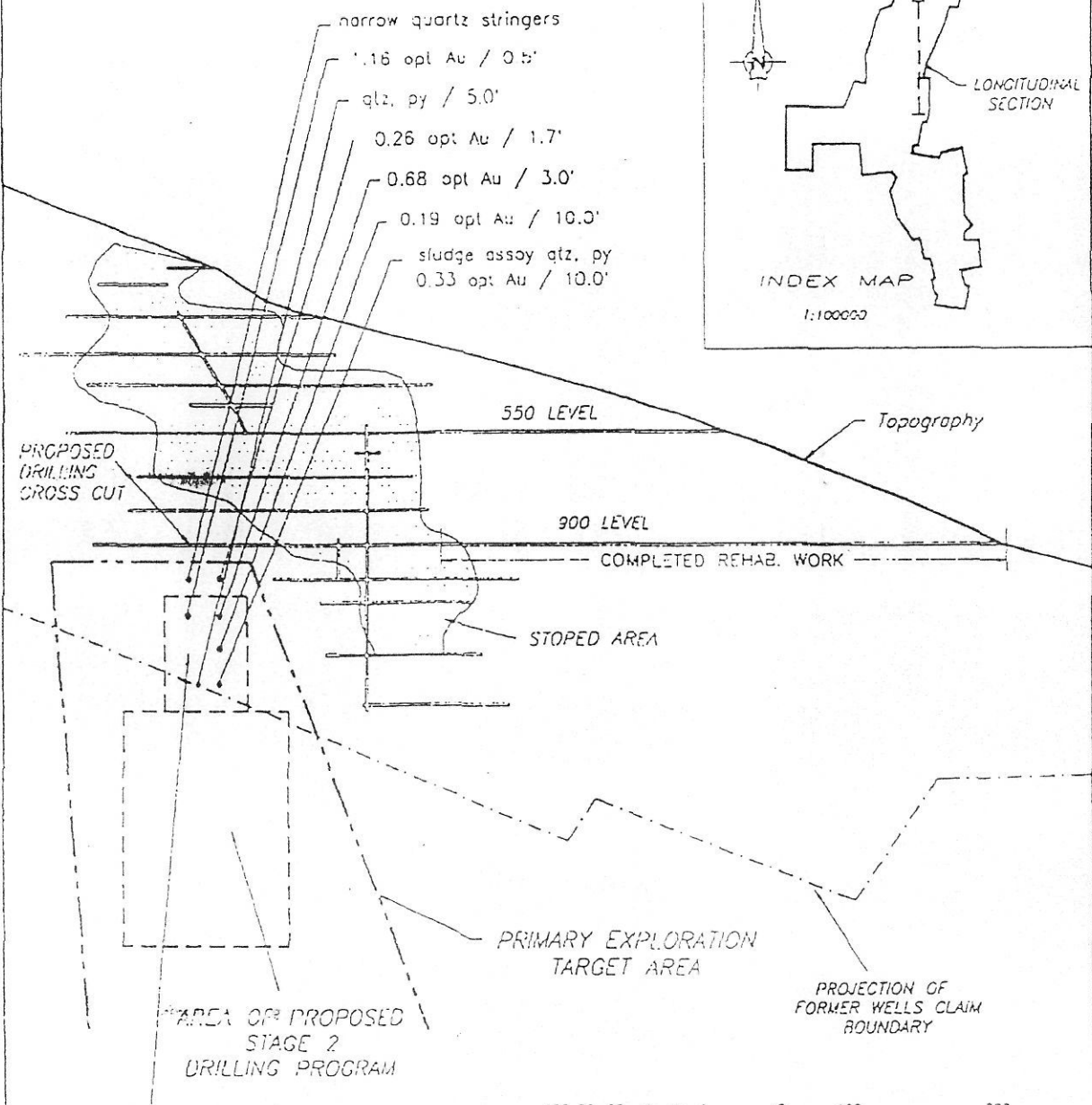
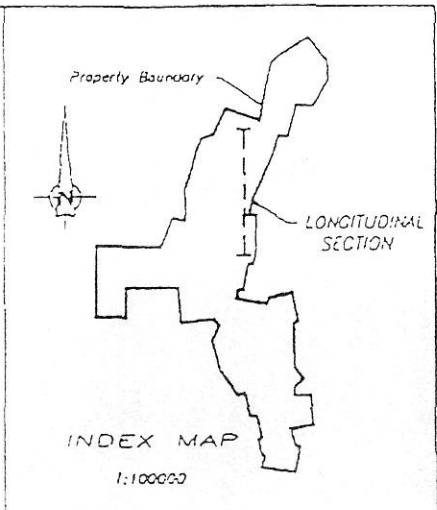

RUPERT RESOURCES LTD  
 - SURF INLET PROJECT -  
 SKEENA M.D. - BRITISH COLUMBIA

SURF MINE  
 LONGITUDINAL SECTION

 RAW EXPLORATION LTD. VANCOUVER B.C.	SCALE	1:5000	PLATE
	DRAWN BY	ASG	3.C
	DATE	1994-11	ONG rm4sur/3