

PLAN OF SURVEY OF PART OF EAST BOUNDARY OF JAN 3, MINERAL CLAIM, RECORD No. 6125 OMINECA MINING DIVISION

B.C.G.S. 94E.026

SCALE 1:5000

0 100 200 300 400 500 metres.

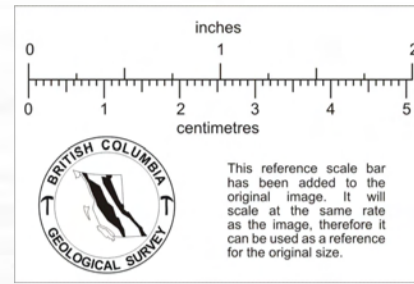

LEGEND:

Bearings are astronomic, derived by gyroscopic meridian observations and referred to the meridian through the legal corner post of Jock I and 5.

Distances shown are in metres and decimals thereof.

LCP denotes legal corner post

- PP denotes standard capped post set

- IP denotes standard iron post set

- △ TH denotes traverse station

- WT denotes witness

- C. denotes rock cairn

- MC denotes mineral claim.

Reference cairn is situated on a high flat topped hill

JAN 1
Located March 25, 1984
Record no. 6098

JAN 2
Record no. 6099
Located March 25, 1984.

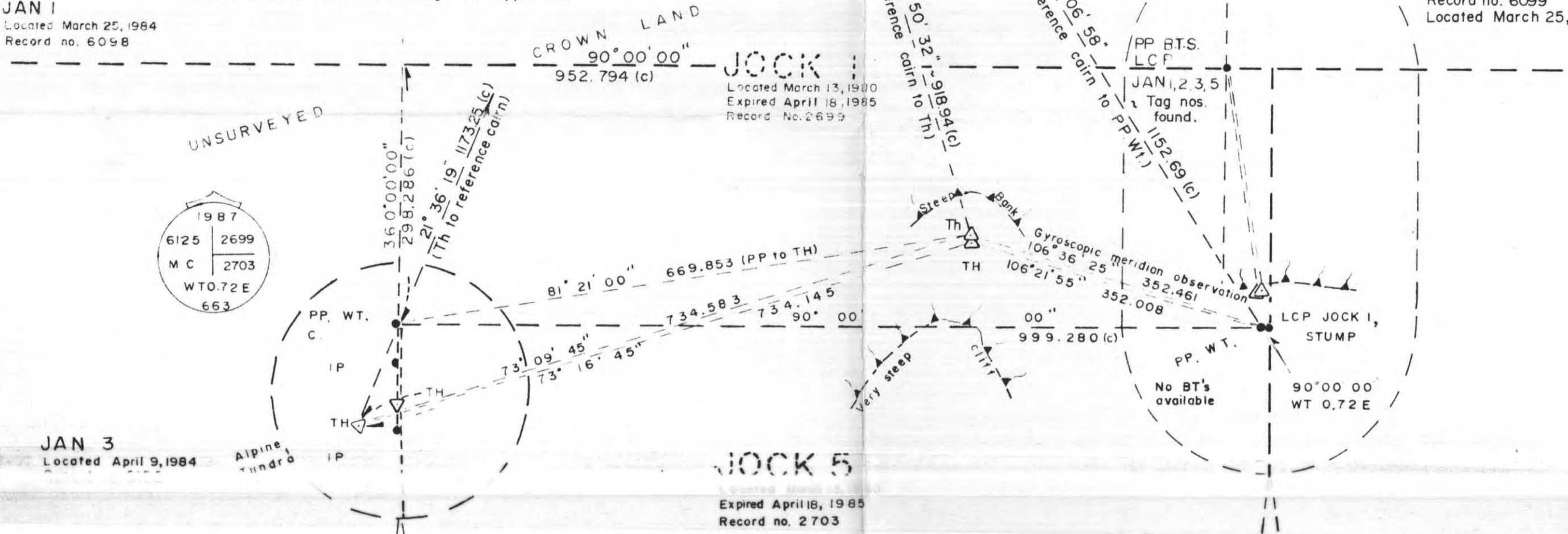

JAN 3
Located April 9, 1984

JOCK 5

Expired April 18, 1985
Record no. 2703

UNSURVEYED CROWN LAND

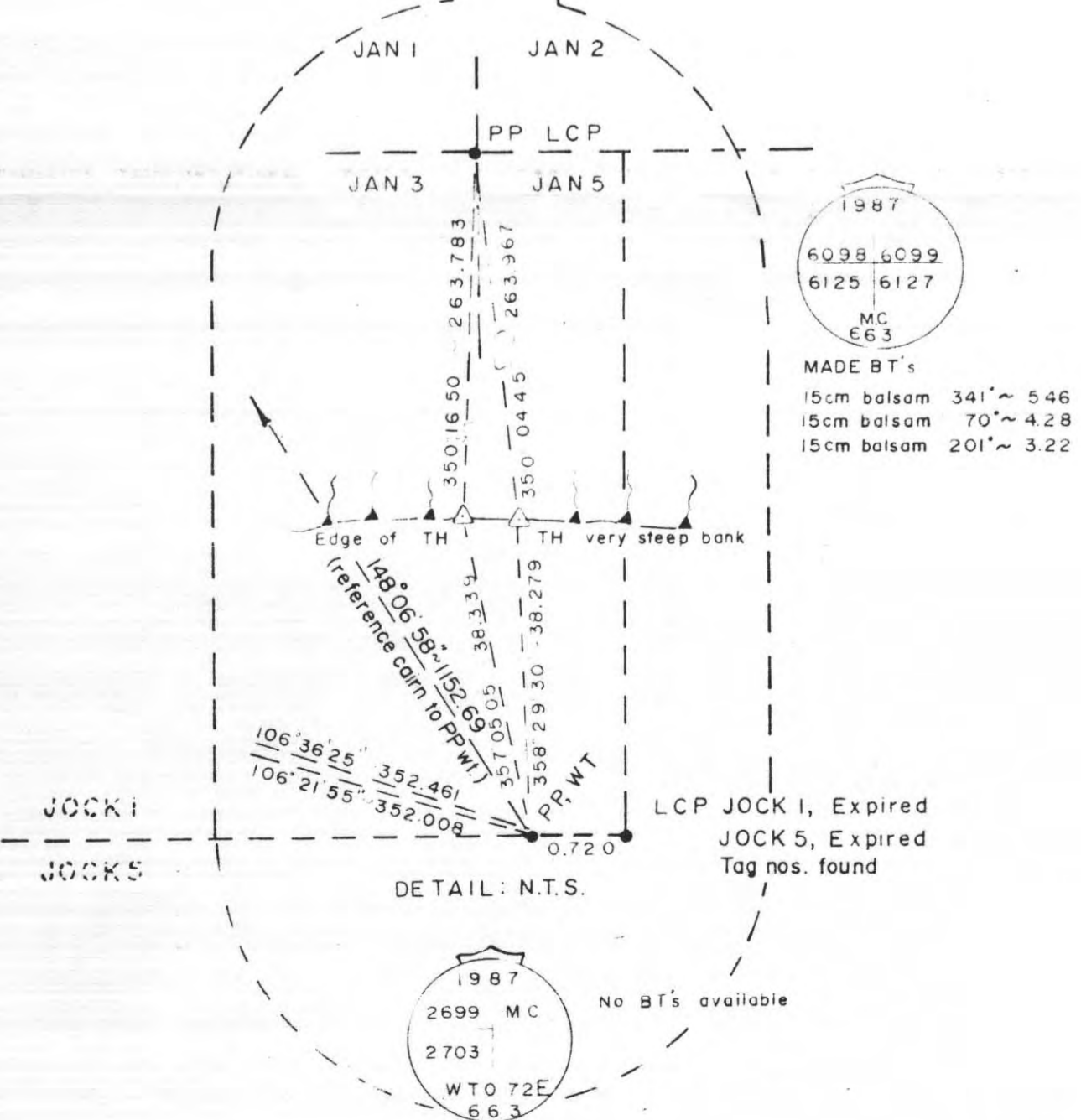
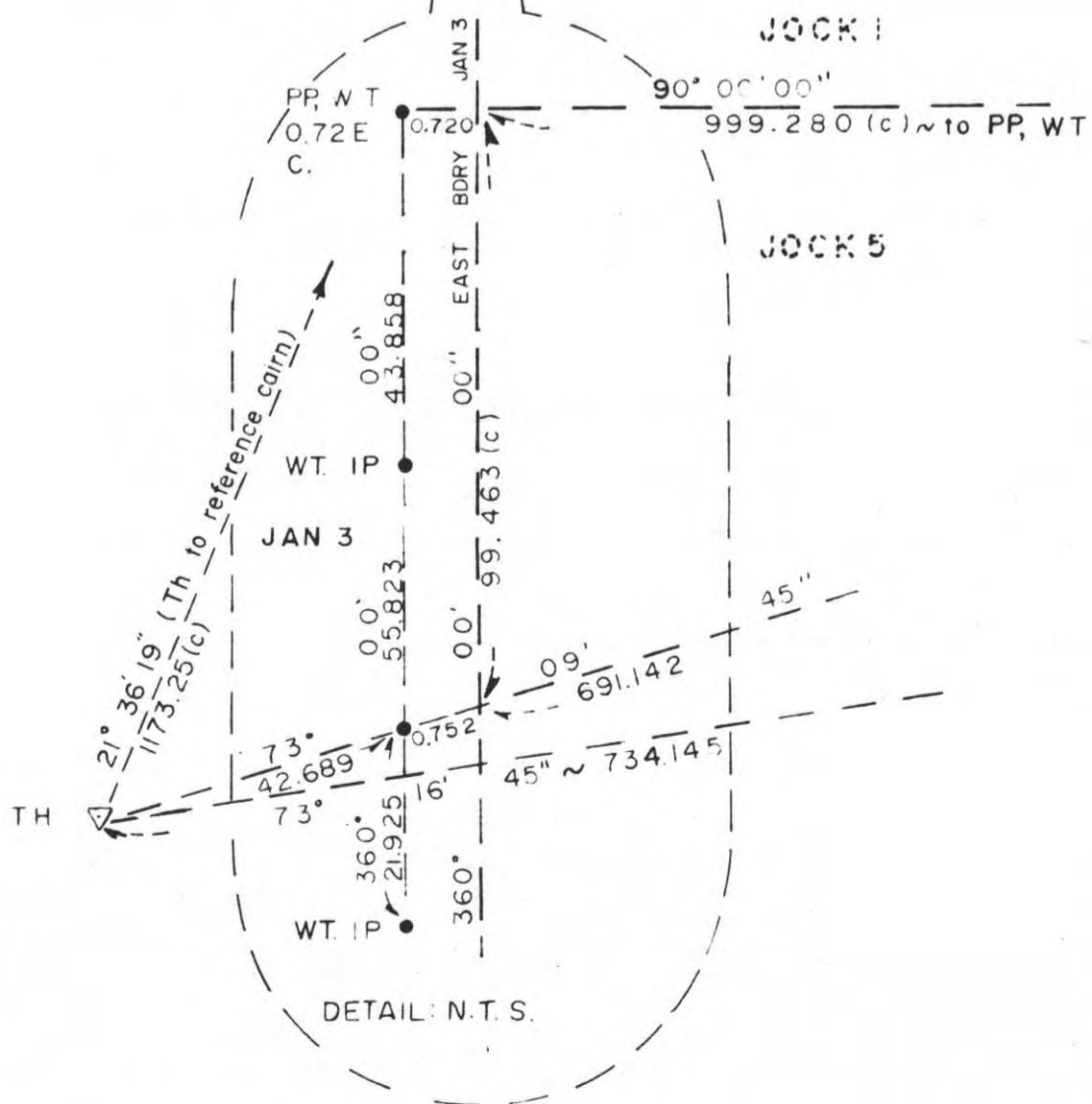

I, Anthony A. de Bruyne, a British Columbia Land Surveyor of Smithers in British Columbia certify that I was present at and personally superintended the survey represented by this plan and that the survey and plan are correct.

The survey was completed on the 16th day of September, 1987.

Anthony A. de Bruyne, B.C.L.S.

AA de BRUYNE
BC Land Surveyor
P.O. Box 486, Smithers
Job # 87-119

016902