

Moosehorn Creek Groupe	
M7	T. Allan
M6	H.A. Reid
M5	Johnny Bob
M4	J.A. Broley
M3	P.E.R. Williams
M2	T.H. Nicholson
M1	G. Mel. Bell

McLaren Creek Groupe	
A	C.W. Piersdorff
A1	J.W. Blatchford
A2	J. Standridge
A3	J.J. O'Connor
A4	E.R.R. Field
A5	E.E. Silverwood
A6	M.S. Hutchinson
A7	A. Rankin
AB	K. Cunningham
A9	T.H. Nicholson
PB	L. Mulvany
PB1	G. Smith
PB2	A.J. MacCormack
PB3	D. Stinton
PB4	J.J. O'Connor
PB5	M. Phillips
PB6	Bob Abestie
PB7	G.W. McLaren

Two Brothers River Groupe - Leases and Filings of 1934 - Approx. 80 Acres each					
T.B.1	Garfield Smith	T.B.18	Henry John	T.B.37	Albert T. Dodge
2	G.W.G. MacConachie	20	Jim Dennis	38	A. Cunningham
3	R.M. Halperny	21	G. Mel. Bell	39	Fred Abbott
4	T.H. Nicholson	22	Grace Holman	40	R.J. MacCormack
5	J.S. Peppard	23	Bob Abesti	41	C.L. Dodge
6	D. Stinton	24	N.S. Smith	42	H.J. Broley
7	J. Benson	25	J.A. Broley	43	H.A. Reid
8	Johnny Bob	26	Wm McCool	44	P.E.R. Williams
9	Jim Moyez	27	Maro Phillips	45	T. Allan
10	E.R.R. Field	28	H.S. Harris	46	T. Aitken
11	E.E. Silverwood	29	P. McCool	47	R.M. Halperny Jr.
13	M.S. Hutchinson	30	G. Max. Bell	48	B. Marshall
12	J.W. Blatchford	31	M. Cunningham	49	Leon Dennis
14	C.W. Piersdorff	32	L. Mulvany	50	E.A. Broley
15	Garclon Bell	33	J.W. Adair	51	Peter Dennis
16	B. Phillips Est.	34	J. Standridge	52	G.W. McLaren
17	H.A. Bell	35	Hazel E. Young	53	O. Lundberg
18	Alex Jack	36	J.J. O'Connor	54	N. McCallum

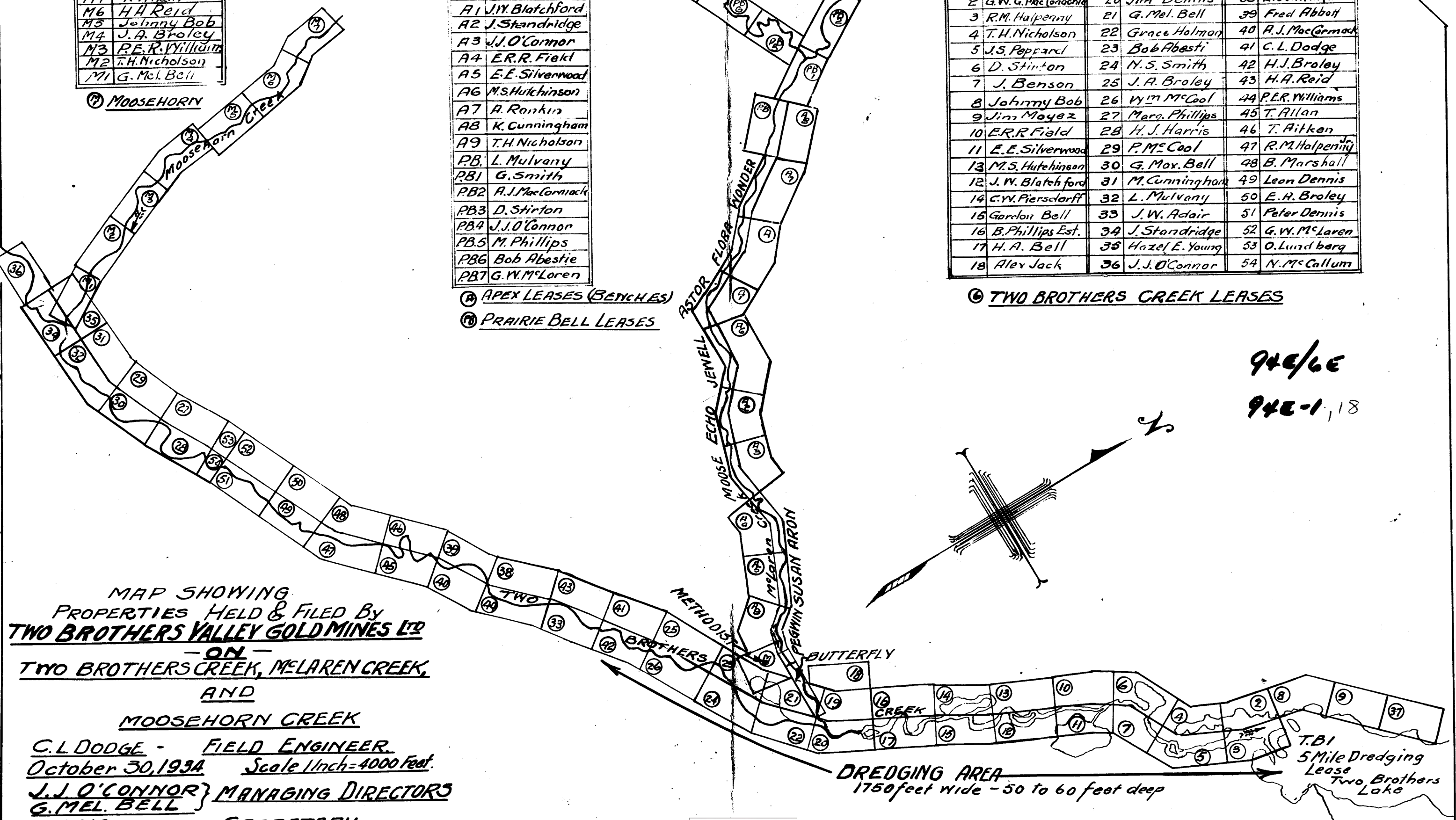

Ⓜ MOOSEHORN
 Ⓜ APEX LEASES (BENCHES)
 Ⓜ PRAIRIE BELL LEASES

Ⓜ TWO BROTHERS CREEK LEASES

94E/6E
 94E-1, 18

MAP SHOWING
 PROPERTIES HELD & FILED BY
TWO BROTHERS VALLEY GOLD MINES LTD
 - ON -
 TWO BROTHERS CREEK, McLAREN CREEK,
 AND
 MOOSEHORN CREEK
 C.L. DODGE - FIELD ENGINEER.
 October 30, 1934 Scale 1/4 inch = 4000 Feet.
 J.J. O'CONNOR } MANAGING DIRECTORS
 G. MEL. BELL }
 H.V. O'CONNOR SECRETARY

