

093N 153

016343

May 22nd, 1975.

Kennco Explorations (Western)
Limited,
505 Burrard Street, Suite 730,
One Bentall Centre,
Vancouver, B. C.
V7X 1M4

Dear Sirs:

Re: Germ No. 1-17 and Baldy No. 1-10
Record Nos. 130611-27, 130601-10
Omineca Mining Division

Thank you for your letter dated May 16th, 1975,
and the information submitted pursuant to Section 52 of
the Mineral Act with respect to the above noted mineral
claims.

Yours very truly,

R. Rutherford,
Deputy Chief Gold Commissioner.

*bc

KENNCO EXPLORATIONS (WESTERN) LIMITED

505 BURRARD STREET, SUITE 730

ONE BENTALL CENTRE

VANCOUVER, B.C. V7X 1M4

MAY 21 '75 AM

May 16th, 1975

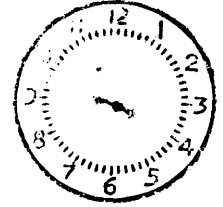

**DEPT. OF MINES
AND PETROLEUM RESOURCES**

Chief Gold Commissioner,
Department of Mines & Petroleum Resources,
Parliament Buildings,
Victoria, B.C.

Dear Sir: Re: GERM & BALDY Claims - Omineca M.D., B.C.

Pursuant to Section 52(2)(b) of the Mineral Act on submitting a report of the exploration and development carried out on a mineral claim that has been abandoned or allowed to lapse, I hereby advise you of our forfeiture of the following two claim groups; namely, the Germ claims located south of Germansen Lake on June 16, 1974, and the Baldy claims located five miles southeast of Germansen Lake on June 20, 1974. Both claim groups consisting of seventeen and ten claims, respectively, expire on July 3, 1975.

5812

The exploration work carried out in 1974 consisted of rock chip sampling on the Germ claims (12 samples) and detailed soil sampling on the Baldy claims.

Enclosed are a claim schedule and maps showing claim locations and sample sites.

I trust this meets with the necessary requirements of Section 52(2)(b) of the Mineral Act.

Yours very truly,

V. Ryback-Hardy

V. Ryback-Hardy
Geologist

INITIALS	DATE	INITIAL
D.M.		
ADM (M)		
ADM (P)		
C.C.C.	✓	
C.P.R.	✓ 2/15	R
DEED		
ACCR		
GEN.		
ASSTS.		
W.C.L.	✓ N. Carter	VRH/fh MCTS.
M.S.P.		
M. DEV.		
ED. & P.		
	hc 2/15 12.6	
FILE NO.		
CLERK		

[Handwritten initials]

Germ Claims

<u>Claim</u>		<u>Record No.</u>	<u>Tag No.</u>	<u>Date Staked</u>	<u>Date Recorded</u>
Germ No.	1	130611	304337M	June 16/74	July 3/74
	2	130612	304338M	June 16/74	July 3/74
	3	130613	304339M	June 16/74	July 3/74
	4	130614	304340M	June 16/74	July 3/74
	5	130615	304305M	June 16/74	July 3/74
	6	130616	304310M	June 16/74	July 3/74
	7	130617	304341M	June 16/74	July 3/74
	8	130618	304342M	June 16/74	July 3/74
	9	130619	304343M	June 16/74	July 3/74
	10	130620	304344M	June 16/74	July 3/74
	11	130621	304345M	June 16/74	July 3/74
	12	130622	304346M	June 16/74	July 3/74
	13	130623	304347M	June 16/74	July 3/74
	14	130624	304348M	June 16/74	July 3/74
	15	130625	183500M	June 21/74	July 3/74
	16	130626	459552M	June 21/74	July 3/74
	17	130627	459553M	June 21/74	July 3/74

Baldy Group

Baldy No.	1	130601	459542M	June 20/74	July 3/74
	2	130602	459543M	June 20/74	July 3/74
	3	130603	459544M	June 20/74	July 3/74
	4	130604	459545M	June 20/74	July 3/74
	5	130605	459546M	June 20/74	July 3/74
	6	130606	459547M	June 20/74	July 3/74
	7	130607	459548M	June 20/74	July 3/74
	8	130608	459549M	June 20/74	July 3/74
	9	130609	459550M	June 20/74	July 3/74
	10	130610	459551M	June 20/74	July 3/74

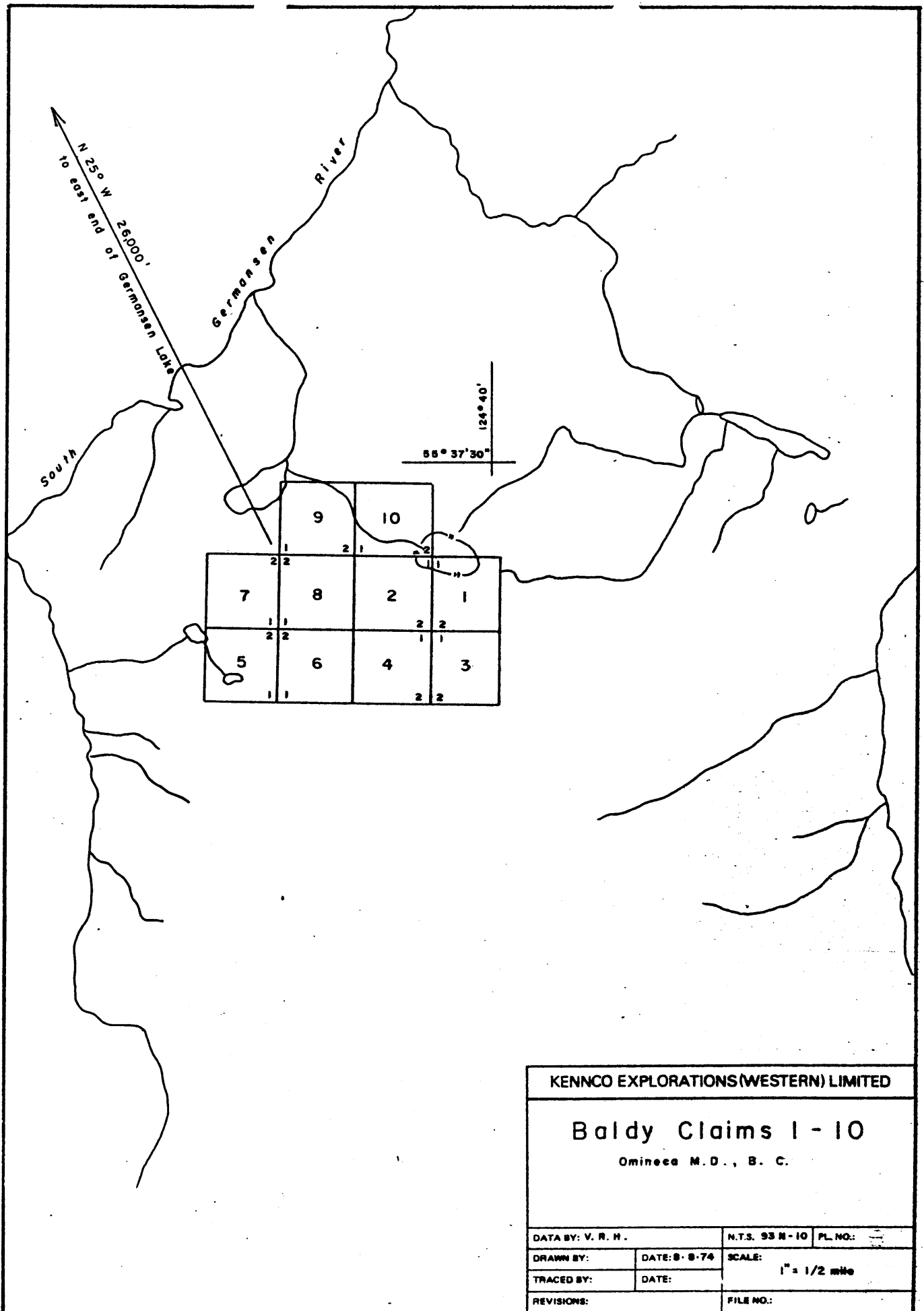

Fig-8

Bal Claims
Omineca M.D., B.C.

**Silt & Soil Sample Sites
in Silt and Soil**

DATA BY V.R.H.	DATE 22-8-74	SCALE 1" = 400'
DRAWN BY	DATE	FILE NO.
TRACED BY		
REVISIONS		

METAL VALUES IN P.P.M.

LEGEND

- Silt sample
- Soil sample line
- Swamp

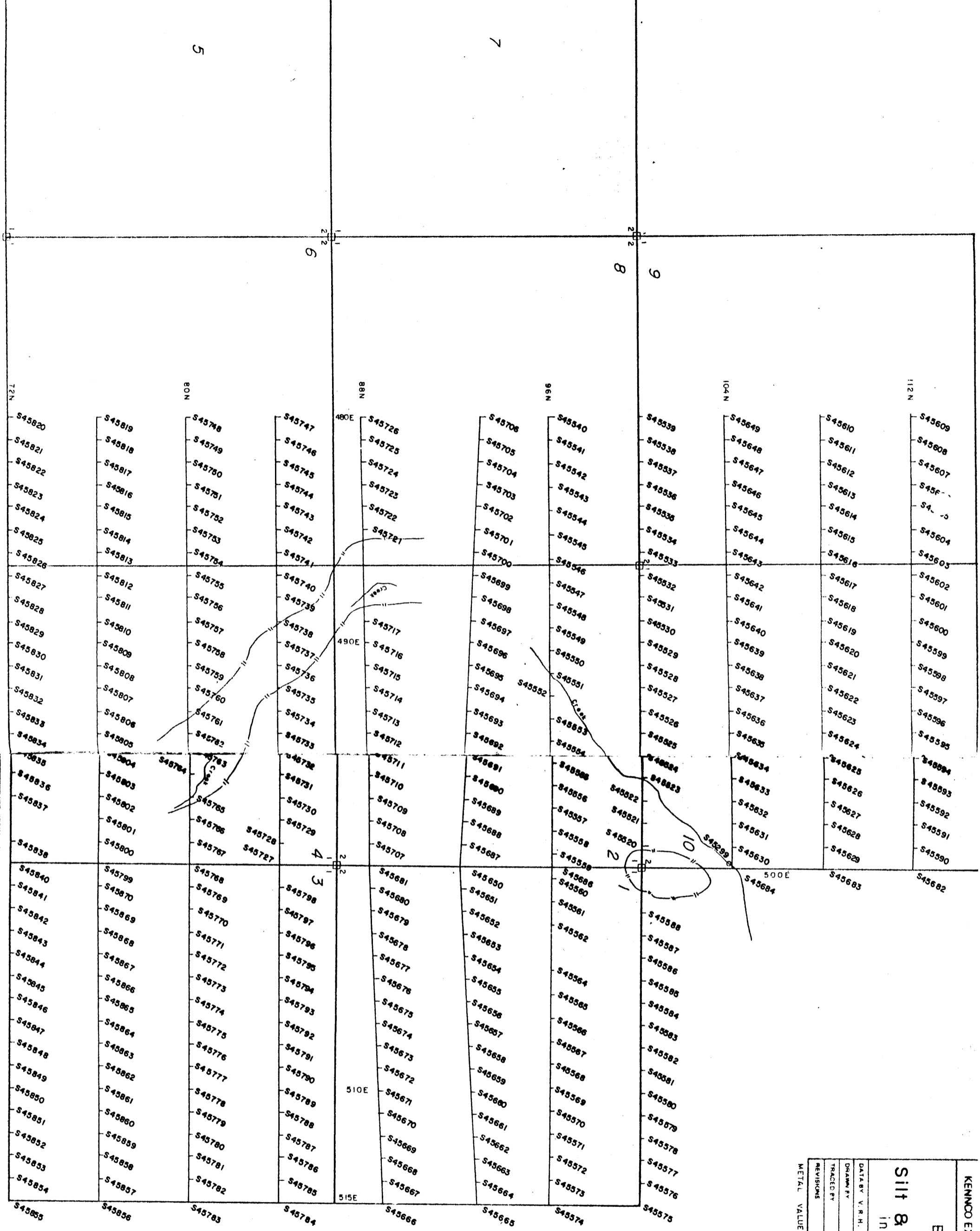
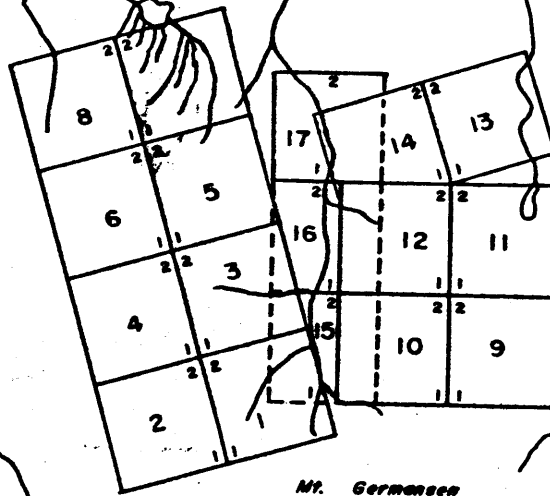

Fig. 3

Germansen Lake

125° 50'

55° 40'



Mt. Germansen

KENNCO EXPLORATIONS (WESTERN) LIMITED

Germ Claims 1-17

Omineca M. D., B. C.

DATA BY: V. R. H.		N.T.S. 93 N - 12	PL. NO.:
DRAWN BY:	DATE: 8-8-74	SCALE: 1" = 1/2 mile	
TRACED BY:	DATE:		
REVISIONS:	FILE NO.:		

Fig. 19

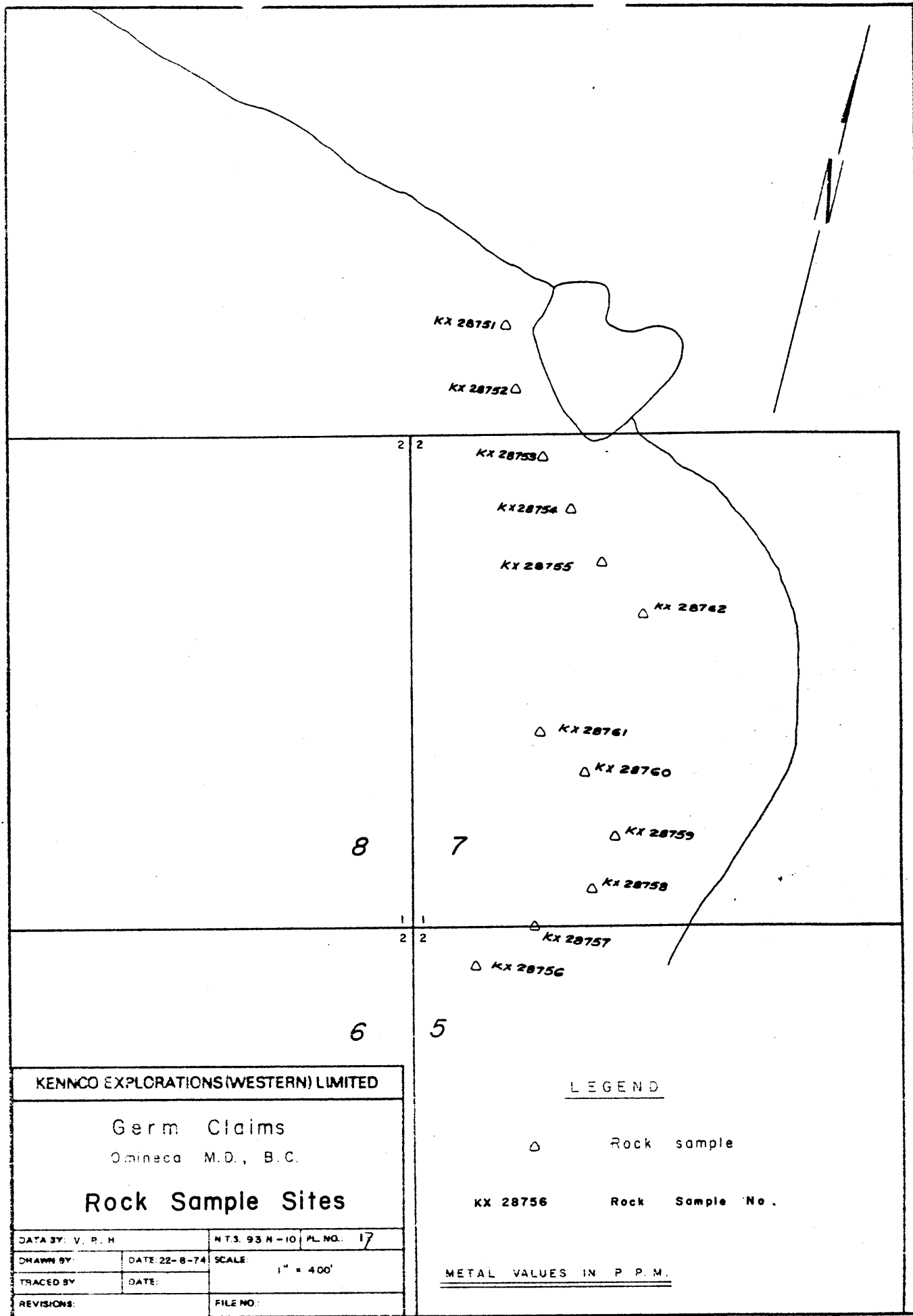

KENNCO EXPLORATIONS (WESTERN) LIMITED

Germ Claims
Omineca M.D., B.C.

Rock Sample Sites

DATA BY: V. R. H.	N.T.S. 93 N-10	PL. NO. 17
DRAWN BY:	DATE: 22-8-74	SCALE: 1" = 400'
TRACED BY:	DATE:	
REVISIONS:	FILE NO.:	

LEGEND

△ Rock sample

KX 28756 Rock Sample No.

METAL VALUES IN P.P.M.

Fig 15