

016139

Contours

1	---
2	---
3	---
5	---
7	---

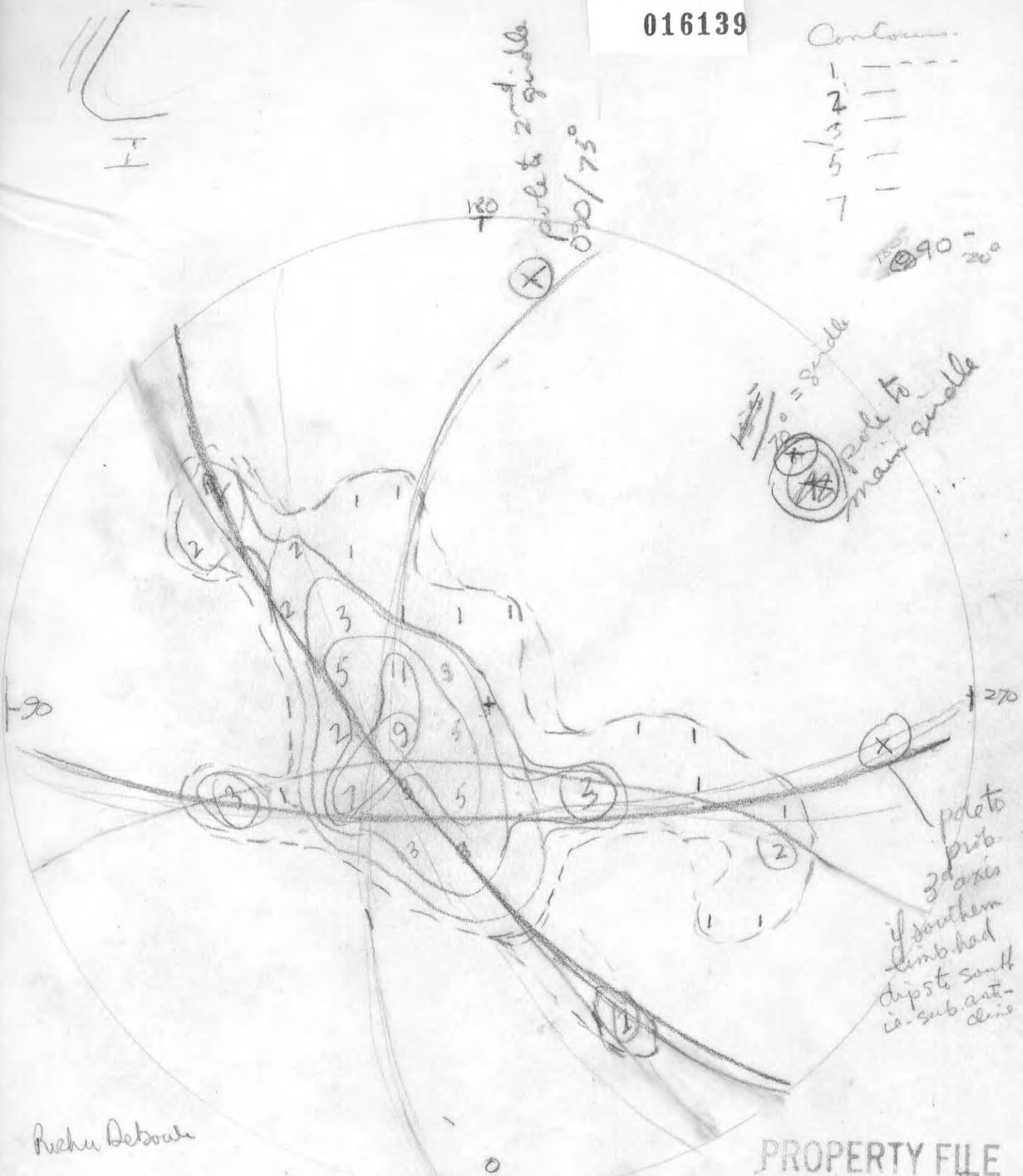

Richard DeSousa

Statistic Study of bedding attitudes (3 attitudes per $2\frac{1}{2}$ ft
 i.e. ca. 3 miles x $1\frac{1}{2}$ miles). Poles plotted. 3 girdles?

PROPERTY FILE

71
 93M072-06

Stereoscopic projection of poles to bedding at
Rocher Desrochers, (with 3 attitudes over $2\frac{1}{2}$ square
or ^{app} 4 square miles) - Material for next figure, which
is only contoured roughly.

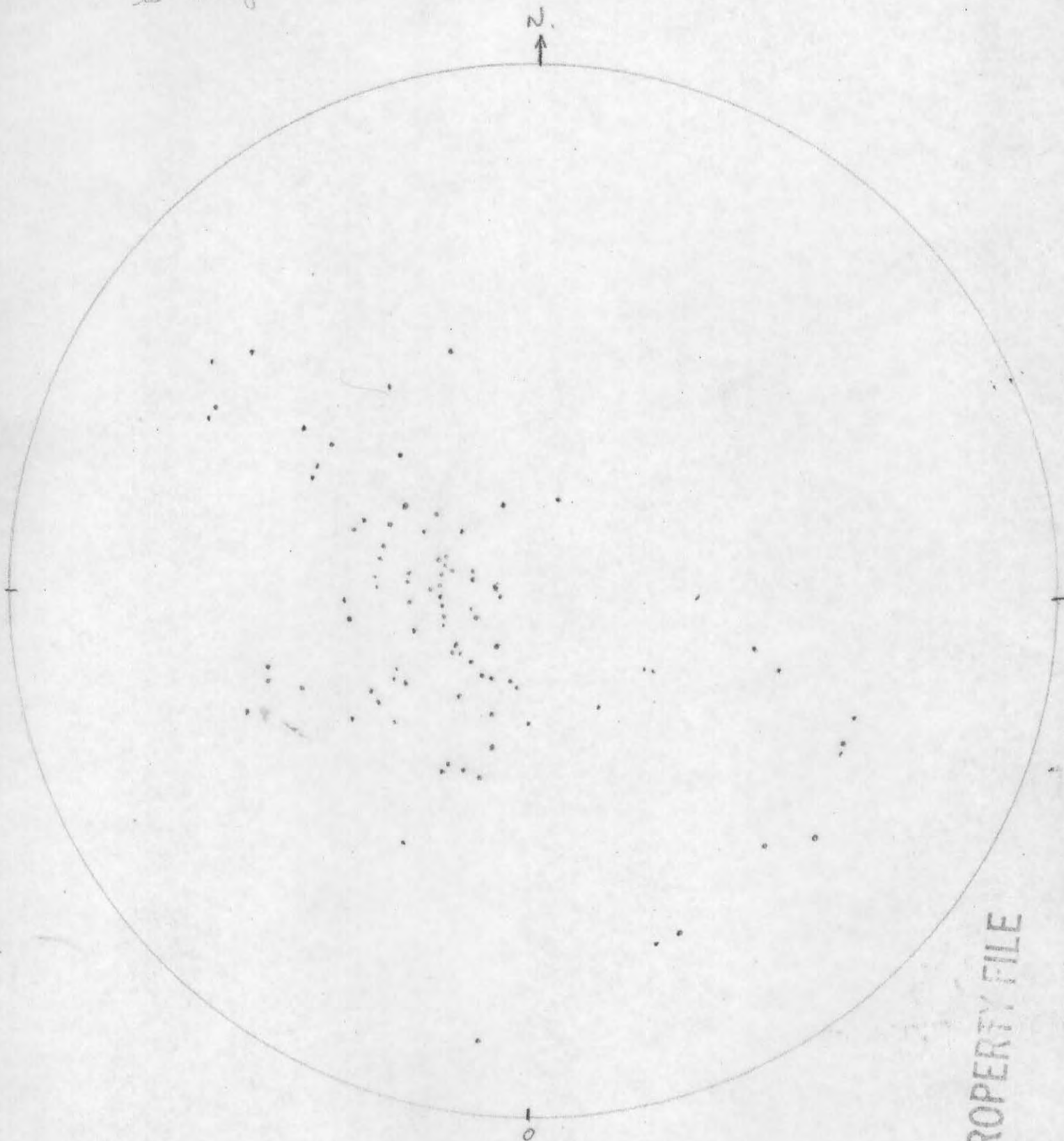

PROPERTY FILE

71
93MOT2-06

Reference
No. 45

75 Cap



Porphyritic
Granodiorite

PROPERTY FILE

93M071

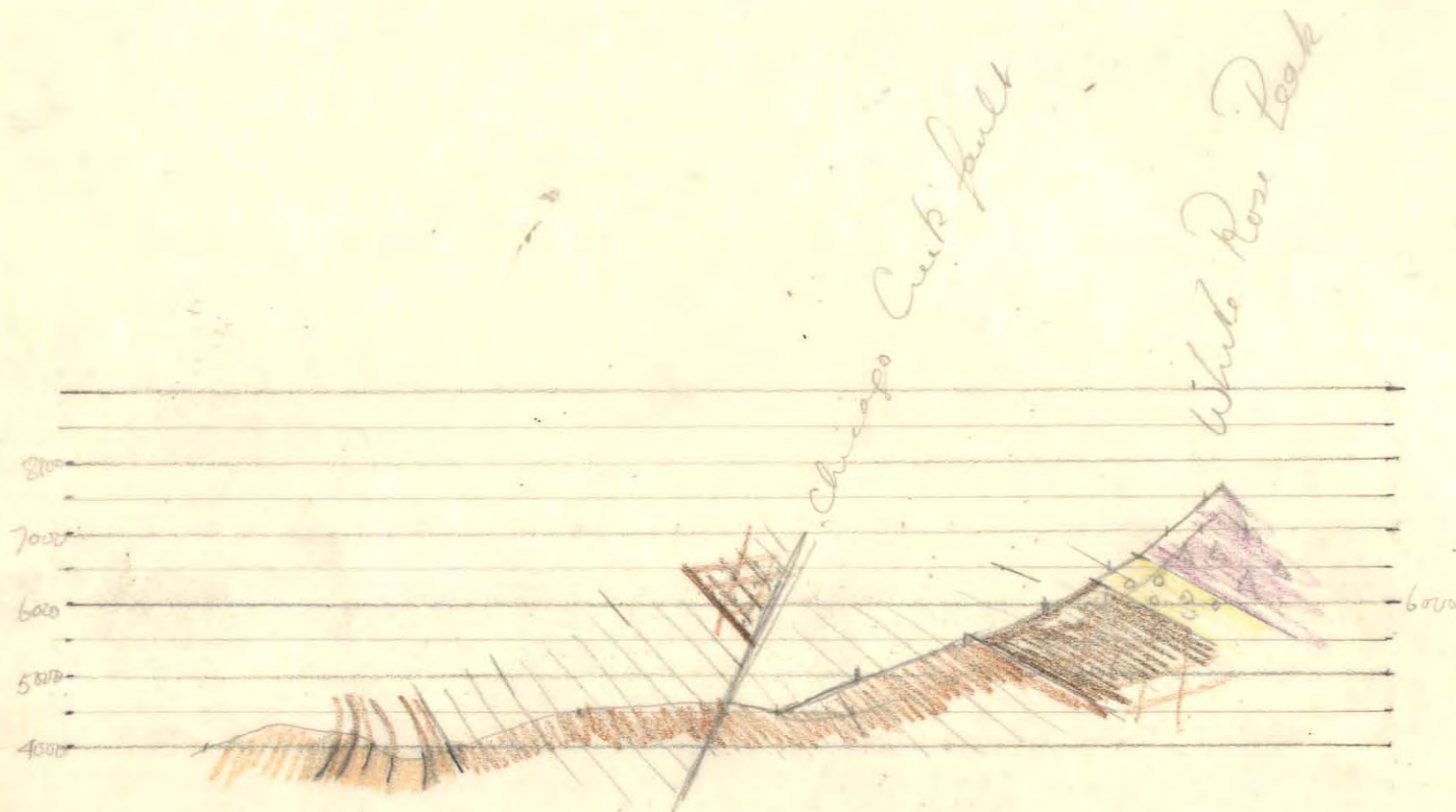

Red Rose Em {

Dawn	600	Section II Red Rose Creek, Mill fault.
Blind Boy	1500	
Amogosa	4000	
Mill Mer	1500+	
	<u>7600</u>	

PROPERTY FILE

93M071-06

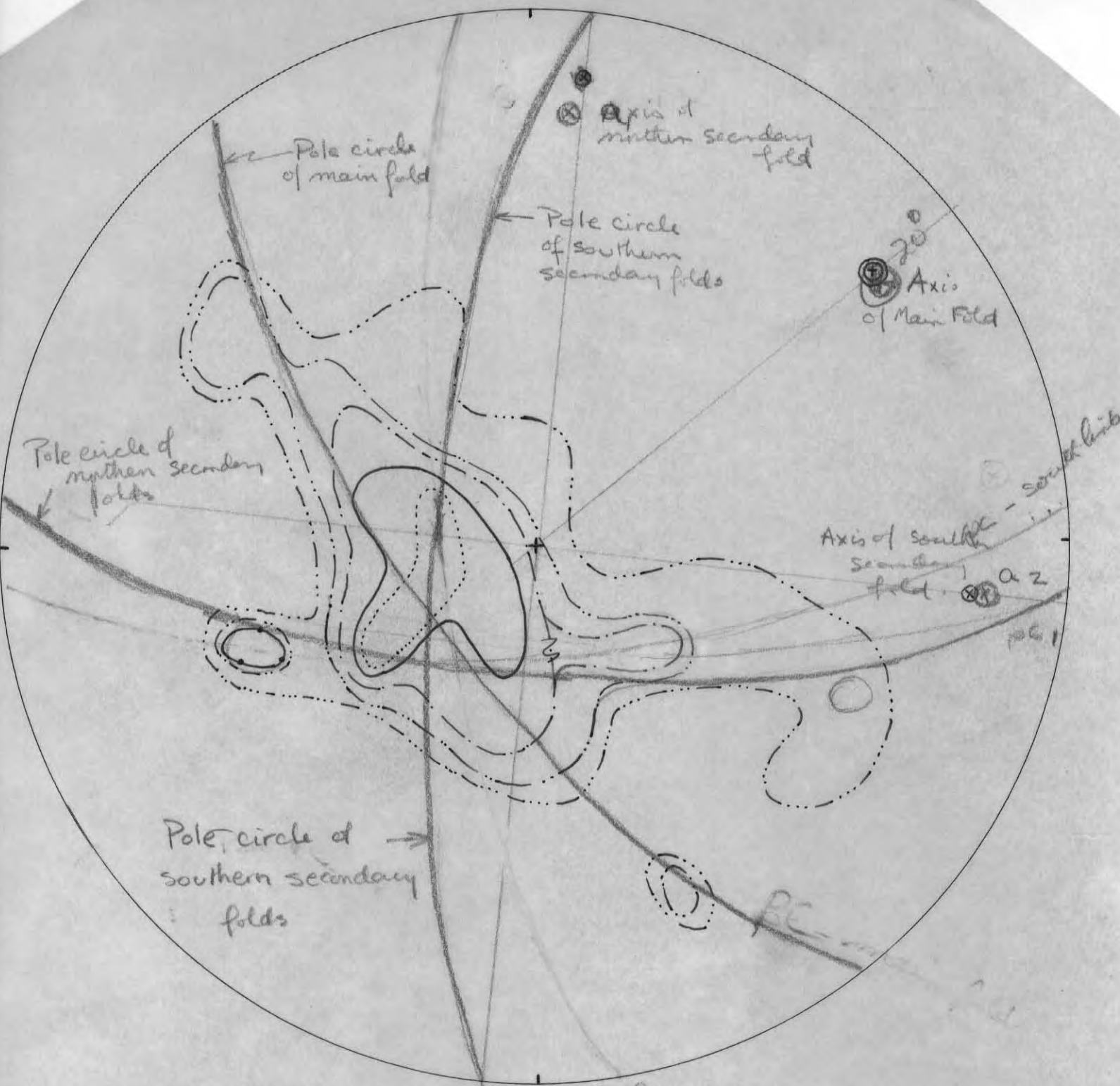

- Considerations:
 1. ——— pole per one placement
 2. ———
 3. ———
 5. ———
 7.

Schmit, Steronet.

93M071
PROPERTY FILE

FIGURE 6

Stereoscopic Projection on Schmidt Net
of Joints observed in Rocher Déboulé Stock

+ observation on west side of central axis

• " " east " " " "

— normal to long axis

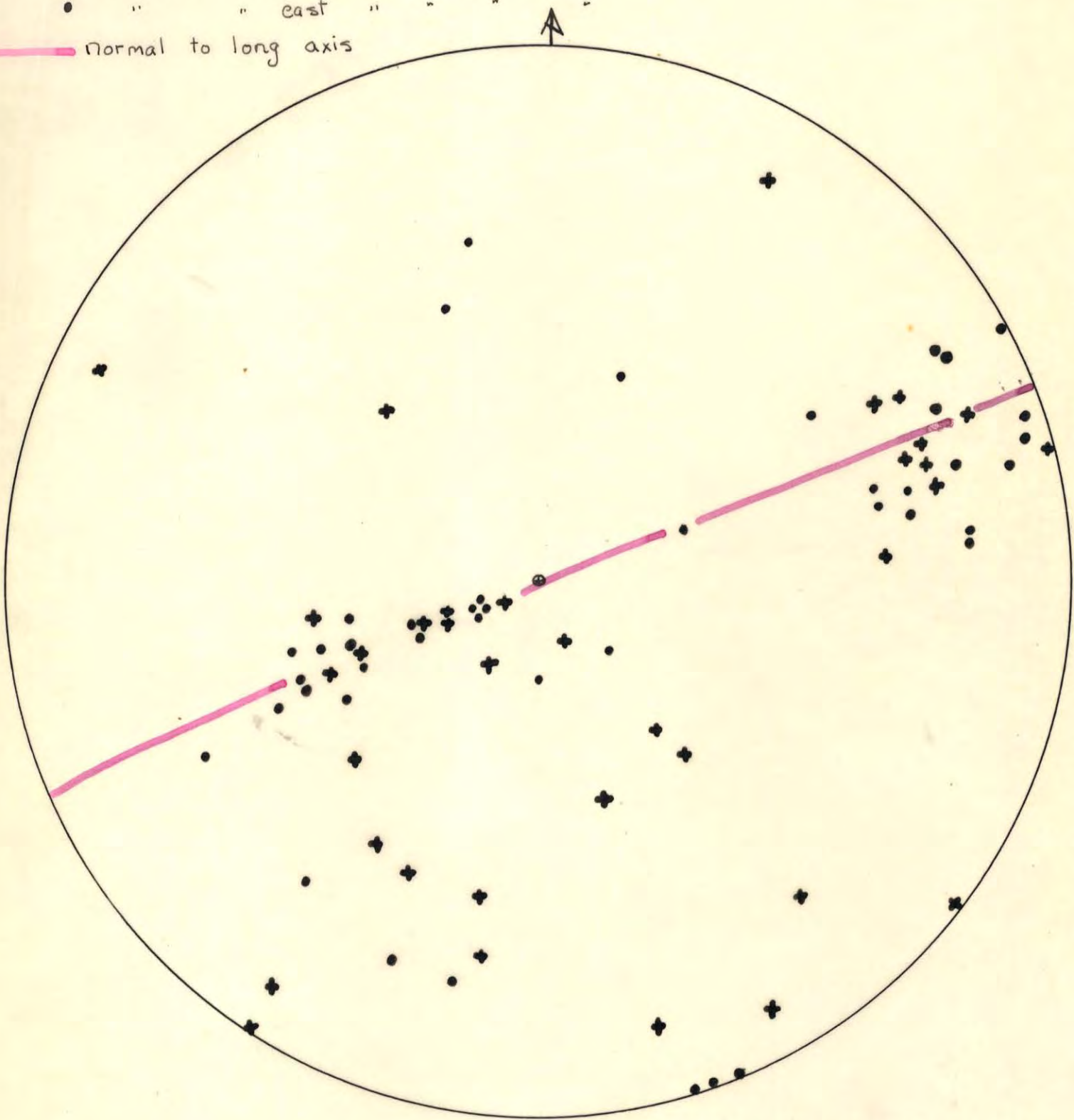

PROPERTY FILE

71
93MOT2-06

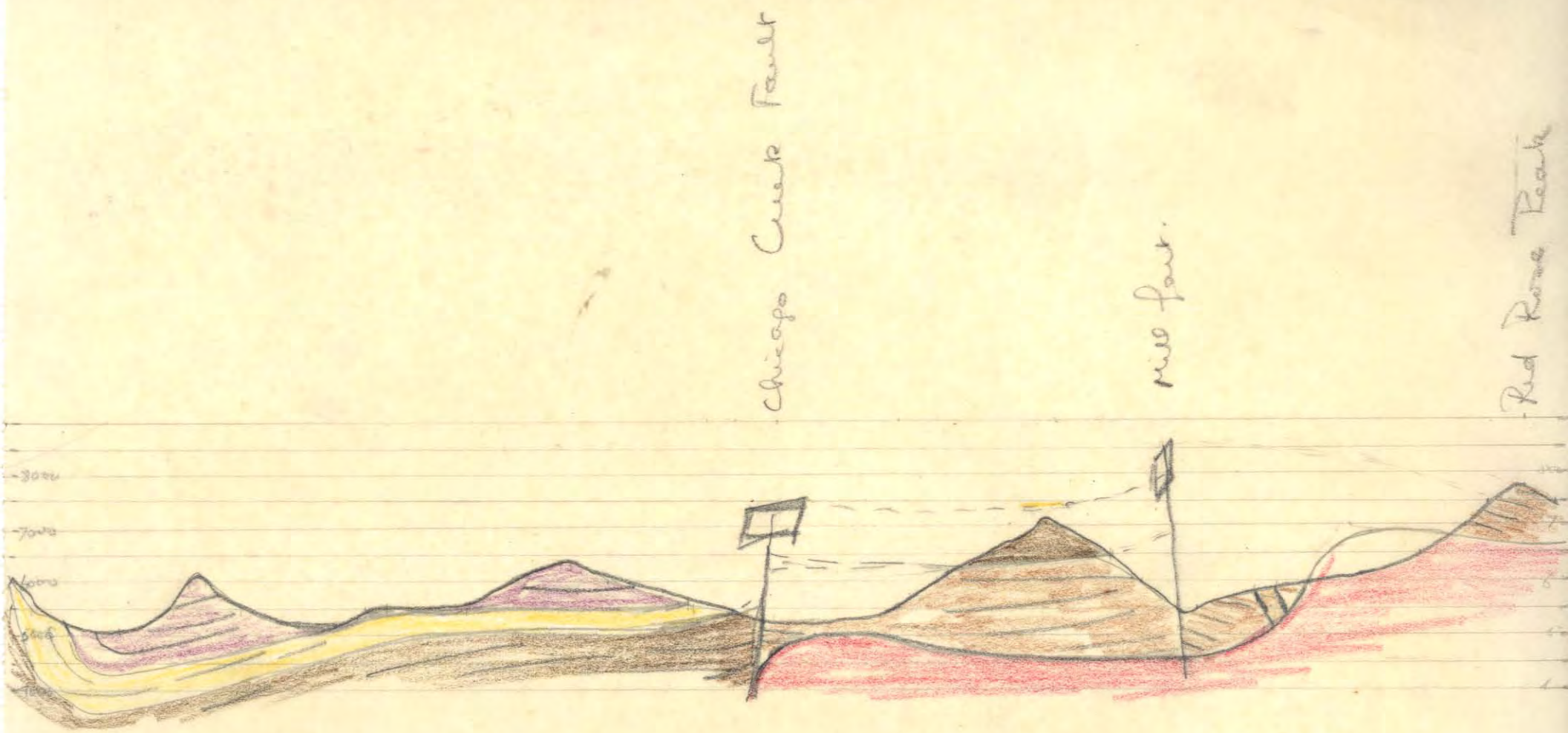

93MOTI-06
PROPERTY FILE

2000' in

Brian Bow Peak
8200'

Peak between two branches of
Brian Bow creek

750'

7000

6000

5000

4000

BB

D

C

Chicago Co
fault

4200' of
Brian Bow fm
on Brian Bow

PROPERTY FILE

93M071-06

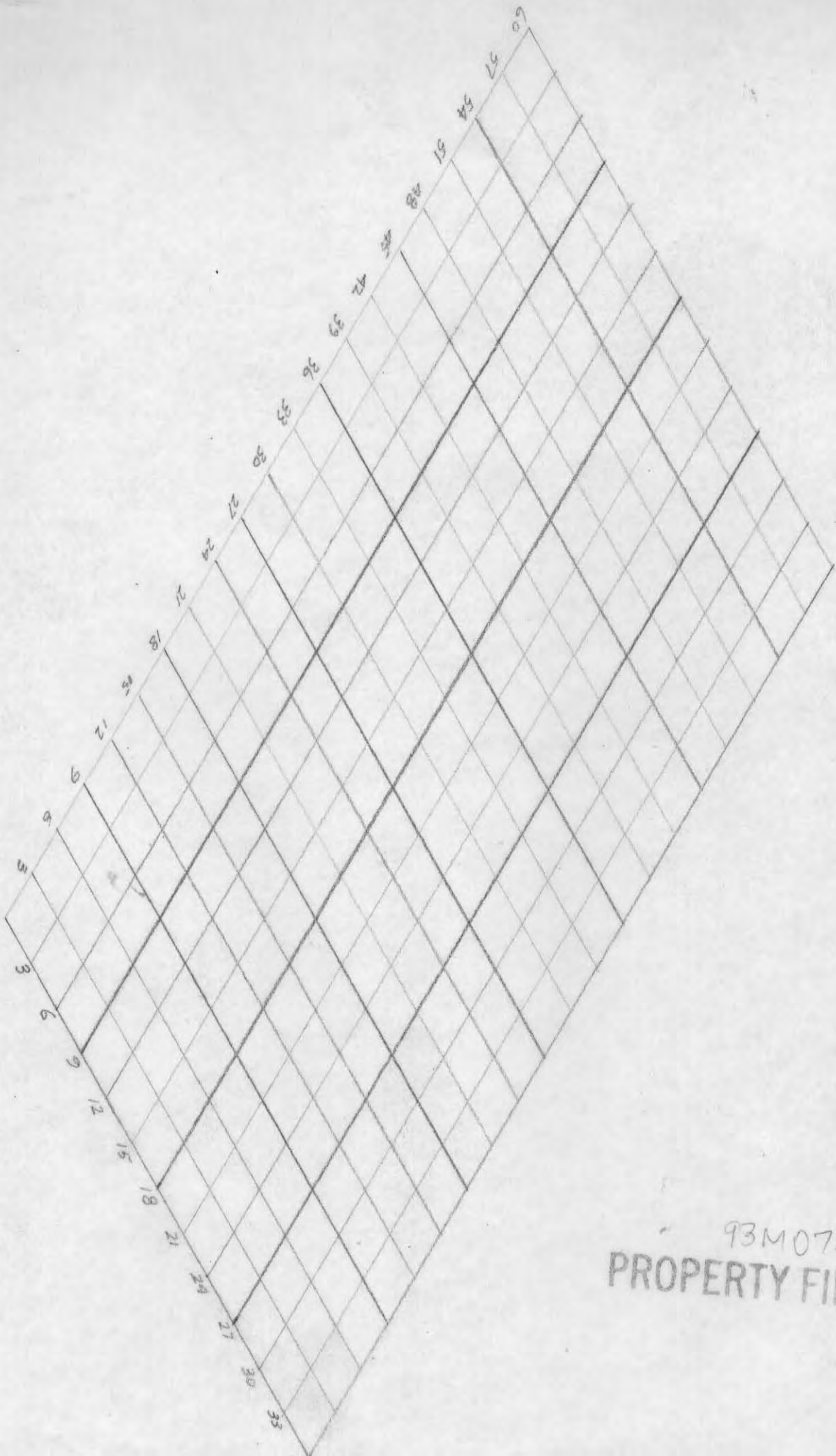

93M071
 PROPERTY FILE

361 road
342 road

Rocher Dehault Stack

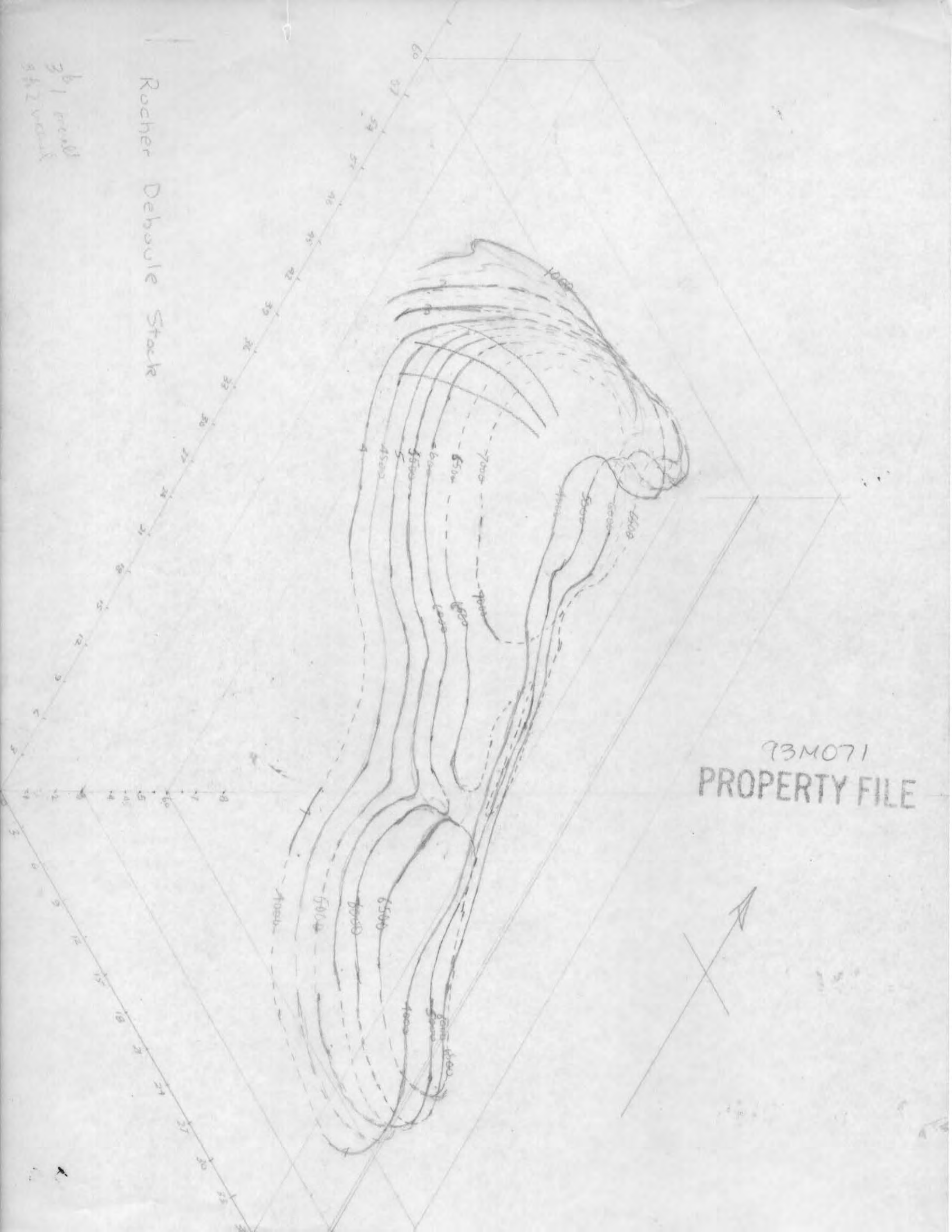

93M071
PROPERTY FILE