

**FENTON GROUP
TSALIT MOUNTAIN PROJECT
HOUSTON, B. C.**

PROPERTY FILE

INTRODUCTION

During 1976 a program of exploration was continued on the Fenton Group by Stokes Exploration Management Co. Ltd. The property is under option to British Newfoundland Exploration Ltd.

REGIONAL GEOLOGY

Geology of the Tsalit Mountain region is described in a recent publication by Church*, who states:

"... The bedrocks consist of an assortment of Mesozoic and Tertiary volcanic and sedimentary rocks and a large granite intrusion.

A suite of Early Mesozoic rocks underlies most of the map-area and is host to the mineral deposits on Tsalit Mountain. The lowest part of this sequence consists of argillite beds exposed along Puport Creek and east of Owen Creek in the northeast part of the map-area. The argillite is overlain by a thick rhyolite unit cropping out to the north and south of the upper course of Puport Creek and east of Owen Creek. The upper part of this sequence is about 1,000 feet thick, consisting mainly of volcanic rocks exposed on Tsalit Mountain. On the east part of the mountain the rocks are dark amygdaloidal basalt and andesite lavas with a few thin intercalated rhyolite marker flows. To the west, a thick lens-shaped body of tuff breccia is found near the top of a basalt-andesite lava pile."

* Church, B.N. (1970): Geology, exploration and Mining in British Columbia; B.C. Dept. of Mines and Petroleum Resources, pp. 142-149.

PROPERTY GEOLOGY

In a report by D. G. Leighton and Dr. K. I. Lu dated November 26, 1976, the property geology is described:

"The Fenton property is mostly drift covered with bedrock exposures generally scarce. Claims are underlain by a variety of lithologies which include: basalts, massive and agglomeratic andesites, acid tuffs and tuff breccias, massive and brecciated rhyolites and sedimentary rocks. The only sediments seen were shales, but sandstones are reported.

"Regolith exposed in road cuts in the western part of the property consist mainly of quite fresh dacitic pyroclastics with some lava. Basalt outcrops in the vicinity of grid station 19S12W. The western slope of Tsalit Mountain is composed of andesite, massive to agglomeratic, and basalt. Basalt appears to overlie the andesite on the lower slopes, though andesite appears again higher in the section. Shale occurs with andesite in drill core dumped at the north end of the base line road. Rock samples collected by R.B. Stokes recently while staking new claims west of the original Fenton group include a variety of silicified acid breccias.

"Float was examined over a fairly large portion of the property and appears to offer some insight into bedrock geology. Rhyolitic lava and coarse pyroclastics (including some welded tuff) are abundant along the OE line and in the vicinity of the camp site. Andesitic material increases to the southeast.

"Some pyritic (float) rhyolitic tuff breccia occurs at the camp site. More pyrite and vein chalcopryrite was seen in and near the 20S trench."

Rock samples taken from the trenches were submitted to Vancouver Petrographics (see trench maps for location). They were:

Sample 1863C	Andesite flow or intrusion
Sample 1856 1+50SC	Andesite flow (altered)
Sample 1951-25S TR B	Brecciated Andesite flow
Sample 1952 TR 4 $\frac{1}{2}$	Fragmental contact between Andesite Flow and mudstone
Sample 1806 A-6-7E	Andesite crystal tuff.

CLAIMS LIST

<u>CLAIM NAME</u>	<u>CLAIM/ UNITS</u>	<u>TAG NO.</u>	<u>RECORD NO.</u>	<u>RECORD DATE</u>	<u>EXPIRY DATE</u>
Fenton 1	1	467822	132908	Oct.31/74	Oct.31/79
" 2	1	467823	132909	"	"
" 3	1	467824	132910	"	"
" 4	1	467842	132911	"	"
" 5	1	467843	132912	"	"
" 6	1	467844	132913	"	"
" 7	1	467845	132914	"	"
" 8	1	467846	132915	"	"
" 9	1	467847	132916	"	"
" 10	1	467848	132917	"	"
" 11	1	467849	132918	"	"
" 12	1	467850	132919	"	"
" 13	1	467851	132920	"	"
" 14	1	467852	132921	"	"
Fenton 15	2	15836	419	Sep.14/76	Sep.14/80
" 16	1	15837	420	"	"
Fenton 27	1	34427	508	Nov.22/76	Nov.22/77
" 28	4	34428	509	"	"
" 29	2	34429	510	"	"
" 30	1	34430	511	"	"

25

* Additional work will be filed from the drilling.

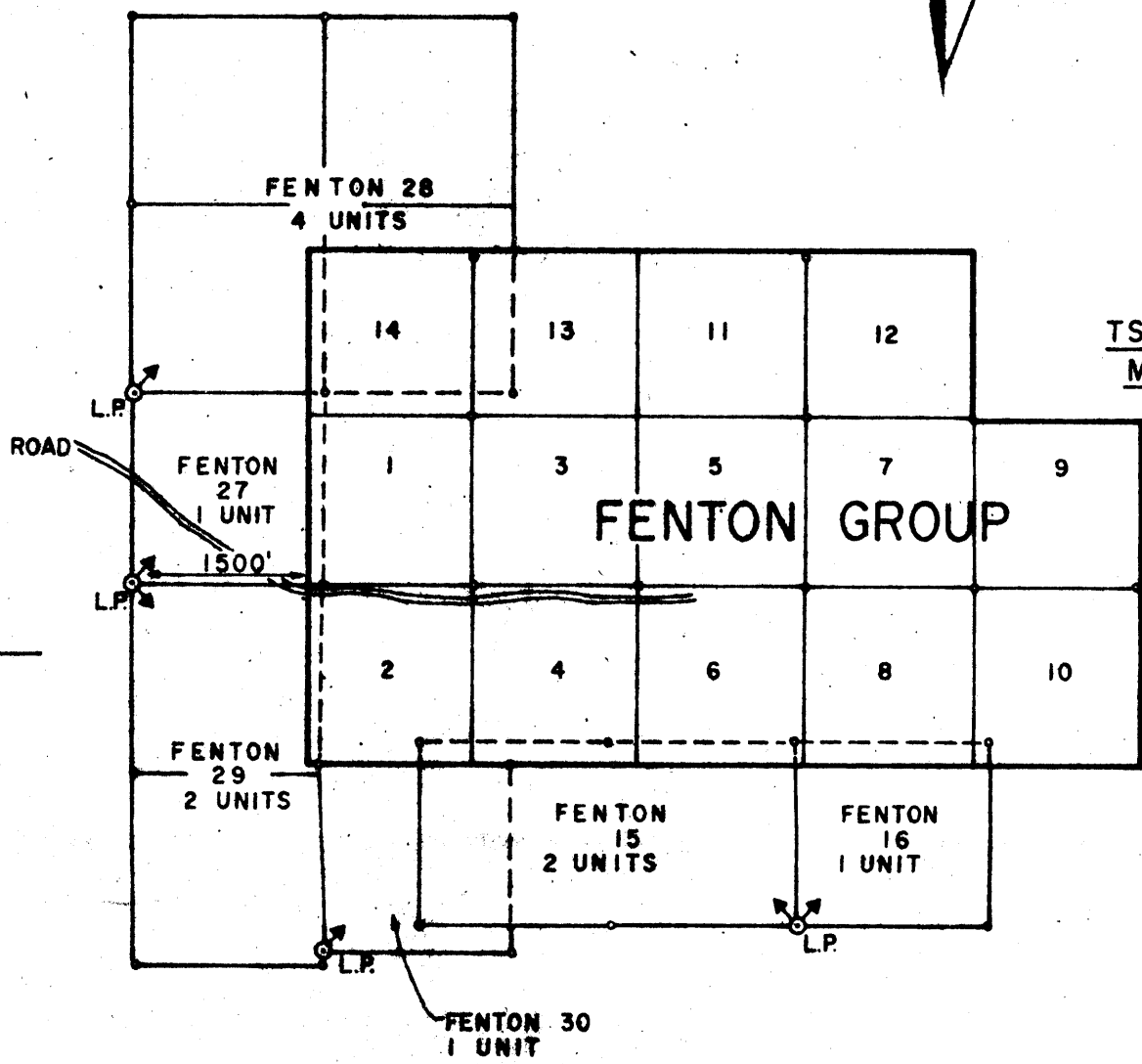

TSALIT
MTN.

54°09'

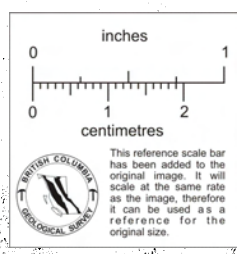

**NEW CLAIMS
FENTON GROUP
TSALIT MTN. PROJECT
OMINECA M.D.**

Drawn: R.B.S.

Date: Nov. 1976

Scale: 1" = 1500'

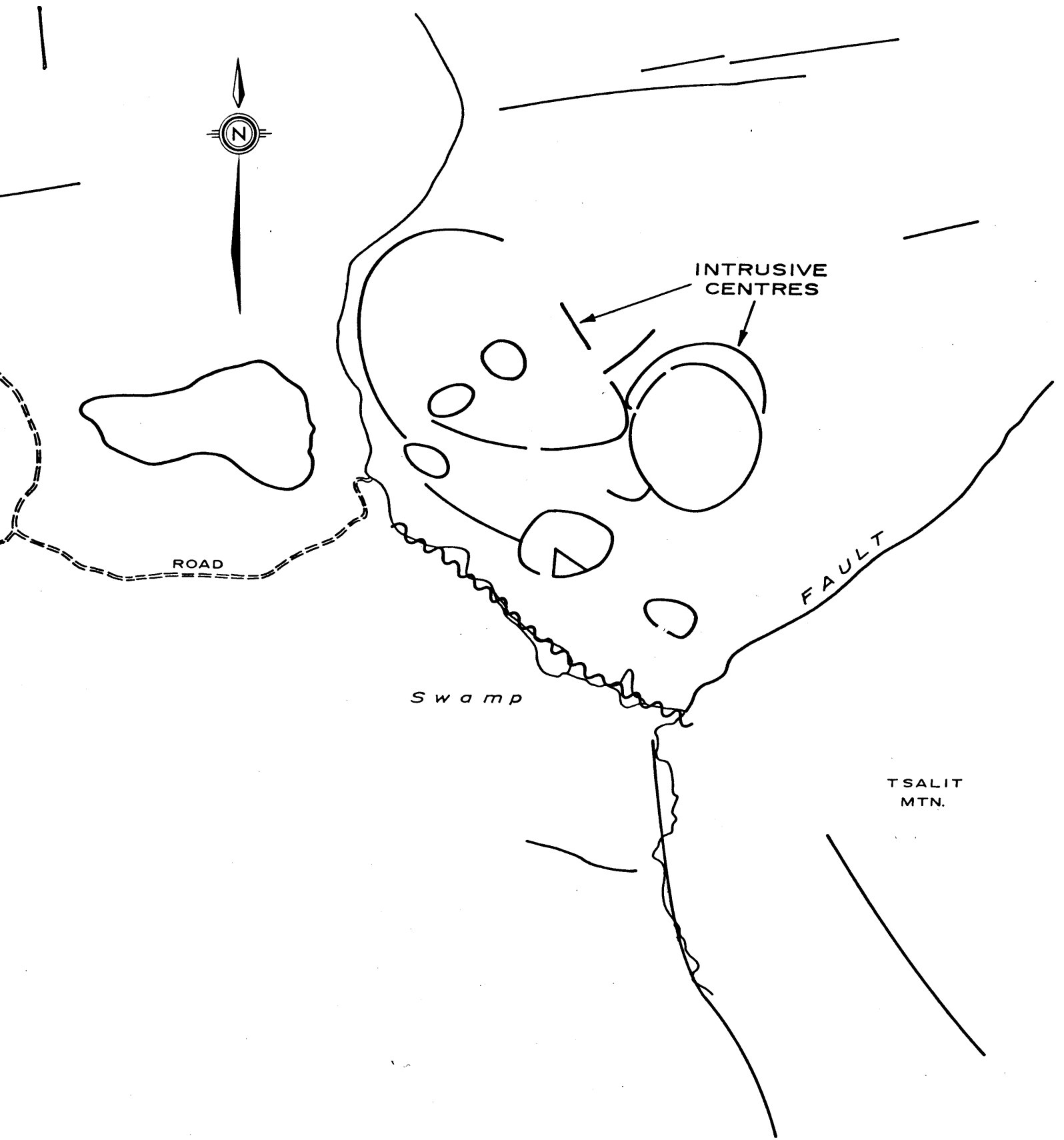

STRUCTURAL
OVERLAY
TSALIT MTN. AREA
SCALE 1" = 1320' \pm

