

S.J. HUNTER & ASSOCIATES LTD.
 CONSULTING ENGINEERS
 VANCOUVER BRITISH COLUMBIA

CLAIM PLAN & ANOMALIES
 HOWSON BASIN PROPERTY
 NORCAN MINES LTD.

SCALE 1" = 1000'
 DATE OCT. 14/66
 PROJECT No. 45
 EXAMINED BY S.J. HUNTER
 P. ENG.

5550

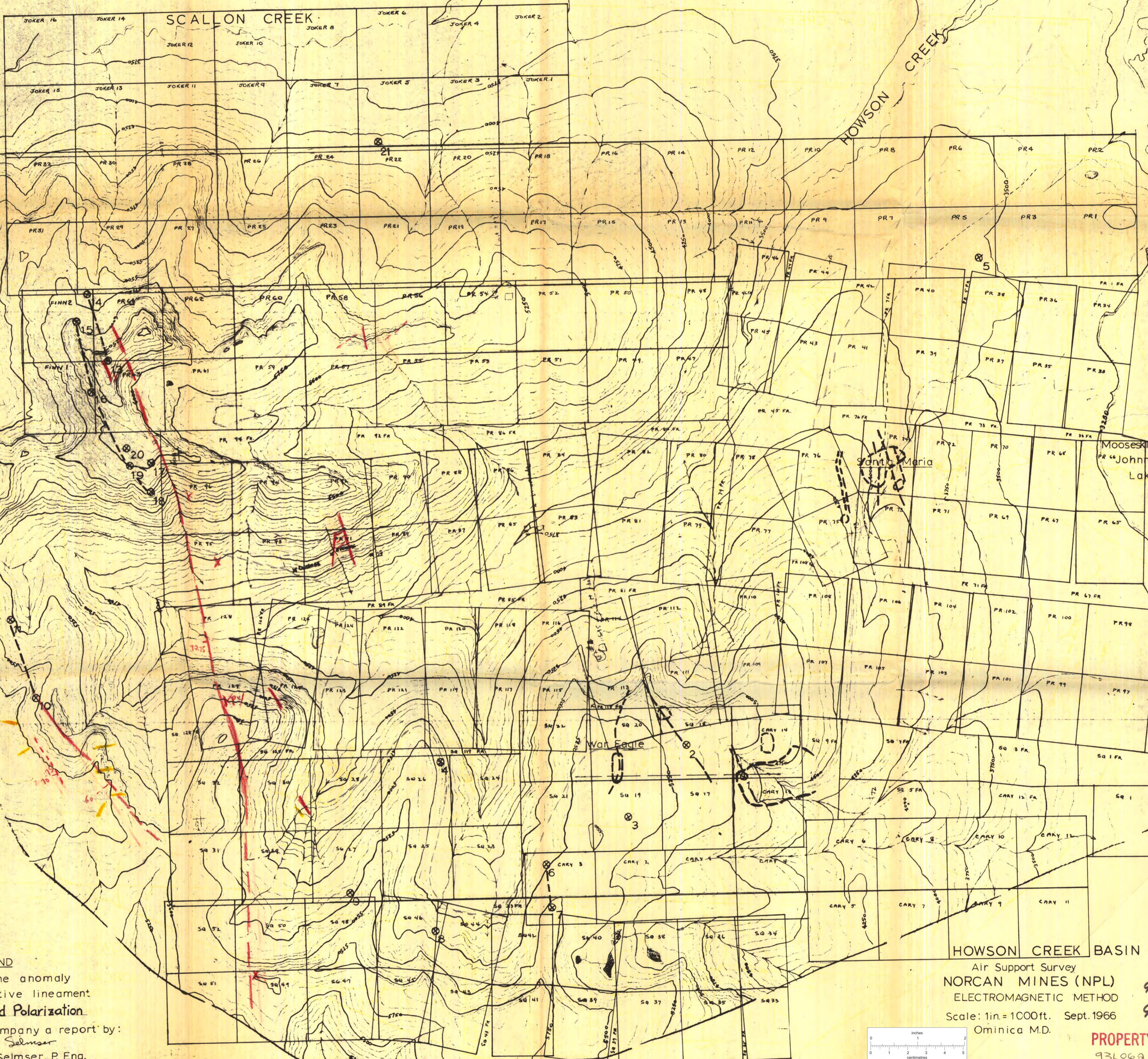

LEGEND

- ⊗ Airborne anomaly
- Conductive lineament
- ⊕ Induced Polarization

To accompany a report by:
 C. B. Selmser
 C. B. Selmser, P. Eng.

HOWSON CREEK BASIN
 Air Support Survey
 NORCAN MINES (NPL)
 ELECTROMAGNETIC METHOD
 Scale: 1in = 1000ft. Sept. 1966
 Ominica M.D.

9316w
 931-62-66

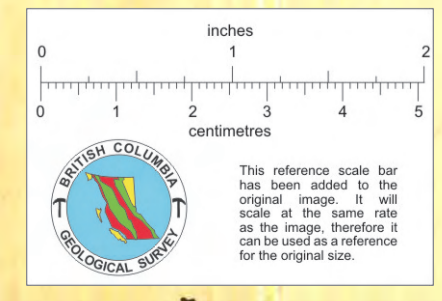

PROPERTY FILE
 931062-06

54, 126, SW

Fig. 1

015568