

INTER-OFFICE CORRESPONDENCE

TO

LOCATION

DATE

FROM

LOCATION

FILE

SUBJECT DUNGATE

- Alteration zoning, drill intersections, magnetics, geochemistry and I.P. show an environment very similar to that of the Morrison orebody
- property lies.

- Alteration area of interest alt'n hasn't been tested which commonly in this area Granite Bell holds highest grade mineralization

93L010(7E)

PROPERTY FILE

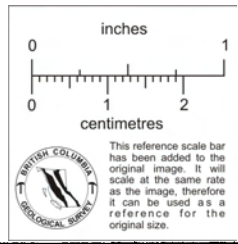
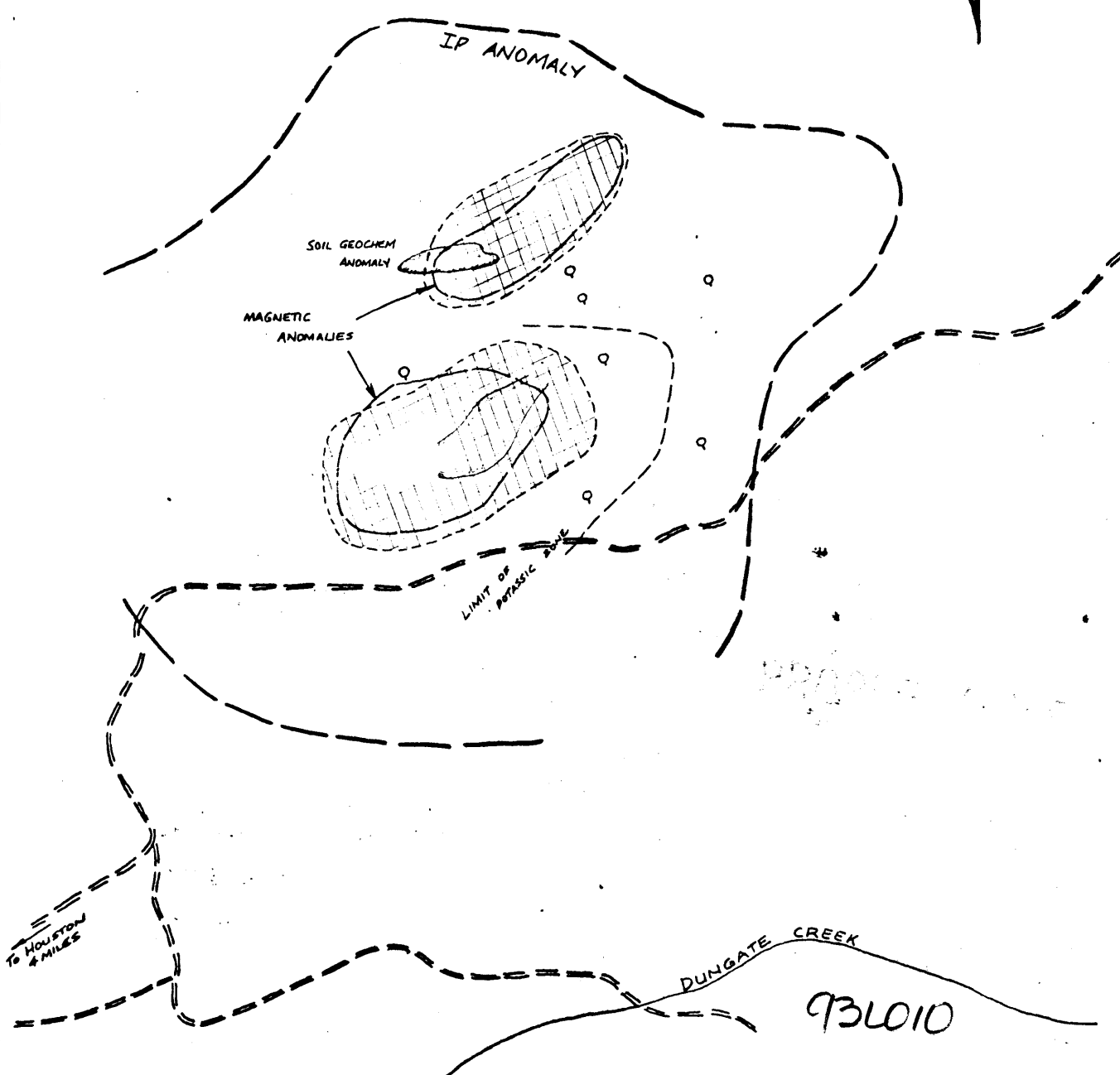

CANADIAN SUPERIOR EXPLORATION LIMITED SMITHERS REGIONAL OFFICE		
DUNGATE CR. PROSPECT		
COMPILATION		
DRAUGHTSMAN: JB	SCALE: 1" = 1000'	DATE: JAN. 1974

06 0



100
100
100

Haskell Volcanics
Boundary

NORANDA
DDH

3

3

3

DUNGATE CREEK

PROP.

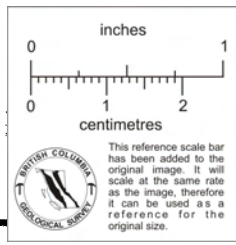

CANADIAN SUPERIOR EXPLORATION LIMITED SMITHERS REGIONAL OFFICE		
DUNGATE CR. PROSPECT		
GEOLOGY		
DRAUGHTSMAN: JB	SCALE: 1" = 1000'	DATE: JAN. 1974

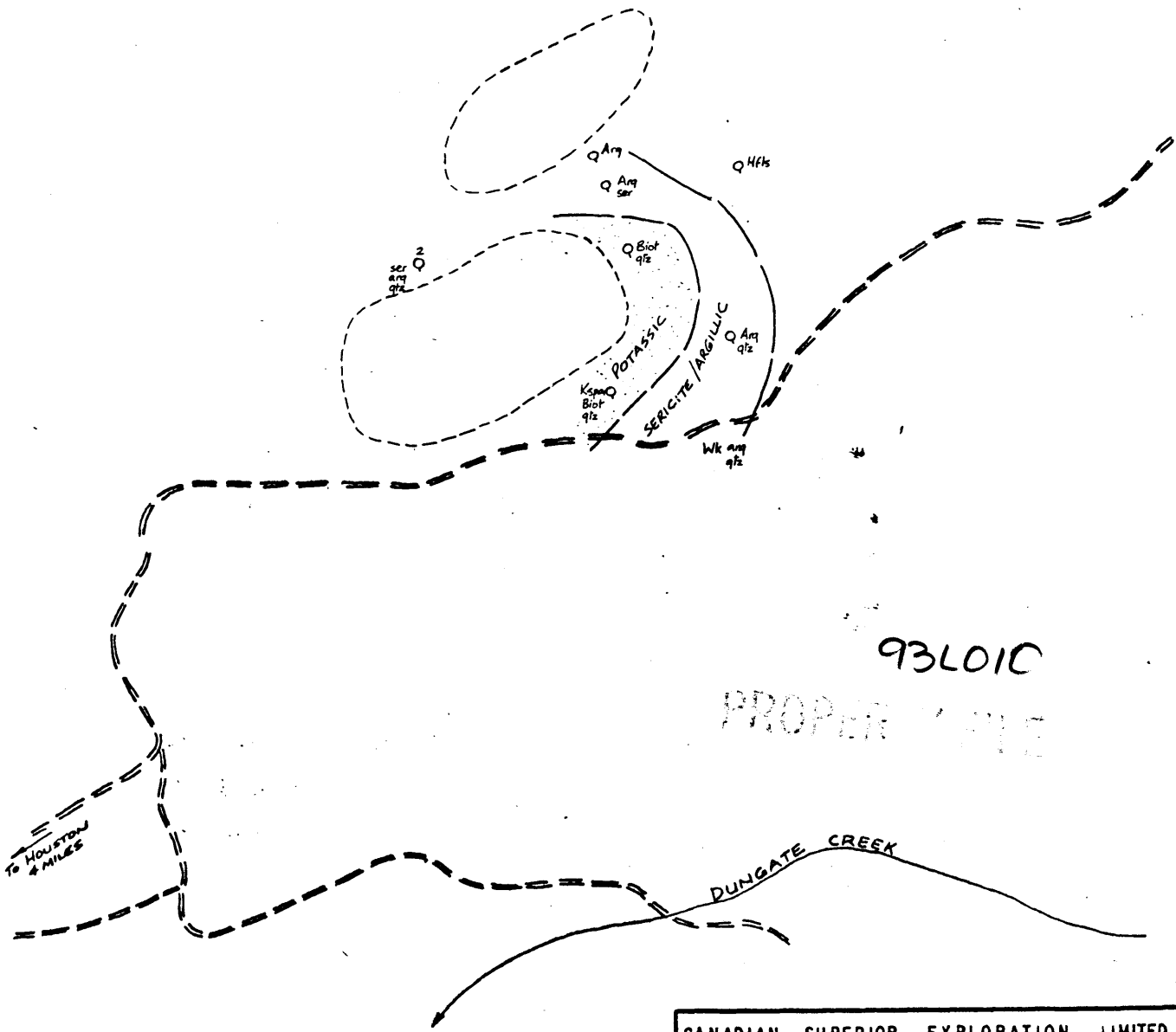

93LO1C

PROPER FILE

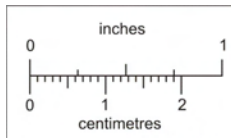

This reference scale bar has been added to the original image. It will scale at the same rate as the image, therefore it can be used as a reference for the original size.

CANADIAN SUPERIOR EXPLORATION LIMITED SMITHERS REGIONAL OFFICE		
DUNGATE CR. PROSPECT		
ALTERATION		
DRAUGHTSMAN: JB	SCALE: 1" = 1000'	DATE: JAN. 1974

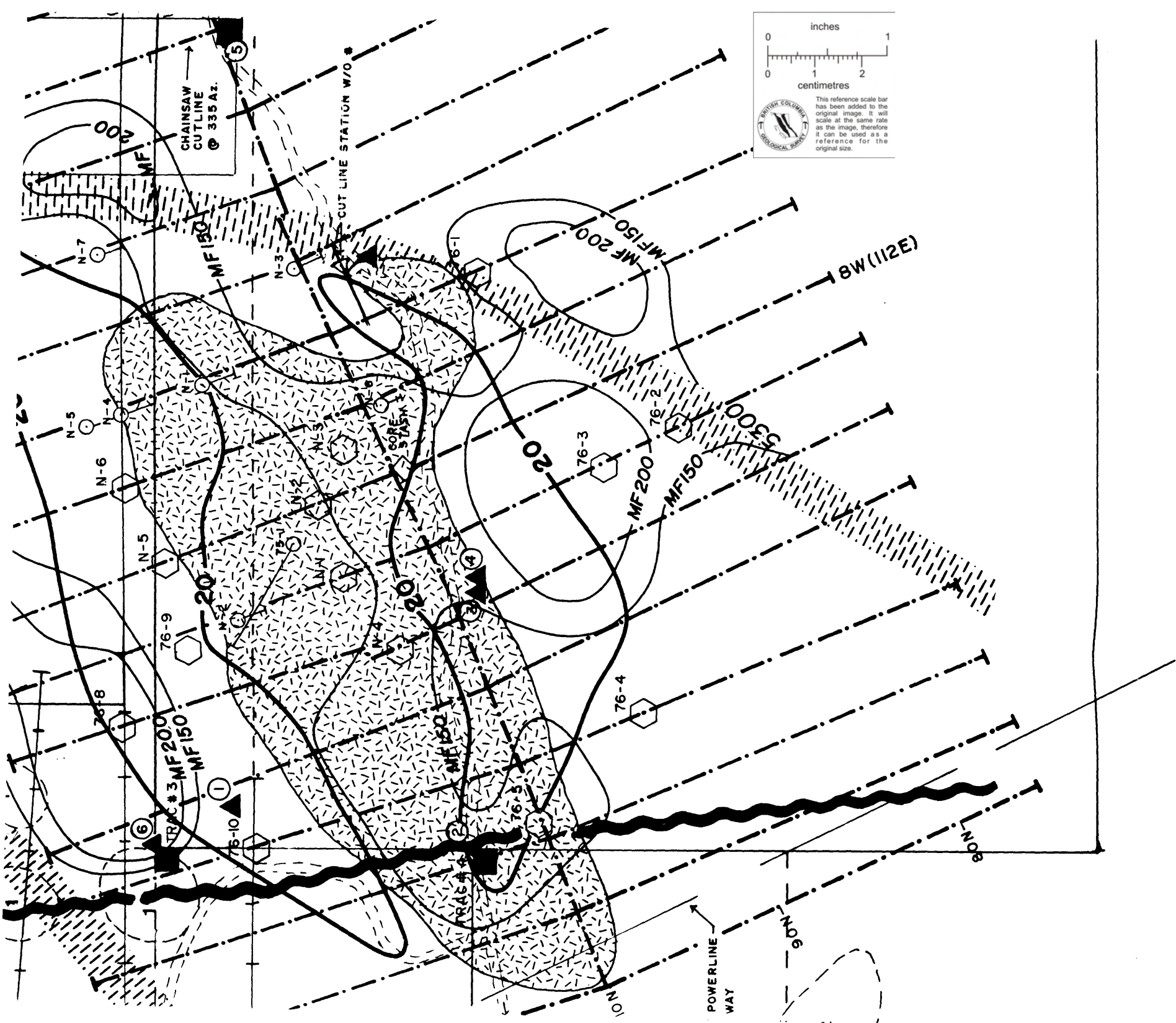

inches
0 1 2

centimetres
0 1 2

BRITISH COLUMBIA
GEOLOGICAL SURVEY

This reference scale bar has been added to the original image. It will scale at the same rate as the image, therefore it can be used as a reference for the original size.