

COLE SHAFT ELEV 3150 APPROX.
7000' FROM PORTAL APPROX.
4800' TURN

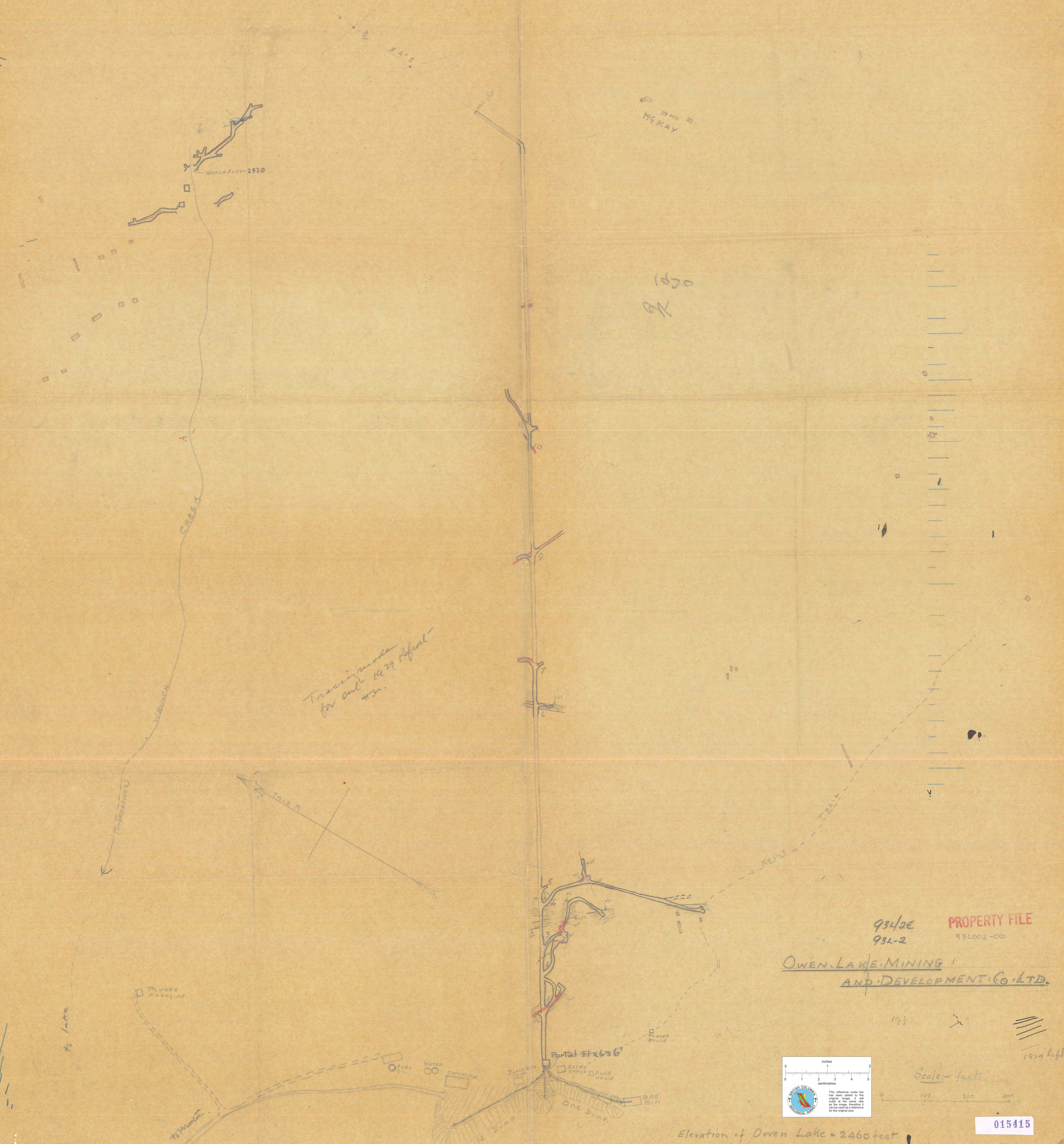

Tracing made for out 1929 Report #32.

1870
9K

934/2E
93L-2
PROPERTY FILE
931002-00

OWEN LAKE MINING AND DEVELOPMENT CO. LTD.

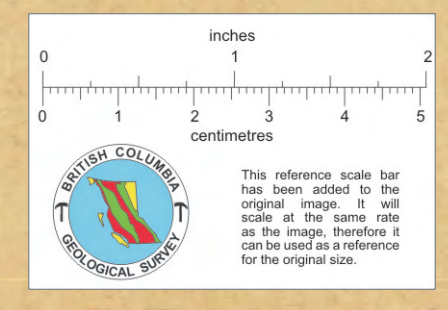

Scale - feet
0 100 200 300

Elevation of Owen Lake = 2460 feet

015415