

Gem .93K016 93K/3E

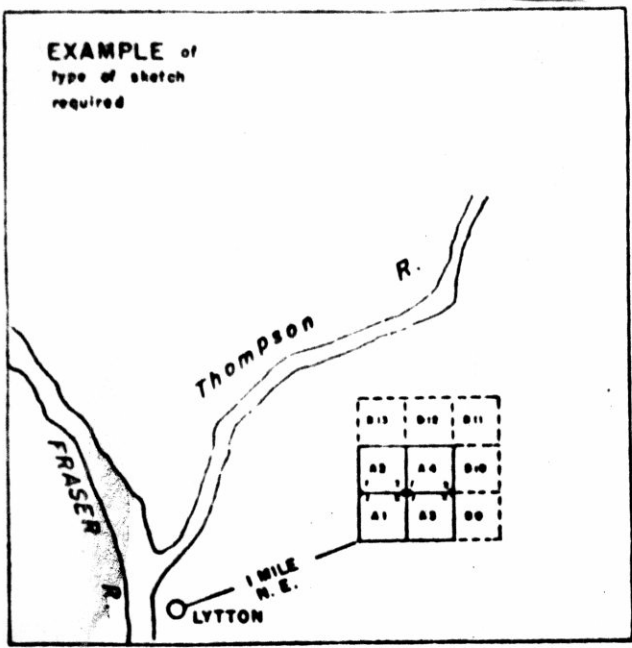

Claims must be tied by direction and distance to at least one, preferably more than one, topographical feature, or to a land lot, section, township, or other recognizable point on printed maps of the district. Relationship of previously located claims should also be shown.
 N.B. — The sketch for a group of claims may be placed on one affidavit.

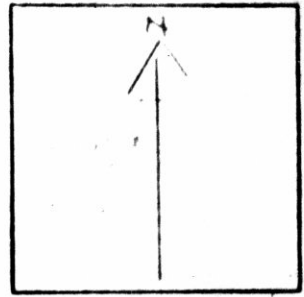

INDICATE NORTH (True or Magnetic)

Highway 16
 To Kuning Lake ←

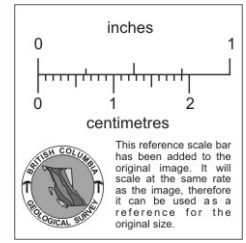
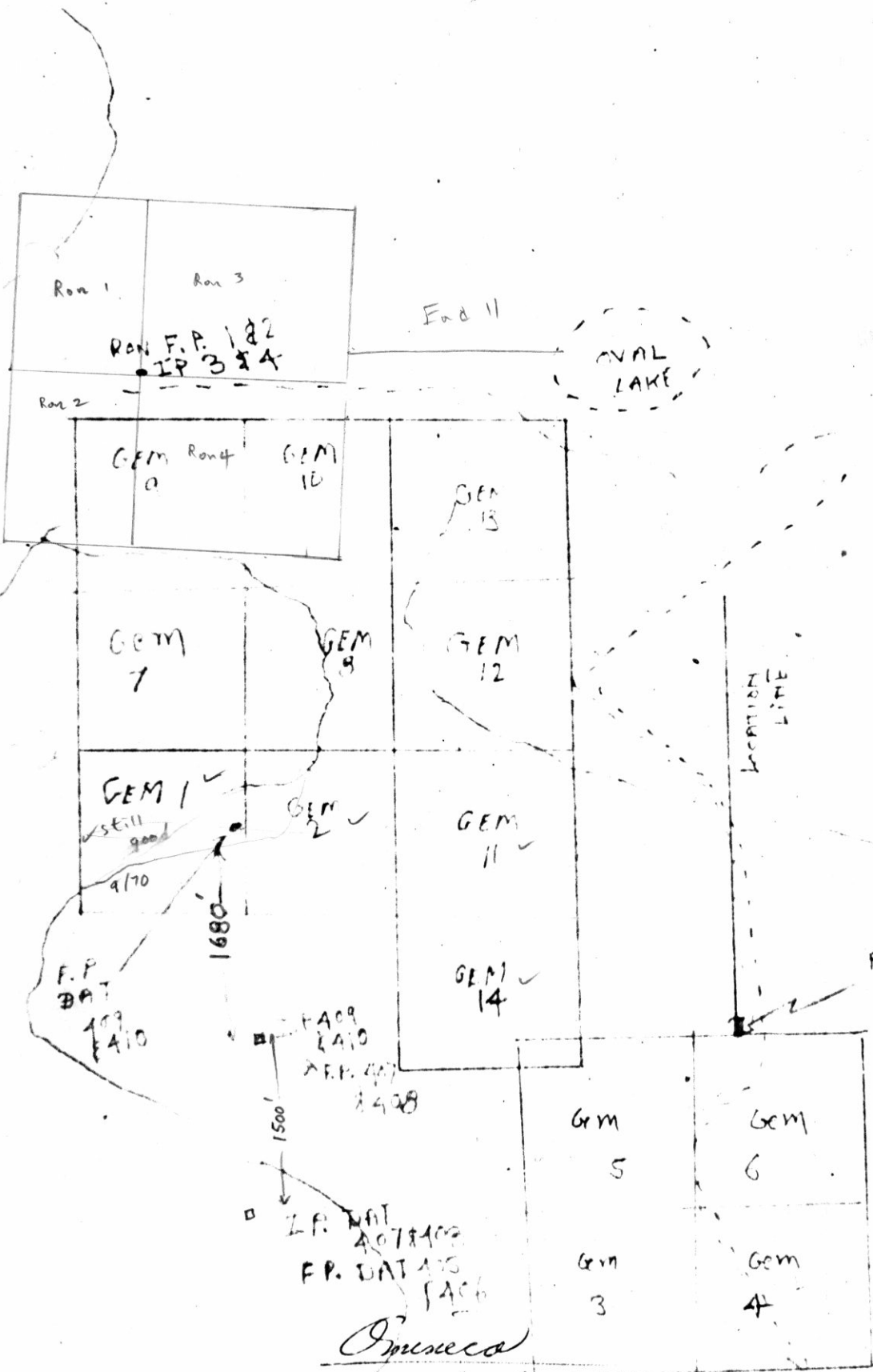

F.P. R.W. 323 & 34

GOVERNMENT AGENT
RECEIVED

SMITHERS, B. C.

SCALE
 4 inch To A MILE
015230

MAP 93K 3E 31/8/66
 Gem # 7-14
 41142-49
 31/10/66
 TO ENDAKO MINES