

93H006

PROPERTY FILE

E 13600

E 13800

N. 16400

3

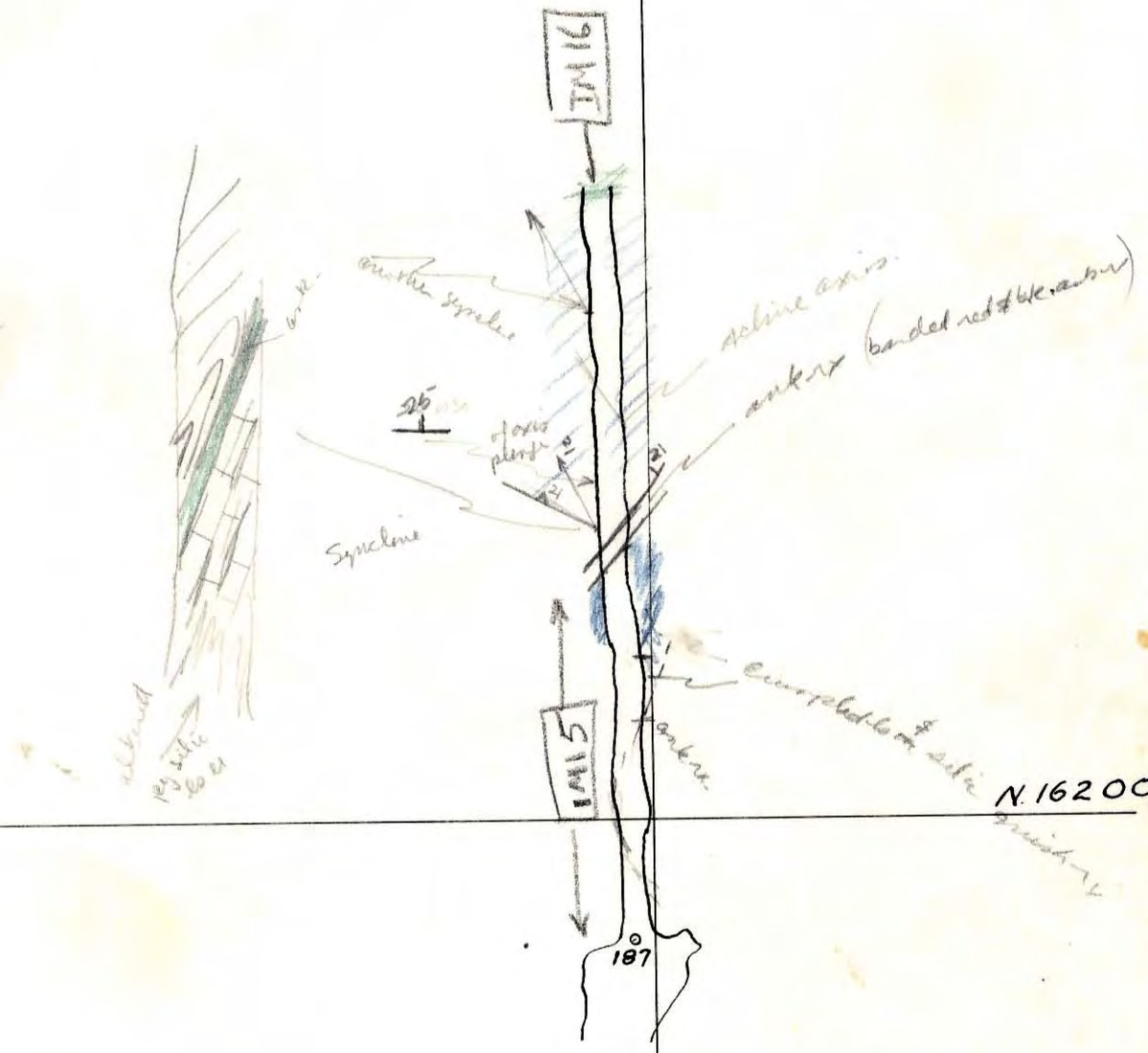

N. 16200

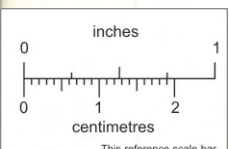

This reference scale bar has been added to the original image. It will scale at the same rate as the image, therefore it can be used as a reference for the original size.

BRITISH COLUMBIA
GEOLOGICAL SURVEY

014774

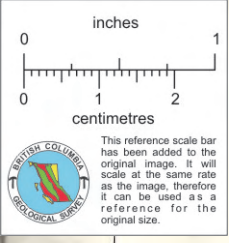

0 1
0 1 2
inches
centimetres



This reference scale bar has been added to the original image. It will scale at the same rate as the image, therefore it can be used as a reference for the original size.

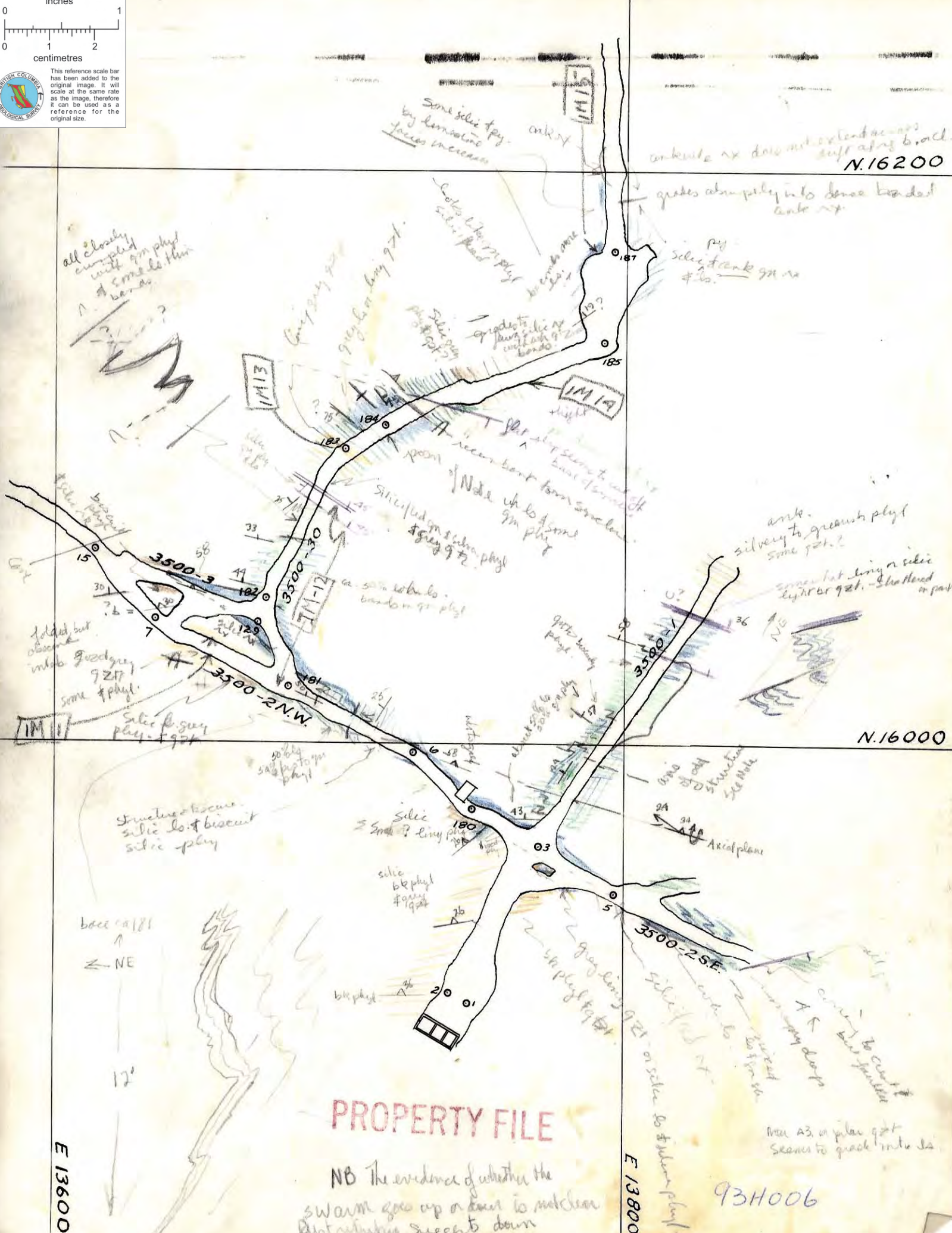

PROPERTY FILE

NB The evidence of whether the swarm goes up or down is not clear. Suggests down

93H006

E 13600

E 13800

N.16200

N.16000

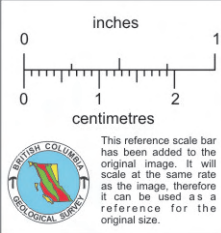

PROPERTY FILE

93H006

Sheet 2.
Island Mtn.
3500' level
100' = 1 in

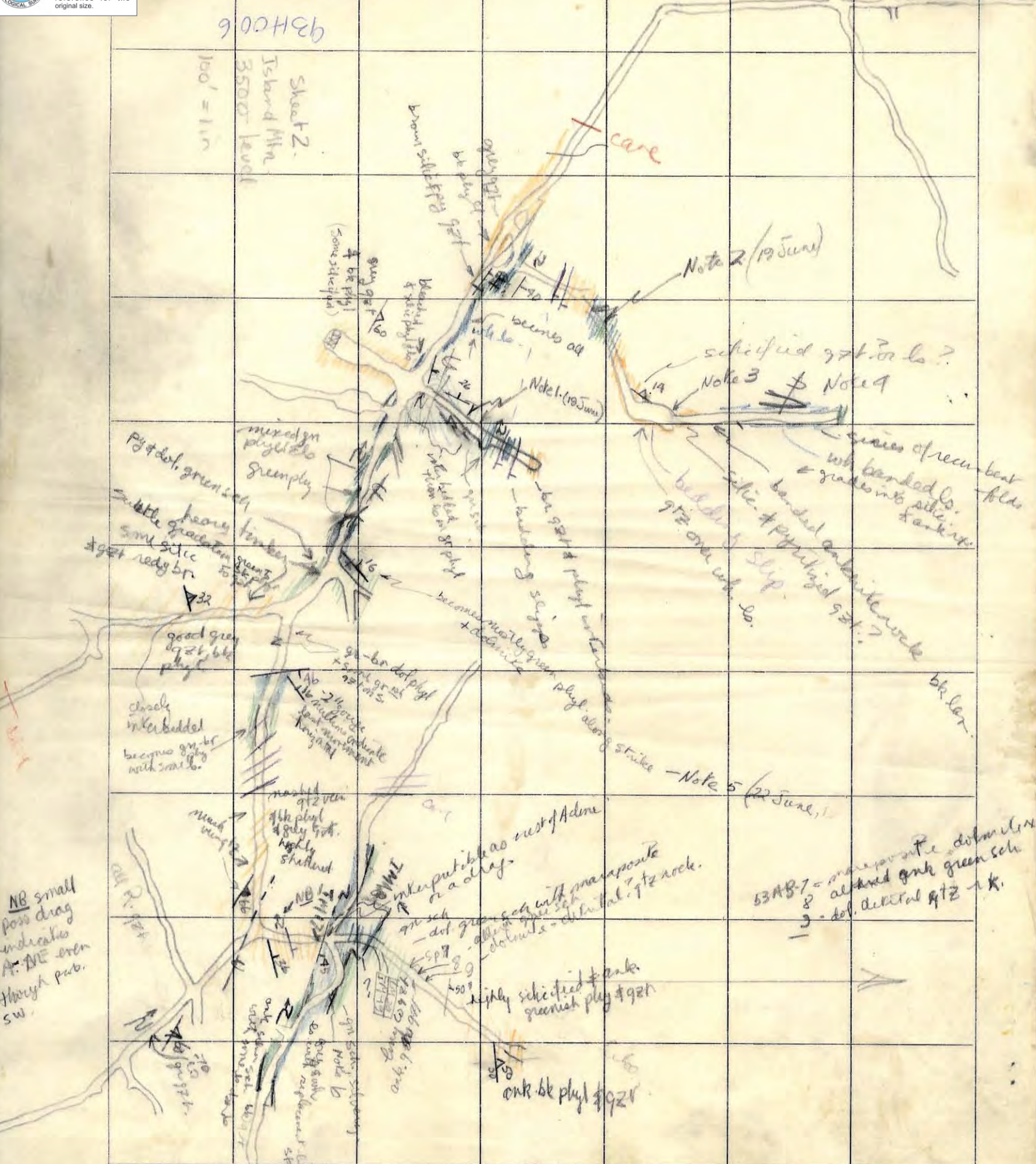

NB small
pos drag
indicates
A-BE even
through pub.
sw.

53AB7 - more porphyritic dolomite
8 - altered gneiss green sch
9 - dol. lateral qtz - k.

highly schistified & banded
greenish phyl & qtz
onk. bk phyl & qtz

Note 5 (22 June)

Note 3 & Note 4

Note 2 (19 June)

Note 1 (19 June)

(Some siltstone)

series of recumbent
wh. banded ls.
grades into siltstone
& arkose.

banded amphibolite
silt. & pyroxenite
slip.

strike - Note 5 (22 June)

intermittent as east of Adena
a drag.

dot green sch with manganese
all in upper sch
dolomite - lateral qtz rock.

NB small
pos drag
indicates
A-BE even
through pub.
sw.

onk. bk phyl & qtz

good grey
dotted phyl

Pyroxenite
greenish
mixed gneiss
pyroxenite
greenish
heavy
subtle gradation
some silt
& qtz red br

care

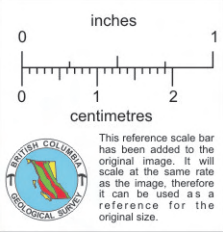

This reference scale bar
 has been added to the
 original image. It will
 scale at the same rate
 as the image, therefore
 it can be used as a
 reference for the
 original size.

sheet 1.
 Island Mtn
 3600 level
 100 = 1 in
 93.4006

PROPERTY FILE