

2476B across 2" 2 ft
at station (2)

venⁿ 7" maybe 8" (accessable)
3 ft wide
20 feet south of
this is another vein
in logging 2 to 3'
wide

(2477B) - across 6"
vein said to be
high grade +
14 to 18 in in
bottom of drift
(vein 9)
vein 8 about 6"
10 ft south

(2478B) vein 10 - 3 1/2 ft

2481B) vein 15-6"

wide
shows sulphide
(265ft)

2482B) at 290 feet

across 15-ft
S E end of
vein which
appears to run
along contact at
this point

2483B) 299 ft ~~low~~

~~at~~ across
back of vein
running off to contact
width 2' 6"

2484B) vein strike
N 28 W - 60 S W

324 ft

4' air
across 2 ft

W70E 20



W70E 10

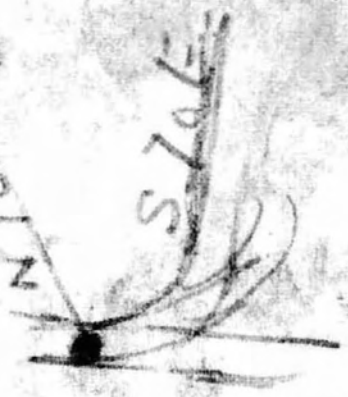

W70E 10

(2485B) across
2 ft 353 feet
been following
contact

(2486B) vein 26
4 ft wide
remembers
intensity near
turning above
pleistocene + qtz

~~No.~~
Black Tunnel.

Tunnel strikes contact
of Schist + greenstone
by raise.

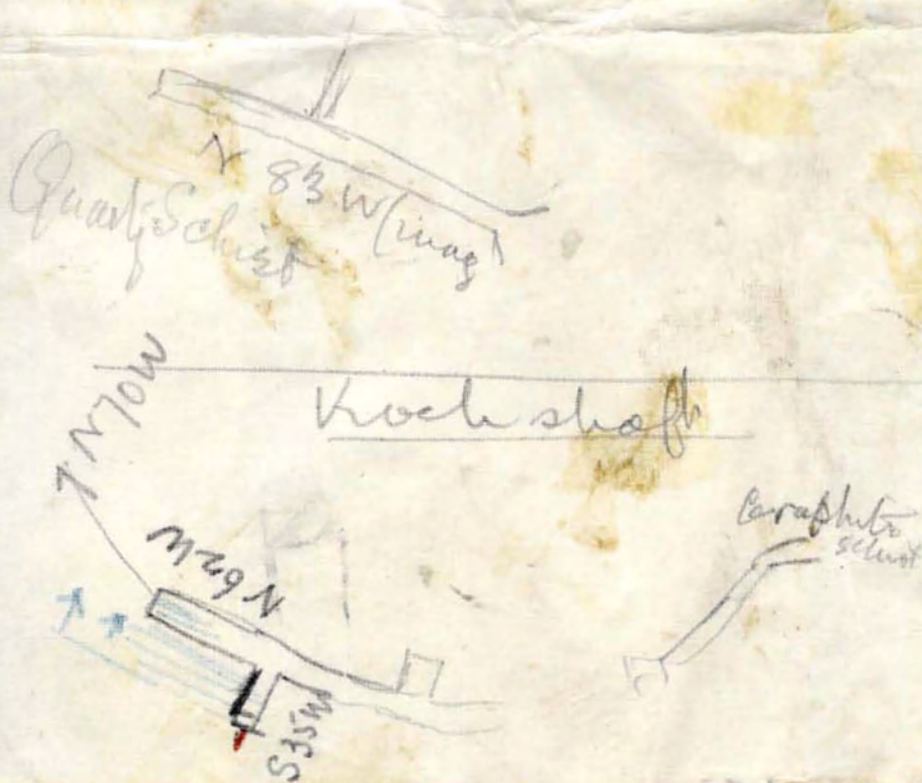

cross cut



Vertical
Contract

hook stuff



2479B

Vein 6.5 ft wide
follows contact
at 195 feet
sample across 4.5 ft
vein starts at
about 170 ft
+ extends 30 ft

2480B

250 ft across 2 ft
full width 3.5 to 4 ft
from 200 to 256
large amount
of quartz more
bluish resubly
siliceous 4/5
greenstone

Vein

1 1/2

2487 B

across 5 ft main
greenstone head of
mineralogy west of
1st drive north

2488 B

across main 6 ft wide
vein level 2, in lower
part north dip.

2489 B

across 14 ft
level 3 E
by shaft

N

level 3

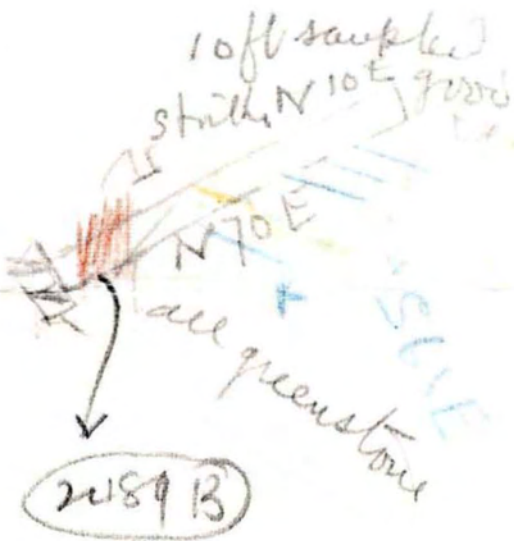

Level 2

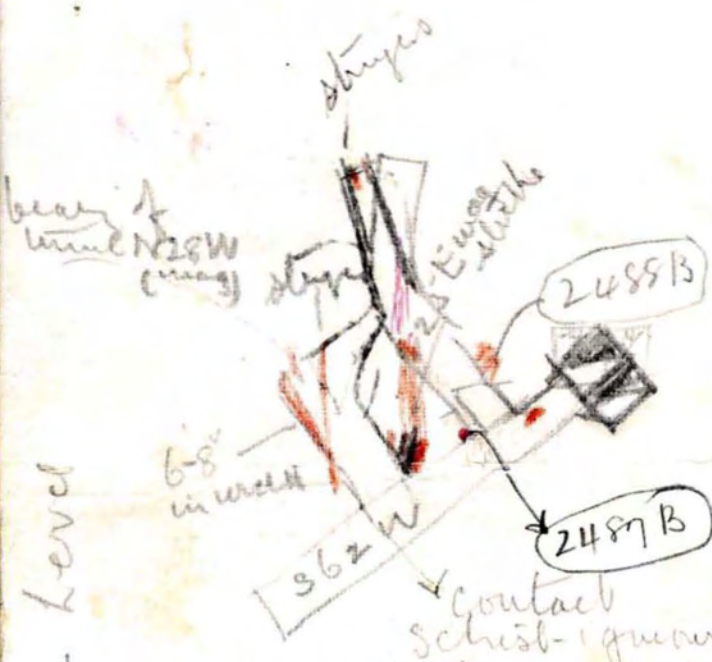

Level 2

In west drift, north drive commences at contact and at the point one quarry vein 18 in in width + 2 parallel strips 3" wide on the