

LONGITUDINAL SECTION OF OPENINGS ON WASHBURNE LEDGE

Vertical Scale equal to Horizontal 1/4 in. to 100 Feet Approx.

Shaft in old Tunnel (furthest South & West) 40ft deep which intersected a cross ledge 3 to 4 ft wide & yielded 100 tons of good ore.

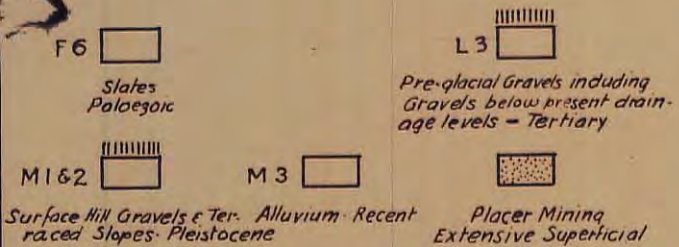

Contour lines Datum level (heavy contour) 2500 Ft. above sea level
Vertical interval, 50 feet between solid lines; 10' between dotted lines

EXPLANATION
 - Strike & Dip +++ Ditch
 - Quartz Vein * Shaft

In the color scheme it will be observed that the several different formations of gravels, & fragmental matter of the old and present river valleys, embracing the Cainozoic subdivisions are indicated by fragmental lines or dots.

NOTE - The deep channel L-3 marks the position of a tertiary valley which was filled up with pre-glacial drifts, and partly re-excavated by the present stream.

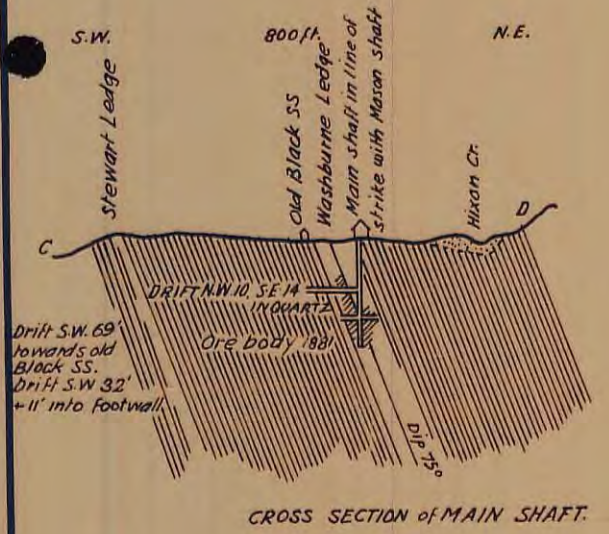

CROSS SECTION OF MAIN SHAFT.

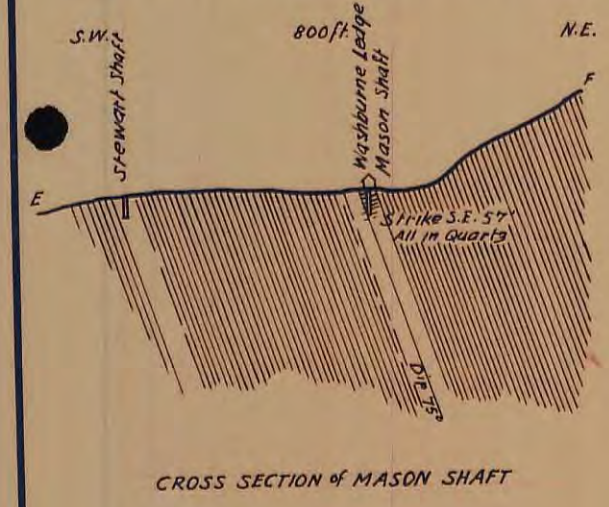

CROSS SECTION OF MASON SHAFT

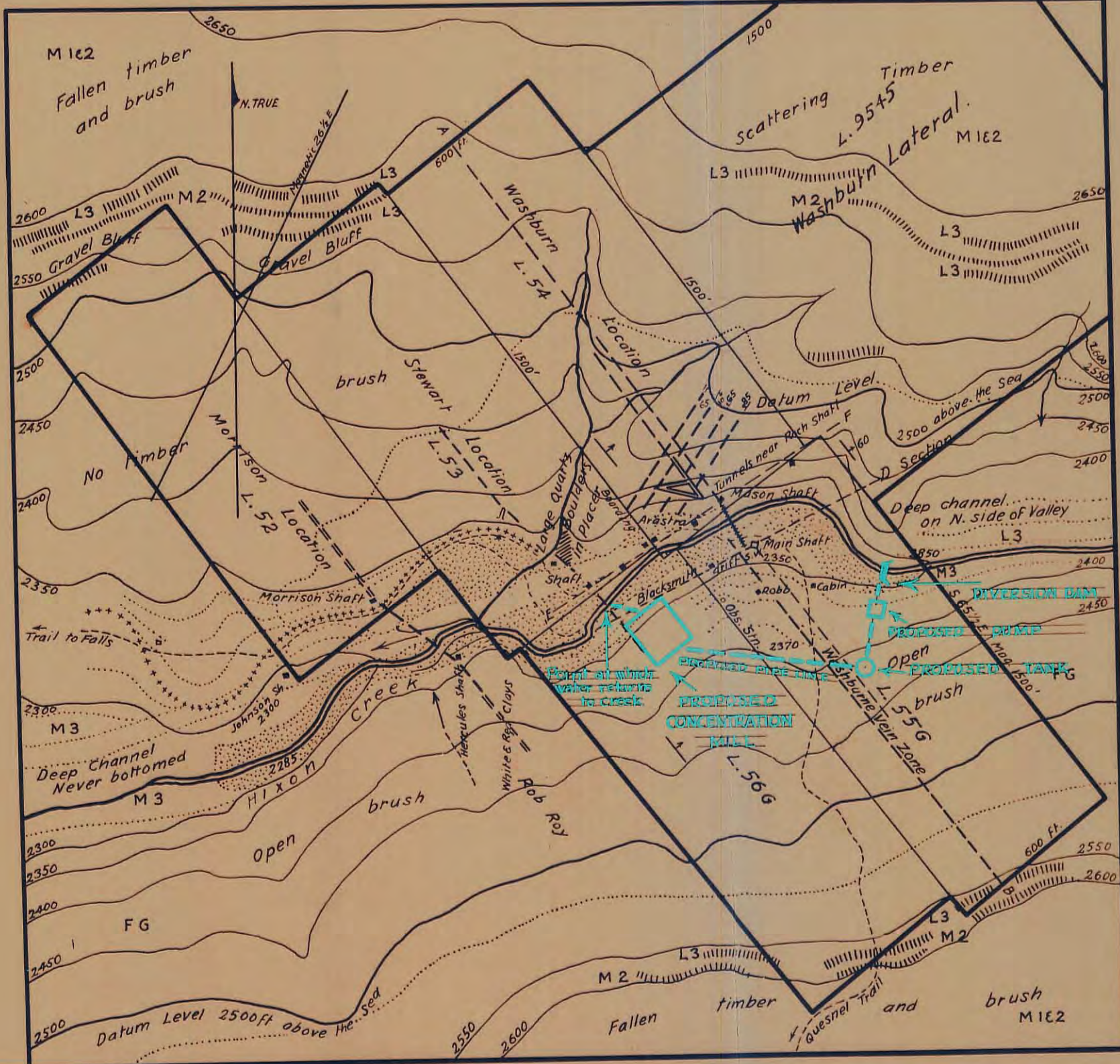

DETAIL MAP OF QUESNELLE QUARTZ MINING CO. MINERAL CLAIMS
 HIXON CREEK, CARIBOO DISTRICT, B.C.
 With Adjacent Placers.

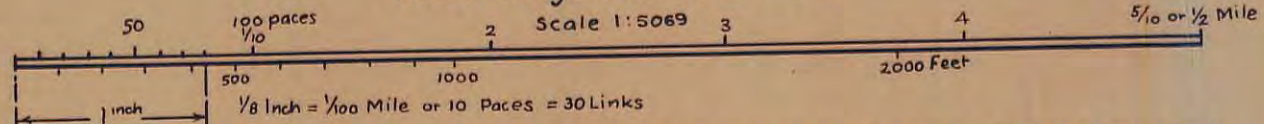

(PARTIAL COPY OF AN OLD MAP TO ACCOMPANY REPORT OF P.E. PETERSON E.M.)

Sketch Showing
PROPOSED CONCENTRATION MILL
 and Water Diversion Pipes
 by
 P.E. PETERSON E.M.

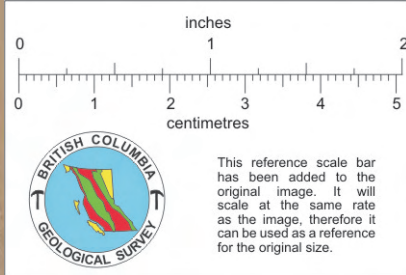

014640