

MEMORANDUM

014546

TO Mr. J. E. McMynn,  
DEPUTY MINISTER

FROM THE

DEPARTMENT OF MINES  
AND PETROLEUM RESOURCES

VICTORIA, B.C., November 5th, 1974

WHEN REPLYING PLEASE REFER  
TO FILE No. 871(17)

Re: ERIC THOMPSON - CALEDONIAN GROUP

Please see the attached file. If Amax does not conclude their option agreement with Thompson, the Government could enter into an option which would permit sampling of the exposed deposit to determine average grades of walls and veins by percussion drilling as recommended by Dr. Holland.

In making this decision it must be realized that this is a "raw" prospect which has been turned down by the experts in the area (Placer - Endako) and by Amax if they do not conclude the agreement presently being negotiated.

*James T. Fyles*

JAMES T. FYLES  
Associate Deputy Minister

JTF:bg

Att: File

*If turned down by Amax, I suggest an agreement with Thompson than a proposal for exploration.*

DEPUTY MINISTER OF MINES  
& PETROLEUM RESOURCES

1394  
REC'D NOV 5 '74

REFERRED	TO	DATE	INITIAL
SECRET			
A. D. M.			
S. D. P.			
M. R.			
E. & P.			
A. D.			
FILE			

Mr. J. E. McMynn,

DEPUTY MINISTER

November 5th

74

871(17)

Re: ERIC THOMPSON - CALEDONIAN GROUP

Please see the attached file. If Amax does not conclude their option agreement with Thompson, the Government could enter into an option which would permit sampling of the exposed deposit to determine average grades of walls and veins by percussion drilling as recommended by Dr. Holland.

In making this decision it must be realized that this is a "raw" prospect which has been turned down by the experts in the area (Placer - Endako) and by Amax if they do not conclude the agreement presently being negotiated.

JAMES T. FYLES  
Associate Deputy Minister

JTF:bg

Att: File

**MEMORANDUM**

TO Dr. J.T. Fyles,  
Associate Deputy Minister.

FROM THE

**DEPARTMENT OF MINES  
AND PETROLEUM RESOURCES**

VICTORIA, B.C., October 15th, 1974

WHEN REPLYING PLEASE REFER  
TO FILE No. PF.93F/15W

Re: Caledonia molybdenum property (93F/15W)

A report on the Caledonia molybdenum property by Tom Schroeter is attached.

The owner, Eric Thomson of Vanderhoof, has extensively trenched and stripped an area 1,000 by 1,500 ft. Bedrock of equigranular and porphyritic quartz monzonite which is extensively fractured and mineralized by molybdenum bearing quartz veins and stringers is exposed.

Samples from mineralized quartz veins, fresh quartz monzonite and a diorite dyke contain significant amounts of molybdenum.

Schroeter's conclusion is that "the Caledonia property has a good exploration potential".

It does not appear that detailed geological mapping can serve any useful purpose at this stage. A programme of percussion drill sampling of the stripped area is now required.

It is understood that Amax Potash Ltd. is interested in optioning the property for that purpose.



STUART S. HOLLAND,  
Chief Geologist, Geological Division,  
Mineral Resources Branch.

SSH/jr

Attd. - report

10925

OCT 15 '74 PM

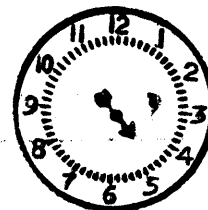

**DEPT. OF MINES  
AND PETROLEUM RESOURCES**

REFERRED TO	DATE	INITIAL
D.M.L.		
ADM (M)	1/1/25	JS
ADM (P)		
C.G.C.		
C.P.R.		
DCGC		
ACPR		
G.C.		
ACCTS.		
GEO.		
INSP.		
REVIEW		
C.C.P.		
FILE NO.		
FILING CLERK		

PROPERTY EXAMINATION

CALEDONIA GROUP

FRASER LAKE, B.C.

93F/15W

TABLE OF CONTENTS

	Page
SUMMARY	1
LOCATION AND ACCESS	1
OWNERSHIP	1
PAYMENTS AND MINERAL RIGHTS	2
HISTORY AND EXPLORATION TO DATE	2
REGIONAL GEOLOGY	3
PROPERTY GEOLOGY	3
MINERALIZATION	4
EXPLORATION POTENTIAL	4

SKETCHES

1. Location and Access
2. Claim Status
3. Property Outlay and Sampling Sketch

TABLES

Work on Mineral Claims

26 September 1974

Tom Schroeter,  
District Geologist,  
Department of Mines and  
Petroleum Resources,  
Smithers, B.C.

SUMMARY

On September 25th I examined the Caledonia Group consisting of 30 contiguous claims situated approximately 8 miles south-southwest of Fraser Lake. The geology and mineralization is similar to that at the Endako Molybdenum Mine located approximately 10 miles to the northwest. Quartz veins, with significant 'ribbon-type' molybdenum, ranging in width from 1/4 inch to greater than 4 feet intrude equigranular and porphyritic quartz monzonite. Younger 'dioritic' and andesite dykes cut the intrusive rocks. Fracture density is intense with three prominent directions noted. The total surface area of trenching and stripping measures approximately 1500 feet by 1000 feet with molybdenum bearing quartz veins observed in most trenches.

Little detailed exploration work has been carried out on the property. The Caledonia molybdenum prospect warrants further exploration.

LOCATION AND ACCESS

The Caledonia claim group is situated approximately 8 miles south-southwest of the village of Fraser Lake which is approximately 100 miles west of Prince George on the Yellowhead Highway 16. The latitude is 53°58' and the longitude is 124°50'. The property lies on the north face of a ridge which slopes towards the Nithi Valley. The property is accessible by 2-wheel drive vehicle along the Glenannan road to the east end of Francois Lake and then south along the road to Laurie Lake.

OWNERSHIP

The Caledonia group of claims is owned by Eric D. Thomson, He lives in Vanderhoof and his mailing address is Box 705, Vanderhoof, B.C. He holds Free Miner's Certificate No. 118209.

PAYMENTS AND MINERAL RIGHTS

The Caledonia group consists of 30 contiguous claims. The Group Notice No. is 2966. The claims included in the group are Caledonia 1 to 27 inclusive and Caledonia 29, 31 and 33 (see copy).

Assessment fees and rental fees were recorded August 9th, 1974 for a period of one year (i.e. Aug. 13/75 and Oct. 5/75 respectively). Stripping and trenching was the physical work recorded.

HISTORY AND EXPLORATION TO DATE

The Caledonia claim group was staked 9 years ago and has been kept in good standing since by Eric Thomson, a local prospector from Vanderhoof. Thomson has worked on several occasions for various mining companies as a cat operator in the area. His Caledonia property has undoubtedly been examined by numerous mining companies since. Julian Mining Co. was one of the first companies to examine the property. They did a small amount of trenching. Thomson put in several (30) of his own trenches. However, due partly to forestry regulations he stopped trenching in well timbered areas. Many of his trenches hit bedrock, but not all. Numerous quartz veins with molybdenum were encountered in the trenches. Amax, under Vim Lodder, sampled the area and carried out a limited induced polarization survey, apparently without success. Endako Mines, under Ed Kimura, also examined the property.

Although no lines have been cut over the property, flagged lines were noted, probably indicative that a geochemical soil survey has been conducted. There has been no drilling done on the property.

Amax, under Fred Harris, has re-examined the property this summer and apparently are in the process of drawing up an option agreement for a 20-hole percussion drilling program.

## REGIONAL GEOLOGY

The Caledonia claim group is underlain by a phase of the Topley Intrusions, which include more than ten phases of granitic rock within a large area extending from Helene Lake (17 miles north of Fraser Lake) south to Hallett Lake (18 miles south of Fraser Lake). Most phases are quartz monzonites. Mineralization within these quartz monzonites and alaskites is almost exclusively molybdenite, very little copper. The major Endako molybdenum deposit is situated approximately 10 miles to the northwest of the Caledonia property. The Endako body is hosted by the Endako quartz monzonite phase, a medium to coarse grained equigranular rock. Quartz veining with "ribbon-filled" molybdenum constitutes the main mineralization. Fracture density is intense. The accepted theory for structural control of the ore is a doming resulting from extreme pressures and uplift.

The rock type on the Caledonia claim group resembles the Endako quartz monzonite phase. However, it is noticeably porphyritic. Alteration features are similar and mineralization characteristics are similar. Fracture density is strong.

The best reference to the Endako area may be found in the B.C.D.M. Annual Report for 1965 on pages 114 to 138.

## PROPERTY GEOLOGY

The Caledonia group is underlain by quartz monzonite. Intruding the quartz monzonite are two types of dykes, one is dioritic in appearance and the other is a dark green andesitic dyke. The age with reference to mineralization of the dioritic rock is not known. The andesitic rock is definitely post mineral in age. There appears to be two varieties of quartz monzonite, both probably related, but one is noticeably porphyritic with large (up to 4" long) phenocrysts of orthoclase. Fracturing is intense within the monzonites (i.e. 6 fractures per foot). Three prominent directions of fracturing and quartz veining are: 025°, 115°, and 160°. Molybdenum occurs in



all three sets. In addition gouge zones with or without quartz veins carry significant molybdenum. There appears to have been a significant quartz 'flushing' into the quartz monzonite. In the vicinity of the quartz veins and gouging, significant secondary potash alteration exists in the monzonite.

The total surface area where trenching and stripping has been carried out measures about 1500 feet by 1000 feet.

Samples have been collected for assay over various key locations in trenches.

#### MINERALIZATION

Mineralization observed on the Caledonia property is similar to that at the Endako Molybdenum Mine. The host quartz monzonite is intensely fractured and cut by numerous quartz veins ranging in width from 1/4 inch to greater than 4 feet. Ribbon-type molybdenite occurs in the quartz veins as well as gouge seams within the rock. Three prominent directions of fracturing and quartz veining with molybdenum were observed. The strikes of these prominent quartz veins are: 025°, 115°, and 160°. The wallrock adjacent to the quartz veins has been altered to various intensities. One particular sample was taken from the 'fresh' quartz monzonite (6"), through the altered monzonite (6") and into the quartz vein (4"). The overall direction of the quartz veining system appears to be in an east-southeasterly direction. Molybdenum mineralization was noted in trenches over a surface length of at least 1500 feet. Minor amounts of chalcopyrite were observed. Magnetite appears to be a significant accessory mineral, as does pyrite.

#### EXPLORATION POTENTIAL

The Caledonia property has a good exploration potential.

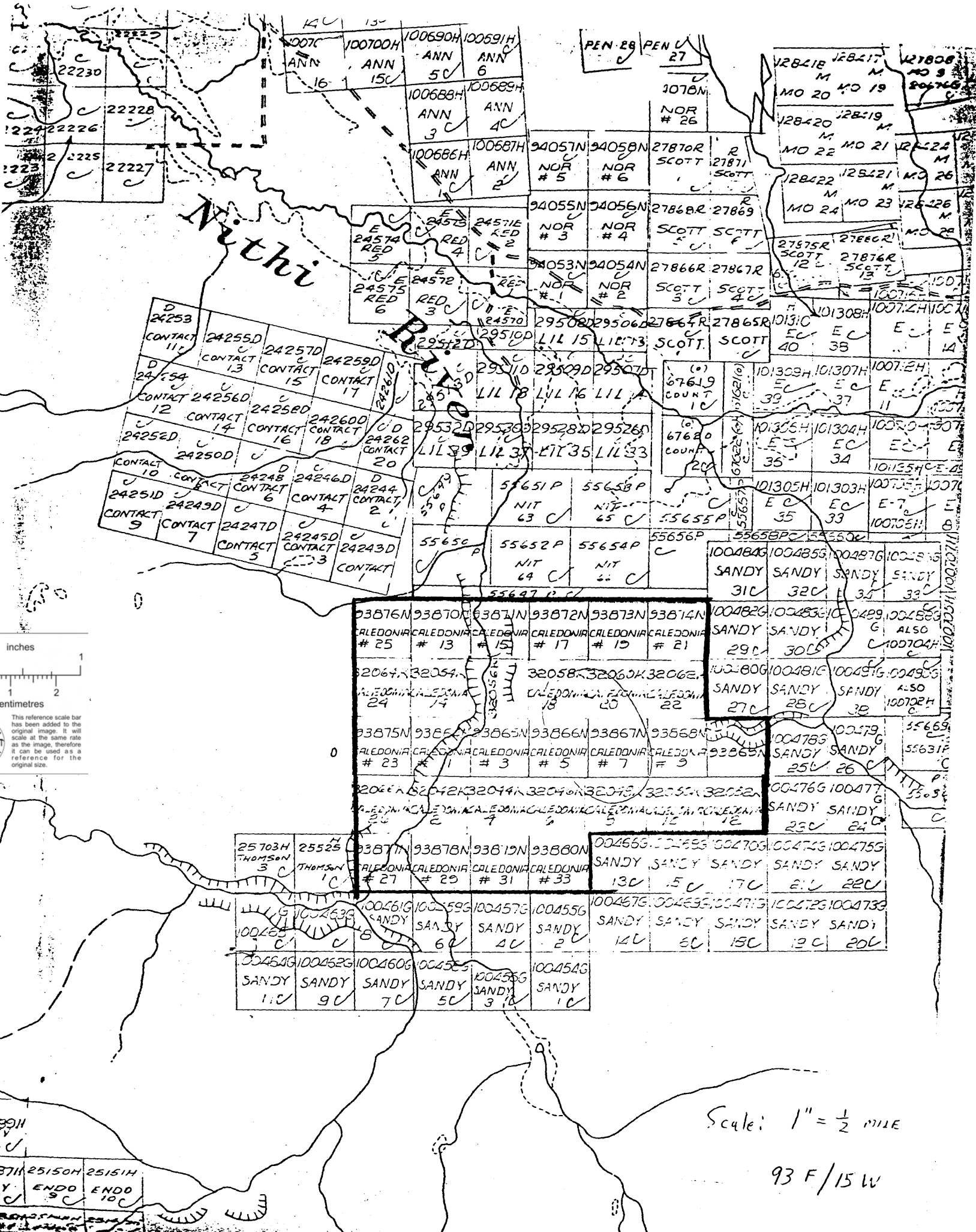

0 1  
inches  
0 1 2  
centimetres

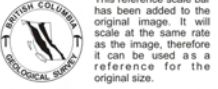

Scale: 1" = 1/2 mile

93 F/15 LW

31389H KEY 1 22	25150H KEY 20	25151H ENDD 10
31387H KEY 1 20	25150H KEY 9	25151H ENDD 10

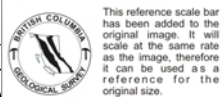
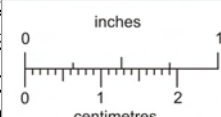
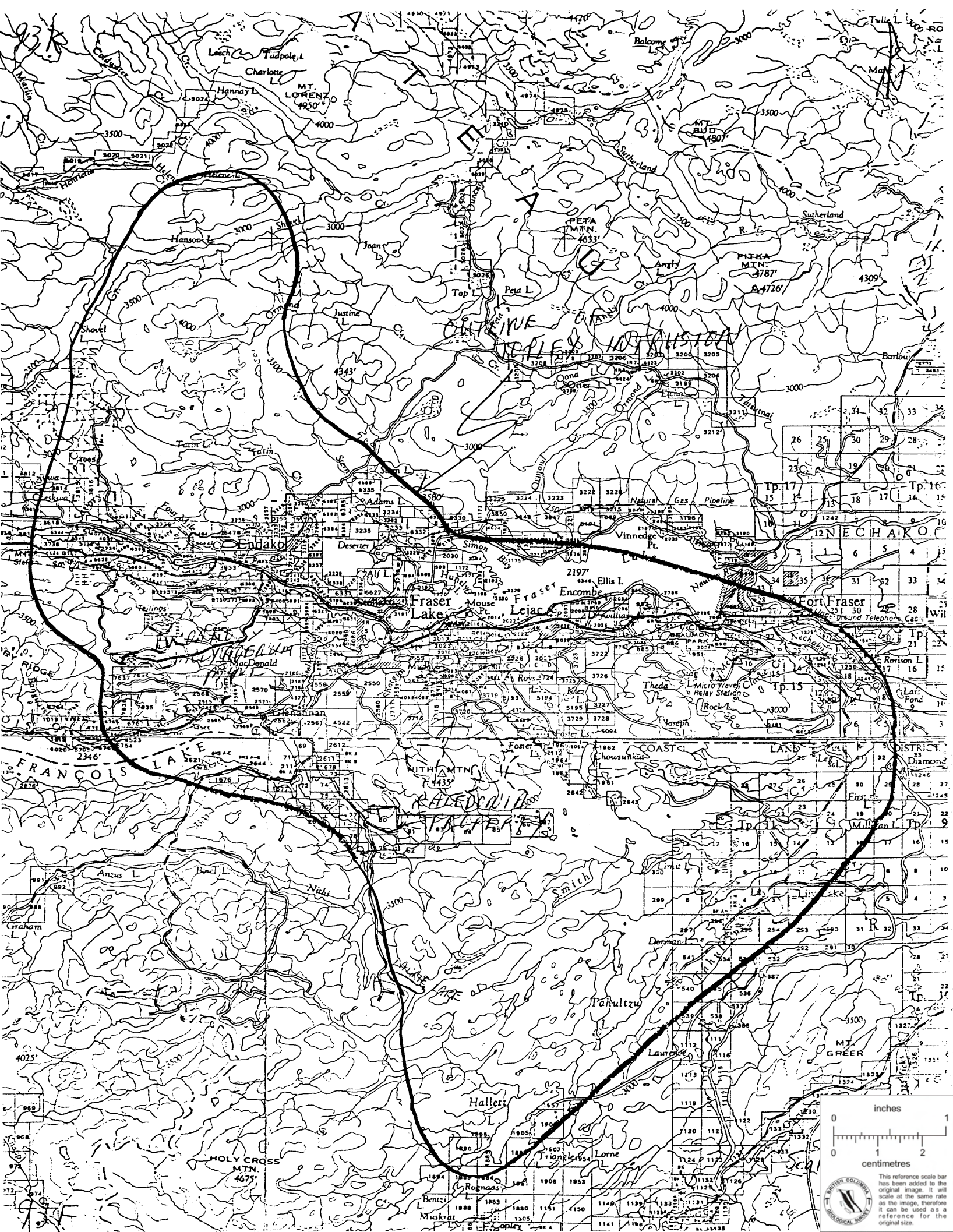

This reference scale bar has been added to the original image. It will scale at the same ratio as the image, therefore it can be used as a reference for the original size.

**WORK SHEET**

**APPLICATION OF WORK ON MINERAL CLAIMS**

MINING DIVISION OMINECA MINING RECEIPT NO. 92156E AMT. \$ 300.00

NAME OF GROUP Caledonia GROUP NOTICE NO. 2966 DATE RECORDED NG Oct 5/70  
W Aug 9/74  
(IF ANY)

NUMBER OF YEARS  
AND TYPE OF WORK  
(EACH CLAIM)

TOTAL  
YEARS

WORK NUMBER(S)	NAME(S) OF CLAIM(S)	RECORD NUMBER(S)	WORK DONE SINCE (LAST ANNIV. DATE)	PENALTY FEES \$	NUMBER OF YEARS AND TYPE OF WORK (EACH CLAIM)						TOTAL YEARS
					PHYSICAL	DRILLING D	LEGAL SURVEY S (SINGLE CLAIM)	GEO. SURVEY G	PROSPECTING P	LEGAL SURVEY S (PERIMETER)	
1959	Caledonia No. 2	32042	Aug 13/73		1						1
1960	Caledonia No. 4	32044	Aug 13/73		1						1
1961	Caledonia No. 6	32046	Aug 13/73		1						1
1962	Caledonia No. 8	32048	Aug 13/73		1						1
1963	Caledonia No. 10	32050	Aug 13/73		1						1
1964	Caledonia No. 12	32052	Aug 13/73		1						1
1965	Caledonia No. 14	32054	Aug 13/3		1						1
1966	Caledonia No. 16	32056	Aug 13/73		1						1
1967	Caledonia No. 18	32058	Aug 13/73		1						1
1968	Caledonia No. 20	32060	Aug 13/73		1						1
1969	Caledonia No. 22	32062	Aug 13/73		1						1
1970	Caledonia No. 24	32064	Aug 13/73		1						1
1971	Caledonia No. 26	32066	Aug 13/73		1						1
1972	Caledonia #1	93864	Oct 5/73		1						1
1973	Caledonia #3	93865	Oct 5/73		1						1
1974	Caledonia #5	93866	Oct 5/73		1						1
1975	Caledonia #7	93867	Oct 5/73		1						1
1976	Caledonia #9	<del>93868</del> 93868	Oct 5/73		1						1

TOTAL ALL YEARS 18

**WORK SHEET**

**APPLICATION OF WORK ON MINERAL CLAIMS**

MINING DIVISION OMINECA MINING RECEIPT NO. 92156E AMT. \$ 300.00

NAME OF GROUP Caledonia GROUP NOTICE NO. 2966 DATE RECORDED - N G Oct 5/70  
 (IF ANY) - W Aug 9/74

NUMBER OF YEARS  
AND TYPE OF WORK  
(EACH CLAIM)

TOTAL  
YEARS

WORK NUMBER(S)	NAME(S) OF CLAIM(S)	RECORD NUMBER(S)	WORK DONE SINCE (LAST ANNIV. DATE)	PENALTY FEES \$	PHYSICAL	DRILLING	LEGAL SURVEY (SINGLE CLAIM)	GEO. SURVEY	PROSPECTING	LEGAL SURVEY (PERIMETER)	TOTAL YEARS
						D	S	G	P	S	
					Cont'						18
1977	Caledonia #11	93869	Oct 5/73		1						1
1978	Caledonia #13	93870	Oct 5/73		1						1
1979	Caledonia #15	93871	Oct 5/73		1						1
1980	Caledonia #17	93872	Oct 5/73		1						1
1981	Caledonia #19	93873	Oct 5/73		1						1
1982	Caledonia #21	93874	Oct 5/73		1						1
1983	Caledonia #23	93875	Oct 5/73		1						1
1984	Caledonia #25	93876	Oct 5/73		1						1
1985	Caledonia #27	93877	Oct 5/73		1						1
1986	Caledonia #29	93878	Oct 5/73		1						1
1987	Caledonia #31	93879	Oct 5/73		1						1
1988	Caledonia #33	93880	Oct 5/73		1						1

TOTAL ALL YEARS 30

CALEDON A

93F/15W

<u>SAMPLE NUMBER</u>	<u>SAMPLE WIDTH</u>	<u>DESCRIPTION</u>	<u>No</u>
CAL - 1	6"	'Fresh' quartz monzonite adjacent to sample CAL -2.	<del>0.70</del> 0.003
CAL - 2	6"	'Altered' (clay) quartz monzonite adjacent to quartz vein.	<del>0.003</del> 1.73
CAL - 3	4"	Mineralized quartz vein (MoS <sub>2</sub> ) in quartz monzonite.	0.023 0.003
CAL - 4	1'	Grab sample of diorite dyke.	<del>1.73</del>
CAL - 5	16"	Mineralized quartz vein (MoS <sub>2</sub> ), plus magnetite in quartz monzonite.	0.70 <del>0.003</del>
CAL - 6	4'	Mineralized quartz vein (MoS <sub>2</sub> ) plus pyrite and magnetite in quartz monzonite.	0.38
CAL - 7	1'	Gouge and quartz vein (+MoS <sub>2</sub> ) in quartz monzonite.	1.23
CAL - 8	6"	Gouge and quartz vein (+MoS <sub>2</sub> ) in quartz monzonite.	0.19
CAL - 9	6"	Gouge and quartz vein (+MoS <sub>2</sub> ) in quartz monzonite .	4.31
CAL -10	2'	Quartz vein with high grade MoS <sub>2</sub> and magnetite.	0.75

Yours truly,

*Tom Schroeter*

Tom Schroeter,  
District Geologist

TS/hh

# CALEDONIA - PROPERTY

"Rough sketch" 25/9/74  
T. Schröter.



UPPER AREA (Hill)

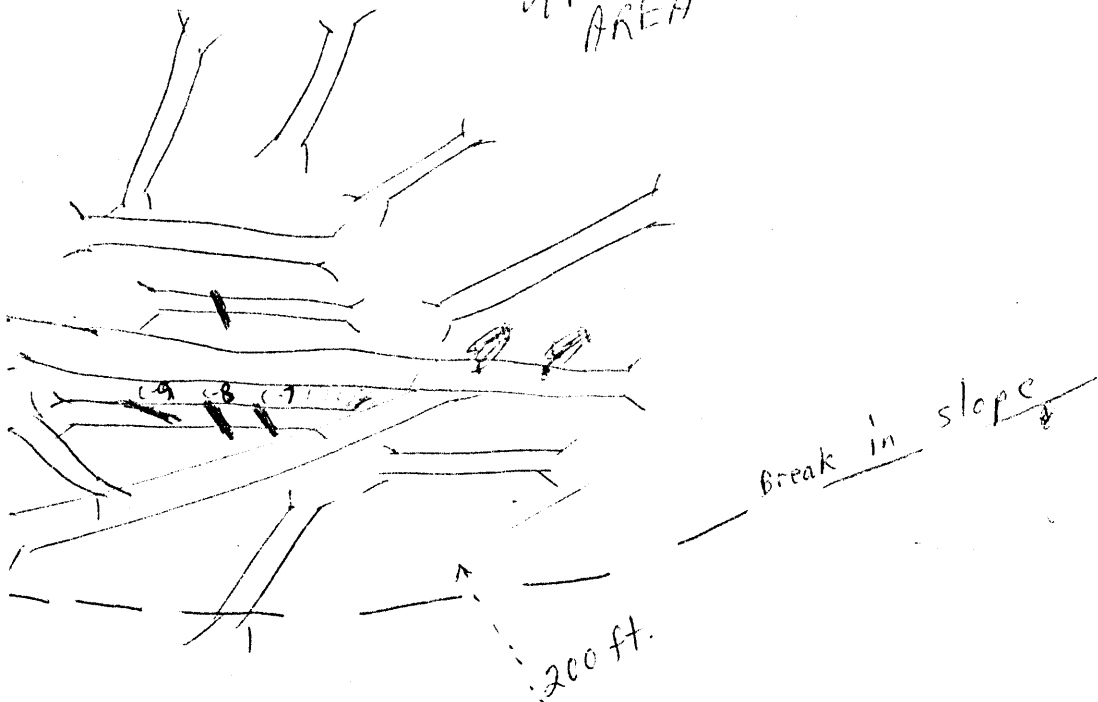

LOWER AREA

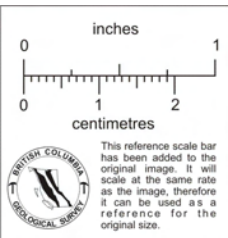
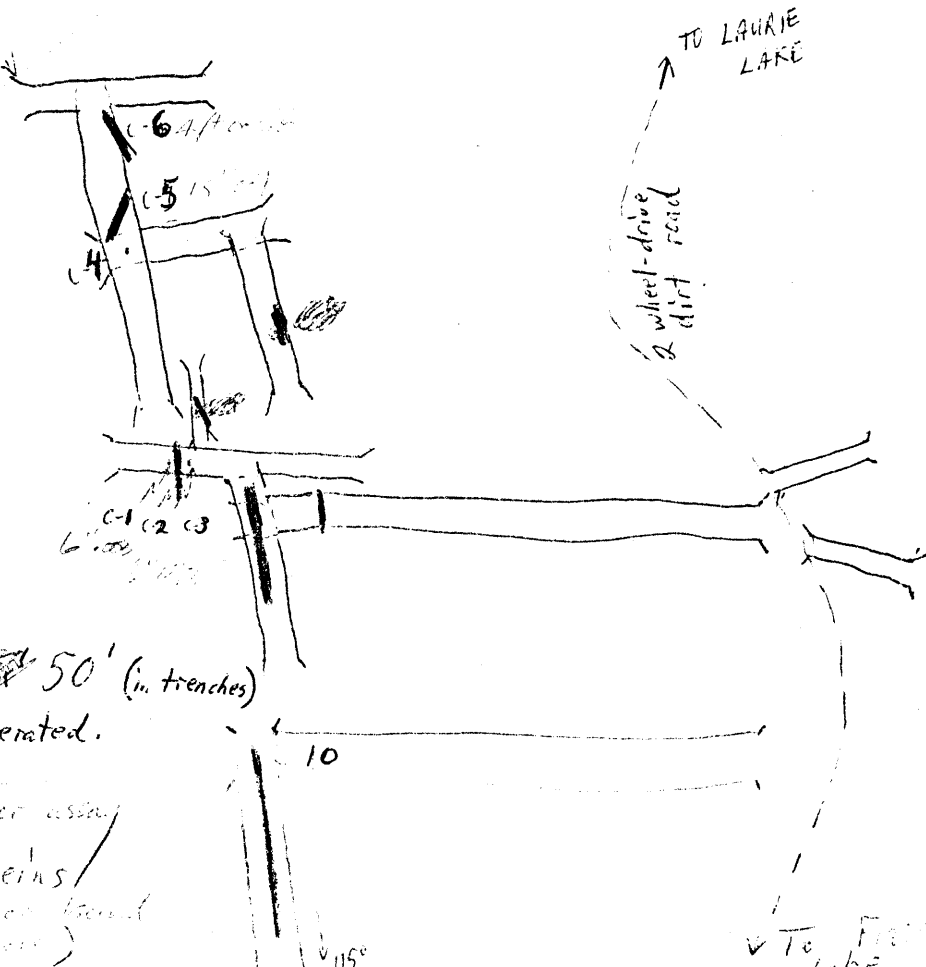

Scale: Approx. 1" = ~~100~~ 50' (in trenches)  
- otherwise scale is exaggerated.

- C-2 Samples taken for assay
- Mineralized quartz veins (Note: only veins sampled on level are shown here)



2322

DEPARTMENT OF MINES AND PETROLEUM RESOURCES  
VICTORIA

RECEIVED  
OCT 21 1974  
SIA

SAMPLE RECEIVED FROM..... T. SCHROETER (N. C. Carter)

ADDRESS..... Geological Division

LABORATORY No.	SUBMITTER'S MARK	LABORATORY REPORT	
		Cu %	Mo %
14270M	CAL-1	<0.01	<0.003
14271M	CAL-2	0.01	1.73
14272M	CAL-3	<0.01	0.023
14273M	CAL-4	<0.01	0.003
14274M	CAL-5	0.03	0.70
14275M	CAL-6	<0.01	0.38
14276M	CAL-7	0.02	1.23
14277M	CAL-8	<0.01	0.19
14278M	CAL-9	<0.01	4.31
14279M	CAL-10	<0.01	0.75

THIS DOCUMENT, OR ANY PART THEREOF, MAY NOT BE REPRODUCED FOR PROMOTIONAL OR ADVERTISING PURPOSES.

DATE..... October 18, 1974

*W. M. Johnson*  
CHIEF ANALYST AND ASSAYER.



DEPUTY MINISTER



DEPARTMENT OF MINES AND PETROLEUM RESOURCES  
PARLIAMENT BUILDINGS  
VICTORIA, BRITISH COLUMBIA

September 19, 1974

Mr. Eric Thomson,  
Box 705,  
Vanderhoof, B. C.

Dear Sir:

I would like to correct the impression given you by the letter of September 16, 1974 from the Associate Deputy Minister, Dr. J. T. Fyles.

This Department will be glad to assist you. A geologist will examine any data you have and if he considers he should visit your property will so do.

If your property warrants development, the Government will help have it developed and may negotiate participation with you or otherwise assist you in negotiating for development in other ways.

Otherwise, if it is thought that your property does not warrant further work we will so advise you.

Sincerely yours,

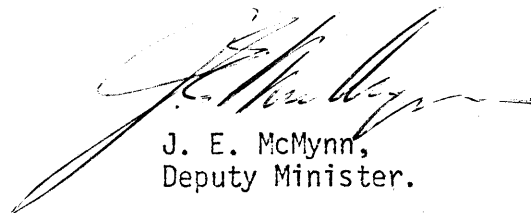

J. E. McMynn,  
Deputy Minister.

JEM:DB

copies to: Hon. L. T. Nimsick  
Mr. Doug Kelly, M.L.A.  
Dr. J. T. Fyles ✓  
Dr. S. S. Holland

September 16, 1974

Mr. Eric Thomson,  
Box 705,  
Vanderhoof, B. C.

Dear Sir:

It has recently been brought to my attention that through Mr. Doug Kelly you have asked the Minister of Mines to participate in the development of a 30-claim molybdenum property which you hold. It is unlikely that the government will participate, but you may wish to submit to this office the details and any report you have on the property. In the department's ongoing work of compiling data on the mineral resources of the province, any data on mineral deposits is of value to us.

Yours very truly,

James T. Fyles  
Associate Deputy Minister  
Mineral Resources

JTF/af

cc.: Mr. J. E. McMynn

Dr. S. S. Holland

20/9  
- showed Tom Schroeder  
- read him this letter  
- Tom has arranged to visit  
properties with Thomson Sept 28  
JTF

16 897 4411  
237

MEMORANDUM

TO Mr. J.E. McMynn,  
Deputy Minister.

FROM THE

DEPARTMENT OF MINES  
AND PETROLEUM RESOURCES

VICTORIA, B.C., March 21st, 1974

WHEN REPLYING PLEASE REFER  
TO FILE NO.....

Re: Caledonia Group

These claims are four miles southeast of the east end of Francois Lake. The ground was held in 1964 by Julian Mining Co. Ltd. who did some trenching and then dropped the claims. The ground was located in 1965 by Thomson and held continuously by him since. Assessment work on the claims is recorded to August 1974.

None of our geologists has been on the ground.

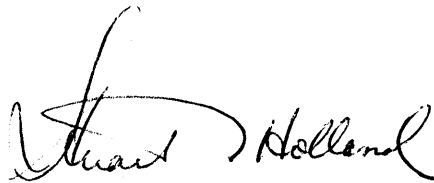

STUART S. HOLLAND,  
Chief Geologist, Geological Division,  
Mineral Resources Branch.

SSH/jr

*No action requested.  
by JEM.*

DEPUTY MINISTER OF MINES  
& PETROLEUM RESOURCES

471  
D MAR 21 '74

REFERRED TO	DATE	INITIALS
TS		
C.		
G. C.		
I.		
M. B.		
P. E.		
FILE	871	

**MEMORANDUM**

TO Hon. Leo T. Nimsick  
Minister Mines and Petroleum  
Resources  
Parliament Buildings

FROM

Doug Kelly, M.L.A. Omineca

March 8 1974

SUBJECT Re: Mining Claim  
Mr. Eric Thompson

OUR FILE

YOUR FILE

93 F / 15W

Dear Sir,

I have been contacted by one of my constituents, a Mr. Eric Thompson, Box 705, VANDERHOOF, B.C. about the matter of his mining claims.

Mr. Thompson who has 30 claims known as the Caledonian Group would like to share the benefits of these claims with the Government of British Columbia. They are a Molybdenum property and apparently of good grade. He states that he has invested \$36,000 in them which I assume that he would like to have returned to himself.

I believe Mr. Thompsons offer to be a generous one. Would you please look into the offer.

Yours sincerely,

*Doug Kelly*  
Doug Kelly, M.L.A.  
Omineca

DEPT. OF MINES  
AND PETROLEUM RESOURCES  
Rec'd MAR 19 1974

DK/sw

DEPT. OF MINES  
AND PETROLEUM RESOURCES  
**RECEIVED**  
MAR 11 1974  
MINISTER'S OFFICE  
VICTORIA, B. C.

4M SE of E end of FRANCIS L.

BOTH SIDES OF NITHI R.

Aug. 13/65 32042 etc held by record work received by Aug/74