

ALLAN P. FAWLEY, PH.D., P.ENG.
CONSULTING MINING ENGINEER AND GEOLOGIST

1947 WEST KING EDWARD AVENUE
VANCOUVER 9, BRITISH COLUMBIA

March 6, 1965

Notes on the Copper Ridge Mines Ltd. claims in the Endako Area

The following notes are largely from "off the record" information and are partly from memory, but are probably accurate.

The Endako MoS_2 deposit covers about 5,000 by 2,000 ft. in an elongated N.W. direction; elsewhere throughout the area there is hardly a trace of MoS_2 .

There are "vast" areas of drift, generally fine sand and clay.

N.W. faults are considered important for ore, but E-W faults may be feeders.

Geochemistry considered to work well even through 50 and more ft. of overburden (!! A.P.F.). (Told Ph and fine sand suitable for colloidal migration upwards). Over deposit about 120 p.p.m.; directly to east of deposit about 70 p.p.m.; remainder of area generally from 5-18 p.p.m.

Glaciation at Endako deposit to S.E. then swings to E. and then to N.E.

A few miles to the E. and N. of the Endako deposit the granite is of a different type and not a speck of MoS_2 can be found.

Conclusions by A. P. Fawley

Copper Ridge hold a very large claim group (over 300) in the Endako Area. Most of the claims appear to be of little value but further work is justified on the claims in the south-western part of the block, including the Rac, Bingo, and Ol groups, the Vimy and Forwest groups (if available), and the south-western parts of the Box and Pal groups (see enclosed claim map).

The 20 claim Bingo group is one of the most favorably located but is completely covered by overburden.

A general outline of the terms requested is that sufficient money be spent the first year to keep the claims in good standing, three times that amount be spent in the second year, and 5 times that amount in the third year.

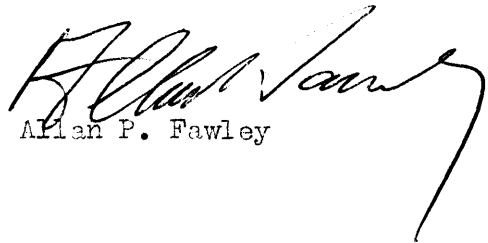

Allan P. Fawley

**CLAIM GROUPING
COPPER RIDGE MINES LTD.
ENDAKO B.C.**

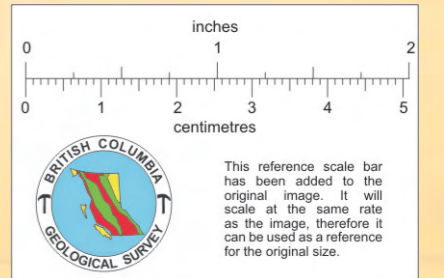
1 INCH = 3000 FEET

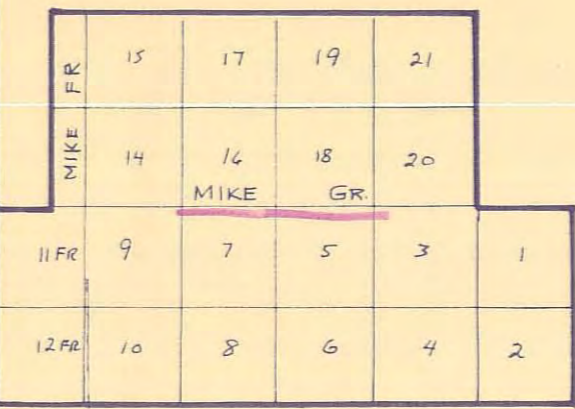
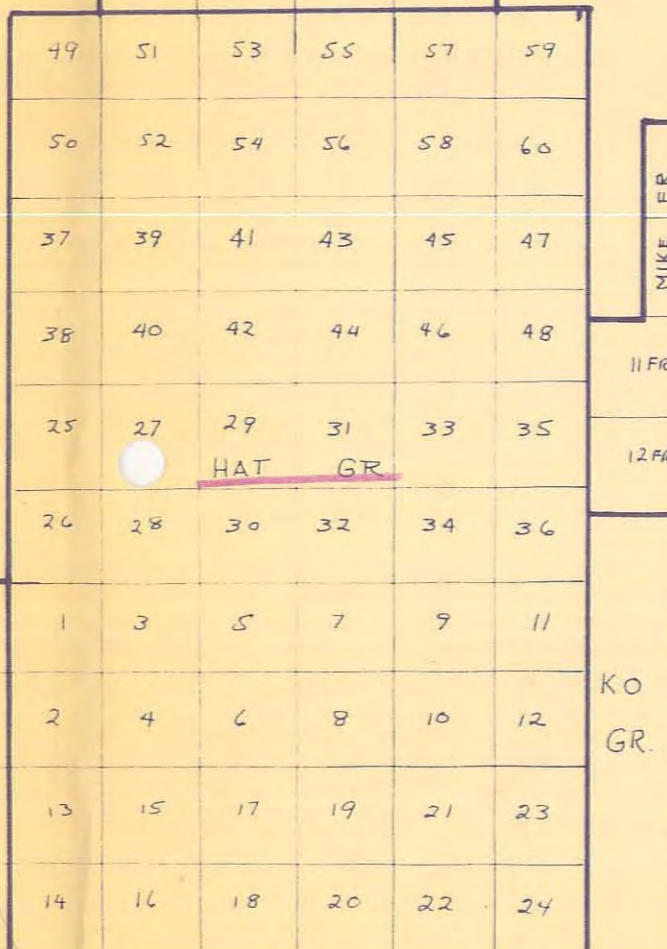

FAT GROUP
ENDAKO MINES



PIE FR. STAKED Oct 12/64
RECORDED Oct 13/64

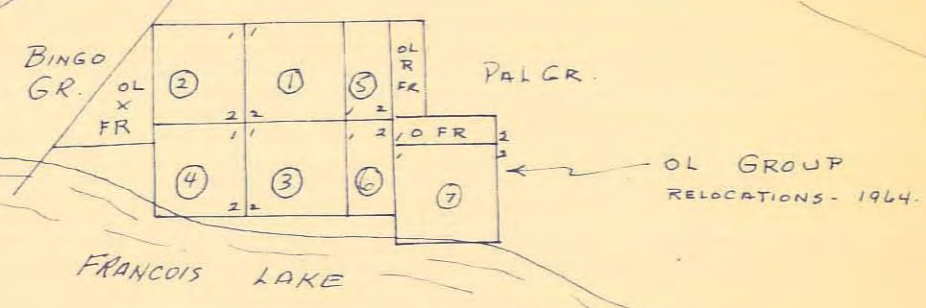

Direction of glacial movement

5-18 PM
N.W. 7 and 5 info