



092JNE131, 020, 090

To: Vic Preto, Manager
Applied Programs

014056

Date: October 16, 1985

Our File:

Re: Notes on the Gold Bridge area: addendum to memo of October 9, 1985

LEVON RESOURCES

Congress Property

CONGRESS - LOU (10) 92JNE131 ✓

-02

Brad Aelicks, geologist with Levon, states that a feldspar porphyry dyke at the Lou discovery sight was dated at 65×10^6 years of age.

The Lou zone was discovered in an area of extensive overburden by trenching as a result of a soil, antimony anomaly. Mineralization in this replacement type deposit has quartz, ankerite, mariposite, stibnite, realgar (kermesite), arsenopyrite, pyrite and minor tetrahedrite.

Results from the percussion drilling indicate 0.845 ounces (29 grams) of gold over 10 feet (3.3 metres) apparent width and 0.011 ounces (0.4 grams) of gold over 8 feet (2.6 metres) (G.C.N.L. October 7, 1985).

BRX Property 92JNE020

Levon Resources report 560 ounces (19,198 grams) of gold and 400 ounces (13,713 grams) of silver from a grab sample in a new zone. (G.C.N.L. October 7, 1985). The BRX group of properties lies between the old Bralorne mine and Gold Bridge to the north. Rocks underlying the BRX ground consist of almost every rock type in the area exclusive of the Noel Formation and the Bendor Batholith. The rocks have been subjected to intense faulting and shearing.

Ranger Property 92JNE090

Levon also report grab sample results of 2.87 ounces (98.4 grams) of gold and 6.37 ounces (218.4 grams) of silver. This property is helicopter supported. (G.C.N.L. October 7, 1985).

WARSTAR RESOURCES

Underlain by similar geology to the Lou zone on the Congress property to the south, trenching and drilling did not appear to come up with a major discovery. The Alpha and Beta zones are silicified and altered greenstones contain pyrite, arsenopyrite, mariposite, galena and sphalerite along shears. Gold values reported of 0.2 ounces (6.9 grams) appear to be spotty.

Quoted as:

EMPR OF (Notes on Gold Bridge Area, G. White, Oct 1985)

Vic Preto (Memorandum)
Page 2
October 16, 1985

X-CALIBRE RESOURCES

West of Warstar and north of the Congress the Tyax claim group underlain by Ferguson Group rocks have anomolous arsenic (566 ppm) and gold (1670ppb) in altered greenstone. Percussion drilling was planned in October or November.

GOLD BRIDGE MINERALIZATION

Free gold, or gold with sulphides often with quartz/ankerite alteration appears to have no affinity for any particular rock type and is structurally controlled. Mineralization is vein type, or replacement along shear zones of variable widths, or, the mineralization may be a combination of these two types of emplacement. There is an unusual mix of mesothermal to epithermal minerals, arsenopyrite, pyrite, calcite, quartz, mariposite, stibnite, galena, sphalerite and realgar to name some of the minerals present.

There are a number of dykes and intrusives in the area of mineralization, and a sodic granite, and/or an altered feldspar (plagioclase) porphyry dyke rock may be the source of the mineralizing solutions.

The admixture of mesothermal and epithermal metallic minerals deposited in strong structures may indicate good depth possibilities with these new discoveries.



Gordon P. E. White, P.Eng.
District Geologist

GPEW/lc
Enclosure - Map

Addendum to Gold Bridge Report dated October 9, 1985



Congress Property - Levon Resources "Lou" zone discovery.
- view to north. Gold Bridge area.

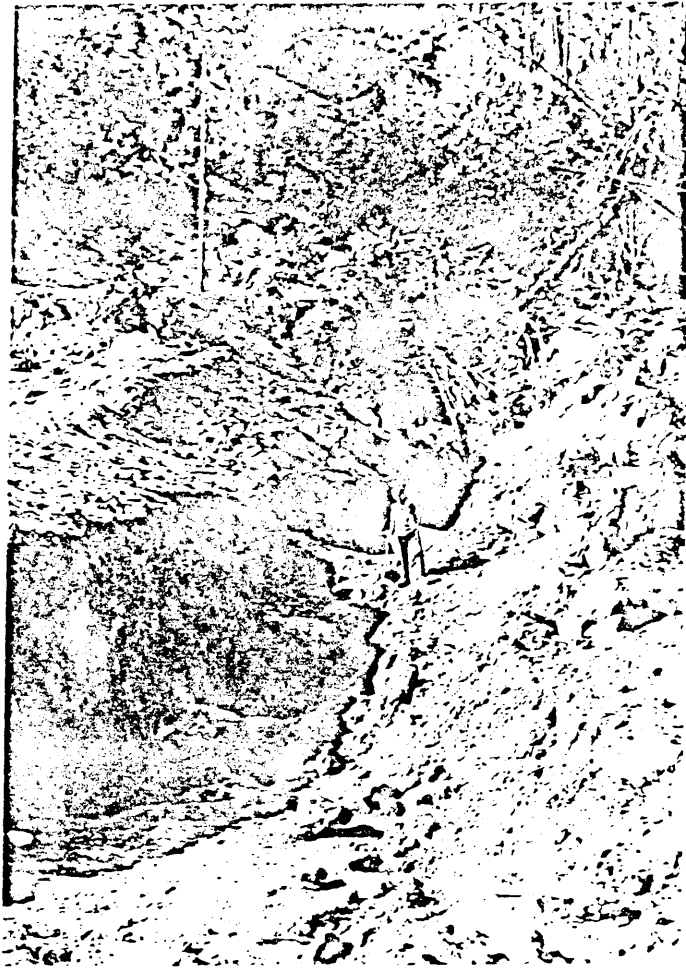

Levon Resources discovery pit on "Lou" zone, - view to west - maroon volcanic flows are silicified and mineralized. Altered feldspar (plagioclase) dyke in shadow below person standing and nearer white ridge in shadow is silicified and brecciated host rock of altered and sheared volcanics, (0.07 oz. (2.4 gms) Au over 20 metres).



Levon Resources "Lou" zone, approximately 100 metres of discovery trench of south. Dark blue to left is cherty argillite sharply contacted with plagioclase feldspar porphyry.

The feldspar porphyry at this location appears to be concordant with the attitude of the Ferguson Group (mid-Triassic) sediments and the sill or dyke extends to 12 metres to the right and west of this contact.

GOLD BRILL DE AREA, BC.

VEIN & REPLACEMENT DEPOSITS

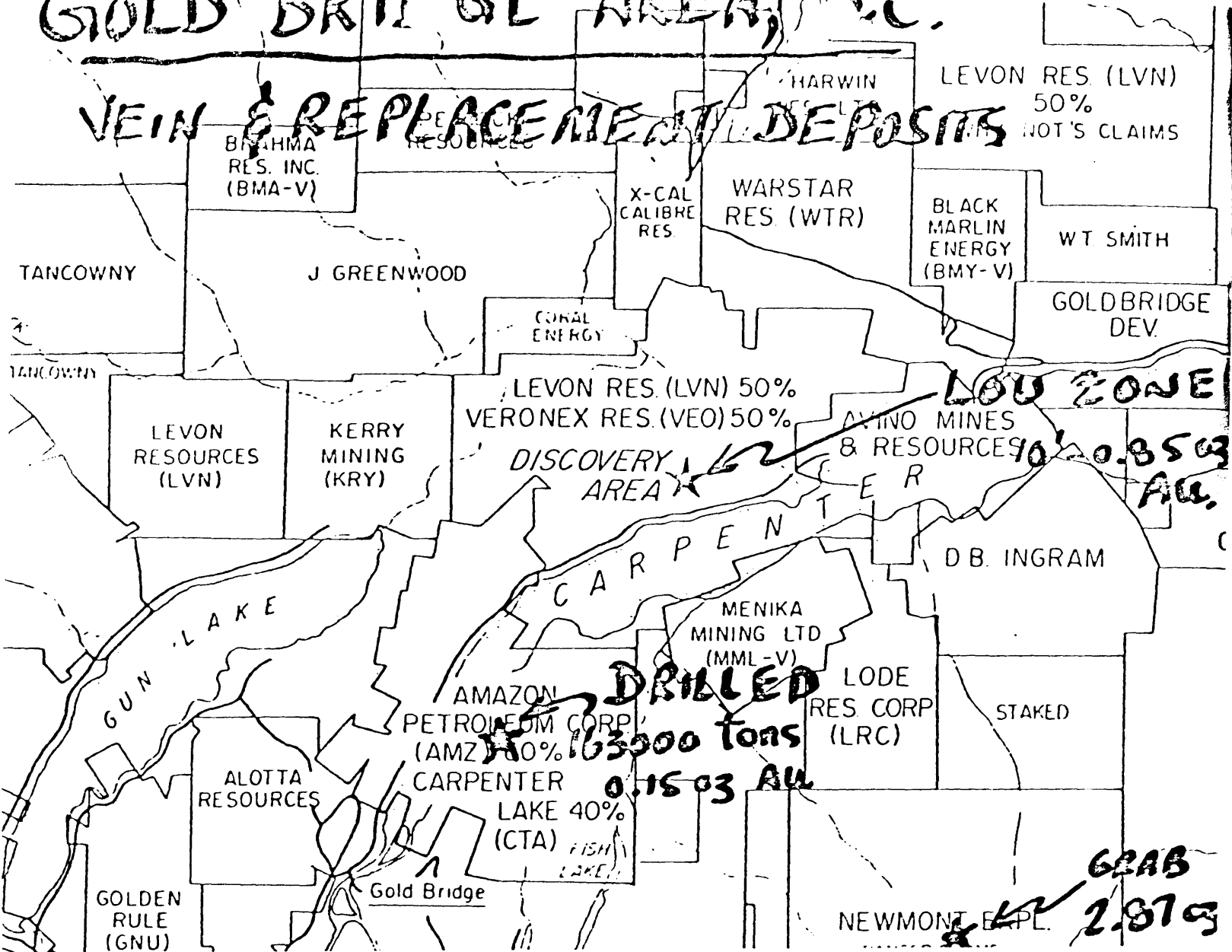

Y-ML -TYAX

DESIGN CORPORATION

DESIGN CORPORATION

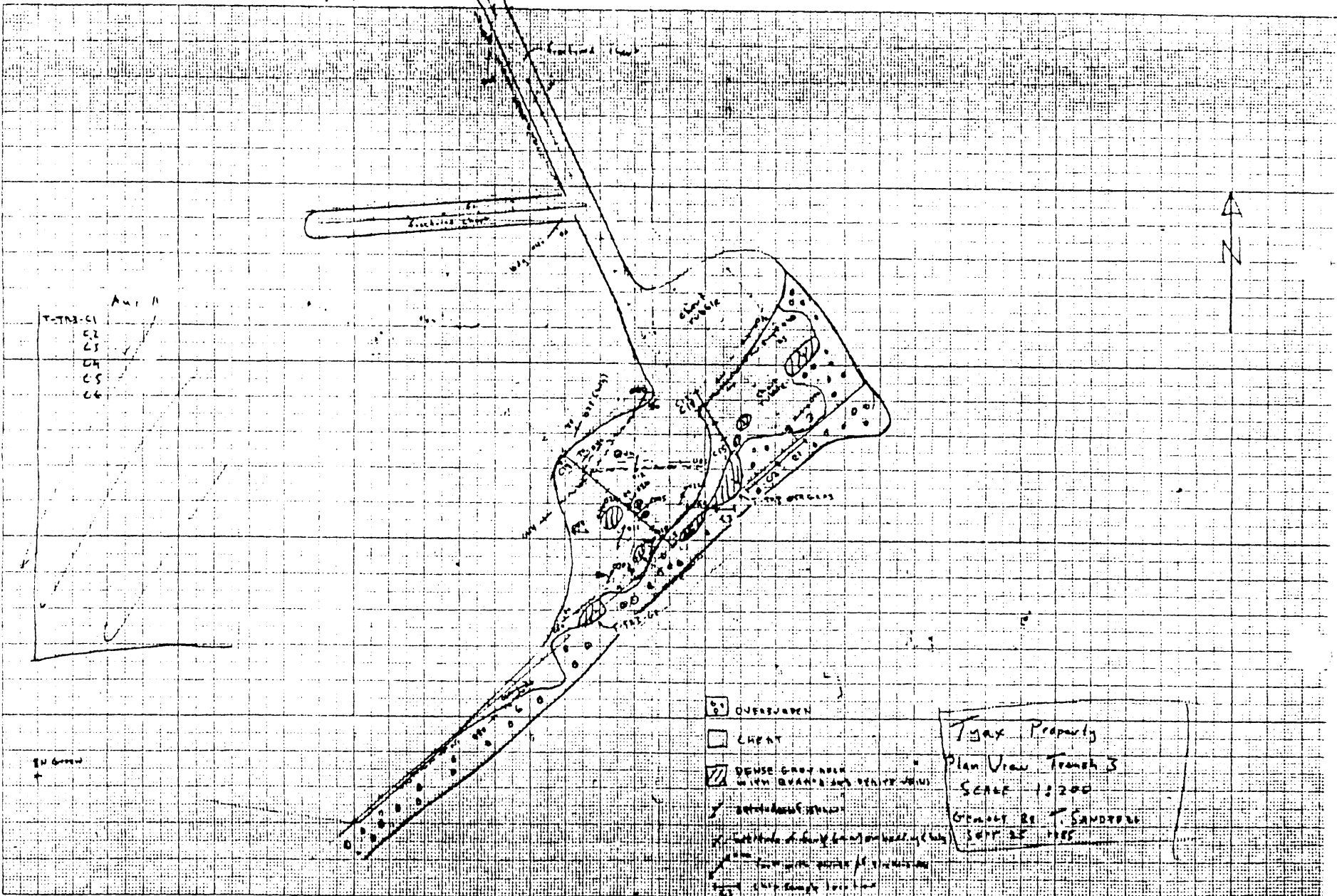

T-TYAX-C1 Soil sample location
 = what sort of samples are there, Gary?