

Scheelite Notes - Page 1

93A/14W

Burns - Lamp
Cross Notes
June 2nd 42

Cariboo Hudson

Location No	Description of Cavity	Width of Vein
1	lamped all quartz veins - No WOs	
2	dissem. wash.	
3	6" x 1/2" 50% Wog	2'
4	Disseminated wash.	
5	wash @ base of vein.	7x3 face.
6	2' heavy wash on foot of drift.	
7	nil.	
8	nil.	
9	dissem scheelite 6" x 1" 25% ore.	
10	wash. (W. wall)	
11	1/4" scheelite (W. wall)	
12	2' Wash on W wall	
13	2' 10% scheelite	
14	Wash - on back.	
15	4' 50% scheelite	
16	30' 10% scheelite and wash.	
17	< 1% scheelite	
18	5% scheelite disseminated on E wall.	
19	< 1% scheelite - along walls and back.	
20	40' dissem. wash (10%).	
21	< 5% disseminated scheelite.	
22	1/4" x 1 1/4" E wall.	
23	1' Wash.	
24	4' x 4" 50% scheelite 6' x 1" 50% - 1' x 2" 50% 1' x 2" 30%.	

Portal Sheet

Schedule Notes - 1822 only.
June 2nd 42 - P. 1.

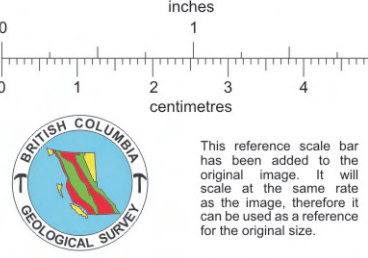

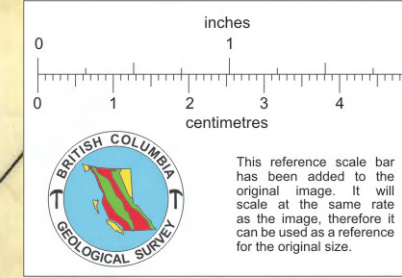

Schachtel Notes - 21621, 23-24 inclusive
June 2nd, P1

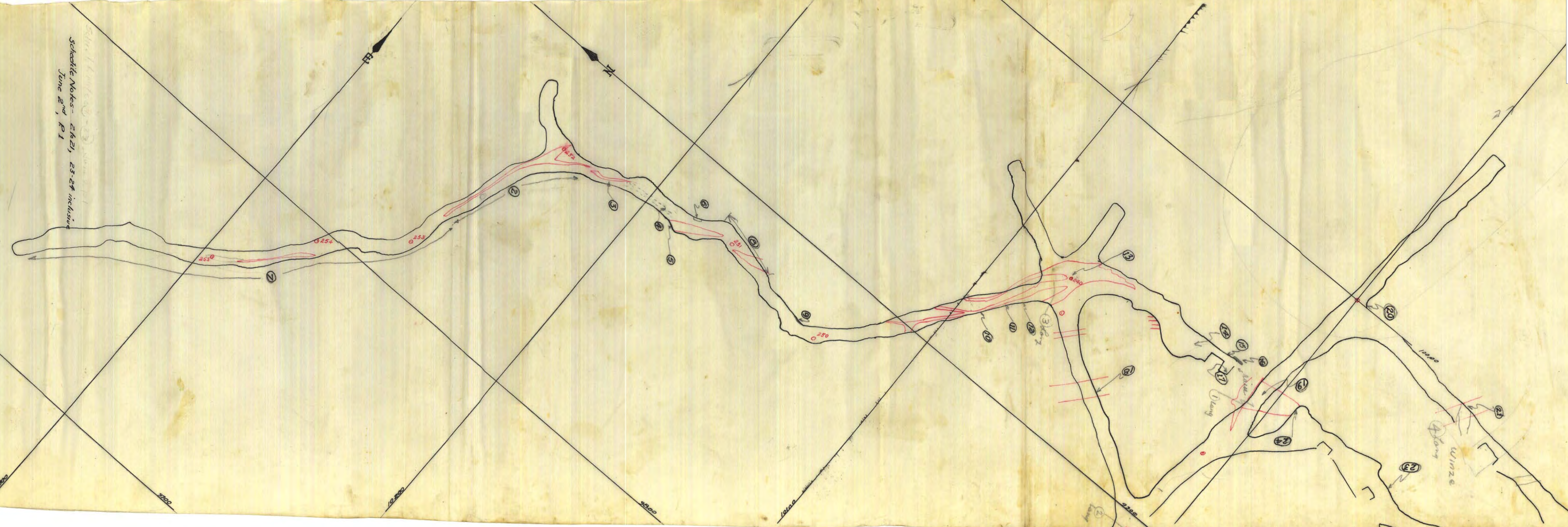

Map of Schachtel