

PLAN SHOWING HORSEFLY RIVER

HARPERS CAMP

Accompanying Report of J.D. Galloway on proposed Keystone Drilling.

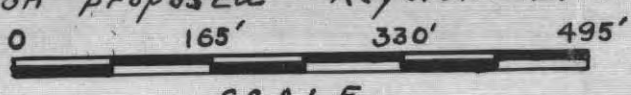

SCALE.
July 1918.

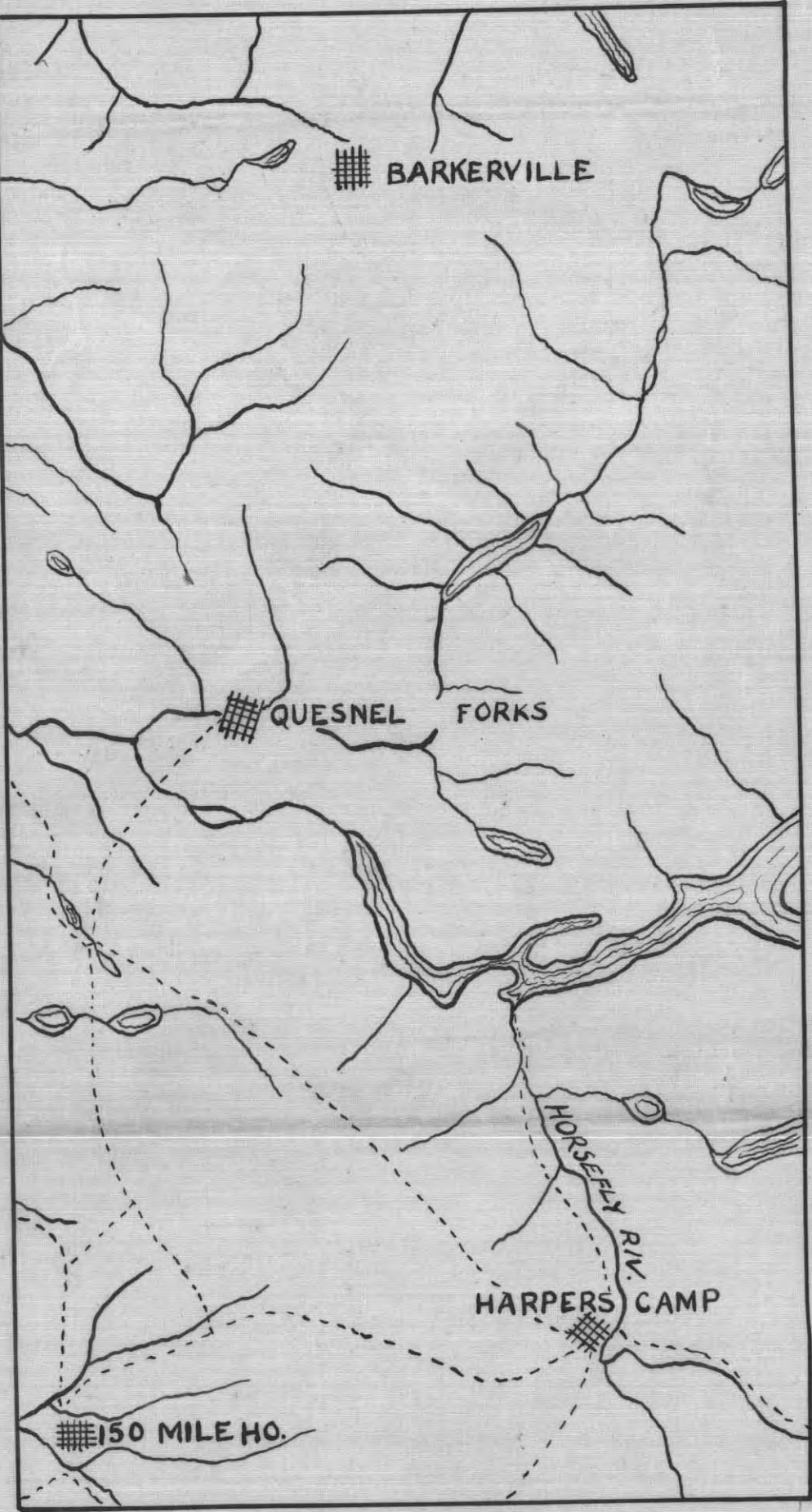

KEY MAP

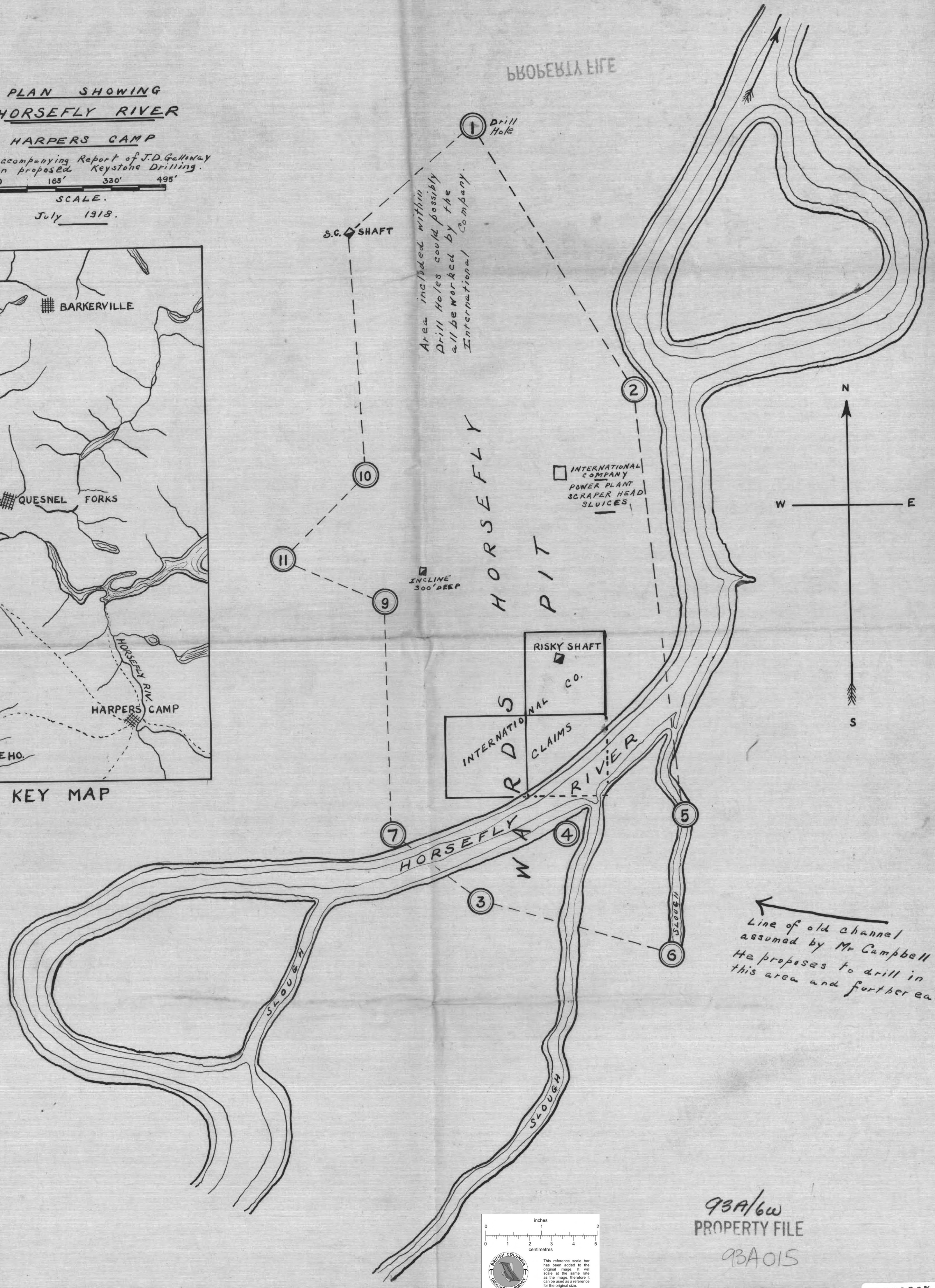

Area included within Drill Holes could possibly all be worked by the International Company.

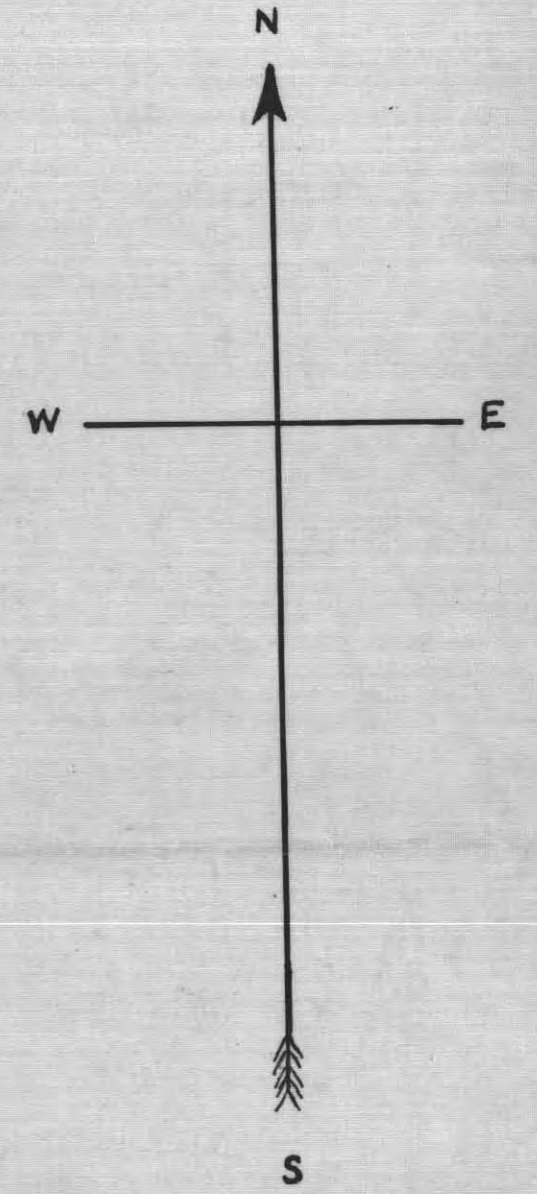

Line of old channel assumed by Mr Campbell He proposes to drill in this area and further east.

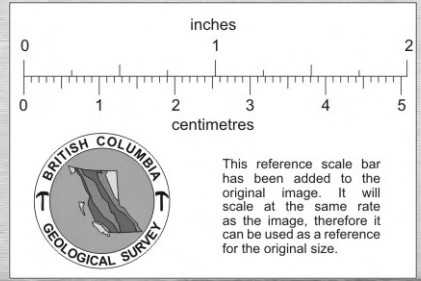

93A/6w
PROPERTY FILE
93A015