

CARIBOO BELL PROPERTY FILE 93A008

MERCURY IN SOILS ANALYSED BY LEMAITRE S-1 DETECTOR

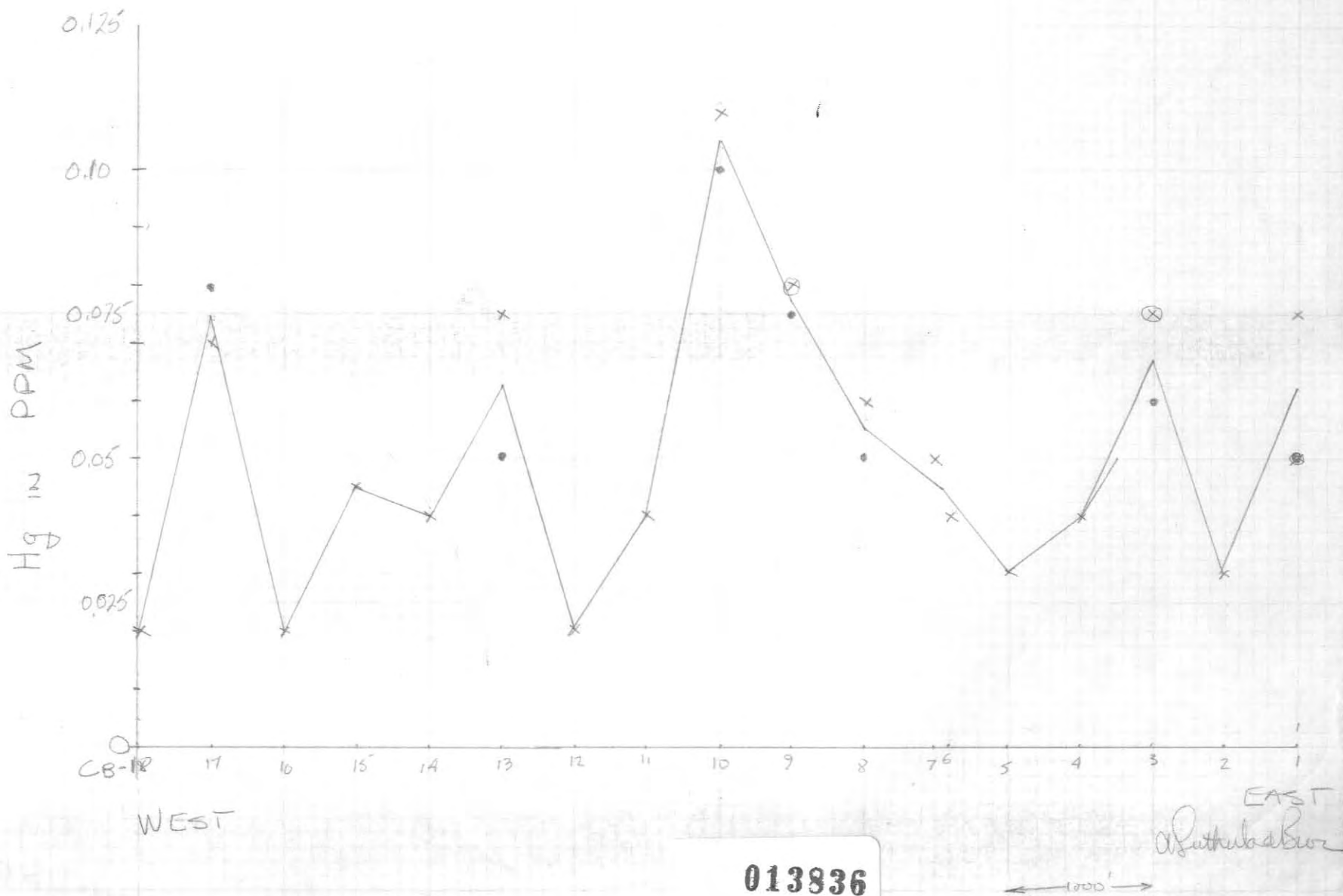

013836

EAST
a. Puthubasur

← 1000 →

- LATE P.
- LATE MONZ, SPARSE PITCHED
- SYENODIORITE
- MONZONITE POR
- BRECCIA FAULT
= MOSTLY MONZ POR
= SYENODIORITE POR
- VOLCANIC & SKARN

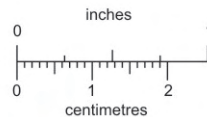

This reference scale bar has been added to the original image. It will scale at the same rate as the image, therefore it can be used as a reference for the original size.

Hy Bdr
x
AA

Monz.
x + Hy Bdr
43.

Bas

CARIBOO BELL
INTER. APRIL '67

PROPERTY FILE 93A008

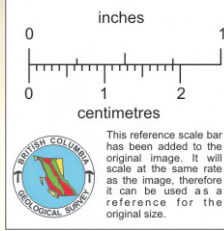

CARIBOO BELL

- FAIR. INTENSIVE
- KR ALT
- VISIBLE Cu
- PY

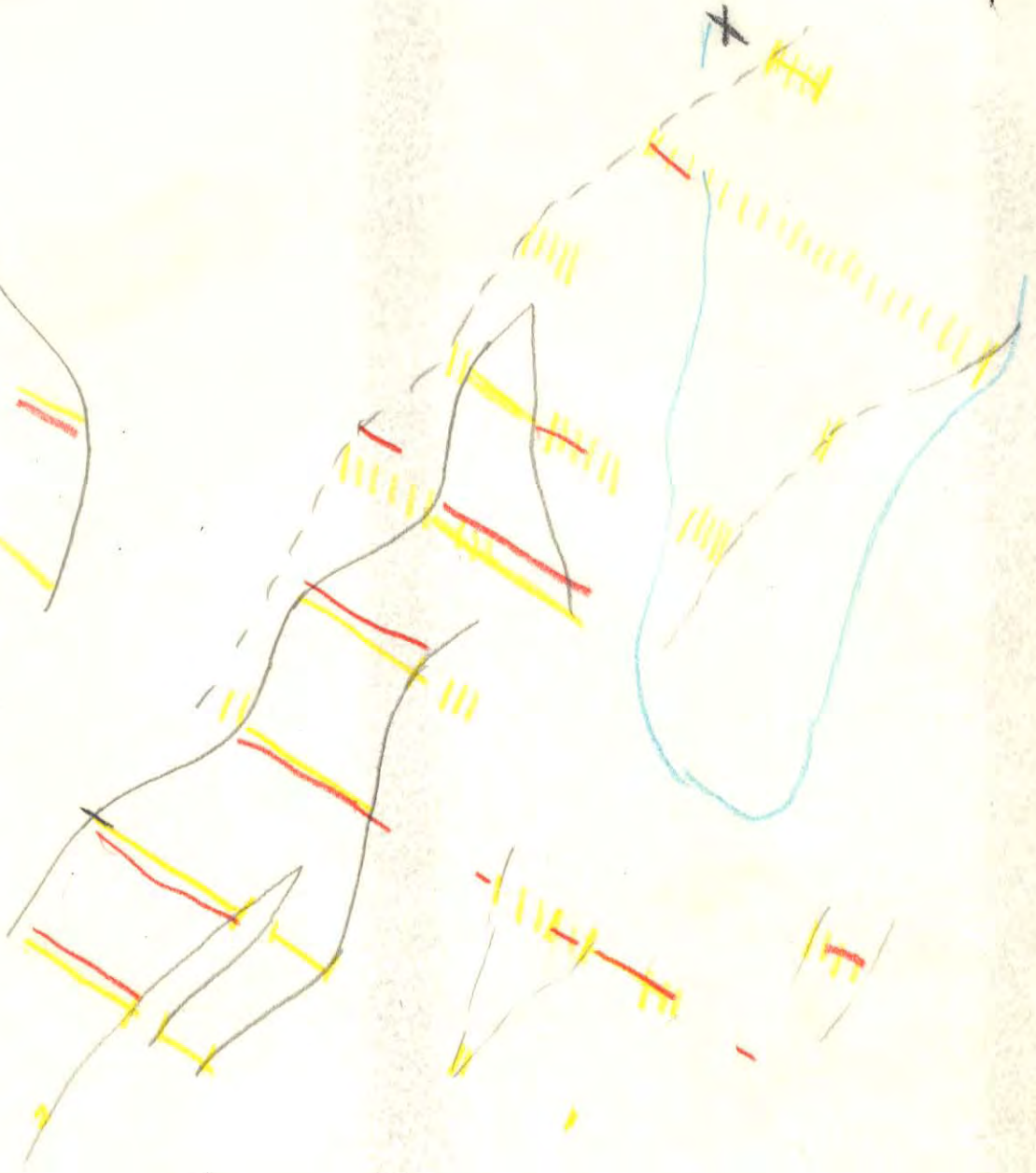

93A008
PROPERTY FILE X

БРОБЕРИЛИ

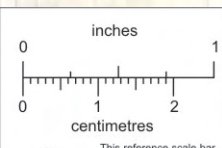
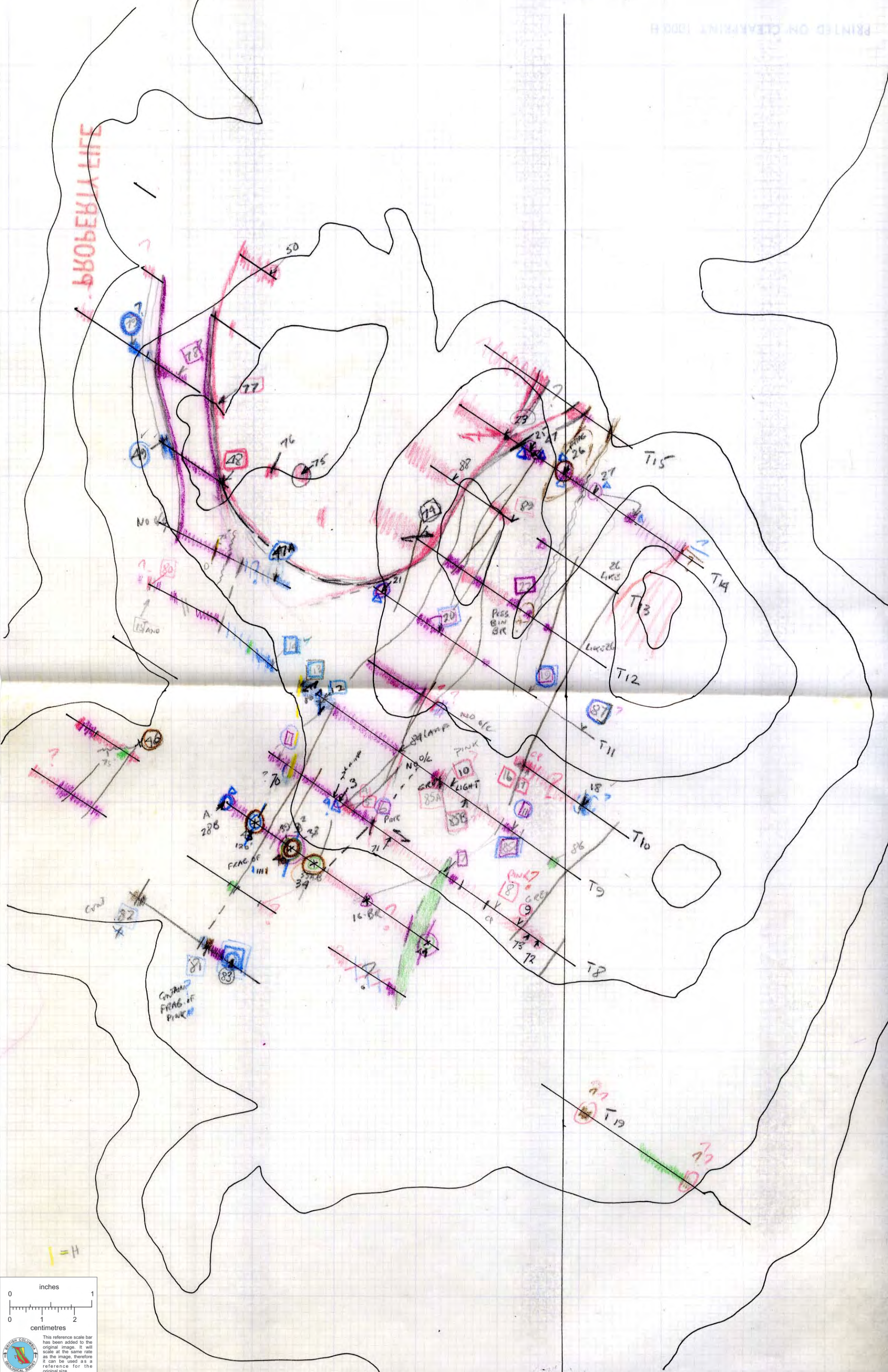







This reference scale bar has been added to the original image. It will scale at the same rate as the image, therefore it can be used as a reference for the original size.

BIOLOGICAL SERVICE



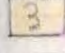
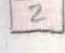

LEGEND

-  LAMPROPHYRE DYKES
-  LATE SPARSELY PHENOXYIC POR.
-  PYRITIC MOTTLED PHASCOF 3
-  BRECCIA OR S.
-  GREY TO PINK MONZ TO PSEUDO SYENITE POR.
-  GREY DIORITE POR.
-  Volc Rk

93A008
PROPERTY FILE

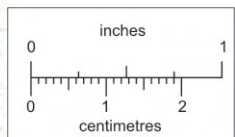
JULY '66
INTERPRETATION OF THE GEOLOGY
OR
CARIBOO BELL



 This reference scale bar has been added to the original image. It will scale at the same rate as the image, therefore it can be used as a reference for the original size.

500' = 1 IN

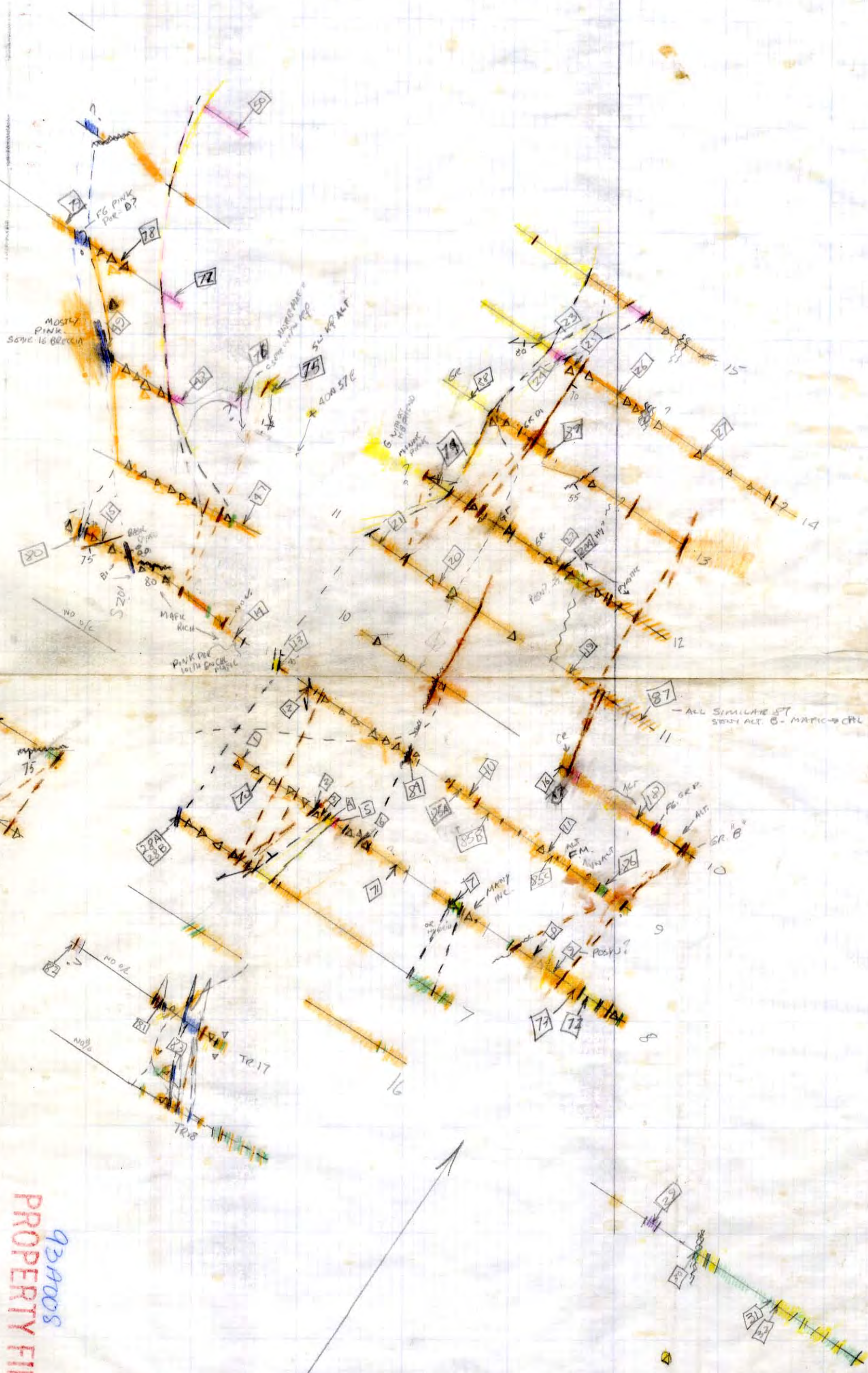

PROPERTY FILE
 93A008

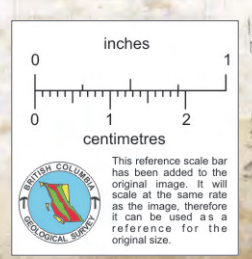

1430
 3075
 5000

200' o/c FOR.

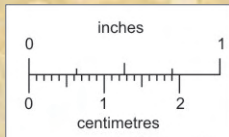

This reference scale bar has been added to the original image. It will scale at the same rate as the image, therefore it can be used as a reference for the original size.

PROPERTY FILE
93A008

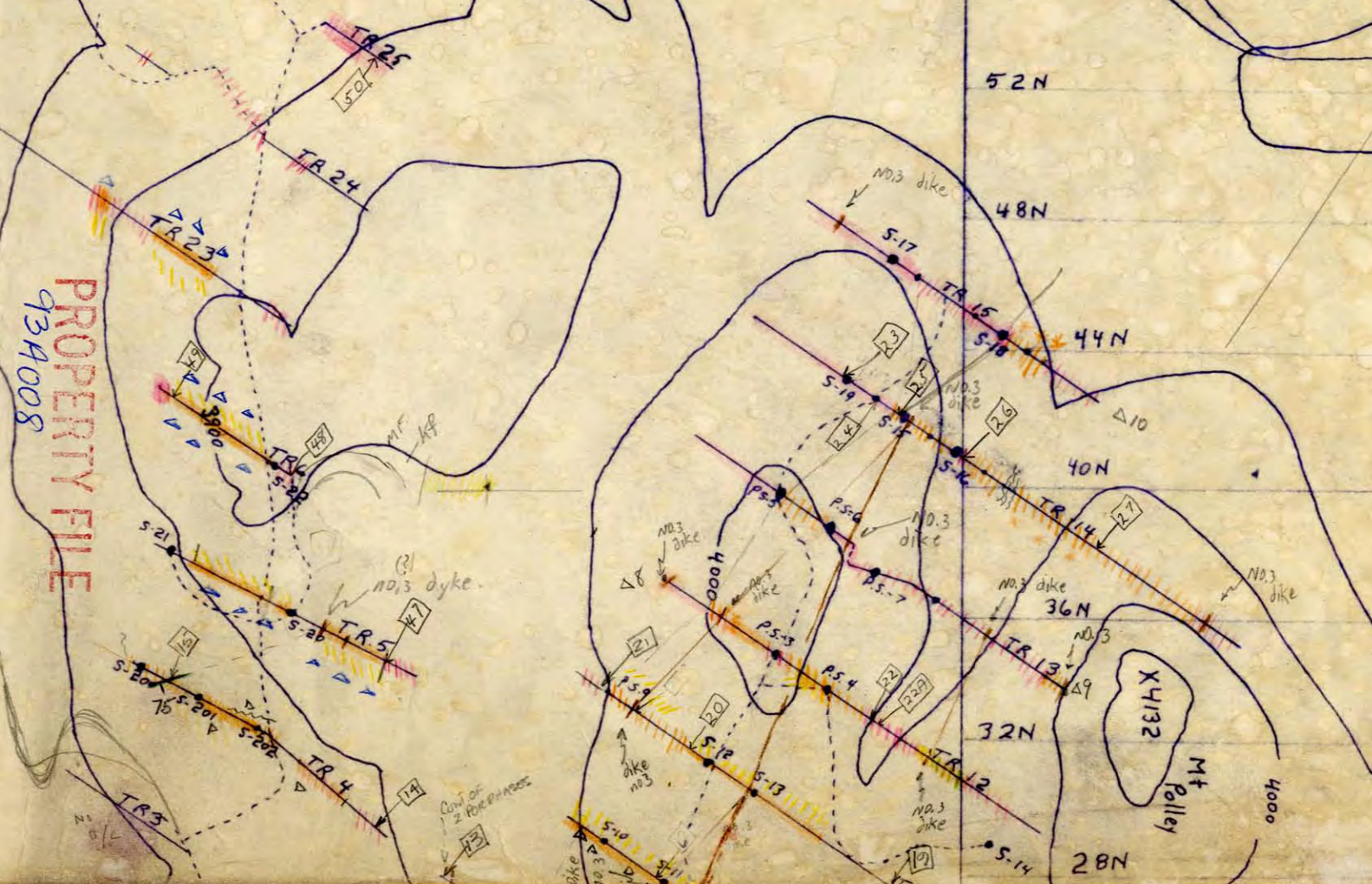



934008
PROPERTY FILE

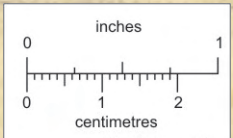

BRITISH COLUMBIA
GEOLOGICAL SURVEY

This reference scale bar has been added to the original image. It will scale at the same rate as the image, therefore it can be used as a reference for the original size.

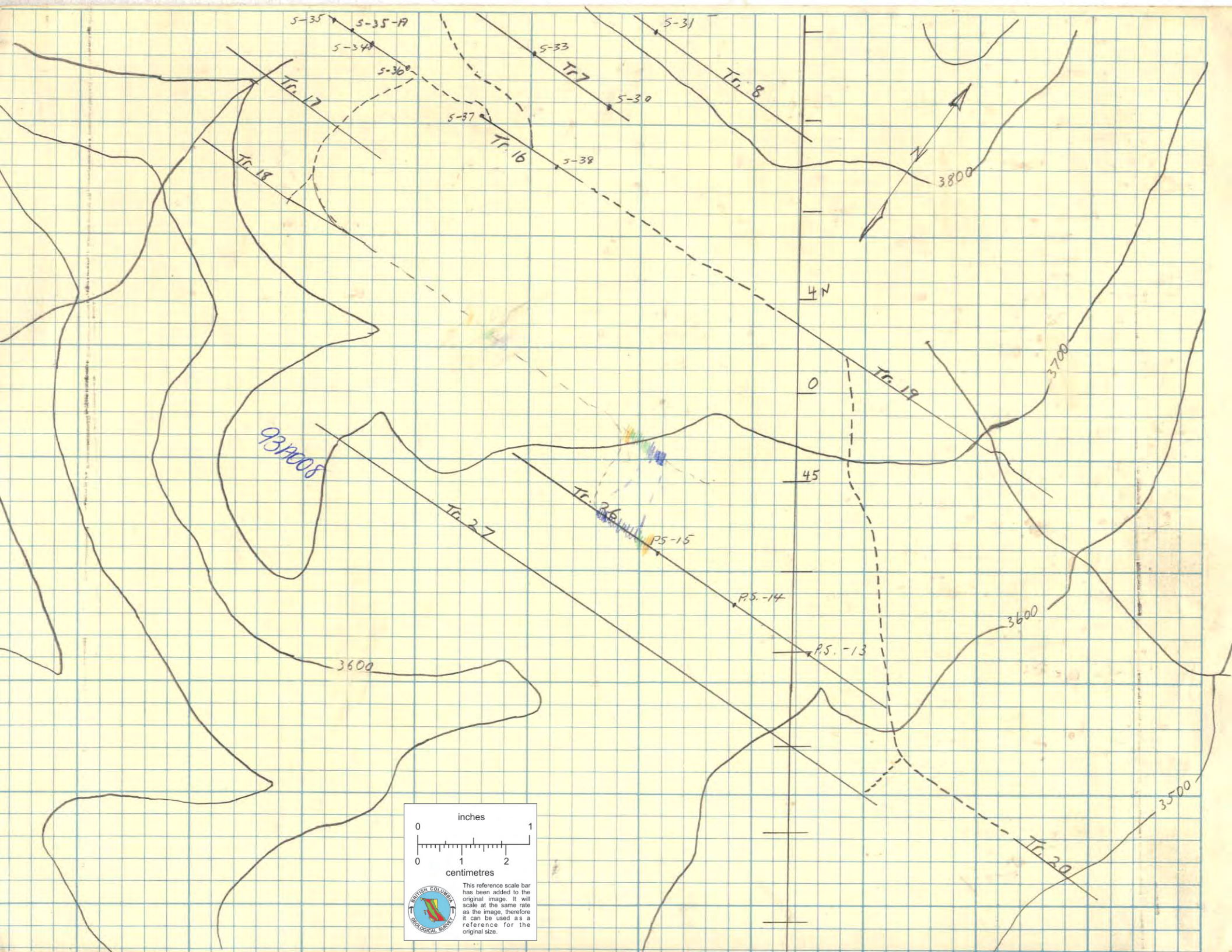

934008

