

1381
Poison Mt. 1959

Poison Mt.

POISON MOUNTAIN

Confidential to B.C. Dept. of Mines 1961.

N. JERSEY ZINC EXPLOR. Co.

MAGNETOMETER SURVEY & other data
1959

Scale 1" = 200'

Reading - spacing on N-S lines - 100 ft
on E-W " - 400 ft (possibly)
" " (100N) - 100 ft

Contour interval 500 ft plus 3,750 ft average base contour.
1000 ft

920/2E

920-46.47

PROPERTY FILE

980646-06

(J.M.C. legend & mapping, 1961 (see Ann. Rpt. 1961)
p. 23

- Horstblende - porphyry
- Breccia of biotite - porphyry
- Biotite - porphyry
- Geyserite, conglomerate, siliceous
- Flow-fraction bedding
- soil @ (soil survey covers entire map)
- Cp min (1 pt)
- py above

- Over 6,000 ft
- 5,000 - 6,000 ft
- 4,500 - 5,000 ft

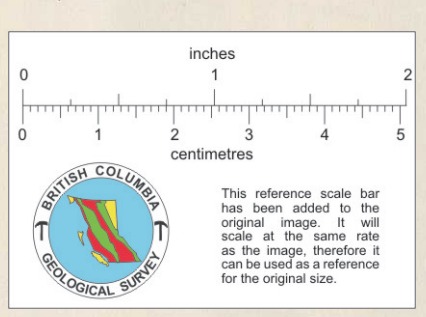
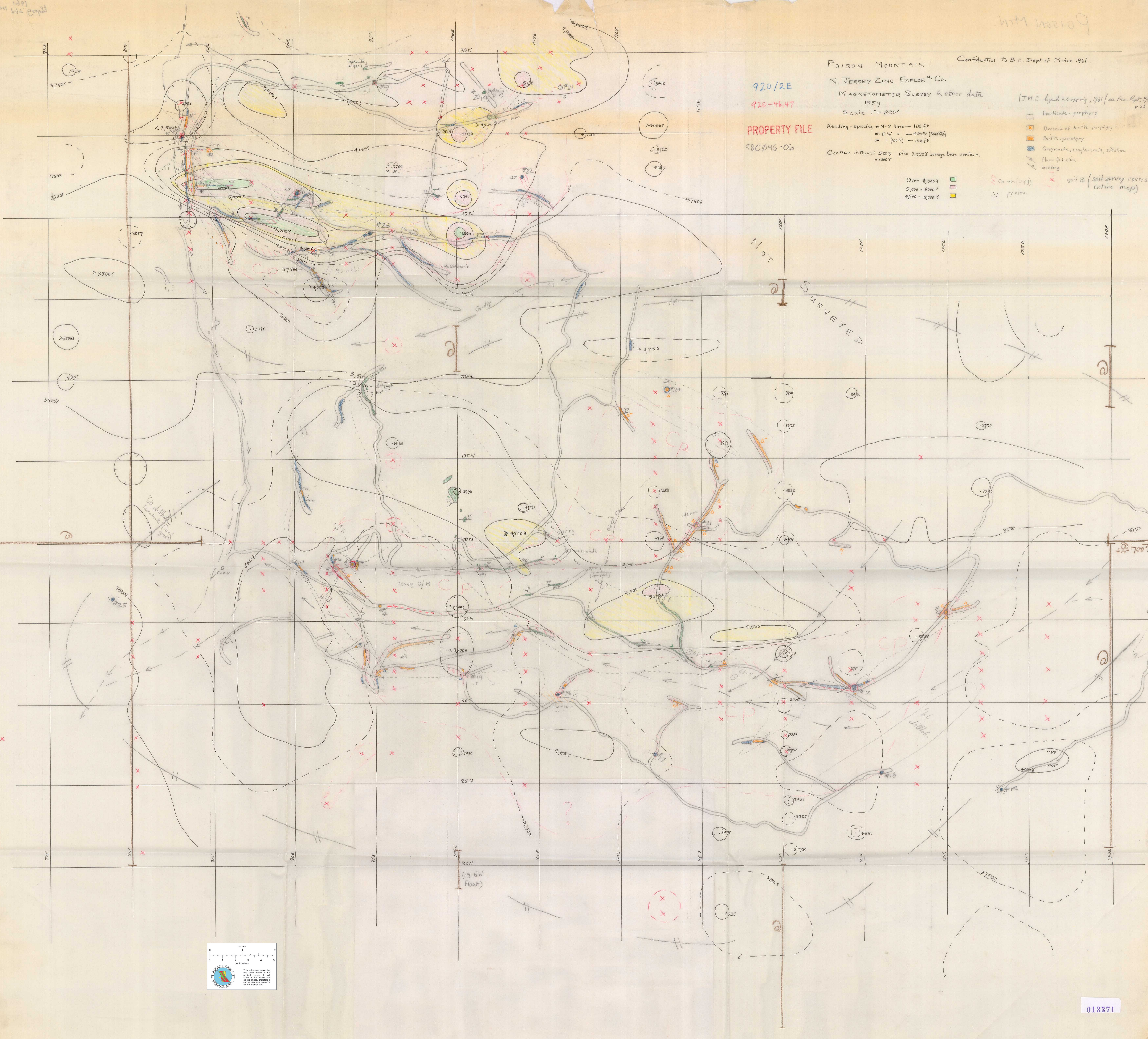

013371