

3-5' thick in face no. 4.
Round drilled in face

Back 10' high
Holes
cut for sprags

Vein shows 2 1/2' in
Vein bulges to 10" with 2"x3"
any white incl. very little
cecid faulting
Lots of white cement q.

Sp 867-9 show mill & inclusion

Spores empty, a little
broken ore heavy ring
above chutes
Dip 85° N.
Some diags ore V.

No 2 (LOWER) ADIT.
1" = 30' (3)

Wide crush zone 6"-1' white
+ 1/2" & 2" white dip
nos

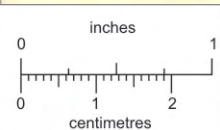

This reference scale bar has been added to the original image. It will scale at the same rate as the image, therefore it can be used as a reference for the original size.

012268

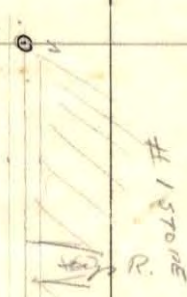

Back logged from \odot to within 10' E of \odot , or x.c.

Non. can be pulled to here - R.

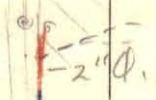

→ rock

diag of 2" with faulting at it

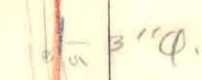

1/2 diag of calcite -
1/4 calcite 2" \phi.



Good in diag

Upper 1" = 30'



Equal down step

No 1 (UPPER) ADIT
1" = 30' ①

Over leasy, never more than 2" sometimes 1/2" or 2" \phi.

On 200-61, 2" \phi.

→ 85°
= Vert saw cut
etc. R. includes
1/2 of it ①

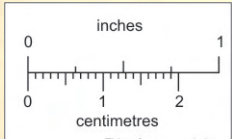

BRITISH COLUMBIA GEOLOGICAL SURVEY
This reference scale bar has been added to the original image. It will scale at the same rate as the image, therefore it can be used as a reference for the original size.

PILL

4 1/2"
1 1/4" (1 1/2")

chute
up.

2 1/4"
Non-Comm. R.

1 1/2"
3 1/4"

9" x 2 1/4"
ribbon
initially
replaced
by fine

Strong
ribbon
2 5/4"
SP367

8 1/2" white
crust
1 1/2"

No 2 (LOWER) ADIT
1 1/2 30' (2)

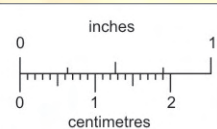

BRITISH COLUMBIA GEOLOGICAL SURVEY
This reference scale bar has been added to the original image. It will scale at the same rate as the image, therefore it can be used as a reference for the original size.

7 1/2" R.
4 1/2" R.

(2)

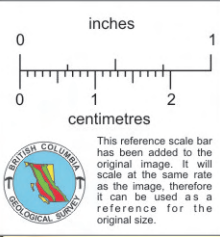

→ 56° = flat vein in SW wall no back
 can't see join w/ main vein
 From here flat vein is dkt + vein to
 face of vein 6-10" sheared like with
 d. veins 1/2 - 2" mostly comb-Q, nos, etc.



Climb up to back - vein lousy 2-3'
 (1/2 W) sheared breaks to a 2-3' break

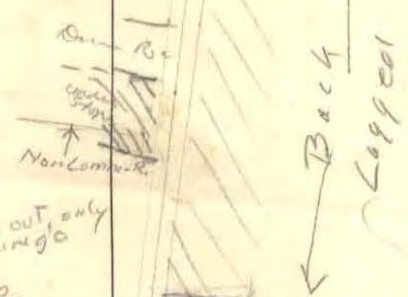

Nothing in X-C
 only Q.d.

N61 (UPPER) ADIT
 1" = 30' (2)

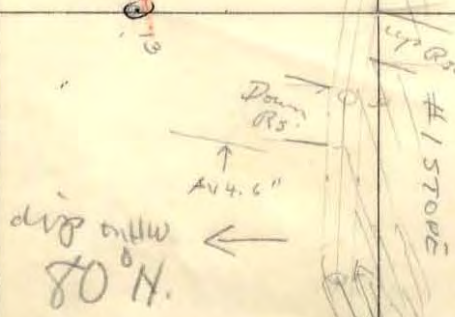

Climb up R5 @ 09 ± 20' to back & within 3 1/2
 back - steep 3' W. vein 2-3" @ 5 sp 863-4
 some sharp angled veins edging it, lying pretty well within
 5-7" vein - shear - west is at a vein in shear.
 vein shear - shear - no crushed leached white Q.d.
 coming to face FW, straight very free thw, dip
 STOPE 2 1/2 - 4' mostly 3.0 Open, stop, no ore, stulls,
 6-10" ac. Stope.

(2)

2" go, 1 1/2" Ensh, mt.

lagged
Open stipes, ore down

4-5 ditto 3-4

03-4 Fairly constant 2" Q rubbin
sum / sp 366
wt 2-6 "go

2" Q
Ore sp 366

vein
sec. r.

No 2 (LOWER) ADIT
1" = 30'
①

1/4" Q
r 1/2" go.

SPT 69 - shows alterations eg d. for a" for vein-stripe
dense black dye, spots out at 6"

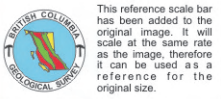
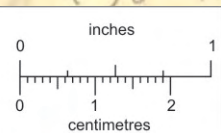

This reference scale bar has been added to the original image. It will scale at the same rate as the image, therefore it can be used as a reference for the original size.

more spindles, smooth, str 10° dV. @ port 1

