

THE C. D. MINING CO. LTD
LONG. ASSAY SECTION - NO. 4 VEIN

INCLINATION: 81° SE
Scale: 1 in = 20 ft
Avg 2/1/19 up to date
L.C.B.

92L2w
92L-15

549°W ← → N49°E

surface profile

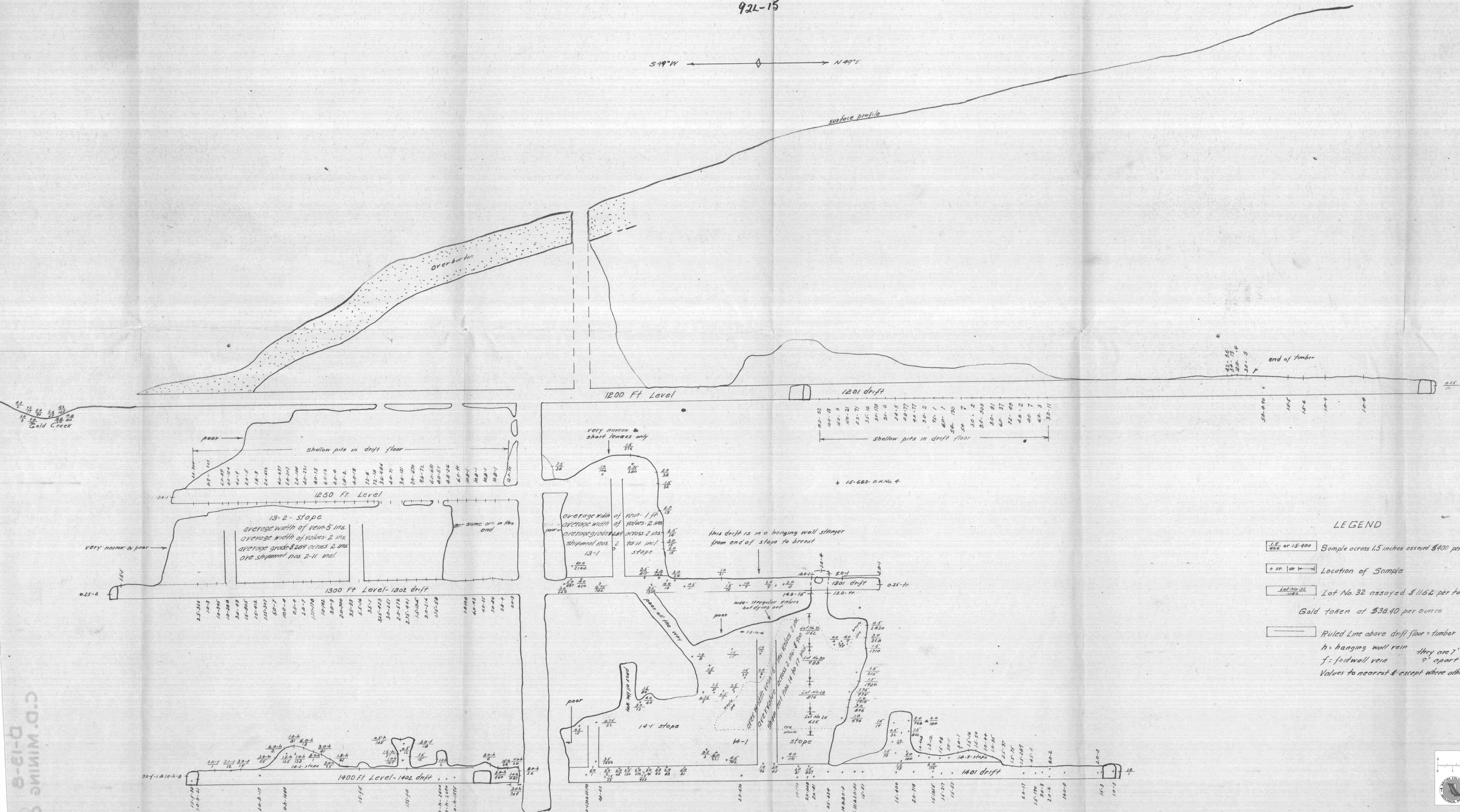

LEGEND

- 15 or 15-900 Sample across 15 inches assayed \$400 per ton
- + or | Location of Sample
- Lot No. 32 Lot No. 32 assayed \$1152 per ton
- Gold taken at \$38.40 per ounce
- Ruled Line above drift floor = timber
- h* = hanging wall rein they are 7' to 9' apart
- f* = footwall vein
- Values to nearest \$ except where otherwise shown

