

ORIGINAL 300' Geol

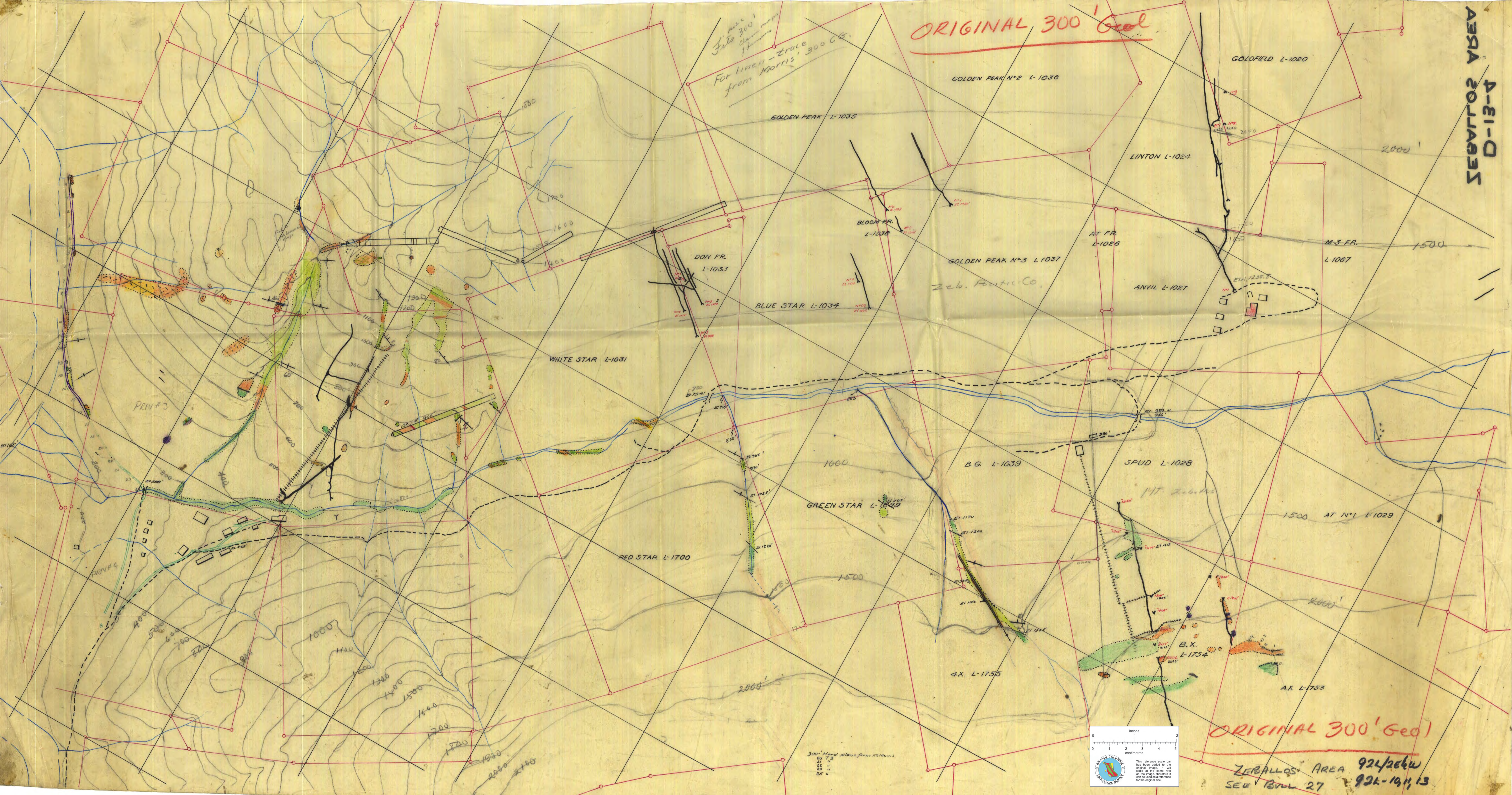

File 300
For lines - trace
from Morris' 300' G.C.

GOLDEN PEAK N°2 L-1036

GOLDFIELD L-1020

GOLDEN PEAK L-1035

LINTON L-1024

BLOOM FR.
L-1038

AT FR.
L-1026

M-3 FR.
L-1067

GOLDEN PEAK N°3 L-1037

DON FR.
L-1033

Zeb. Reel Co.

ANVIL L-1027

BLUE STAR L-1034

WHITE STAR L-1031

B.G. L-1039

SPUD L-1028

GREEN STAR L-1039

AT N°1 L-1029

RED STAR L-1700

A.X. L-1755

B.X.
L-1754

A.X. L-1753

ORIGINAL 300' Geol

ZEBALLOS AREA 924/264w
SEE BULL 27 924-1911, 13

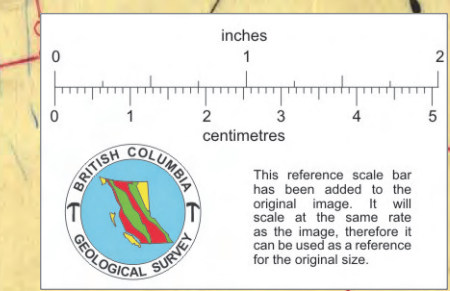

300' Hand plans from 1870s
20
21
22
23
25

Aug 17 - Rapa-Nomanae section was put in by
connecting claim points to station limits as shown on topog.
Each map section has been checked by planimetry, and
Kant's area is shown in green on corresponding points on topog map
see adjacent sheet D-13-3

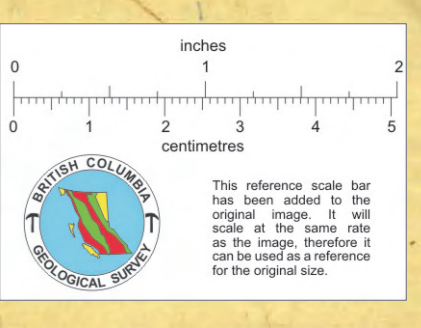

- 6220 Di. r.
- 6231 Granite intrus.
- 6214 Gne. qz. di.
- 6210 Dibb G. Di. r.
- 6217 Fine white granite Summit head P. r.
- 6219 Fine dark, mag. gne. to low P. r.
- 6202 Tuff, like blue green also packed. Waterfall.
- 6225 Chert, qz. gne. (P. r.)
- 6237 Lime sh. (P. r.)
- 6215 Lamp. gne.
- 6201 L. r.
- 6215 Gabbro di. r.

ZEBALLOS AREA
SEE BELL 27