

1st copy  
of 2

011771

AL, RC

92J/3

(No M.I. - minor  
pyrite only mineral Zn)

REPORT ON THE  
BRANDYWINE PROPERTY  
VANCOUVER MINING DIVISION  
BRITISH COLUMBIA

92JW001, 021, 022

Latitude: 50°01'N  
Longitude: 123°09'W  
NTS 92J - 3

for

FOCUS RESOURCES LTD.

|     | <u>Claims</u> | <u>Record Number</u> | <u>Expiry Date</u> |
|-----|---------------|----------------------|--------------------|
| AL  | 1 to 3        | 25386 to 25388       | February 8, 1975   |
| AL  | 5             | 25389                | February 8, 1975   |
| AL  | 7 to 10       | 25390 to 25393       | February 8, 1975   |
| DON | 1 to 2        | 25320 to 25321       | February 8, 1975   |
| RC  | 3 to 10       | 25396 to 25403       | February 8, 1975   |
| RA  | 3 to 8        | 25290 to 25295       | February 8, 1975   |
| TAN | 9 to 14       | 25356 to 25361       | February 8, 1975   |

by:

GEORGE B. PHELPS, P.Eng.

March, 1974

92J/3 General  
PROPERTY FILE

92JWGEN.

TABLE OF CONTENTS

|                      | <u>Page</u> |
|----------------------|-------------|
| INTRODUCTION.....    | 1           |
| CONCLUSION.....      | 1           |
| RECOMMENDATIONS..... | 2           |
| ESTIMATED COSTS..... | 4           |
| GEOGRAPHY.....       | 7           |
| Location.....        | 7           |
| Access.....          | 7           |
| Topography.....      | 7           |
| Climate.....         | 7           |
| Vegetation.....      | 8           |
| Water.....           | 8           |
| CLAIMS.....          | 8           |
| HISTORY.....         | 9           |
| GEOLOGY.....         | 9           |

INTRODUCTION

This report is written at the request of Mr. Hans Dietmann, President of Focus Resources Ltd.

The writer examined the property on February 20, 1974. There was two to three feet of snow cover; however, numerous outcrops were exposed and the rock faces on the railway were free of snow.

CONCLUSION

The claim area lies in an area known to be favourable for mineralization. The adjacent Van Silver property has several zones of potentially economic mineralization, containing values in gold, silver, copper, lead, and zinc.

The structural trends reported and observed on the Van Silver property continue to the Focus claim area. These strong lineaments are probably structurally related and are possible fault zones. The sericitic and epidotized greenstones indicate alteration of the country rock.

The Focus Resources Ltd. claim group merits an exploration program to determine if economic mineralization is present.

RECOMMENDATIONS

PHASE I

1. Make a geological map of the claim area at 1 inch = 400 feet scale, using an enlargement of the existing topographic map for control. Air photographs should be used to help define the structure in the area. Photo coverage will be necessary beyond the claim group. A line control grid may be necessary.
2. Conduct a reconnaissance soil and silt sampling program with the mapping. Areas of known mineralization or suspected fault zones should be sampled in greater detail, on an established grid if necessary.

PHASE II

Phase II is contingent upon favourable results from Phase I.

1. Map any mineralized zones in detail at a scale of 1 inch to 100 or 200 feet.
2. Make a detailed geochemical survey to delineate mineralized zones and test for extensions.
3. Trench and sample the mineralized zones using a Cobra type drill and dynamite. The terrain is in general too steep for bulldozer trenching during preliminary exploration.

PHASE III

Phase III is contingent upon favourable results from Phase II.

Diamond drill those mineralized zones which trenching indicates may have economic potential.

No more than five hundred feet of BQ wire line drill should be required for an initial drill program.

ESTIMATED COSTS

|   |                        |
|---|------------------------|
| <u>Personnel</u>  |                        |
| Geologist - Supervisor<br>10 days @ \$175.00/day.....                                       | \$ 1,750.00            |
| Senior Technician<br>10 days @ \$125.00/day.....  | 1,250.00               |
| Technician<br>10 days @ \$ 80.00/day.....   | 800.00.....\$ 3,800.00 |
| <u>Transportation</u>   |                        |
| Wheel drive truck<br>10 days @ \$20.00/day & 15¢/mile plus gas.....                         | 325.00                 |
| <u>Food Accommodation</u>   |                        |
| 1 man/days @ \$15.00/day.....   | 450.00                 |
| <u>Equipment</u>  |                        |
| Surveying equipment, sampling equipment<br>(topographic blowup and aerial photographs)..... | 160.00                 |
| <u>Sampling</u>   |                        |
| Estimated 150 geochemical samples for copper,<br>lead, zinc @ \$1.90/sample.....            | 285.00                 |
| <u>Compilation, Maps and Report</u> .....   | 1,000.00               |
| <u>Contingencies @ 20%</u> .....  | 1,204.00               |
| TOTAL ESTIMATED COST PHASE 1  | <u>\$ 7,224.00</u>     |

PHASE 11

A. Personnel

Geologist - Supervisor  
4 days @ \$175.00/day.....\$ 700.00

Senior Technician  
4 days @ \$125.00/day..... 500.00

Technician  
4 days @ \$ 80.00/day..... 320.00

Cobra drill operator  
4 days @ \$ 80.00/day..... 320.00.....\$ 1,840.00

B. Transportation

4 Wheel drive truck @ \$20.00/day  
& 15¢/mile plus gas..... 115.00

C. Food and Accommodation

16 man/days @ \$15.00/day..... 240.00

D. Equipment

Cobra drill and steel rental, powder, surveying  
equipment..... 350.00

E. Assaying

150 Geochemical samples @ \$1.90/sample.....285.00

50 Rock samples @ \$12.00/sample.....600.00..... 885.00

F. Data Compilation, Maps and Report Phase I & Phase II..... 1,000.00

G. Contingencies @ 20%..... 886.00

TOTAL ESTIMATED COST PHASE 11.....\$ 5,316.00

PHASE 111

A. Personnel

Geologist - Supervisor  
12 days @ \$175.00/day.....\$ 2,100.00

B. Transportation

4 Wheel Drive @ \$20.00/day  
& 15¢/mile plus gas..... 355.00

C. Food and Accommodation

12 man/days @ \$15.00/day..... 180.00

D. Diamond Drilling

500 feet BQ - All inclusive costs  
Mobilization, demobilization @ \$17.00/foot..... 8,500.00

E. Contingencies @ 20%..... 2,227.00

TOTAL ESTIMATED COST PHASE 111      \$ 13,362.00

TOTAL ESTIMATED COST PHASE I.....\$ 7,224.00

TOTAL ESTIMATED COST PHASE 11..... 5,316.00

TOTAL ESTIMATED COST PHASE 111..... 13,362.00

\$ 25,922.00



## GEOGRAPHY

### Location

The property is located about 50 miles north of Vancouver, B. C., in the Vancouver Mining Division. The property lies one mile west of Daisy Lake. The claim block lies just west of highway 99. Co-ordinates are 50°01' North Latitude and 123°09' West Longitude.

### Access

Highway 99 provides good access from Vancouver or Squamish to the property area. The claim area can be reached by an old logging road or by following the B. C. Railway which passes through the property. The western claim area is steep and rocky and there are no roads to this part of the area.

### Topography

The area is steep and rugged with numerous rock exposures. The elevation varies from 1,300 feet to over 3,600 feet. There are numerous steep ravines which strike between N10°E and N10°W. It is likely that these ravines are related to structural lineaments.

### Climate

The climate is relatively mild and similar to Vancouver; however, the winter precipitation is snow rather than rain. Two to

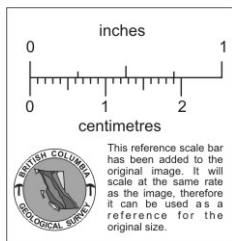

**FOCUS RESOURCES Ltd.**  
**BRANDYWINE CREEK AREA**  
Vancouver, M. D.

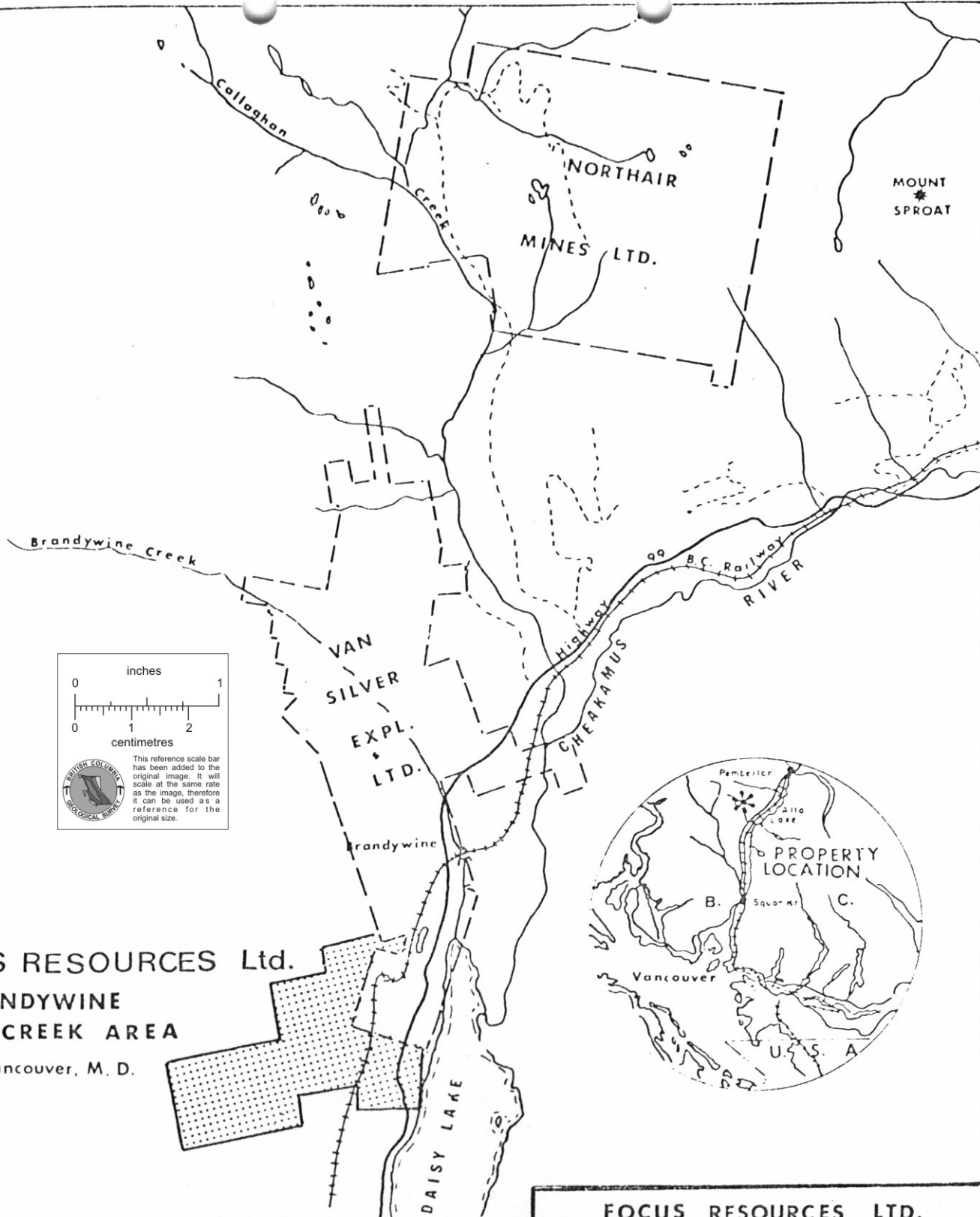

|                             |              |            |
|-----------------------------|--------------|------------|
| <b>FOCUS RESOURCES LTD.</b> |              |            |
| BRANDYWINE CREEK AREA       |              |            |
| Claim<br>Location Map       |              |            |
| SCALE 1 in. = 7500 ft.      | Date Mar. 74 | Drawn p.h. |

four feet of compacted snow can be expected to accrue in the claim area.

Vegetation

The claim area is forested with spruce and fir. There is little underbrush and the trees are not particularly thick due to the many rock outcrops and steep slopes.

Water

Several streams drain the claim area and there is ample water for any drilling requirements. The drainage is to the east into Daisy Lake.

CLAIMS

Focus Resources Ltd. has acquired the following mineral claims in the Vancouver Mining Division. The claims include:

| <u>Claim Names</u> | <u>Record Numbers</u> | <u>Expiry Dates</u> |
|--------------------|-----------------------|---------------------|
| AL 1 to 3          | 25386 to 25388        | February 8, 1975    |
| AL 5               | 25389                 | February 8, 1975    |
| AL 7 to 10         | 25390 to 25393        | February 8, 1975    |
| DON 1 to 2         | 25320 to 25321        | February 8, 1975    |
| RC 3 to 10         | 25396 to 25403        | February 8, 1975    |
| RA 3 to 8          | 25290 to 25295        | February 8, 1975    |
| TAN 9 to 14        | 25356 to 25361        | February 8, 1975    |

The location and individual claims are shown on the accompanying map.

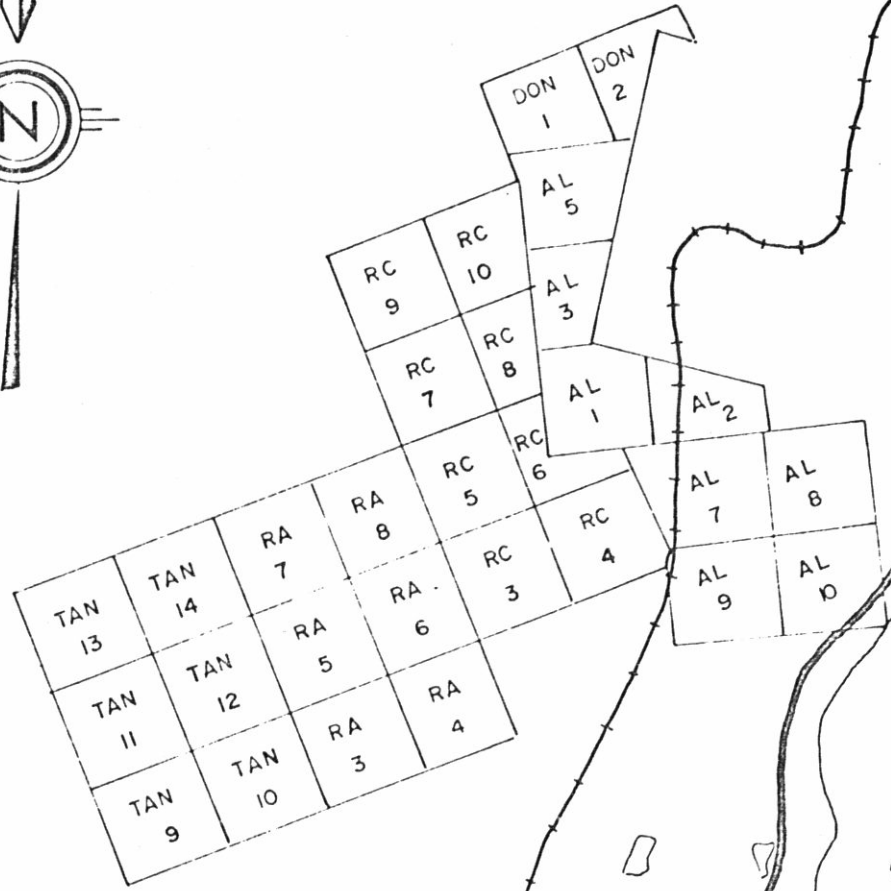
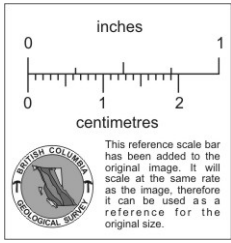
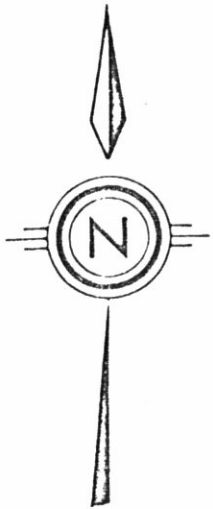

to Vancouver  
B.C. Railway

Vancouver

Brandywine

DAISY LAKE

Cheakamus Riv

Highway 99

to Pemberton

|                       |              |            |
|-----------------------|--------------|------------|
| FOCUS RESOURCES LTD.  |              |            |
| BRANDYWINE CREEK AREA |              |            |
| CLAIM<br>MAP          |              |            |
| SCALE 1" = 3000'      | Date Mar. 74 | Drawn p.n. |

### HISTORY

This area has been known as a mineralized area for many years. The first mining activity was exploration for placer gold in the streams.

Mineral claims were staked in the area in the early 1920's and the adjacent Van Silver property has been known for many years. Exploration is in progress on the Van Silver property, and Northair Mines, five miles to the north, is developing promising gold mineralization.

The area has not yet been mapped by the G.S.C. or B. C. Department of Mines.

### GEOLOGY

Basalt and greenstone were the only rock types observed in the claim area during the preliminary examination, but the two to four feet of snow cover prevented even reconnaissance mapping.

The greenstones contain less than one to two per cent pyrite and on the A1 8 claim are strongly epidotized. The pyrite is contained both as disseminations and fracture fillings. Most of the other outcrops examined were very sericitic.

Several very strong lineaments indicate possible fault zones. These strike N 10° E and occasionally N 10°W. Snow cover prevented an examination of these features. These structures are on the same trend as the mineralized zones on nearby and adjacent properties.

These zones should be examined when snow conditions permit. Aerial photographs will be particularly useful in mapping the structures on the Focus claims, and locating primary areas of interest for immediate field examination.

Respectfully submitted,

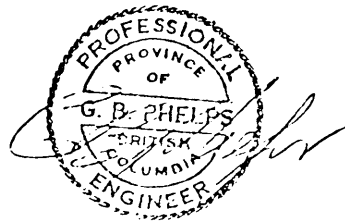

G. B. Phelps, P.Eng.

ENGINEER'S CERTIFICATE

I, GEORGE B. PHELPS, of #501-2061 Beach Avenue, in the City of Vancouver, in the Province of British Columbia, DO HEREBY CERTIFY:-

1. That I am a consulting geological engineer with a business address of 420-475 Howe Street, Vancouver, British Columbia.
2. That I am a graduate of the Montana College of Mineral Science and Technology where I obtained my B.Sc. in geological engineering in 1966 and my M.Sc. in geological engineering in 1969.
3. That I am a Registered Professional Engineer in the Geological Section of the Association of Professional Engineers in the Province of British Columbia.
4. That I have practiced my profession as a geological engineer for the past eight years, and
5. That I have no interest, direct or indirect, in the property with which this report is concerned, nor do I expect to receive any such interest. I have no interest in the securities of Focus Resources Ltd.



George B. Phelps M.Sc., P. Eng.

DATED at the City of Vancouver, Province of British Columbia, this 30 day of April 1974.