

PROPERTY FILE

BRANDYWINE DP ZONE
PLAN
1995 VERTICAL HOLES

SURVEYED BY McELHANNBY CONSULTING SERVICES LTD.
AUGUST 17, 1995

011706

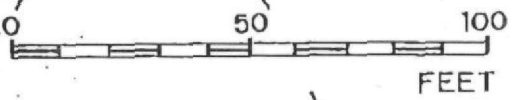

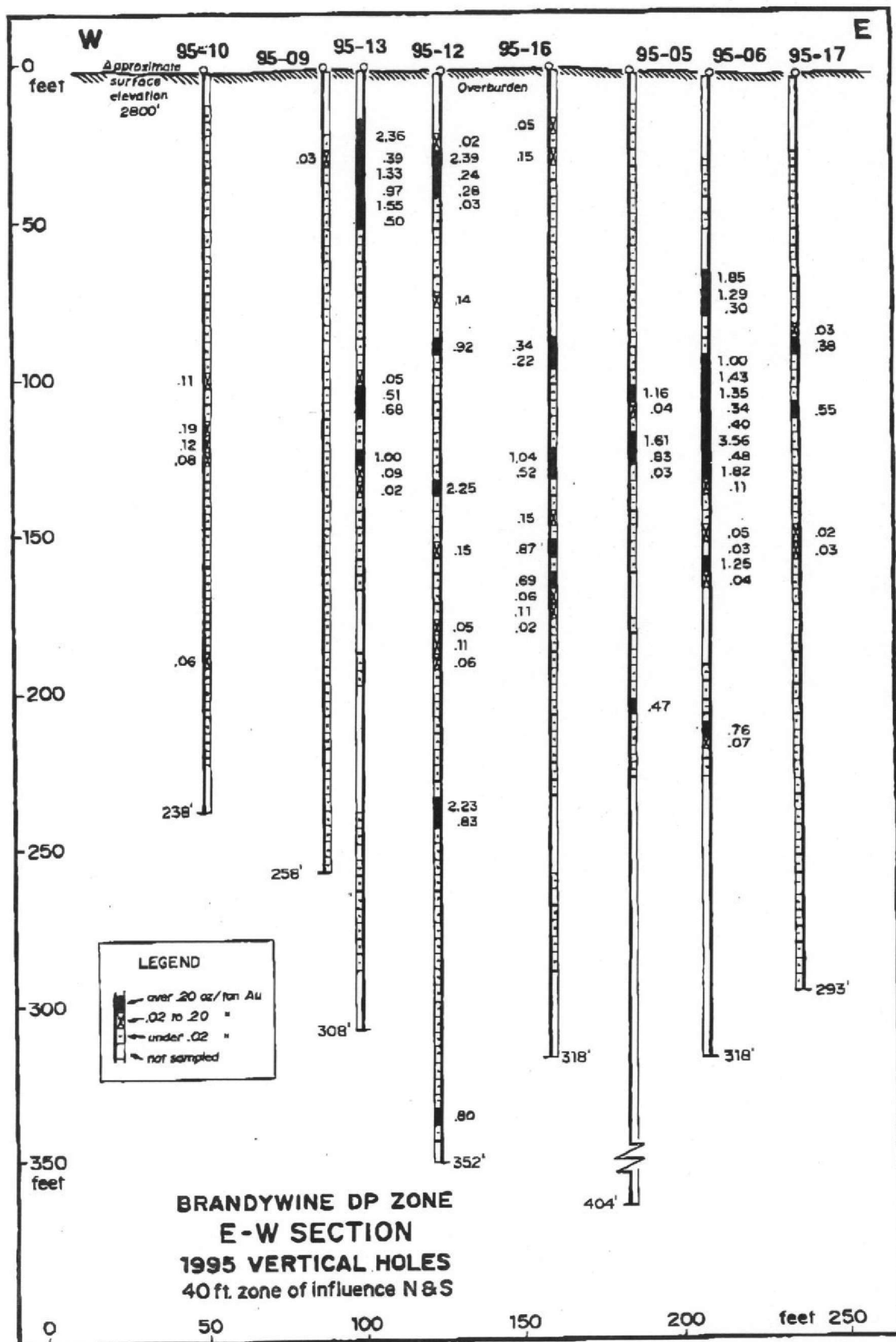

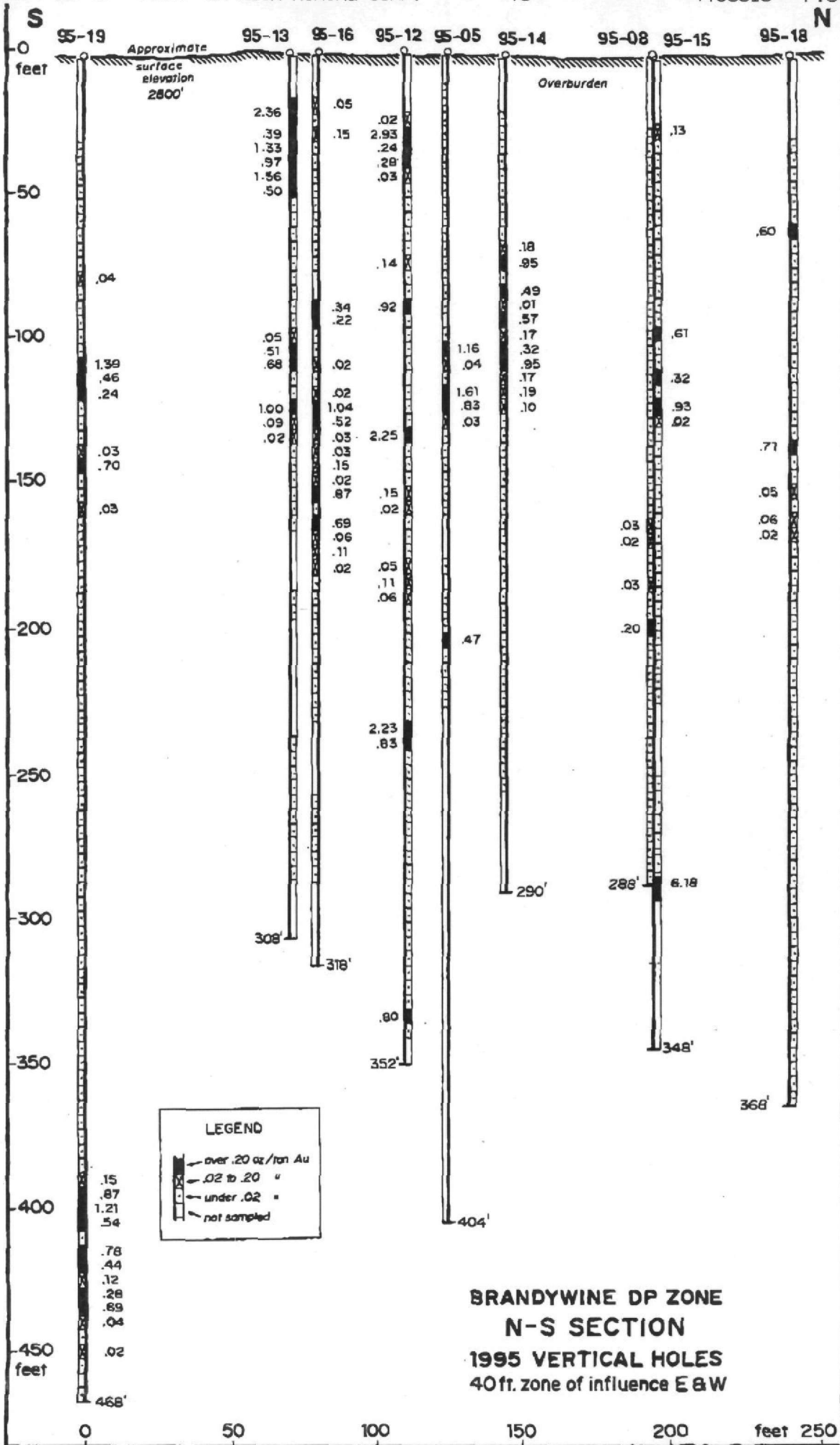

BRANDYWINE DP ZONE
N-S SECTION
1995 VERTICAL HOLES
40 ft. zone of influence E & W

PROPERTY FILE

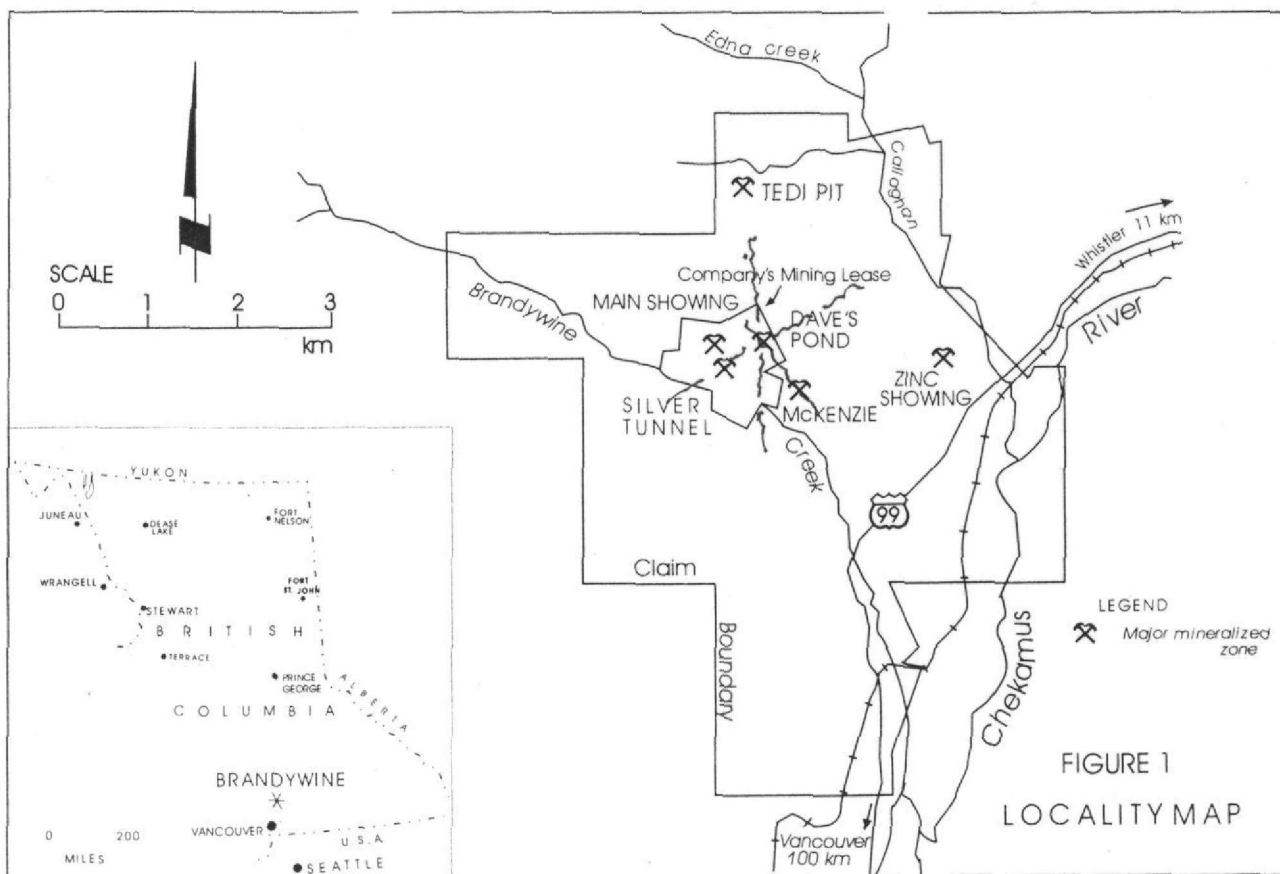

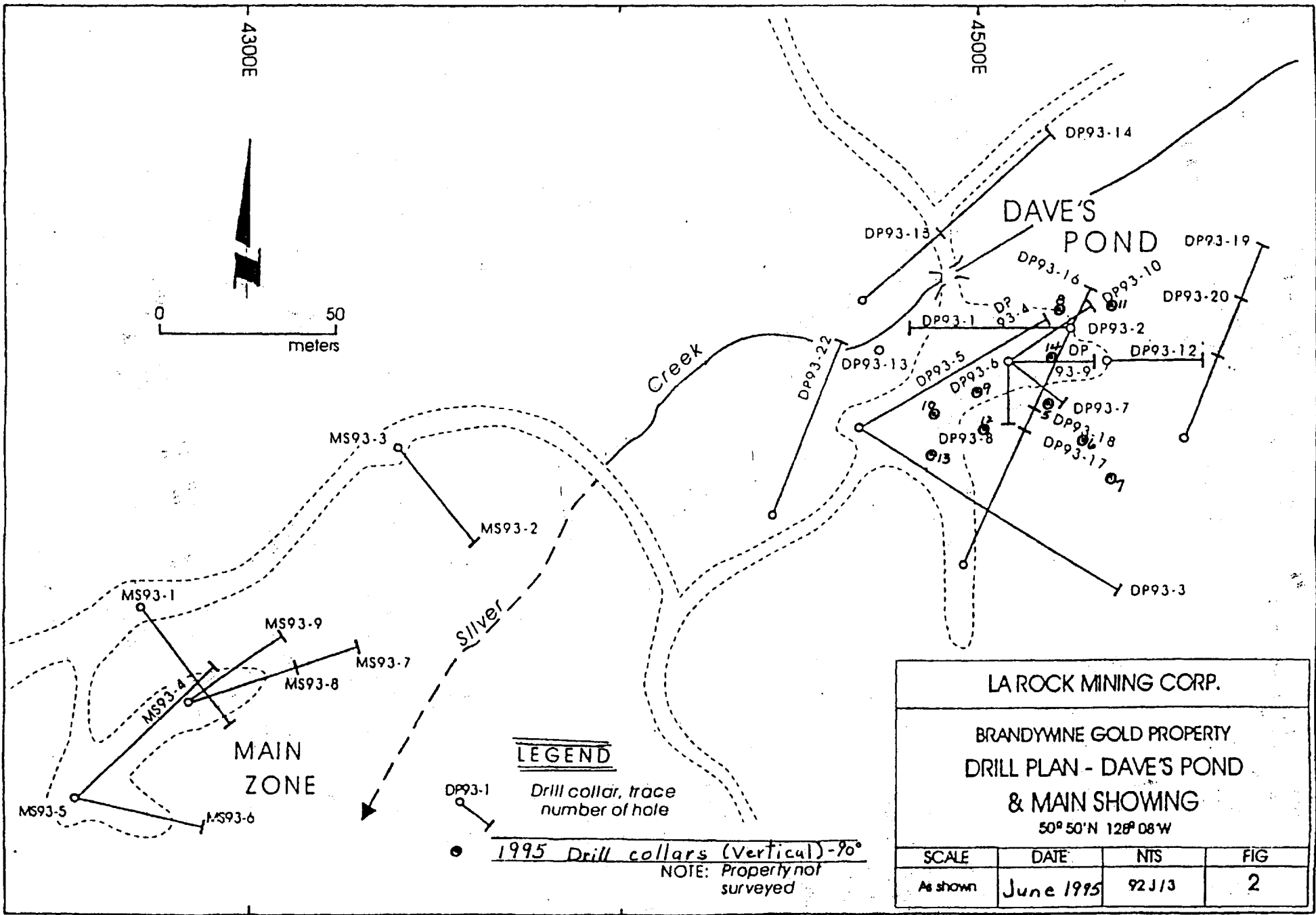

LA ROCK MINING CORP.

BRANDYWINE GOLD PROPERTY
 DRILL PLAN - DAVE'S POND
 & MAIN SHOWING

50° 50' N 128° 08' W

SCALE	DATE	NTS	FIG
As shown	June 1995	92 J 13	2

LEGEND

○ DP93-1 Drill collar, trace number of hole

● 1995 Drill collars (Vertical) - 90°

NOTE: Property not surveyed

ORGE CRO

CHI

GEORGE
A11

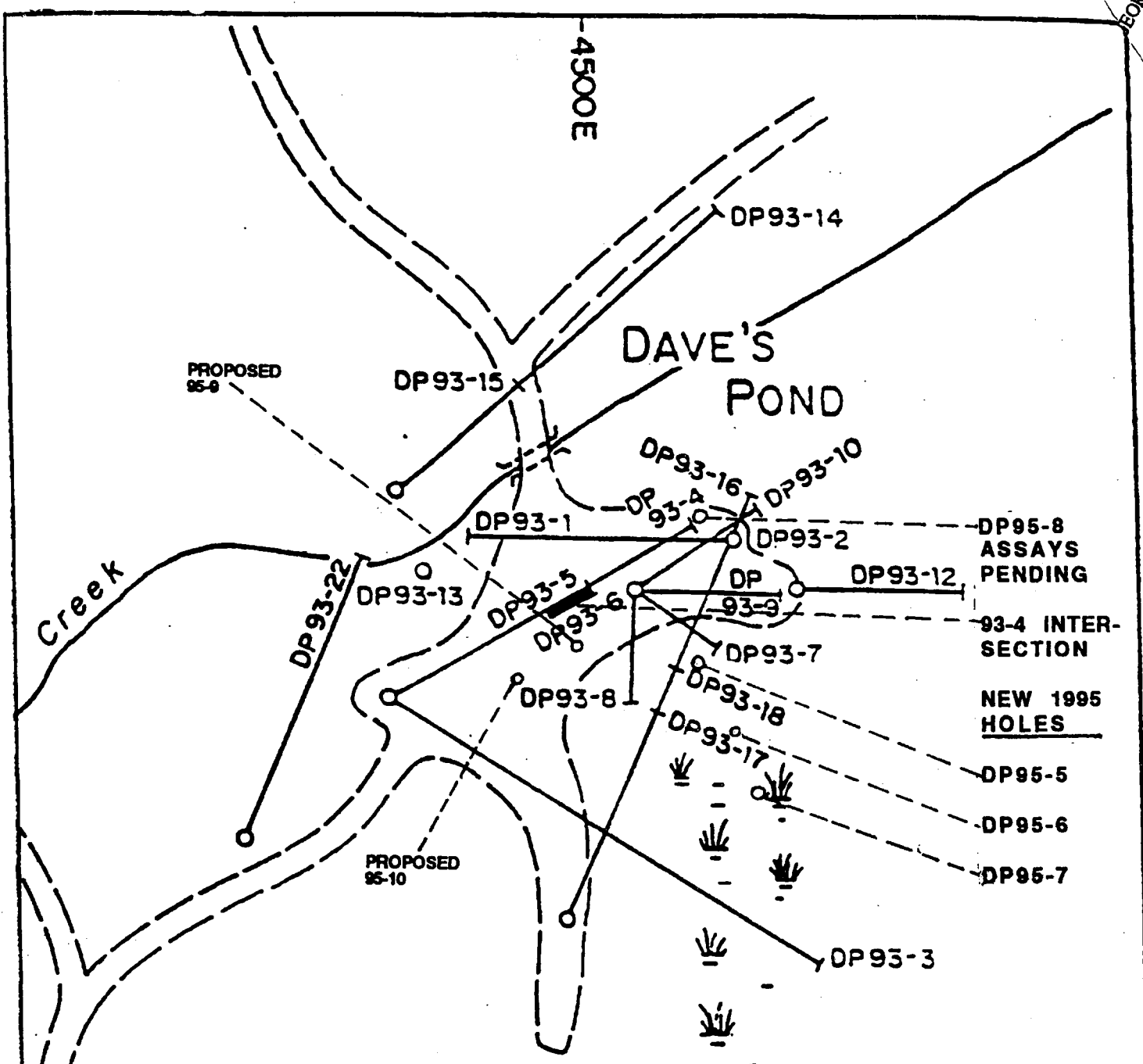

DP95-8
ASSAYS
PENDING

93-4 INTER-
SECTION

NEW 1995
HOLES

DP95-5

DP95-6

DP95-7

LA ROCK MINING CORP.

BRANDYWINE GOLD PROPERTY
DRILL PLAN - DAVE'S POND
& MAIN SHOWING

50°50'N, 128°08'W

NOTE: Property not surveyed

SCALE	DATE	NTS	FIG
As shown	Nov. 28, 1993	92 J / 3	2

BRANDYWINE PROJECT DRILL RESULTS

HOLE	FOOTAGE	WIDTH	AVERAGE OZ. GOLD/TON
DP93-4	182-256	74 ft.	0.222 oz gold/Ton
	(including 10 ft. of and 74 ft. av.)		0.60 oz gold/Ton 0.35 oz silver/Ton
DP93-5	128-153	25 ft.	3.046 oz gold/Ton
	(including 5 ft. of 128-153 25 ft. av.)		0.125 oz gold/Ton 4.31 oz silver/Ton
DP93-6	188-233	45 ft.	0.143 oz gold/Ton
	(including 10 ft. of and 10 ft. av.)		0.220 oz gold/Ton 0.380 oz gold/Ton 4.19 oz silver/Ton
DP93-7	78-143	65 ft.	0.093 oz gold/Ton
	(including 5 ft. of 123-135 12 ft. av.)		0.186 oz gold/Ton 1.78 oz silver/Ton
DP93-8	258-283	25 ft.	0.08 oz gold/Ton
	(including 5 ft. of 118-123 5 ft. av.)		0.180 oz gold/Ton 0.167 oz gold/Ton
	308-313	5 ft.	0.100 oz gold/Ton
	341-346	5 ft.	0.282 oz gold/Ton
	308-313	5 ft.	2.14 oz silver/Ton
	DP93-9	103-143	40 ft.
(including 5 ft. of 103-113 10 ft. av.)		2.469 oz gold/Ton 3.02 oz silver/Ton	
(including 5 ft. of 143-148 5 ft. av.)		4.84 oz silver/Ton	
DP93-16	143-189	46 ft.	0.110 oz gold/Ton
(including 8 ft. of 143-148 8 ft. av.)		0.451 oz gold/Ton	
NS93-1	155-175	20 ft.	22 oz silver/Ton
NS93-9	118-128	10 ft.	12 oz silver/Ton
NS93-6	56-61	5 ft.	0.167 oz gold/Ton

All these NS Holes have significant base metal values.

DDH #	Az	Dip	Length	Interval	Width	Gold(oz/t)
DP-94-1	025	-45	298 ft	94.5-104.0	9.5 ft	0.033
				133.0-138.0	5.0 ft	0.087
				148.0-158.0	10.0 ft	0.032
DP-94-2	025	-65	298 ft	115.0-118.0	3.0 ft	0.109
				148.0-153.0	5.0 ft	0.023
				243.5-247.0	3.5 ft	0.261
DP-94-3	025	-45	238 ft	124.0-132.0	8.0 ft	0.349
				166.5-179.5	13.0 ft	0.030
DP-94-4	025	-60	288 ft	173.0-198.0	25.0 ft	0.021
DP-94-5	025	-45	238 ft	125.5-130.5	5.0 ft	0.023
DP-94-6	025	-45	308 ft	155.5-165.5	10.0 ft	0.049
				205.0-210.5	5.5 ft	0.155
DP-94-7	025	-60	348 ft	has been submitted for assay.		

HOLE NO.	INTERVAL FEET	LENGTH FEET	GOLD OZ/T
DP95-1-4			0.025
			.03
			.075
			.64
DP95-5	103 - 133	30	.24
DP95-6	203 - 213	10	.6928
	66 - 93	27	.753
	118 - 158	40	

LA ROCK MINING CORP.
BRANDYWINE PROJECT
BRITISH COLUMBIA

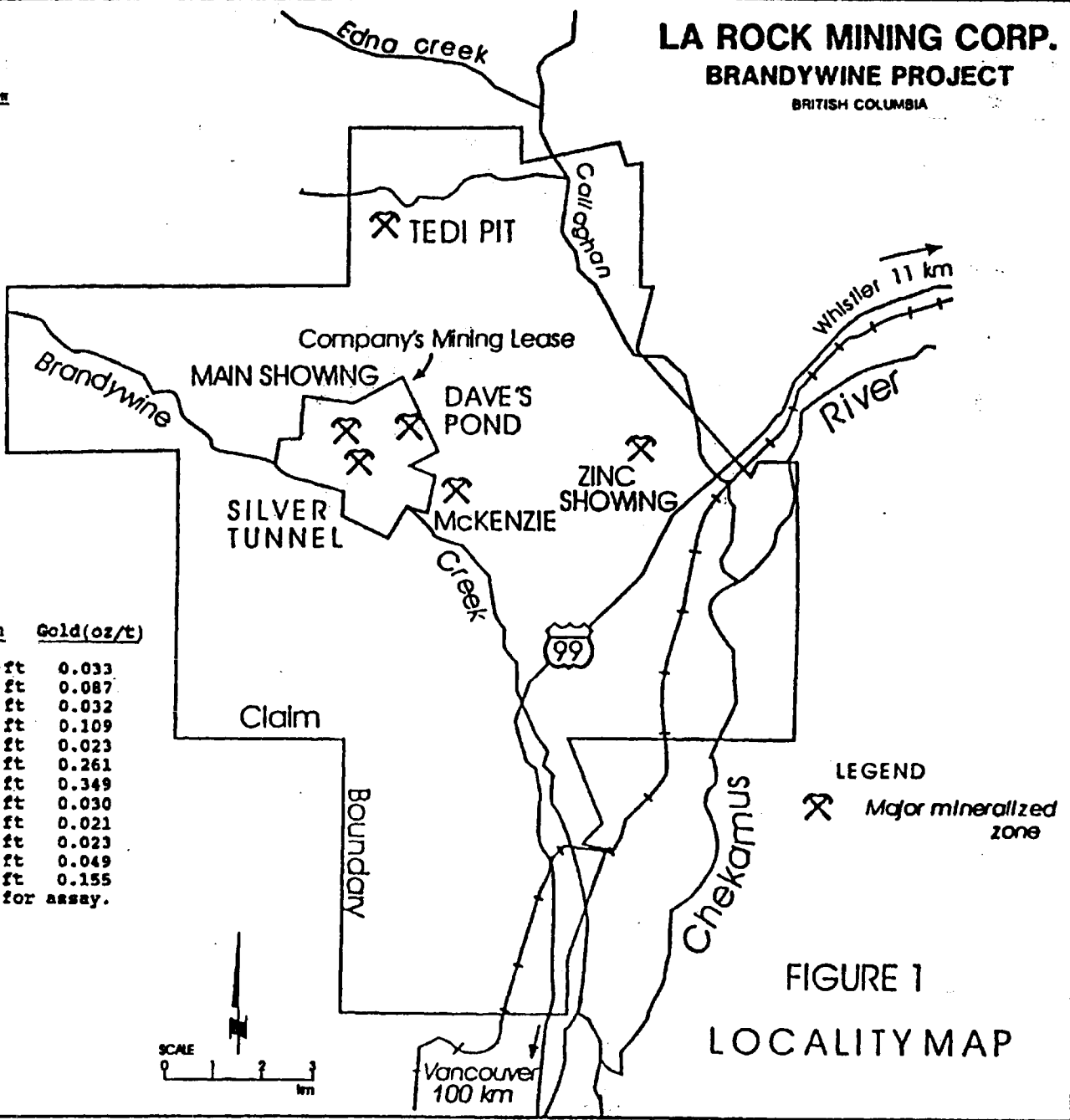

LEGEND
 Major mineralized zone

FIGURE 1
LOCALITY MAP

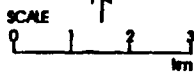

GEORGE

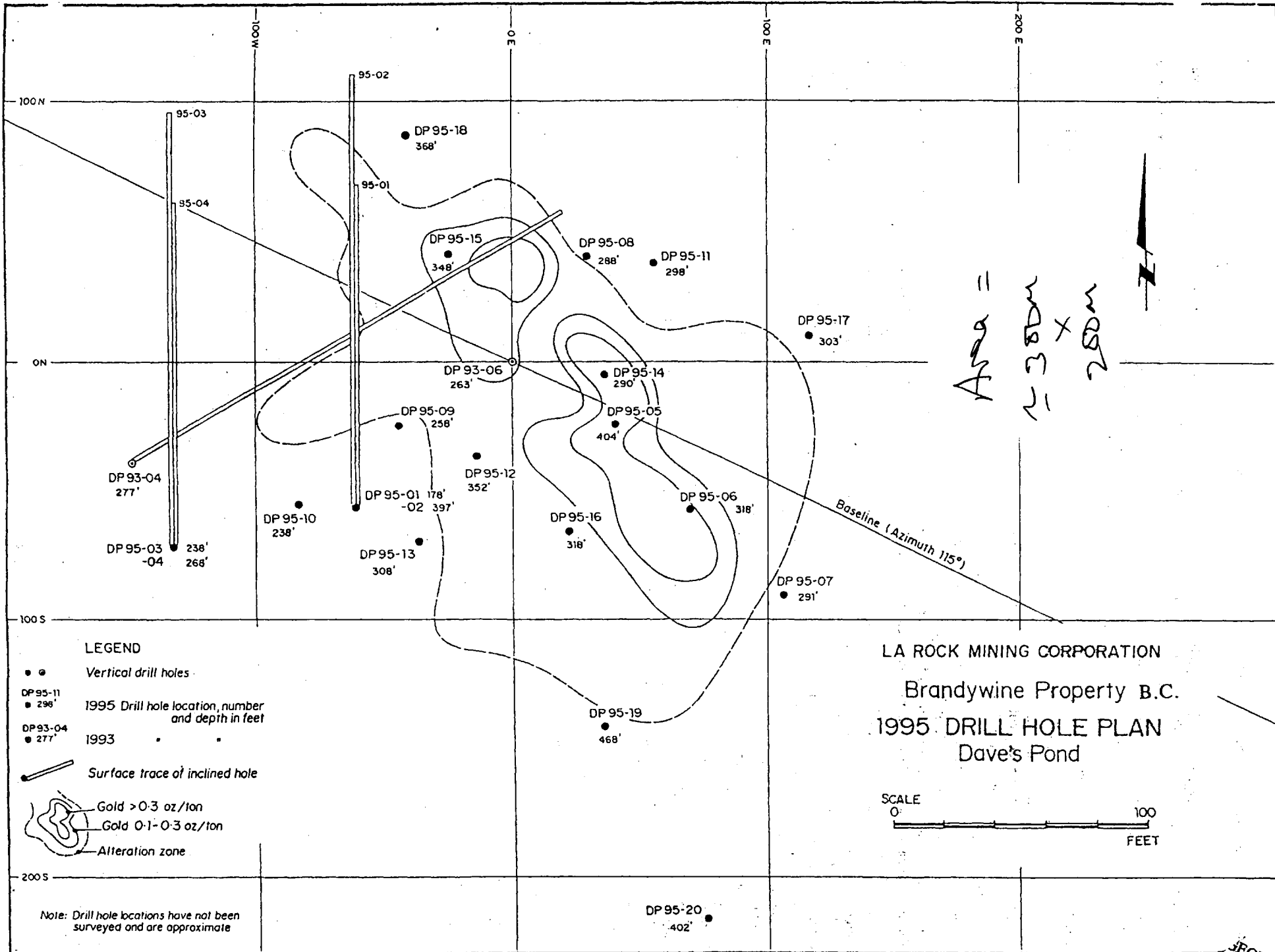

LEGEND

- • Vertical drill holes
- DP 95-11
• 296' 1995 Drill hole location, number and depth in feet
- DP 93-04
• 277' 1993
- Surface trace of inclined hole
- Gold > 0.3 oz/ton
- Gold 0.1-0.3 oz/ton
- Alteration zone

Note: Drill hole locations have not been surveyed and are approximate

LA ROCK MINING CORPORATION
 Brandywine Property B.C.
 1995 DRILL HOLE PLAN
 Dave's Pond

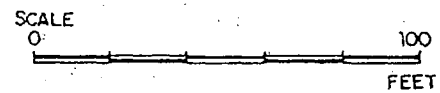

Area =
 ~ 350m
 x
 250m



GEORGE CROSS

BAN BON