

Surface Cut and Tunnel

BRALORNE SAMPLING
LENGTH - 95 FT
AVERAGE WIDTH - 57 FT
AVERAGE ASSAY - 005 OZ./TON

BRALORNE SAMPLING
LENGTH - 70 FT
AVERAGE WIDTH - 51 FT
AVERAGE ASSAY - 009 OZ./TON

MUCK SAMPLE OF QUARTZ IN FACE OF DRIFT SHOWN
015 OZ. GOLD

No 2 Fault

Assumed Position of No 1 Fault

340
Plm in East Segment of Vein.

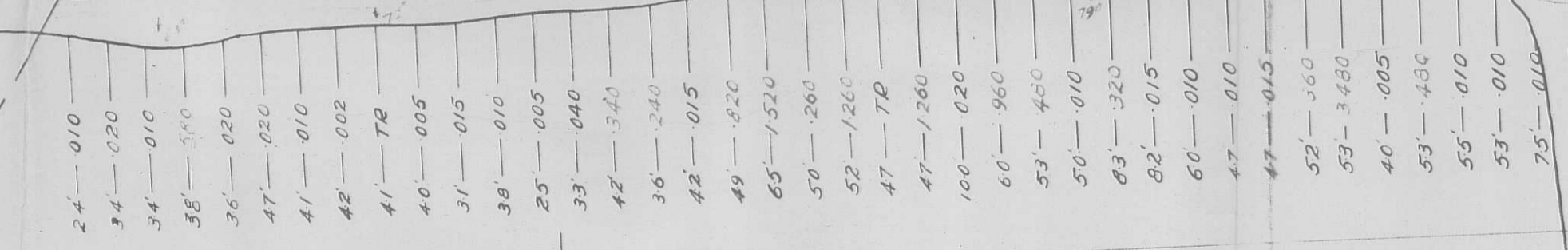

PREVIOUS SAMPLING
LENGTH - 135 FT
AVERAGE WIDTH - 53 FT
AVERAGE ASSAY - 030 OZ./TON

WALKER CROSSCUT

ELEV 3400 FT.

925/9w

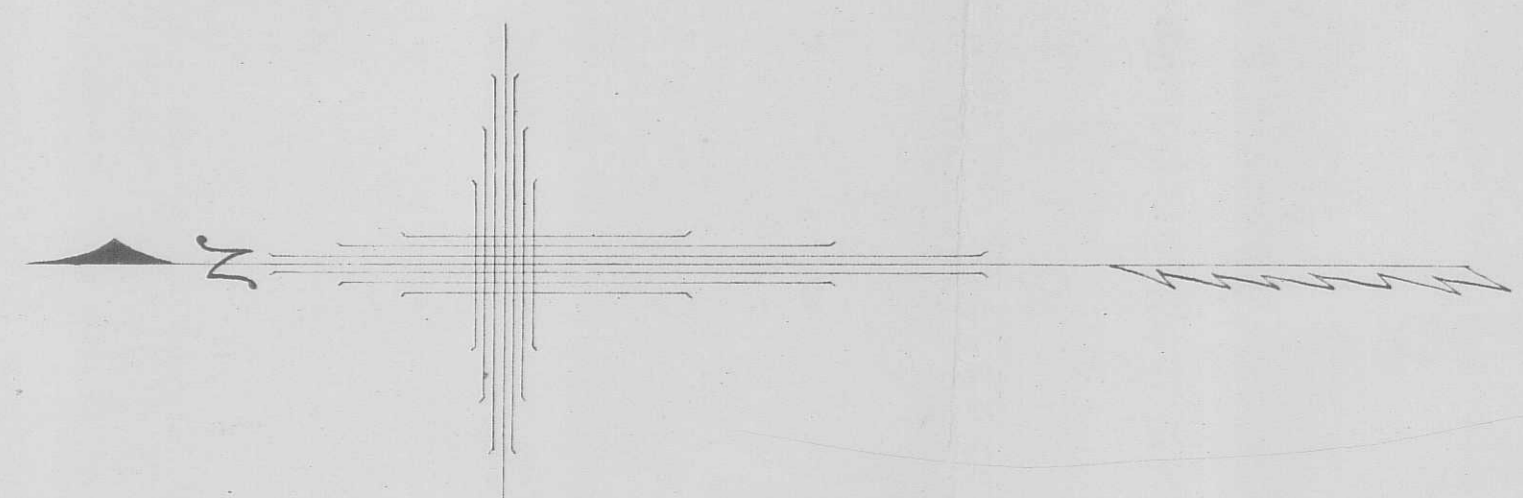

ASSAY LEGEND
1ST - WIDTH IN FEET
2ND - ASSAY IN OZ. PER TON
VEIN OUTLINED IN RED

NATIONAL GOLD MINES LTD.
MCGILLIVARY CREEK B.C.
ASSAY PLAN
OF
FAULTED SEGMENT 3RD LEVEL

SCALE 1"=20'

925NE079
PROPERTY FILE

DRAWN BY - GHWILSON

DATE - NOV 17th 1937