

2 copies sent  
 J.C. Foweraker  
 Nov. 24/58

enlarge to

CANEX AERIAL EXPLORATION LTD.

DIVISION OF  
 CANADIAN EXPLORATION LIMITED

Return to J.M. Carr

INTER-OFFICE MEMORANDUM

To J. D. LITTLE

Date 20 NOV. 1958.

From J. C. FOWERAKER

M.C.'S LOCATED IMMEDIATELY  
 Location SOUTH AND WEST OF THE  
 SUMMIT OF PROMONTORY HILLS  
 N.W. OF MERRITT, B.C.

Re PRELIMINARY SKETCH -  
PLAN OF BETTY LOU AND LOU M.C.'S  
SHOWING ROADS CONSTRUCTED FOR 4 WHEEL DRIVE VEHICLES

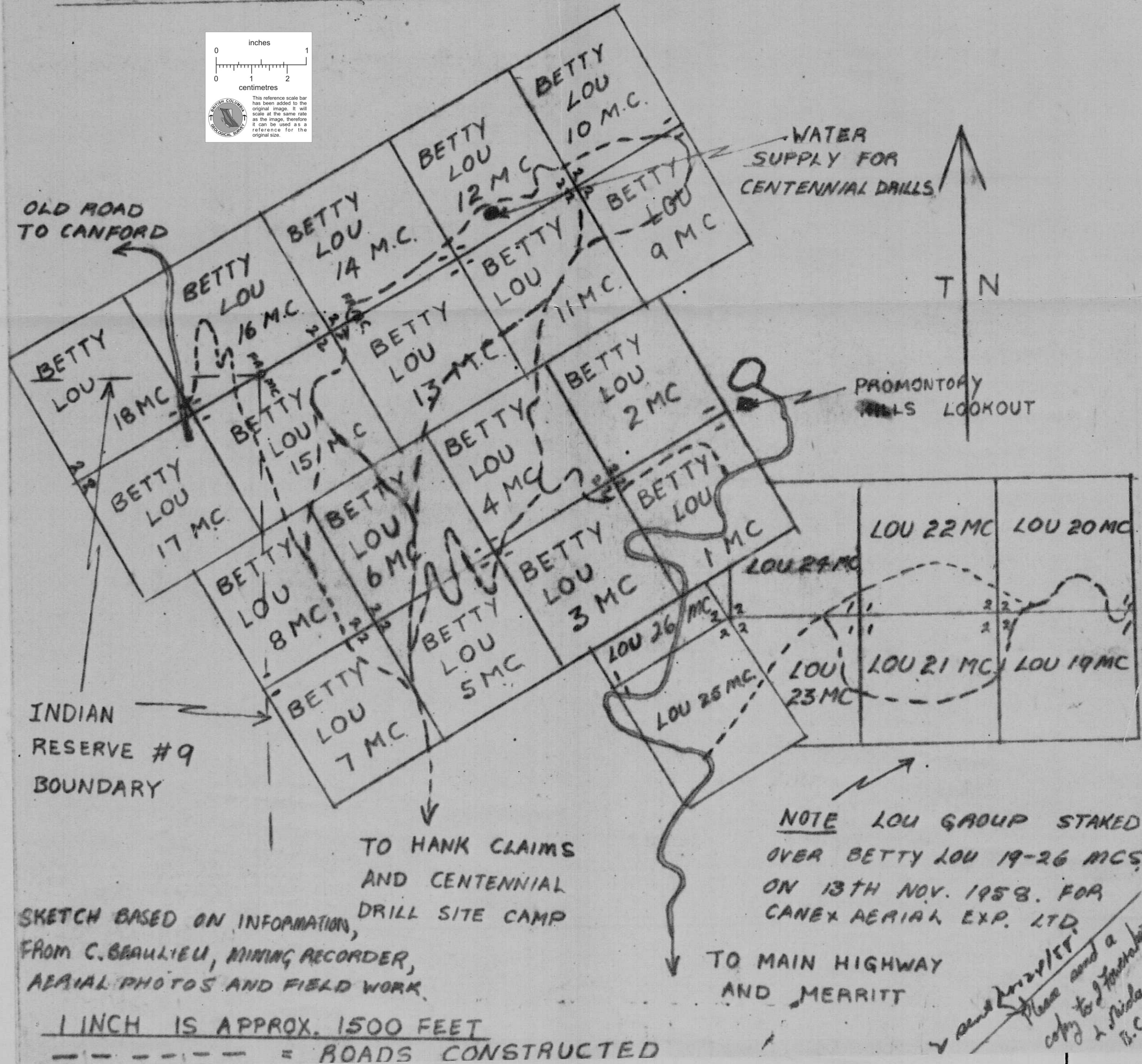
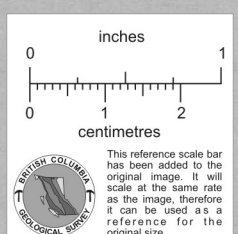

SKETCH BASED ON INFORMATION,  
 FROM C. BRULLIEN, MINING RECORDER,  
 AERIAL PHOTOS AND FIELD WORK.

1 INCH IS APPROX. 1500 FEET  
 --- = ROADS CONSTRUCTED

NOTE LOU GROUP STAKED  
 OVER BETTY LOU 19-26 M.C.S.  
 ON 13TH NOV. 1958. FOR  
 CANEX AERIAL EXP. LTD.  
 TO MAIN HIGHWAY  
 AND MERRITT

and J.M. Carr  
 Please send a  
 copy to J. Foweraker  
 & J. Little  
 B.C.