

# H. HILL & L. STARCK & ASSOCIATES LTD.

CONSULTING ENGINEERS  
MINING • METALLURGY • GEOLOGY  
844 WEST HASTINGS STREET  
VANCOUVER 1, B.C.

010519

*AZISE 51*

February 22nd, 1962.

Dr. M. Carr,  
Department of Mines & Petroleum Resources,  
Victoria, B. C.

Dear Sir:

Complying with your request to Mr. L. P. Starck for information on the SOO CLAIMS we submit the following:

Name of Claims -Soo Group, Nos. 1 to 32	32 claims
Verna Group, Nos. 1 to 12	12 claims
Bare Group, Nos. 1 to 4	<u>4 claims</u>
	48 claims

The 48 claims are held by right of location by the Copper Soo Mining Company Ltd., Osoyoos, B. C. Mr. T. G. Wilson is the Managing Director. H. Hill & L. Starck & Associates are the Consulting Engineers.

The claims are located 6 miles south east of Merritt, B. C.

During 1961 a magnetometer survey was made on the Soo Claims to check anomalies indicated by an earlier survey. A self potential survey was made over parts of the Soo Nos. 9 and 11. Nine X-ray drill holes, totalling 1,037 feet, were drilled on the Soo No. 11 claim.

During 1961 a magnetometer survey and geological reconnaissance were made on the Verna and Bare Groups.

We trust this is the information required.

Yours very truly,

H. HILL & L. STARCK & ASSOCIATES LTD.

*R. P. Mason*

R. P. Mason

DEPT. OF MINES  
AND PETROLEUM RESOURCES

Rec'd FEB 23 1962

*173*  
*Jme*

AND  
Rec'd  
\_\_\_\_\_  
\_\_\_\_\_

RPM/mjr

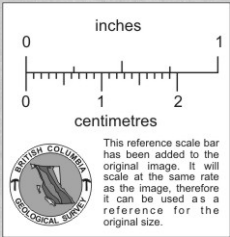
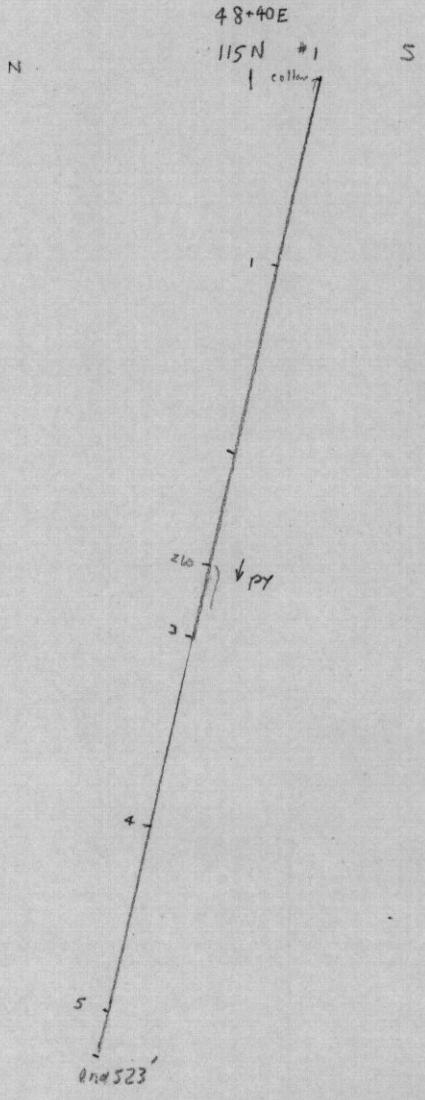

JUSTICE GP 1963

B/L & upper 100' line  
(129N)  $N \uparrow 1000' +$   
 $- 7 \text{ yr } @ 100'$

spotted P (the pk P<sub>0</sub>)  
collected DDH #1

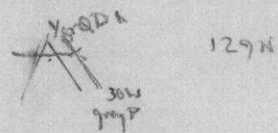

60E

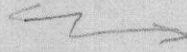

(ca 400' S of Bx clays)

127N

505'  $\uparrow 1/10$   
#2  
Bx v's w @D  
fings in Q3M3  
Bx v's group P



Bx: 7 yr @D wpl P fings (optite fings)  
2nd group

115N

$\uparrow -77^\circ$  523' - gray @D P at top  
#1  
135' - 7 yr @D w (i) pk opt v's  
(ii) e Bx v's (dk. like v's)  
(iii) 3 or more thin pk @3 later P clays (fl. r.?)

78E

$\downarrow$  800'  
to DDH #3 (530E at -43°)  
to DDH #4 nearby (140'E & 54E 102N)  
(55+50E 102N)

