

Mineralization

KAMLOOPS - GALAXY - BASELINE

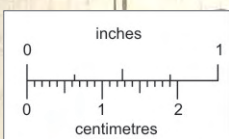
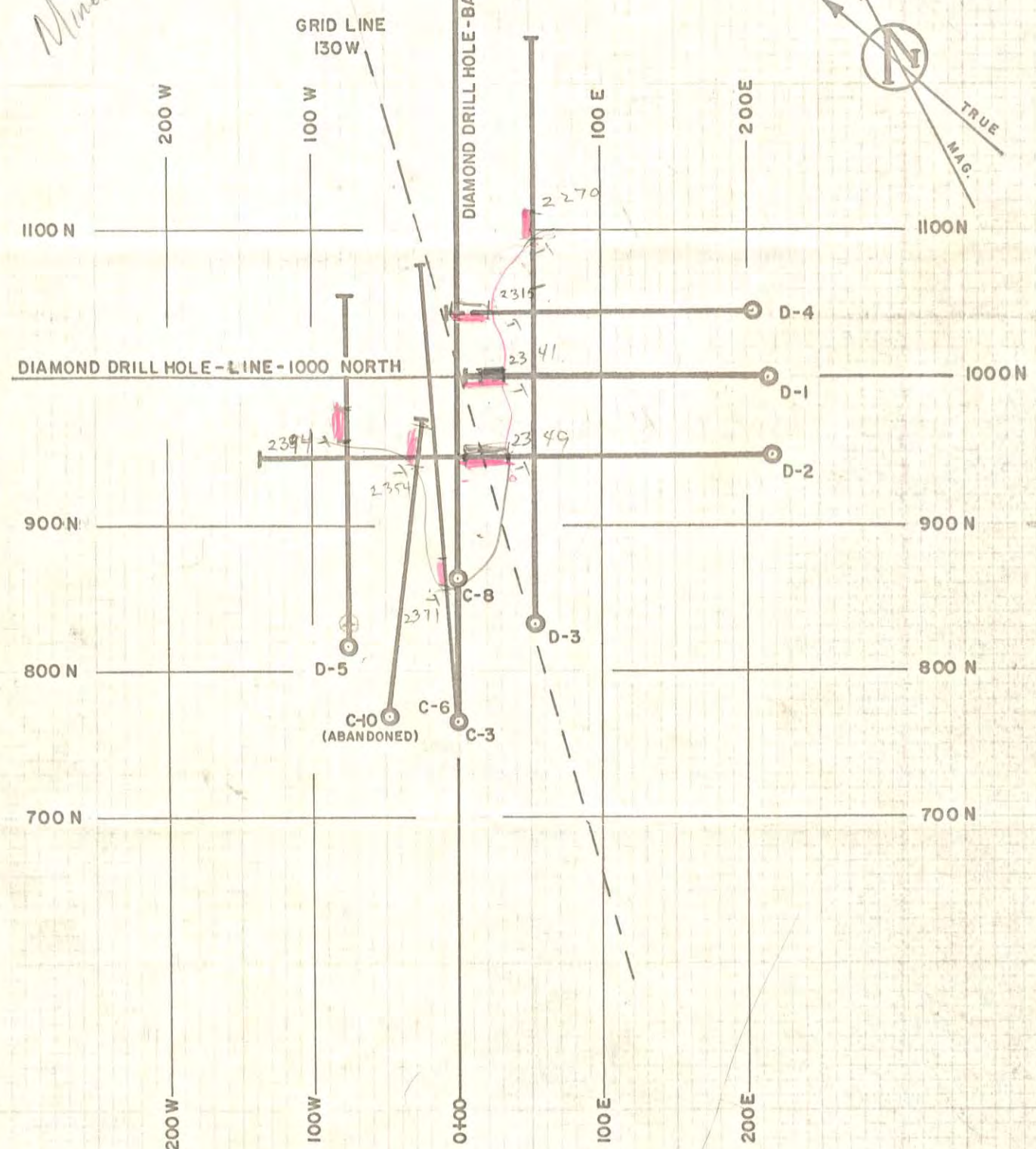
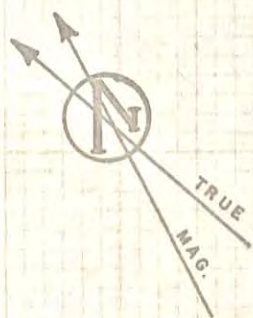

This reference scale bar has been added to the original image. It will scale at the same rate as the image, therefore it can be used as a reference for the original size.

21/9W
21/NE-11

KAMLOOPS COPPER CONS. LTD.
DRILL HOLE LOCATION DIAGRAM
KAMLOOPS - BRITISH COLUMBIA

SCALE - 1" = 100'

009841

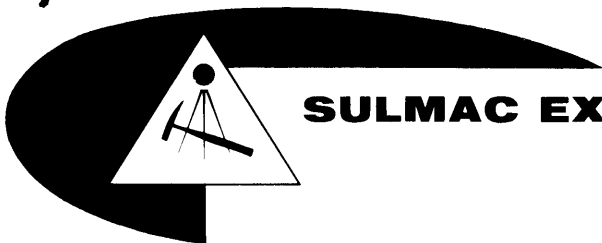

SULMAC EXPLORATION SERVICES LIMITED

Suite 824 — 602 West Hastings Street
Vancouver 2, B.C.
Telephone 685-4201

November 2, 1967

Dr. V. A. Preto,
Department of Mines & Petroleum Resources,
Victoria, B.C.

Dear Dr. Preto:

Please find enclosed sketch showing the location of the C & D series holes drilled on the Kamloops Copper Consolidated Ltd., Property in the Kamloops area, B.C. Please pardon the delay in delivery of the sketch, however I have been travelling steadily since I last saw you.

Cheers,

A handwritten signature in dark ink, appearing to be 'C.T. Pasieka'.

C.T. Pasieka.