

008895

6635

92H/7E

92HSE080-05

GILFORD RESOURCES LTD.

92HSE080 MI # 92HSE 80

PROPERTY FILE

P R O S P E C T U S

Date: May 20, 1977

NEW ISSUE

250,000 COMMON SHARES

RECEIVED
JUN 22 1977
SUPERINTENDENT OF BROKERS

Norma DEEP GULCH 92HSE

	Price to Public	Commission	Proceeds to Issuer if all Shares are Sold
Per Unit:	15¢	3.75¢	11.25¢
Total:	\$37,500.00	\$9,375.00	\$28,125.00*

* Less cost of issue estimated at \$3,000.00.

THERE IS NO MARKET FOR THE COMPANY'S SECURITIES

A PURCHASE OF THE SHARES OFFERED BY THIS PROSPECTUS MUST BE CONSIDERED A SPECULATION SINCE THE COMPANY'S MINERAL CLAIMS ARE STILL ONLY IN THE EXPLORATION STAGE. REFERENCE SHOULD ALSO BE MADE TO THE CAPTION, "PRINCIPAL HOLDERS OF SHARES", ON PAGE 9 AND THE COMPARISON OF THE PERCENTAGE OF SECURITIES BEING OFFERED TO THE PUBLIC BY THIS PROSPECTUS AND THOSE ALREADY ISSUED BY THE COMPANY TO PROMOTERS, DIRECTORS AND CONTROLLING PERSONS FOR CASH AND PROPERTIES.

NO SECURITIES COMMISSION OR SIMILAR AUTHORITY IN CANADA HAS IN ANY WAY PASSED UPON THE MERITS OF THE SECURITIES OFFERED HEREUNDER, AND ANY REPRESENTATION TO THE CONTRARY IS AN OFFENCE.

NO SURVEY HAS BEEN MADE OF THE COMPANY'S LOCATED MINERAL CLAIMS; THEREFORE, IN ACCORDANCE WITH THE MINING LAWS OF THE PROVINCE OF BRITISH COLUMBIA IN WHICH SUCH CLAIMS ARE SITUATED, THEIR EXISTENCE AND AREA COULD BE IN DOUBT.

THE PROPERTY OF THE COMPANY IS WITHOUT A KNOWN BODY OF COMMERCIAL ORE, AND THE PROPOSED PROGRAMME IS AN EXPLORATORY SEARCH FOR ORE.

REFER TO THE CAPTION, "USE OF PROCEEDS", ON PAGE 3 FOR PARTICULARS OF THE MINIMUM SUBSCRIPTION TO WHICH THIS ISSUE IS SUBJECT.

PROPERTY FILE

92HSE080

INDEX

	<u>Page</u>
New Issue	Front-Page Cover
Name and Incorporation of Issuer	1
Plan of Distribution	1
Directors and Officers	1
Capitalization	2
Prior Sales	3
Description of Share Capital Structure	3
Use of Proceeds	3
Description of Business and Property of Issuer	7
Preliminary Expenses	
Principal Holders of Shares	9
Promoters	9
Remuneration of Directors and Senior Officers	10
Escrowed Shares	10
Pooled Shares	11
Material Contracts	11
Interest of Management and Others in Material Transactions	11
Auditors, Transfer Agents and Registrars	11
Purchaser's Statutory Right of Recission	11
Other Material Facts	13
Financial Statements	
Engineering Report	
Certificate	

REPORT
ON THE
NORMA PROPERTY
COPPER MOUNTAIN AREA
SIMILKAMEEN M.D., B.C.

For:

GILFORD RESOURCES LTD.

1020 - 470 Granville Street
Vancouver, B.C.

By:

ALLEN GEOLOGICAL ENGINEERING LIMITED
Vancouver, B.C.

April 12, 1977.

GILFORD RESOURCES LTD.

Statement of changes in financial position
for the period from March 29, 1977 (date of incorporation)
to April 15, 1977

SOURCE OF FUNDS:

Issue of shares of capital stock \$ 22,501

USE OF FUNDS:

Acquisition of mineral claims -

By cash 750
By issue of shares of capital stock 7,500
8,250

Deferred charges -

Exploration 925
Administration 2,867
3,792

Incorporation 929
4,721
12,971

WORKING CAPITAL, April 15, 1977 \$ 9,530

REPRESENTED BY:

Current assets \$ 12,705
Less current liabilities 3,175
\$ 9,530

CONTENTS

INTRODUCTION..... 1.

LOCATION..... 1.

TOPOGRAPHY..... 2.

PROPERTY..... 2.

HISTORY..... 3.

GEOLOGY..... 3.

SUMMARY AND CONCLUSIONS..... 4.

RECOMMENDATIONS..... 5.

REFERENCES..... 6.

MAPS:

- 1. Location
- 2. Property

THE NORMA PROPERTY

COPPER MOUNTAIN AREA

SIMILKAMEEN M.D., B.C.

INTRODUCTION

The Norma property was examined by the writer on April 7, 1977.

The object of the examination was to acquire as much data as available pertaining to the geology and topography of the Deep Gulch Creek - Friday Creek area.

The purpose of this report is to describe the geology and physical features of the area and to outline an exploration programme thereon.

LOCATION

The Norma property is located in southern British Columbia adjacent to the Hope-Princeton Highway, 14 miles south of Princeton and westerly $2\frac{1}{2}$ miles from Copper Mountain.

It extends from Deep Gulch Creek to Friday Creek.



PROPERTY LOCATION

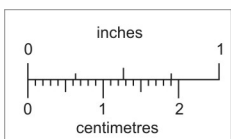

This reference scale bar has been added to the original image. It will scale at the same rate as the image, therefore it can be used as a reference for the original size.



GILFORD RESOURCES LTD.	
LOCATION MAP	
SCALE: 1" = 136 MIs.	
Drawn by	Date APRIL 12/77
Checked by	Drg no. 1
ALLEN GEOLOGICAL ENGINEERING LTD.	

TOPOGRAPHY

The Norma property is located 4000 feet above sea level on the northeast slope of Friday Mountain, on the west side of the Similkameen River. From river level to the property, the valley wall is steep, but the gradient is considerably lower on the claim area.

Deep Gulch and Friday creeks head above the property and flow easterly into the Similkameen River.

PROPERTY

The Norma claim comprises five unit lengths south and two unit lengths west from the Legal Corner Post. The post is located approximately 300 feet west of the Hope-Princeton Highway, at the intersection of the old highway and a subsidiary road. This is approximately 14 miles south of Princeton.

The metal tag number is 35043.

It was located by John Turner March 7 and 8, 1977.

It is designated as Claim #207 and is shown on the accompanying B.C. Department of Mines and Petroleum Resources Map #92H-7E.

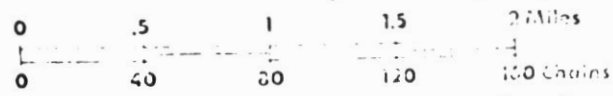
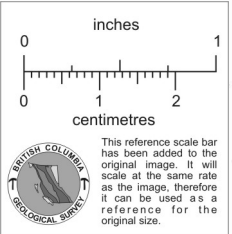
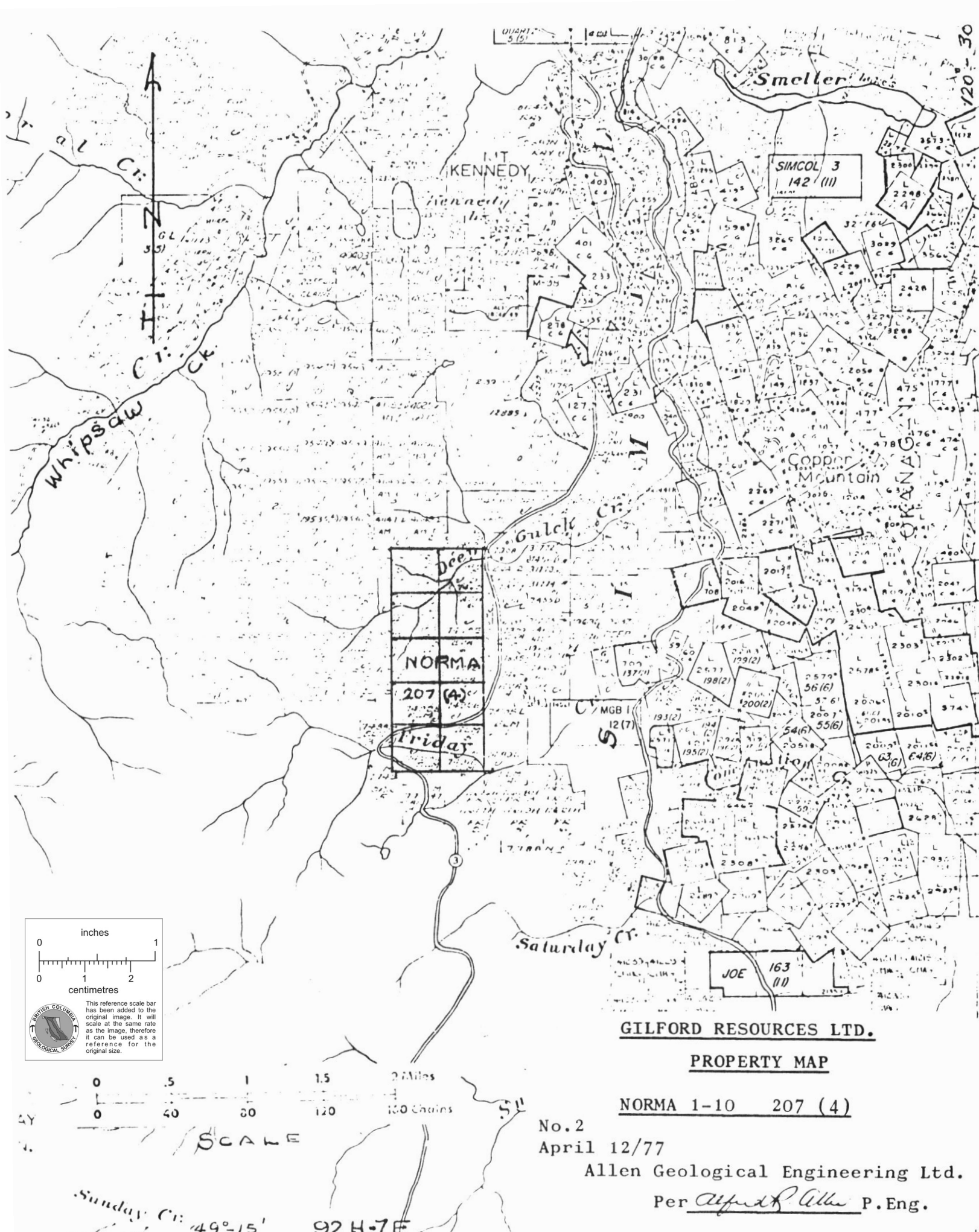

SCALE

GILFORD RESOURCES LTD.

PROPERTY MAP

NORMA 1-10 207 (4)

No. 2

April 12/77

Allen Geological Engineering Ltd.

Per Alfred P. Allen P. Eng.

Sunday Cr. 49°-15' 92H-7E

HISTORY

Copper mineralization was discovered close to Deep Creek, at an elevation of 4000 feet, in 1952 by D.W. Galagher. He excavated shallow pits at several locations on chalcopyrite, bornite and pyrite showings.

Some additional exploratory work was carried out in 1958-59 by the Deep Gulch Mining Syndicate.

In 1971 the ground was staked for the Collishaw group and limited work was done on and around the copper showings.

The claims were allowed to lapse during the downturn in mining, and the Norma claim was staked March 7 and 8, 1977, on behalf of the present owners.

GEOLOGY

The Deep Gulch-Friday creek area is underlain by Triassic sediments and volcanics of the Nicola Group. Coast Range granitic rocks intrude the above. Younger granitic intrusions, including the Copper Mountain, Otter and Lightning Creek, have invaded the Coast Range and Nicola rocks. Associated with the Copper Mountain intrusive complex are the mineral deposits of the region.

On the Norma property Copper Mountain monzonite syenodiorite and syenogabbro rim the eastern portion; Nicola andesite and sericitized tuff outcrop on the central to northern area and the southern section is capped by Tertiary basaltic extrusives.

Chalcopyrite and bornite occur in disseminations, shear zones and veins, usually accompanied by malachite and limonite staining. These have been partially exposed by stripping and trenching, but most of the workings are now sloughed in and the character of the mineralization is not evident. Porphyry dykes, veins and fractures trend northeasterly.

SUMMARY AND CONCLUSIONS

The Norma property comprising a 600-acre claim, is located on the Hope-Princeton highway about 15 miles south of Princeton and southwest of Copper Mountain. The 22,000 ton per day Similkameen open pit operation is located between the property and Princeton.

Exploratory work in the late 1950's and early 1970's partially exposed copper mineralization at several locations in the Deep Gulch-Friday Creek area.

It is concluded that because of the favourable location and excellent geology, a field programme be directed towards a re-examination of surface copper mineral showings and a search for additional deposits.

RECOMMENDATIONS

The following works programme is recommended on the Norma property.

	<u>Estimated Costs</u>
1. Establish a 200 by 400-foot grid over that part of the property not overlain by the Tertiary extrusive rocks,	\$1,500.00
2. Conduct a geochemical survey over the grid area,	1,500.00
3. Make a sketch map showing the geology, claim boundaries, roads and trails, streams and workings and copper showings,	3,000.00
4. Clean out former workings and map and sample the mineralized zones,	2,000.00
5. Conduct an Induced Polarization survey over the grid area,	6,000.00
6. Expose anomalous zones by stripping and trenching,	2,000.00
7. Office, overhead and supervision,	2,000.00
8. Contingencies fund,	2,000.00
Total estimated costs,	<u>\$20,000.00</u>

The estimated time for completion of this field work is three months.

Respectfully submitted,

ALLEN GEOLOGICAL ENGINEERING LIMITED

Per Alfred R. Allen P. Eng.
Alfred R. Allen

Vancouver, B.C.
April 12, 1977.

REFERENCES

Rice, H.M.A., G.S.C. Princeton Sheet, Mem.

B.C. Department of Mines, Minister of Mines Report
1959, pp 53-54

Allen Geological Engineering Limited

203 - 2025 Bellevue
West Vancouver, B.C. V7V 1B9

926-2089
985-3409

CERTIFICATE

April 12, 1977.

I, Alfred R. Allen, certify that:

I am a graduate of the University of British Columbia
and hold the following degrees therefrom:

BASc Geological Engineering 1939

MASc Geological Engineering 1941

I am a member of the Association of Professional Engineers of
the Province of British Columbia.

I have practised my profession for the past thirty years.

I hold no interest in the properties or securities of Gilford
Resources Ltd., or affiliates thereof, nor do I expect to
receive any, directly or indirectly.

The report on the Norma Property, Copper Mountain Area,
Similkameen M.D., B.C., is based on an examination of the
property by the writer on April 7, 1977.

I consent to this report being filed with the British
Columbia Securities Commission.



Alfred R. Allen

CERTIFICATE

The foregoing constitutes full, true and plain disclosure of all material facts relating to the securities offered by this prospectus as required by Part VII of the Securities Act and the regulations thereunder.

DATED the 20 day of May, 1977, at the city of Vancouver, in the province of British Columbia.

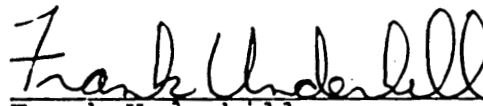

Frank Underhill
Director and Promoter



Laurence Kershaw
Director and Promoter



Edward Murray
Director and Promoter