

LEGEND FOR ROCK TYPES

- | | | | | | | | | |
|---|------------|---|---|---|--|---|--|--------|
| 900 E | INTRUSIVES | - DIORITE, DIORITE PORPHYRY
- GRANODIORITE, MONZONITE
- FELSPAR PORPHYRY DYKES
- BIGTITE PORPHYRY DYKES
- DIABASE DYKES | | 950 E | | | | |
| 900 E | VOLCANICS | - ANDESITE
- RHYOLITE | <table border="0"> <tr> <td style="vertical-align: top;">BRECCIA
FRAGMENTAL
AMYGDULAR
MASSIVE</td> <td style="vertical-align: top;"> </td> </tr> <tr> <td style="vertical-align: top;">BRECCIA
FRAGMENTAL
AMYGDULAR
MASSIVE</td> <td style="vertical-align: top;"> </td> </tr> </table> | BRECCIA
FRAGMENTAL
AMYGDULAR
MASSIVE | | BRECCIA
FRAGMENTAL
AMYGDULAR
MASSIVE | | 1000 E |
| BRECCIA
FRAGMENTAL
AMYGDULAR
MASSIVE | | | | | | | | |
| BRECCIA
FRAGMENTAL
AMYGDULAR
MASSIVE | | | | | | | | |
| 900 E | SEDIMENTS | - BANDED TUFFS
- ARGILLITES
- CONGLOMERATE | | 1000 E | | | | |
| | | SAMPLE AVERAGES - $\frac{Au(0z/T)}{Length(m)}$ $\frac{Ag(0z/T)}{Length(m)}$ | | | | | | |

K.L.S. INVESTMENTS LTD.		
DOCTORS POINT GOLD PROJECT		
NEW WESTMINSTER MINING DIVISION		
HARRISON LAKE, B.C.		
CROSS-SECTION 2065N		
MAIN ZONE		
Prepared by: J.T. SHEARER, M.Sc., P.Geo.		
Scale: As Shown	DATE: June 1997	Fig. 8

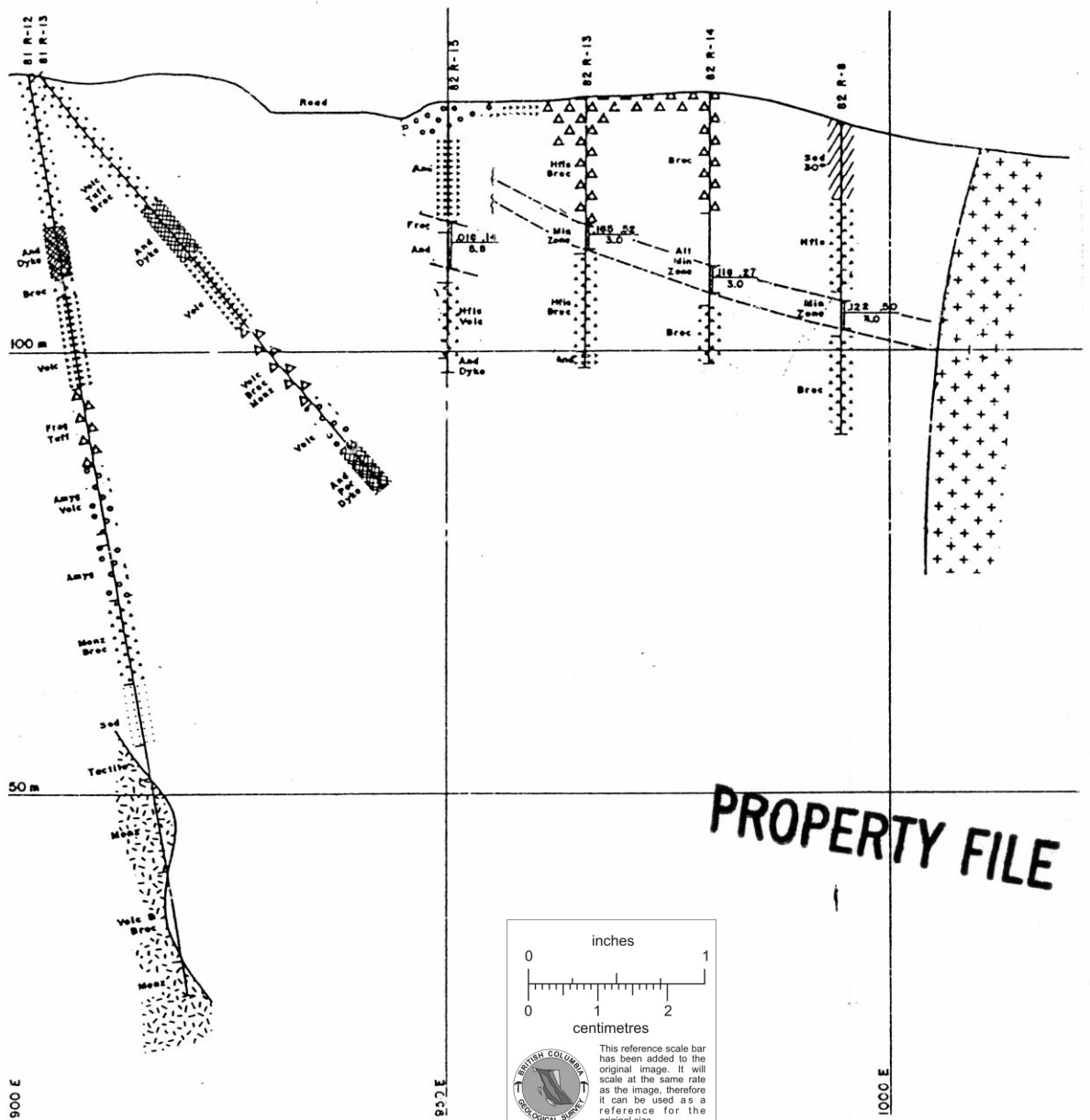

LEGEND FOR ROCK TYPES

INTRUSIVES — DIORITE, DIORITE PORPHYRY	
— GRANODIORITE, MONZONITE	
— FELSPAR PORPHYRY DYKES	
— BIOTITE PORPHYRY DYKES	
— DIABASE DYKES	
VOLCANICS — ANDESITE	
— BRECCIA	
— FRAGMENTAL	
— AMYGDULAR	
— MASSIVE	
— RHYOLITE	
— BRECCIA	
— FRAGMENTAL	
— AMYGDULAR	
— MASSIVE	
SEDIMENTS — BANDED TUFFS	
— ARGILLITES	
— CONGLOMERATE	
SAMPLE AVERAGES — Au(O ₂ /T) Ag(O ₂ /T) Length (m)	

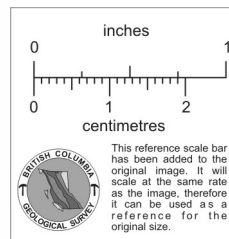

K.L.S. INVESTMENTS LTD.	
DOCTORS POINT GOLD PROJECT NEW WESTMINSTER MINING DIVISION HARRISON LAKE, B.C.	
CROSS-SECTION 2095N	
Prepared by: J.T. SHEARER, M.Sc., P.Geo.	
Scale: As Shown	DATE: June 1997
Fig. 9	

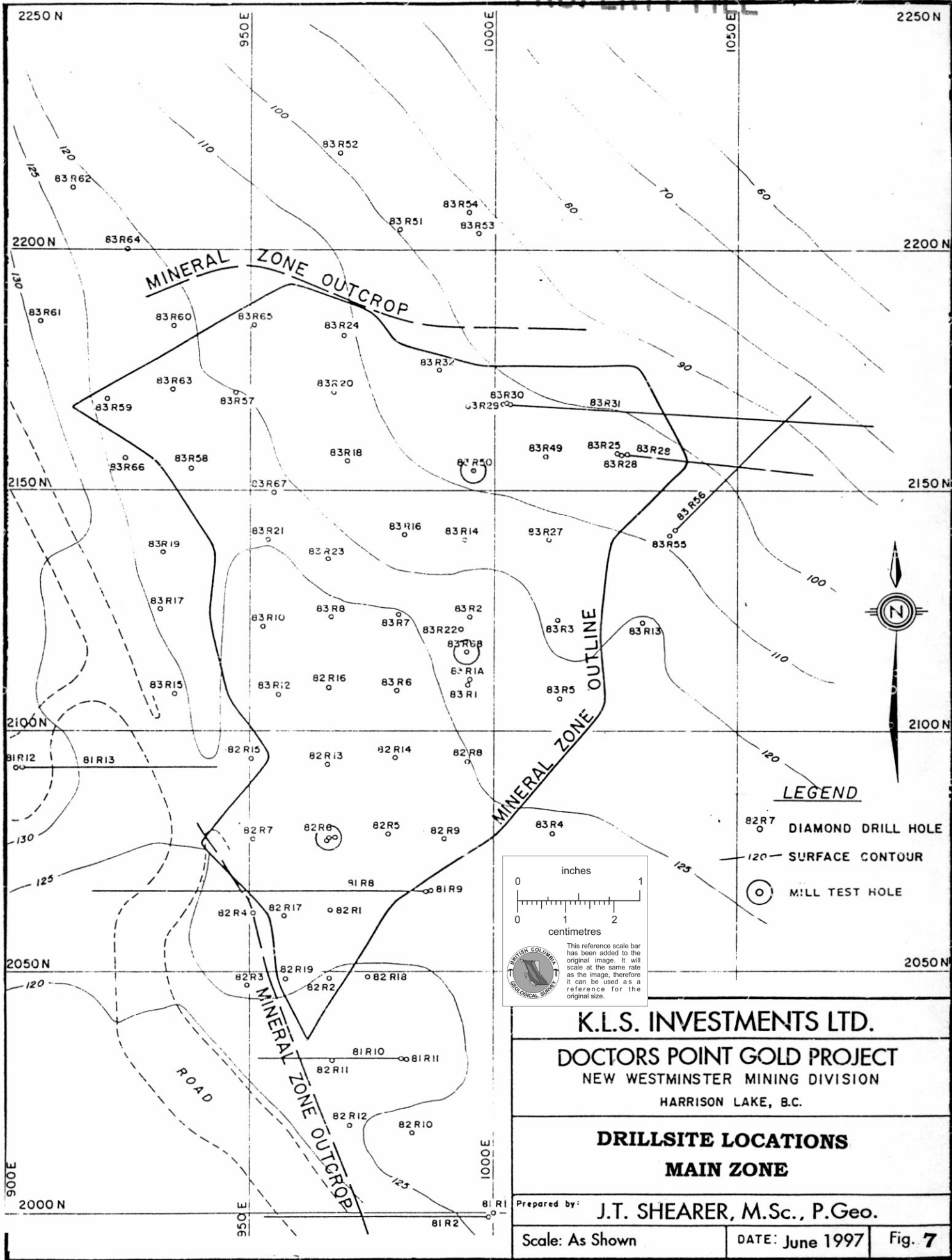

K.I.S. INVESTMENTS LTD.	
DOCTORS POINT GOLD PROJECT	
NEW WESTMINSTER MINING DIVISION	
HARRISON LAKE, B.C.	
DRILLSITE LOCATIONS	
MAIN ZONE	
Prepared by: J.T. SHEARER, M.Sc., P.Geo.	
Scale: As Shown	DATE: June 1997
	Fig. 7

PROPERTY FILE

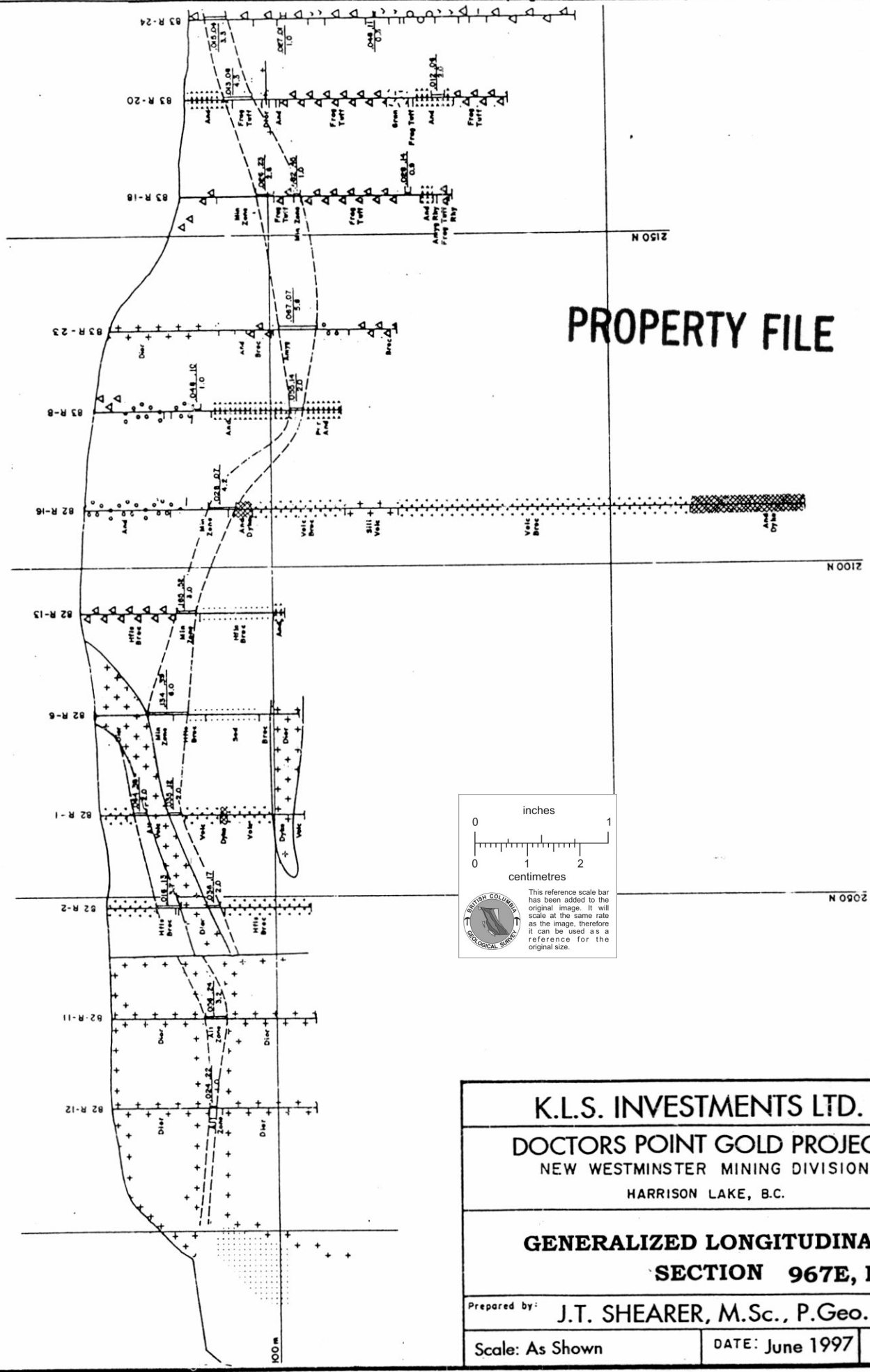

K.L.S. INVESTMENTS LTD.		
DOCTORS POINT GOLD PROJECT NEW WESTMINSTER MINING DIVISION HARRISON LAKE, B.C.		
GENERALIZED LONGITUDINAL SECTION 967E, MAIN		
Prepared by: J.T. SHEARER, M.Sc., P.Geo.		
Scale: As Shown	DATE: June 1997	Fig.11

PROPERTY FILE

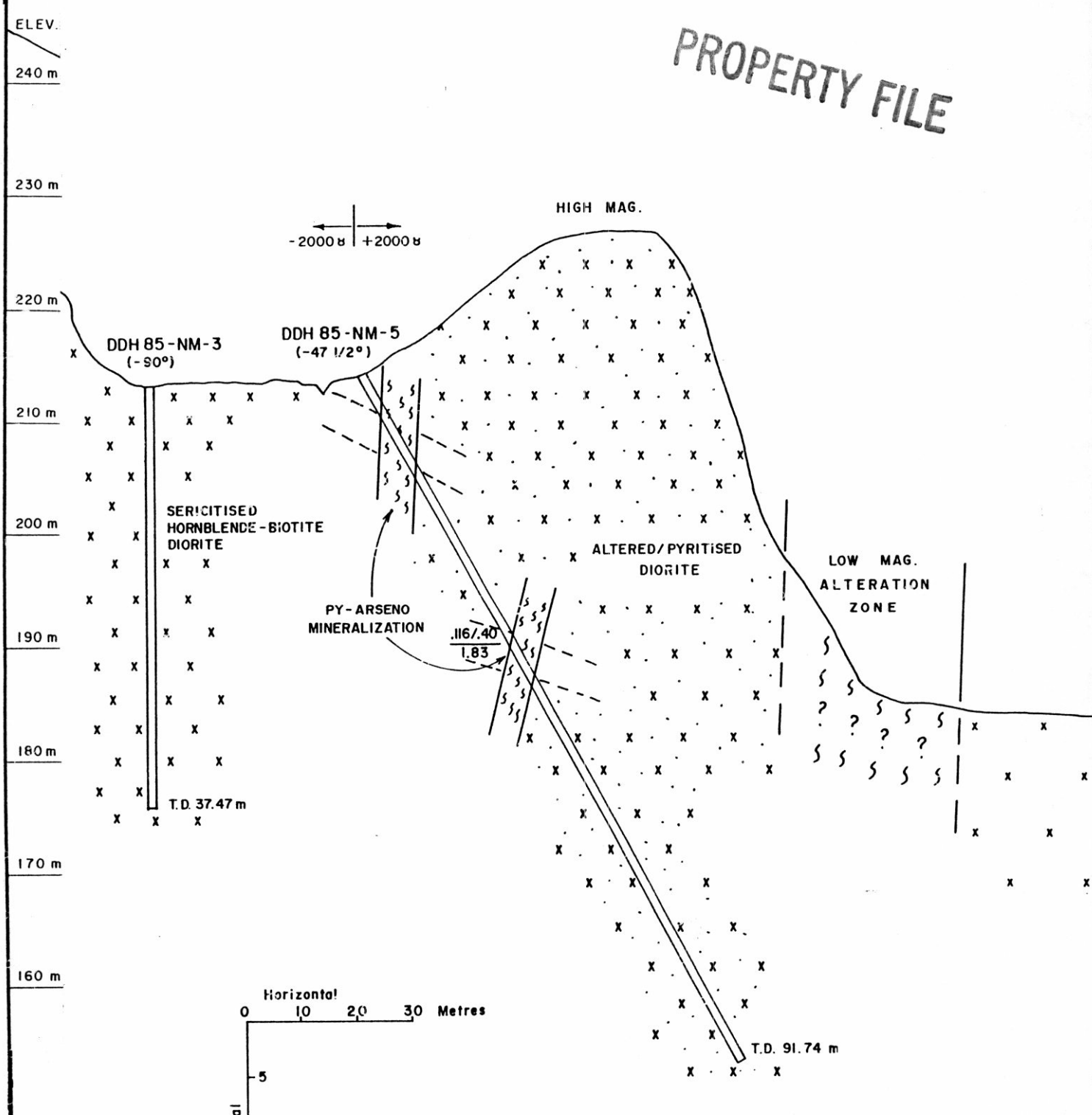

K.L.S. INVESTMENTS LTD.		
DOCTORS POINT GOLD PROJECT		
NEW WESTMINSTER MINING DIVISION		
HARRISON LAKE, B.C.		
GENERALIZED CROSS SECTION		
NORTH MILLSITE AREA		
Prepared by: J.T. SHEARER, M.Sc., P.Geo.		
Scale: As Shown	DATE: June 1997	Fig. 14

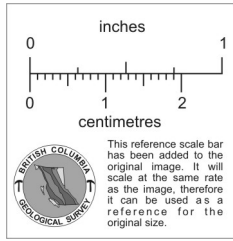

PROPERTY FILE

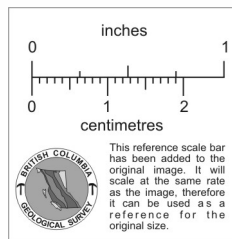
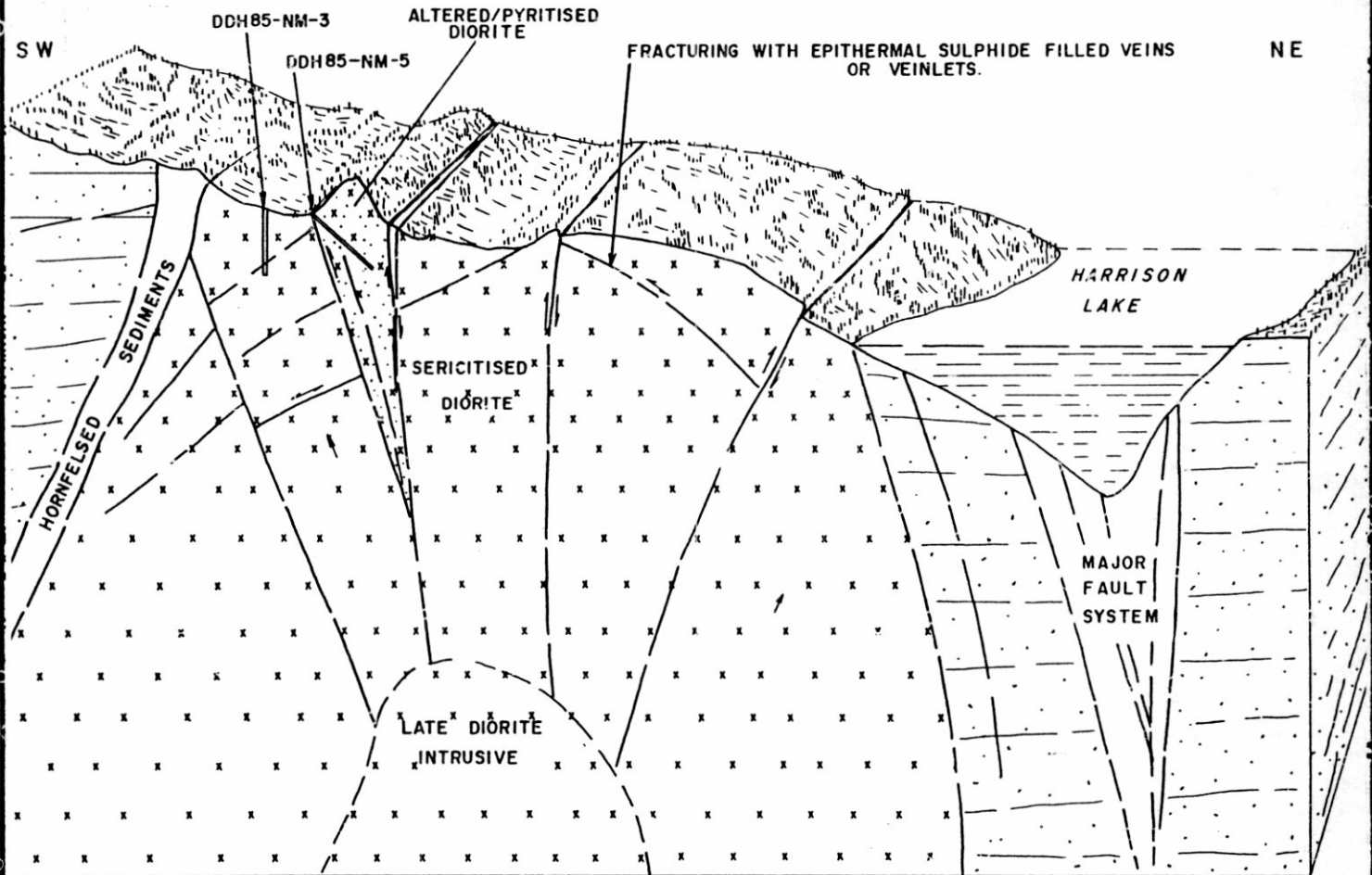

K.L.S. INVESTMENTS LTD.	
DOCTORS POINT GOLD PROJECT NEW WESTMINSTER MINING DIVISION HARRISON LAKE, B.C.	
VEIN MODEL, DOCTORS POINT AREA	
Prepared by: J.T. SHEARER, M.Sc., P.Geo.	
SCALE:	DATE: June 1997
Fig 15	

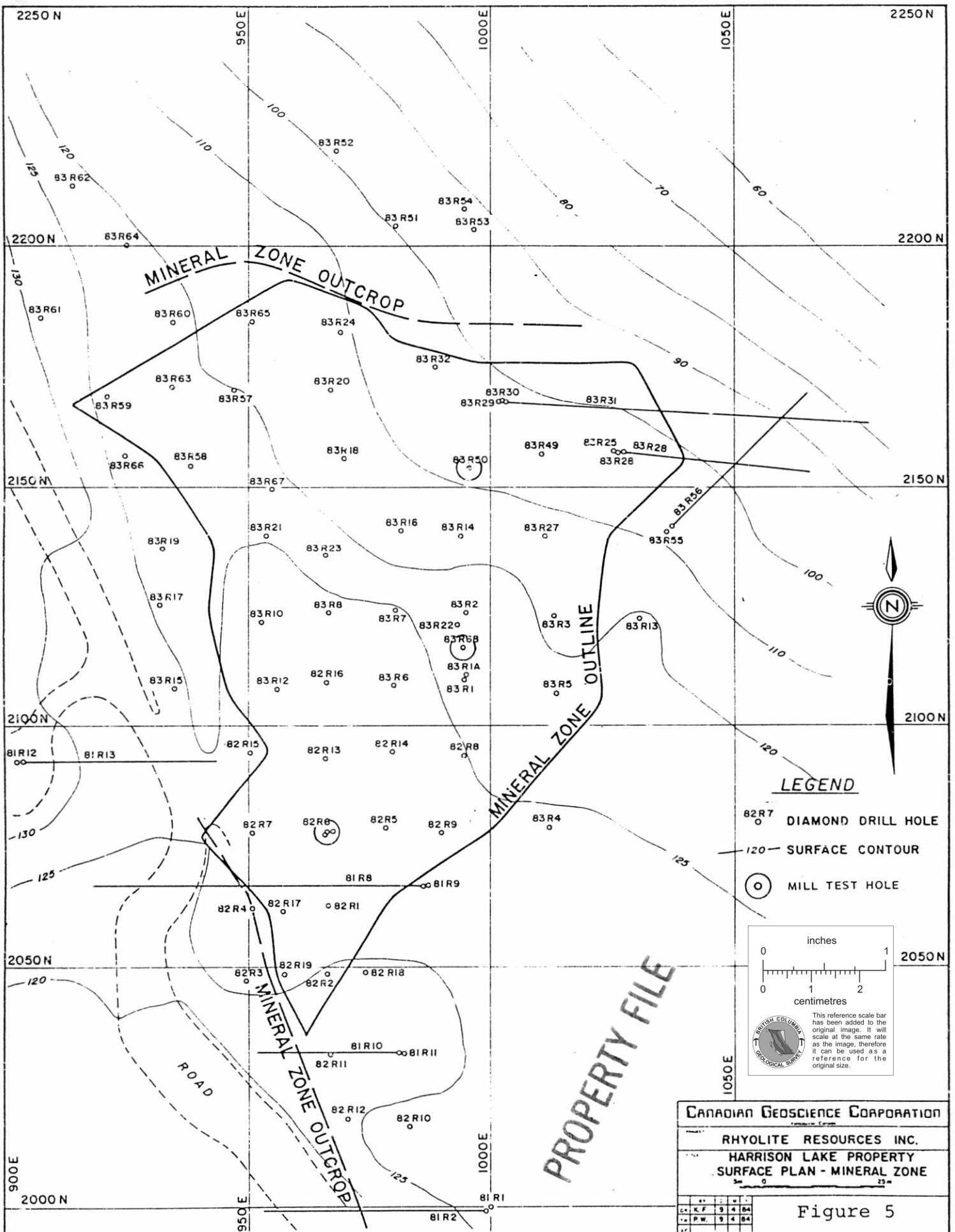

LEGEND

- 82R7 DIAMOND DRILL HOLE
- 120 SURFACE CONTOUR
- MILL TEST HOLE

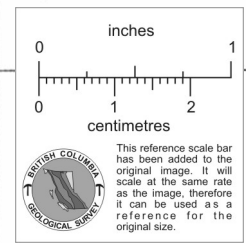

CANADIAN GEOSCIENCE CORPORATION
 RHYOLITE RESOURCES INC.
 HARRISON LAKE PROPERTY
 SURFACE PLAN - MINERAL ZONE

..
..
..
..

Figure 5

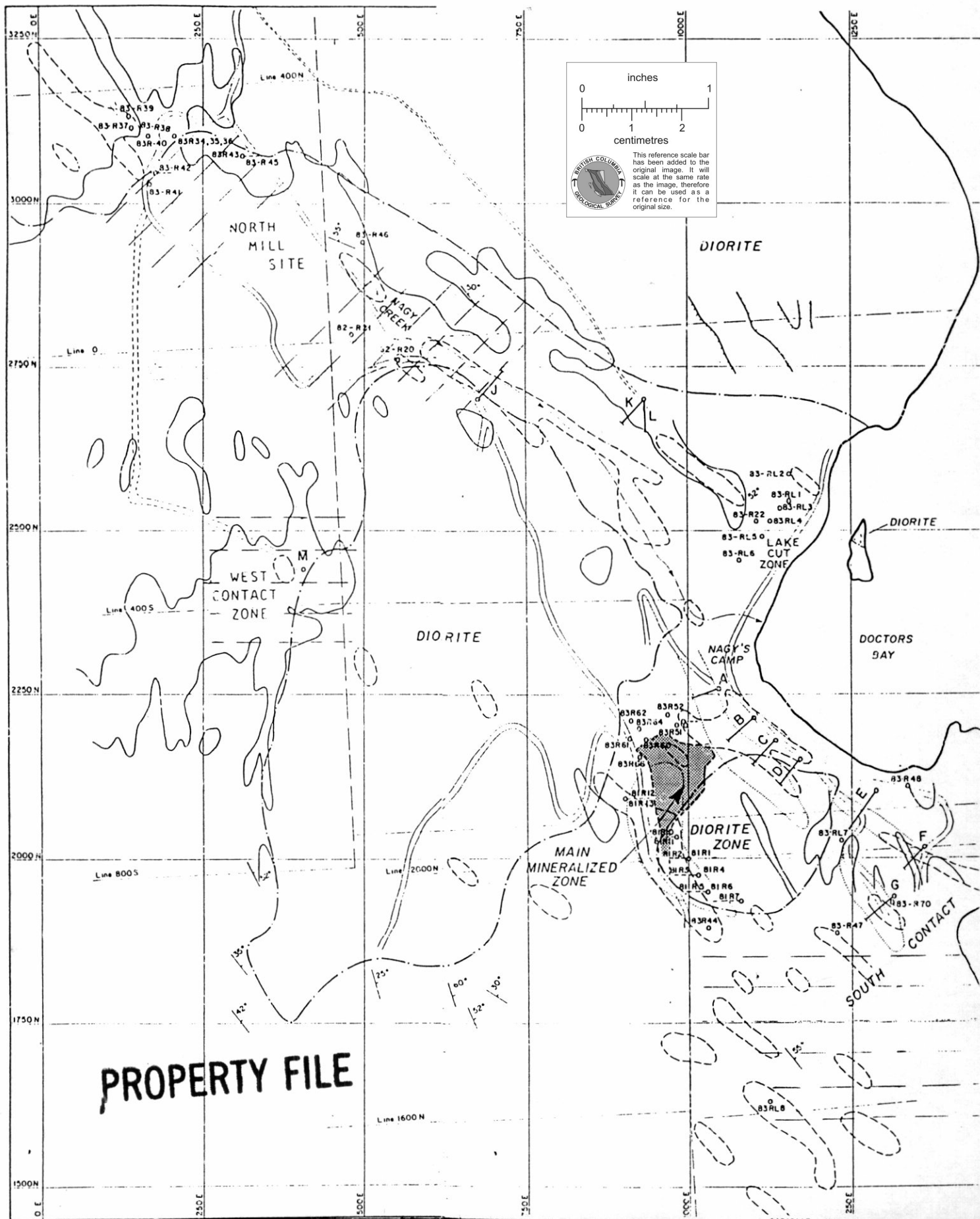

PROPERTY FILE