

SENT BY:

8-19-92 1 28PM Princeton-GOV AGENT-

19567410# 1/ 8

008425

92HNE 034

u

TO: Peter Jus
Geological Branch
Victoria Bc

FROM: Govt Agent
Princeton Bc

DATE: Aug 19/92

NUMBER OF PAGES TO FOLLOW: 2

TRANSMITTED FROM: GOVERNMENT AGENT
BOX 9
PRINCETON, B. C. VOX TWO

FAX NUMBER: 295-3070

TELEPHONE NUMBER: 295-6957 OR TOLL FREE: 1-800-663-0637

MESSAGE: As per your request copy
of affidavit & court's sketch
for Leap record # 36669

924/16FE

CHNE 054

DEPARTMENT OF MINES AND PETROLEUM RESOURCES



MINERAL ACT
FORM G

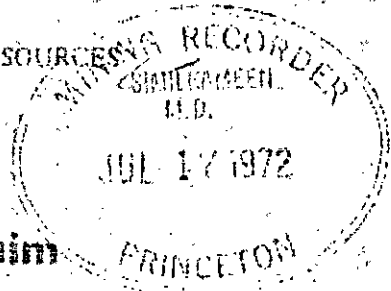

Affidavit Full-sized Claim

PRINCETON Mining Division

MR-630581

930

I, EDWARD GORDON Agent for GEN. DEL. PRINCETON B.C.
(Name.) (Name.)
(Address.) (Address.)

Free Miner's Certificate No. 107140 Date issued JUNE 9/72
Free Miner's Certificate No. _____ Date issued _____

make oath and say:—

1. On the 15 of JULY, 1972, I located the LEAP #1 Mineral Claim, situate [here describe position of claim as near as possible, giving the name or names of any mineral claim or claims it may adjoin] LEAP #1 BORDERS LEAP #2 ON THE SOUTH AND LEAP #3 ON THE WEST.

2. I have placed a No. 1 and a No. 2 legal post on the legal dimensions of the said claim

3. I have securely fastened to the No. 1 post that portion of a metal identification tag, No. 229 2201 N embossed "Initial Post (No. 1)," upon which the following information has been impressed:—

Name of claim LEAP #1
Locator E. GORDON Agent for _____
Date of location JULY 15/72
Approximate compass bearing to No. 2 post WESTERLY
Distance to No. 2 post 1500 feet
Number of feet to right of location-line 1500
Number of feet to left of location-line _____

4. I have securely fastened to the No. 2 post that portion of a metal identification tag, No. 227 2201 N embossed "Final Post (No. 2)," upon which the following information has been impressed:—

Name of claim LEAP #1
Locator E. GORDON Agent for _____
Date of location JULY 15/72

5. I have marked the line between No. 1 and No. 2 posts as required by the provisions of the Mineral Act.

6. To the best of my knowledge and belief the ground comprised within the boundaries of the said claim is unoccupied by any other person as a mineral claim; it is not occupied by any building and is not any land falling within the curtilage of any dwelling-house, or any orchard, or any land under cultivation, or any Indian or military reservation.

PRINCETON

SWORN and subscribed to at _____

this 17 day of JULY, 1972
before me— [Signature]
Mining Recorder
SIMILKAMEEN M.D.

NOTE.—Draw sketch-plan on reverse side

* This affidavit may be taken by a person empowered to take affidavits by the Evidence Act of British Columbia.

036669

EXAMPLE of
type of sketch
required

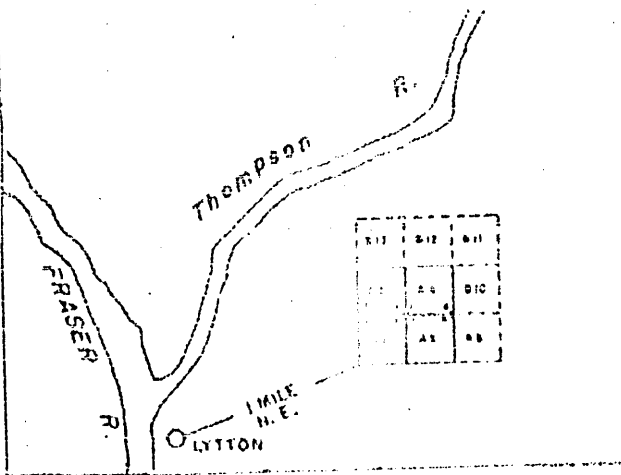

Claims must be tied by direction and distance to at least one, preferably more than one, topographical feature, or to a land lot, section, township, or other recognizable point on printed maps of the district. Relationship of previously located claims should also be shown.

N.B. — The sketch for a group of claims may be placed on one affidavit.

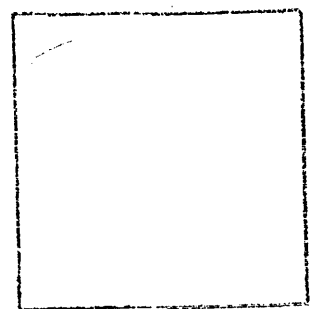

INDICATE NORTH
(True or Magnetic)

N

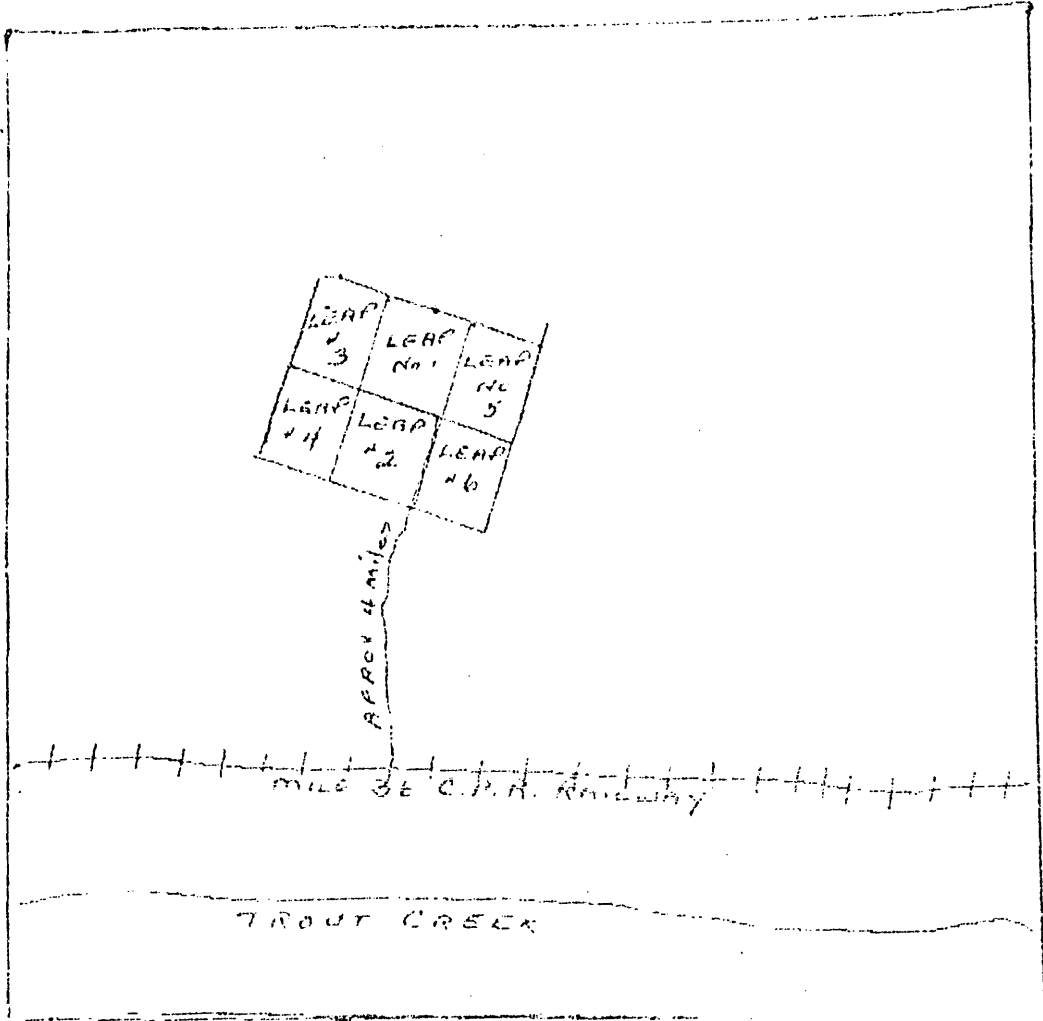

W

E

PRINCETON

Summerland

mile 36 C.P.R. Railway

TROUT CREEK

5

