

PLAN
OF
MINERAL CLAIMS
OF THE
ZINC CREEK MINES LTD.

NORTH VANCOUVER, B.C.

SCALE: 1" = 300'

Copied from blue-print of 1914.

Exposed Ore -  - by Starr's survey to claim corners.
Drainage and Contour Lines approximate only.

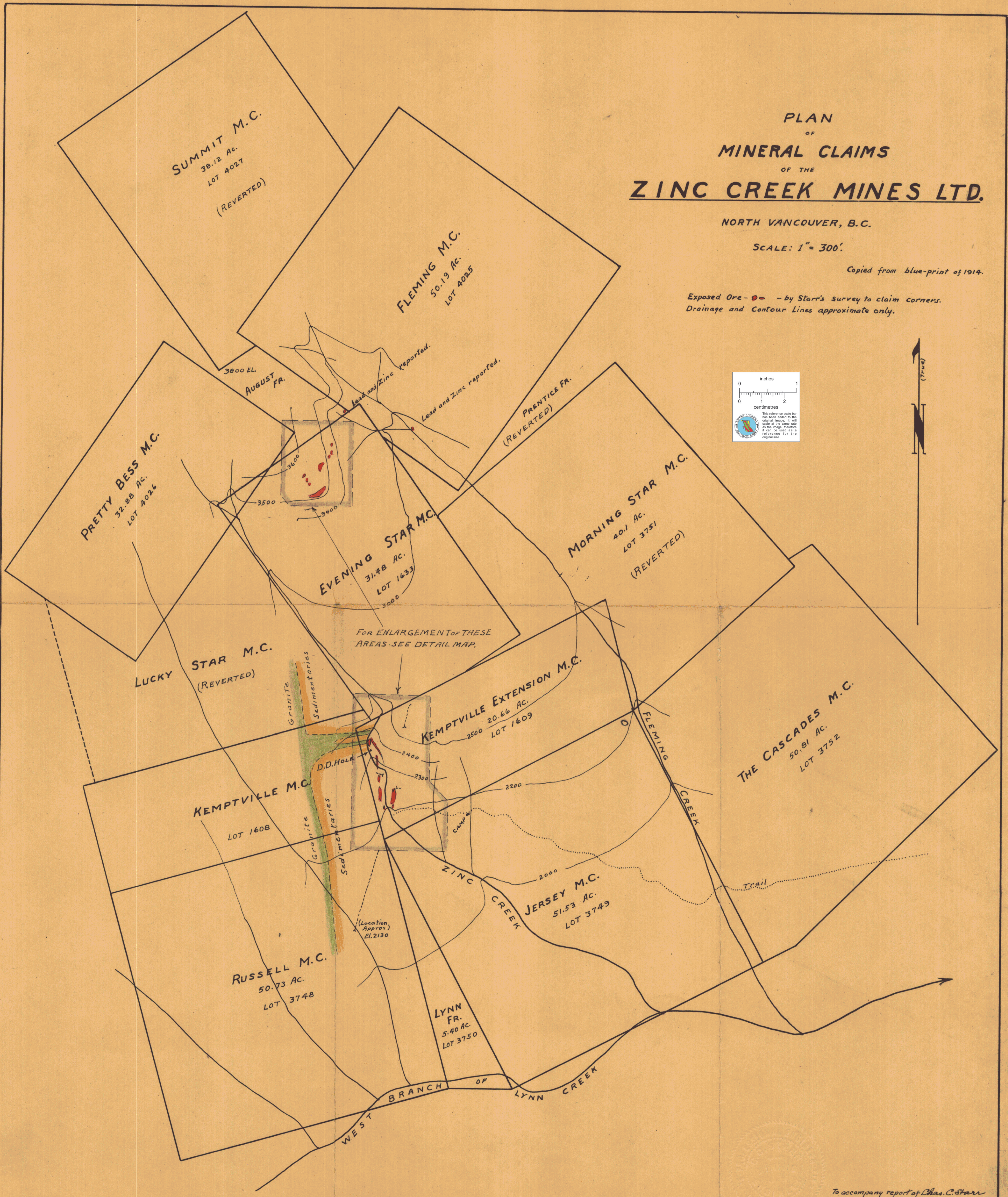
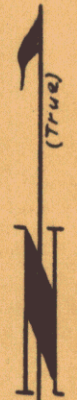
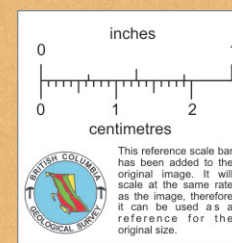

To accompany report of *D. Has. C. Starr*
May 1926

008254