

# PROPERTY FILE

March 5th, 1995

File:

RE: Steven, Christie Claim: Corbold Creek: 92G/10E

---

Comments on telephone conversation with Clayton Gadsby, owner of Steven and Christie Claims (92G/10E).

- Gold-bearing quartz vein cuts the corner of an ice-field near Remote Peak. It is only accessible by helicopter in mid-summer. It trends NW/SE and projects into Golden Ears Provincial Park in both directions.

- The vein system appears to be part of larger structure that projects for several kilometres into the park. It has two gold zones over a width of 4.0 metres.

- There is placer gold in Corbold Creek.

Robert Pinsent

near 0926NE014

NIVRAM I  
 308794  
 SNX2W  
 206200  
 110457  
 NIVRAM II  
 308795  
 36X2W  
 ROBINE I  
 4004 (4)  
 65x2W

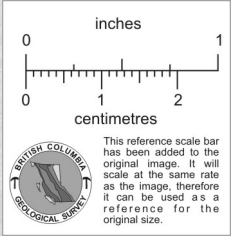

~ 0926NE04 X

STEVEN  
 3219 (8)  
 2N x 2E  
 128759  
 128760  
 REMOTE  
 PKI  
 CHRISTIE  
 3220 (8)  
 45 x 2E

GERANAMO  
 3373 (6) 2N x 3W  
 GERANAMO 2  
 3387 (7) 2N x 3E  
 11503E 11503S  
 11503E  
 GERANAMO 3  
 3390 (8)  
 25 x 5W

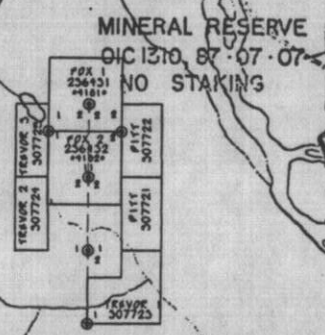
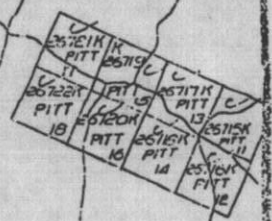

12170 128771  
 MM 9  
 3541 (12) C  
 55 x 41E  
 MM 10  
 3542 (12) C  
 55 x 4E  
 Fish Hatcher Cr.

AIVIN  
 (PC)  
 225440  
 REY

M 20  
 35 (1) C  
 55 x 4E

SNOW

PIT

Creek

Corbold

Creek