

92F/2E

W.L.W.

007344

92F 141

Laurence S. Trenholme
GEOLOGIST

6746 MARGUERITE STREET
VANCOUVER 14, B.C.

TELEPHONE (604) 263-4455

- 687-9076

January 20, 1975

Mr. John Cotowick,
President,
Corrigan Creek Mines Ltd.,
P.O. Box 370,
Port Alberni, B. C.

Dear John:

This is to confirm observations made on my visit to the property on Sunday, January 19, 1975.

The new (No. 4 Adit) has been advanced to a point 71 feet from the original rock ledge marked by a steel pin (0 + 00). Because of the friable nature of the rocks, the face of the portal has been cut back so that the brow over the portal is now at 0 + 45' and the face 26 feet beyond this point.

The approximate bearing is 230°T and dimensions are approximately 10' x 10'.

The main vein shear is persisting strongly as projected at 220°T , dipping 35°SE , so that it now occupies the upper left part of the face.

Lenses of quartz vein material from a few inches to about 2 feet in width adjoin the main gouge seam on either side and locally are mineralized with 10% to 25% coarse pyrite. A specimen of better looking material 6" wide was taken for assay by Mr. Centini.

The proposed program is as follows:

1. Timbering of the portal for safety and to reduce handling excess rock.

. . . / 2

PROPERTY FILE

92F141

2. Reduce size of adit to about 8' x 8'.
3. Change direction left about 10° so as to keep the gouge seam and vein in the right (NW) side of the face. This should give better hanging wall conditions and reduce overbreak.
4. For mucking use either a diesel scoop tram with approved scrubber or rent air powered loader using rail on hand.

General

The structure is continuing strongly in the expected direction (S40°W). Approximately 200 feet of advance will be required to bring the adit below the full dip projection of the highgrade surface trenches, but it should be borne in mind that similar material could be encountered at any point along the gouge fault.

Recommendations

1. It is important to stay with the gouge seam and to keep it in the lower (right hand) part of the face.
2. After another 100 feet of advance it is recommended that test holes be drilled in the footwall (NW) side, with sludges collected for gold assays. This is to check the possibility of a wider zone of low to medium grade material suggested by some of the surface samples.

Any encouragement in this regard should be followed up by diamond drilling flat holes from the adit.

Yours very truly,

L. S. Trenholme

L. S. Trenholme.

LST:bj

cc Mr. Val Contini,
c/o A. E. Le Page Western Ltd., 20/1/75
885 Dunsmuir Street,
Vancouver, B. C.

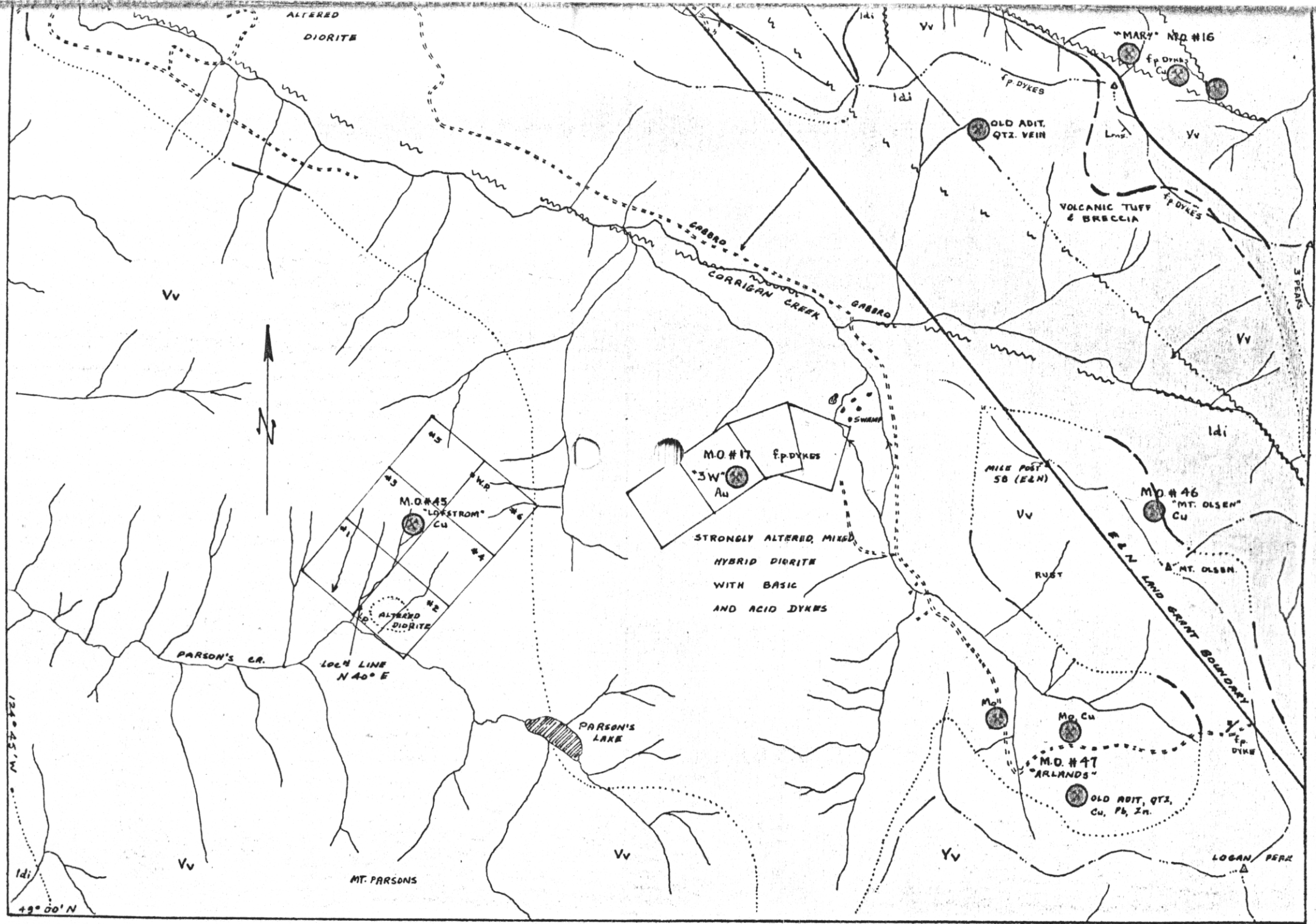

GEOLOGY AND MINERAL OCCURRENCES PARSON'S CREEK - CORRIGAN CREEK AREA

SCALE: 1" = 1/2 MILE