

PROPERTY FILE

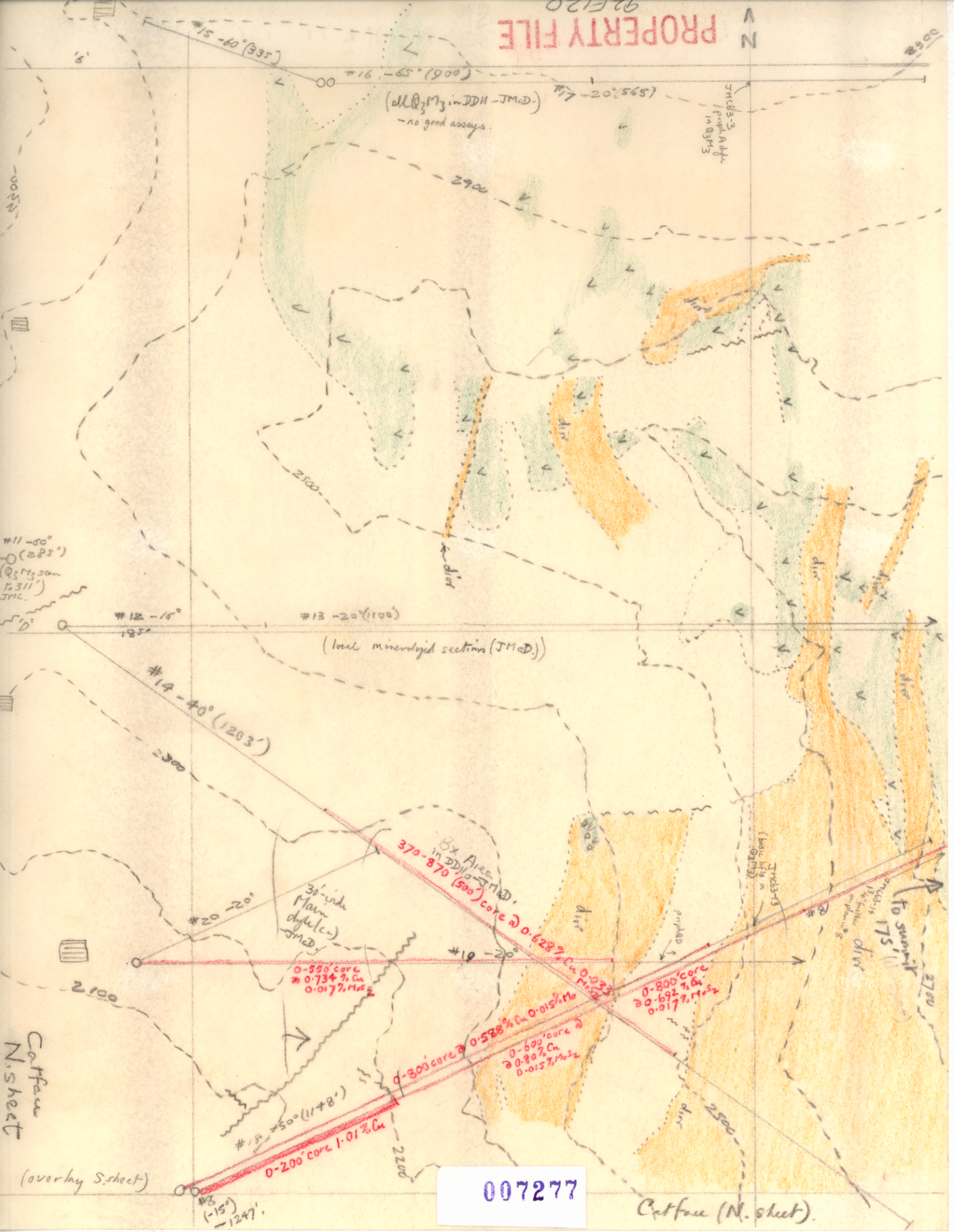

(all Q_3 in DDH - JMD) - no good assays

Tricks-3
100m
100m

#11 - 60°
(283')
Q₃ 1735m
15311'
JMD.

#12 - 15°
193'

#13 - 20° (1100)

(low mineralized sections (JMD))

#14 - 40° (1203')
2300

#20 - 20°

30'-ind
Main
dyke (ex)
JMD

0-550' core
0.734% Cu
0.017% MoS₂

#19 - 20°

370-870 (500) core @ 0.622% Cu 0.013% MoS₂
in 2D/JMD

0-800' core @
0.662% Cu
0.017% MoS₂

0-800' core @ 0.583% Cu 0.015% MoS₂

0-600' core @
0.80% Cu
0.015% MoS₂

#18 - 55° (1178')
2200

0-200' core 1.01% Cu

#16 - 15°
1247'

007277

Catfau
N. sheet

(overlay S. sheet)

Catfau (N. sheet)

To summit
175'