

Open Cut 80E  
Elev. 1489'

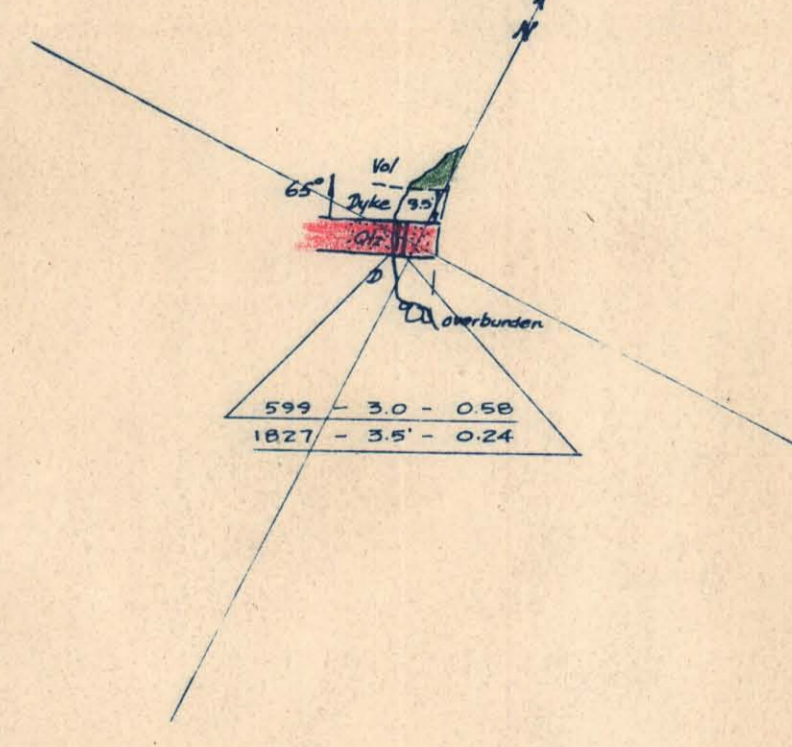

Open Cut 250E (Edmar)  
Elev. 1427'

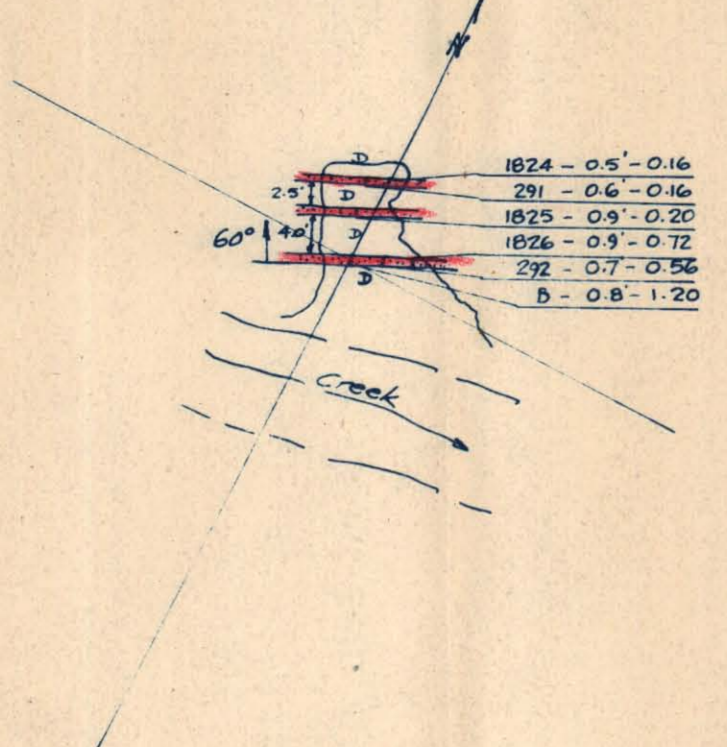

Open Cut 300E  
Elev. 1430'

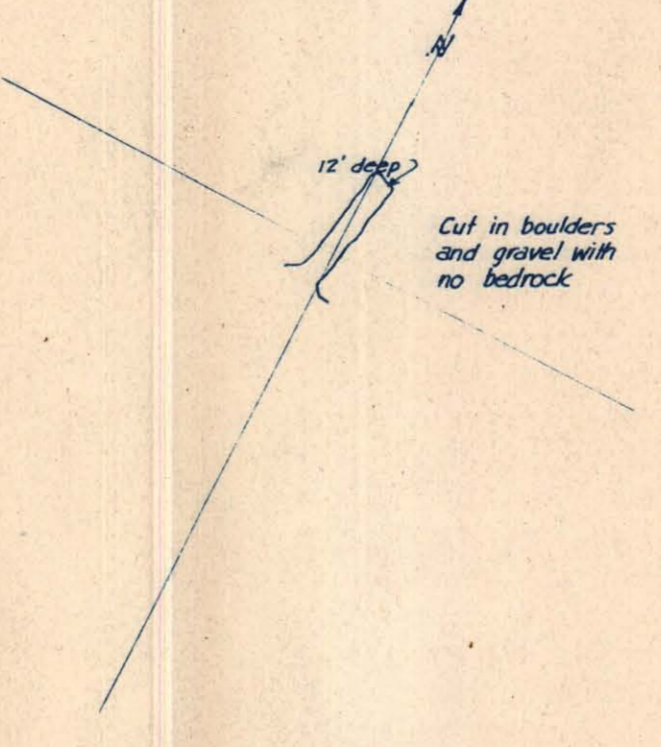

Open Cut 460E  
Elev. 1389'

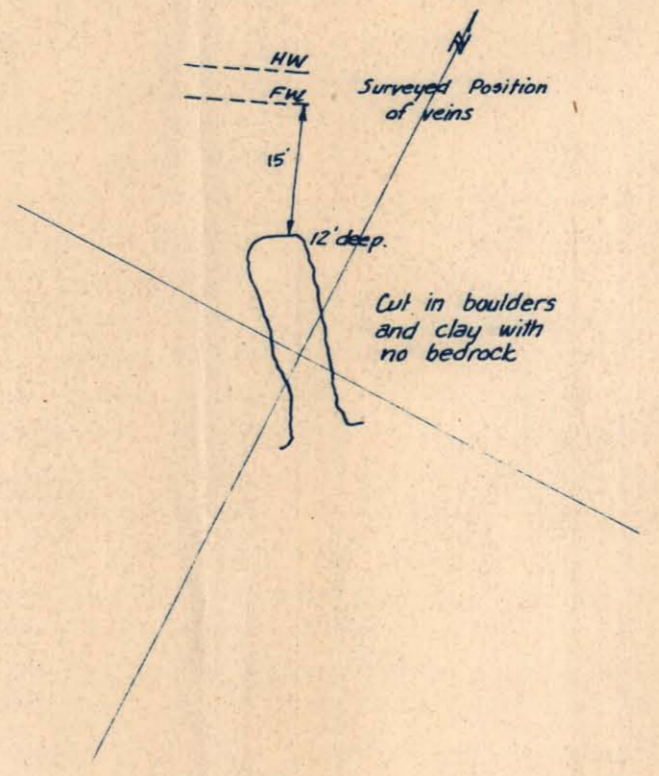

Open Cut 520E  
Elev. 1384'

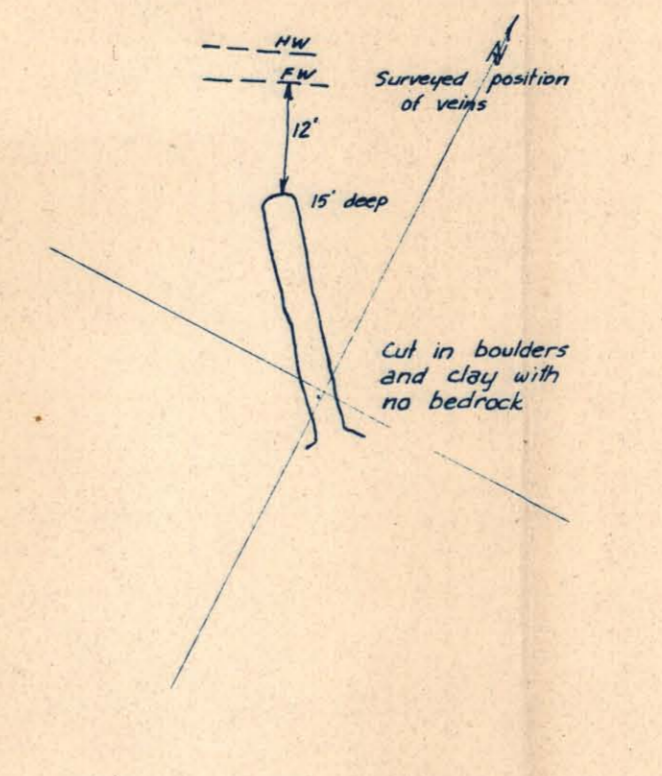

Open Cut 550E  
Elev. 1384'

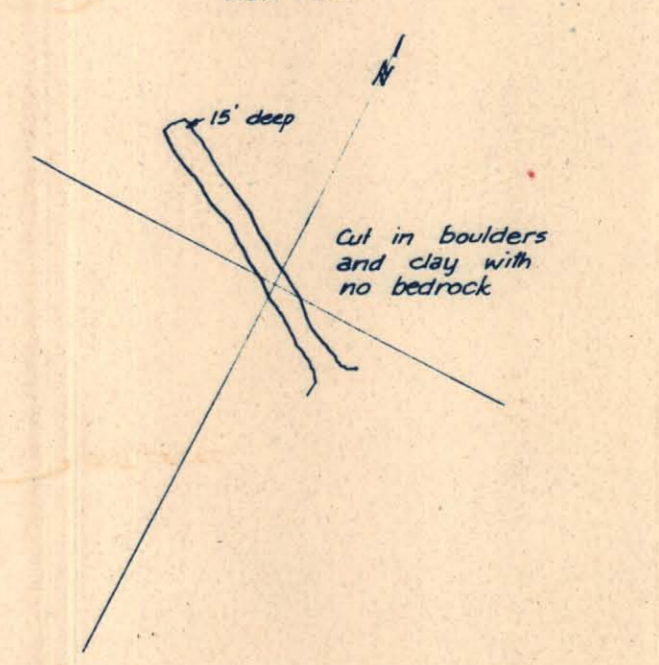

Open Cut 640E  
Elev. 1374'

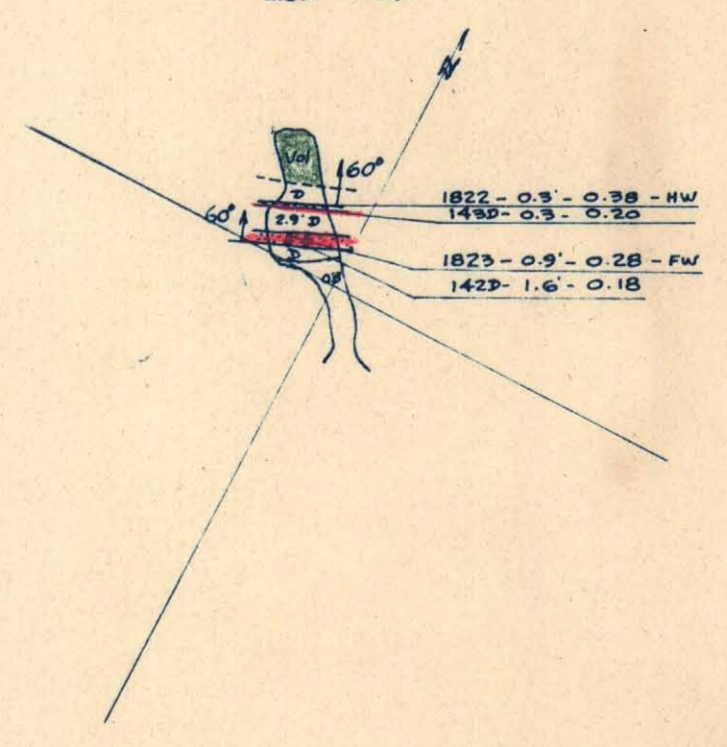

Open Cut 690E-(A)  
Elev. 1360'

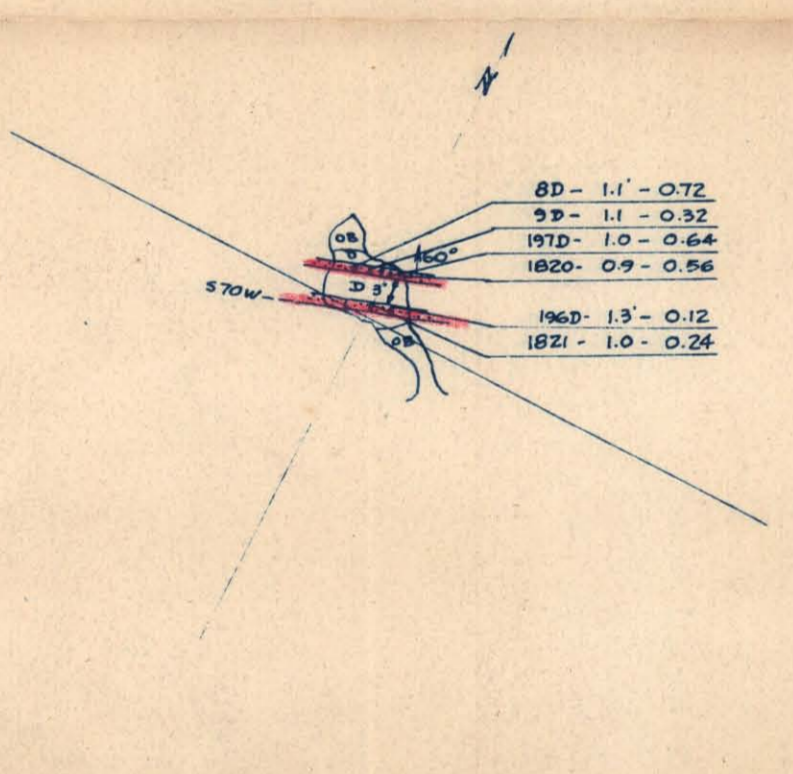

Open Cut 735E  
Elev. 1344'

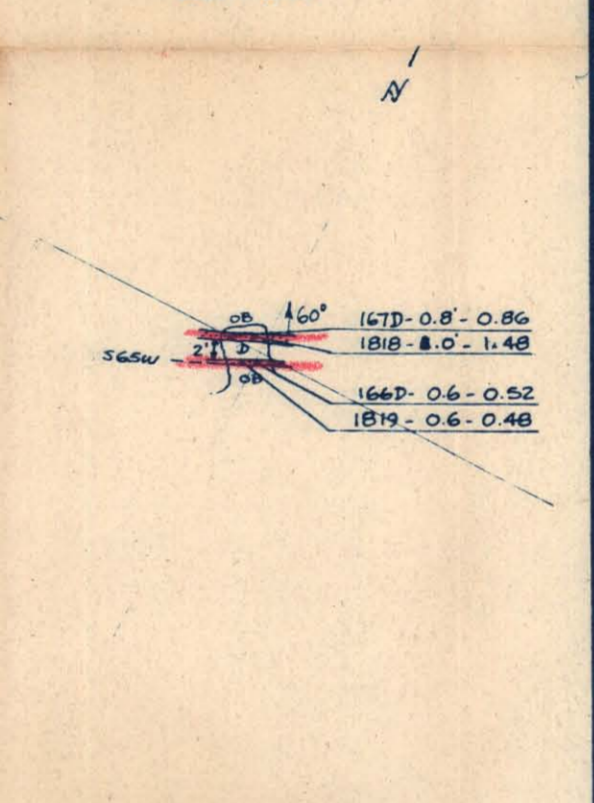

Longitudinal Projection on Open Cuts  
NUMBER "A" VEIN  
Scale: 1" = 100'

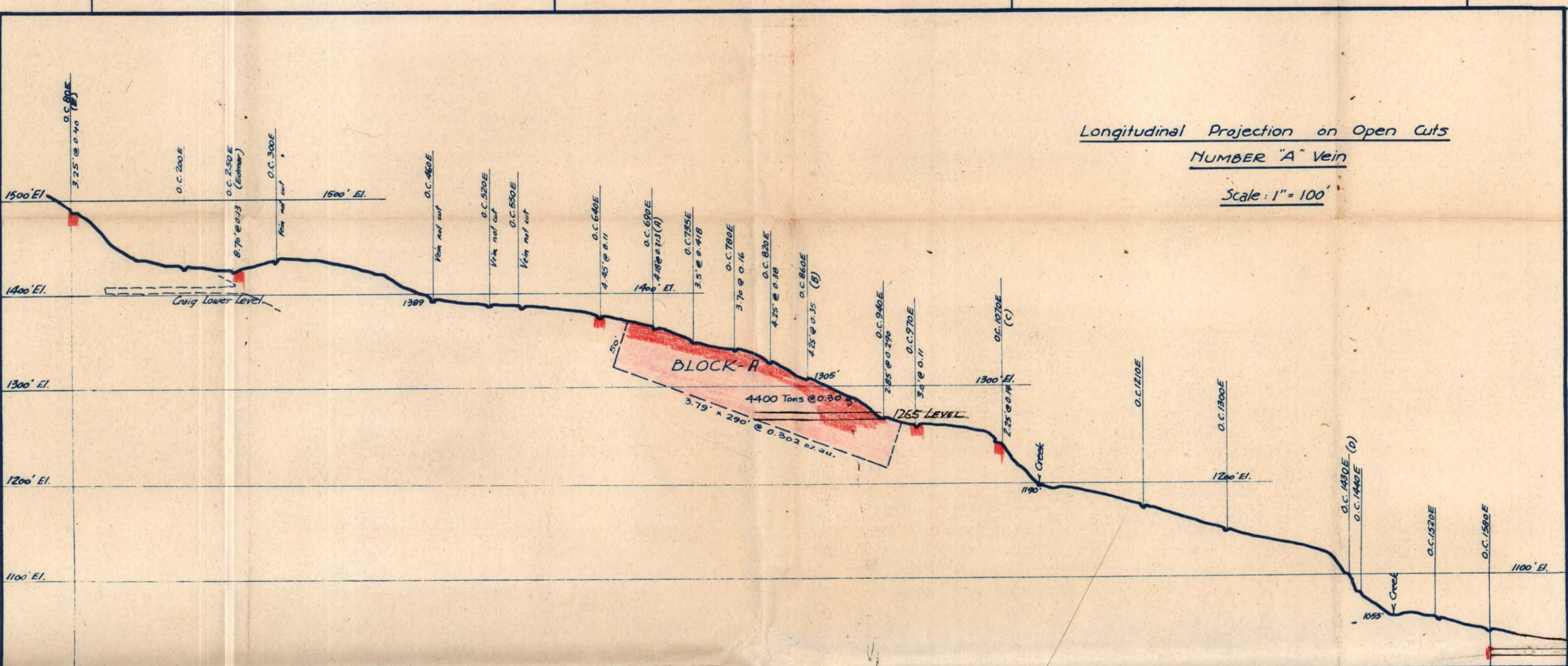

Open Cut 780E  
Elev. 1340'

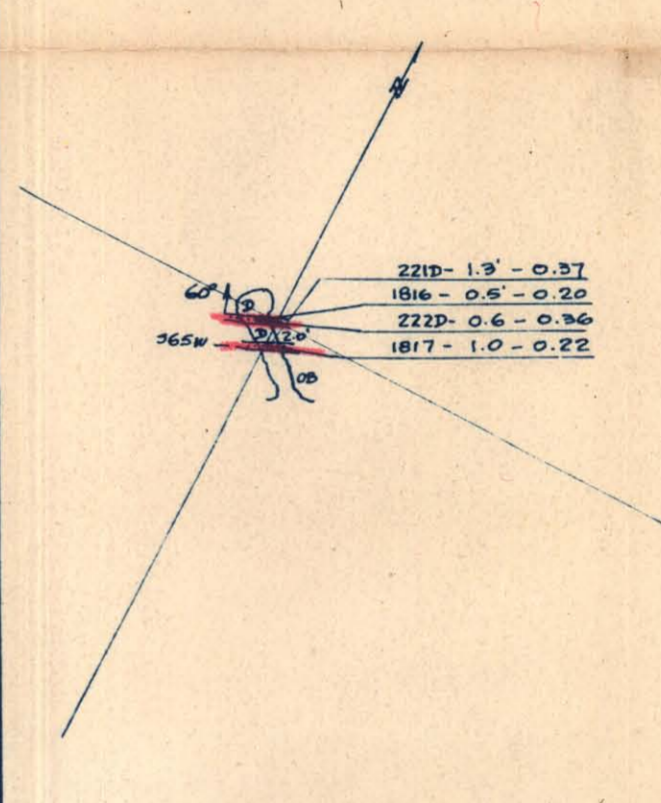

Open Cut 820E  
Elev. 1324'

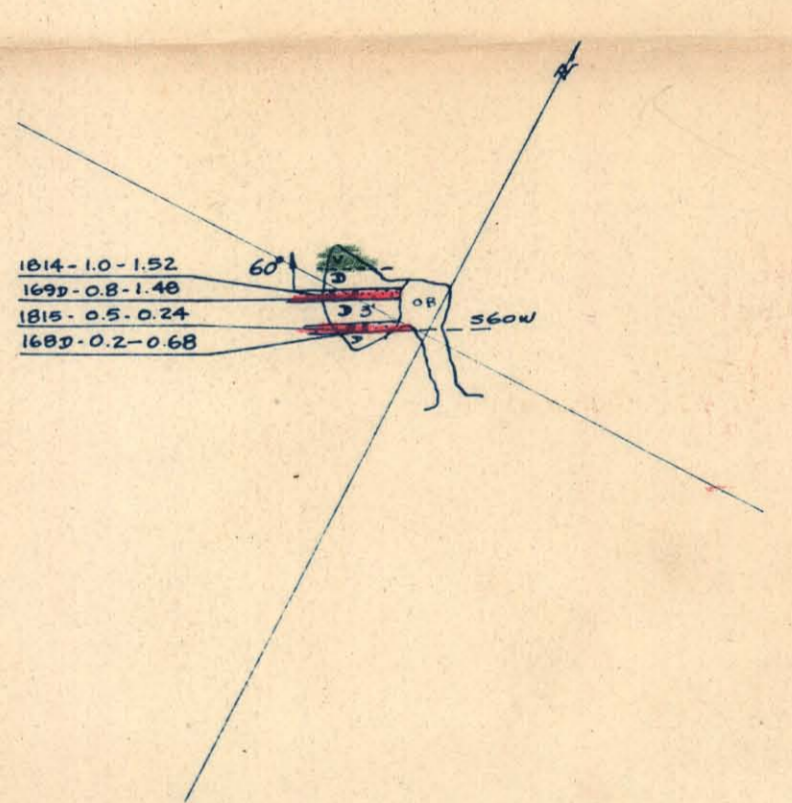

Open Cut 860E-(B)  
Elev. 1305'

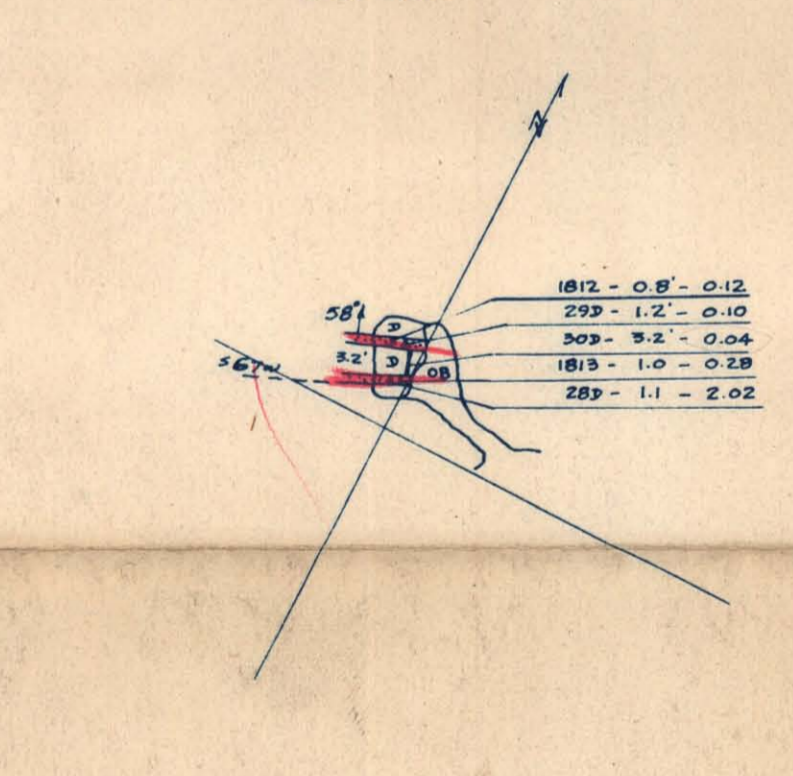

Open Cut 940E  
Elev. 1265'

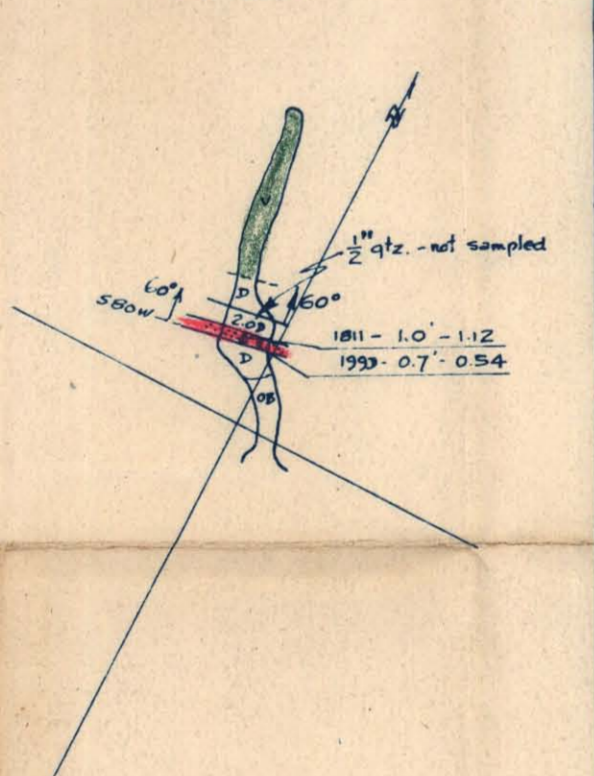

Plan of Open Cut Locations  
NUMBER "A" VEIN

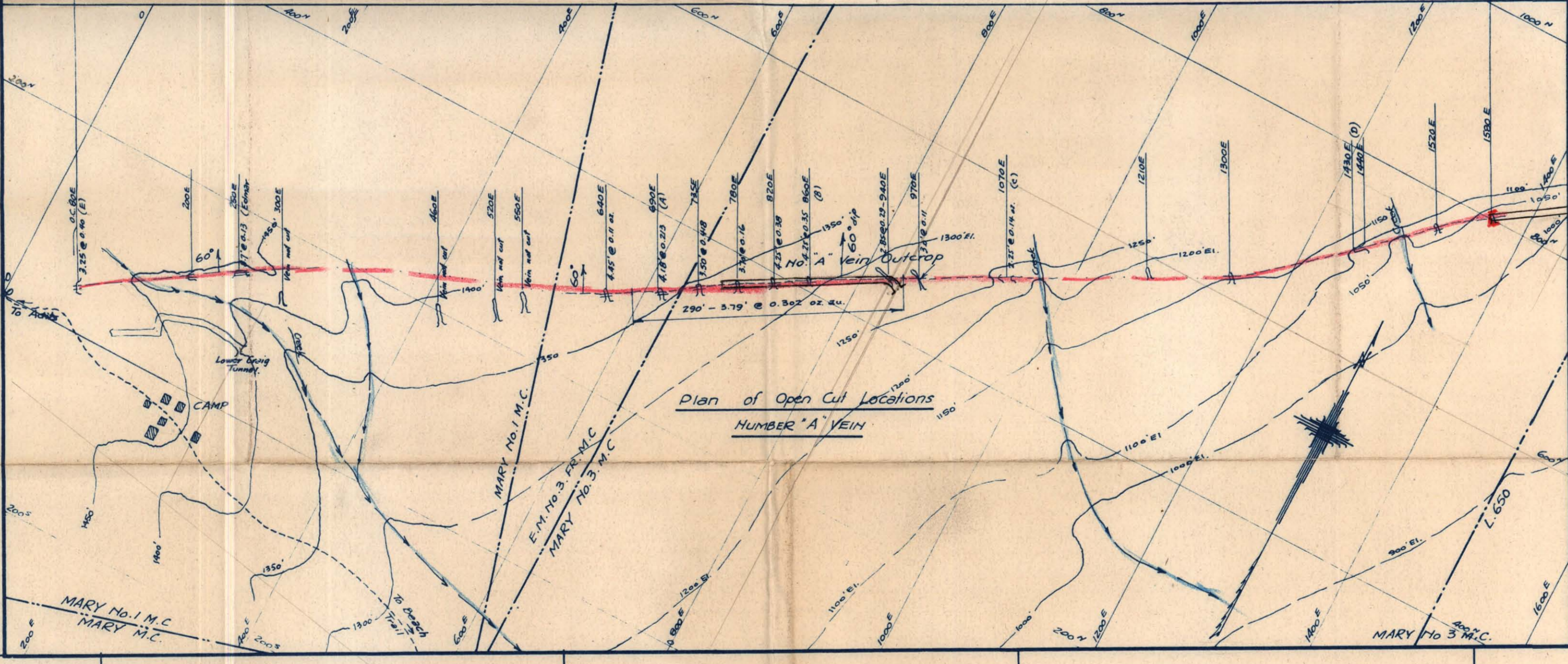

Open Cut 970E  
Elev. 1260'

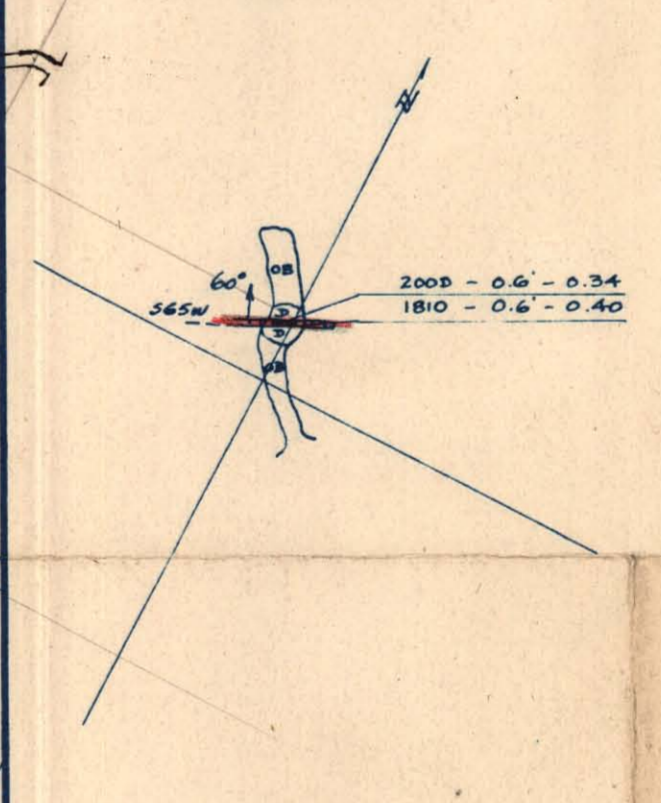

Open Cut 1070E-(C)  
Elev. 1240'

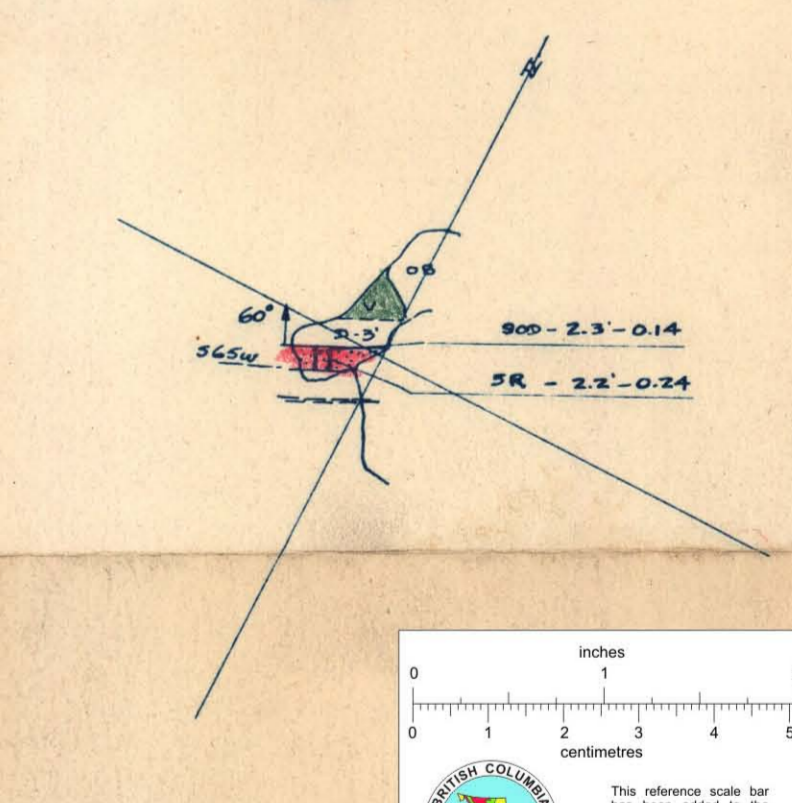

Open Cut 1070E-(C)  
Elev. 1224'

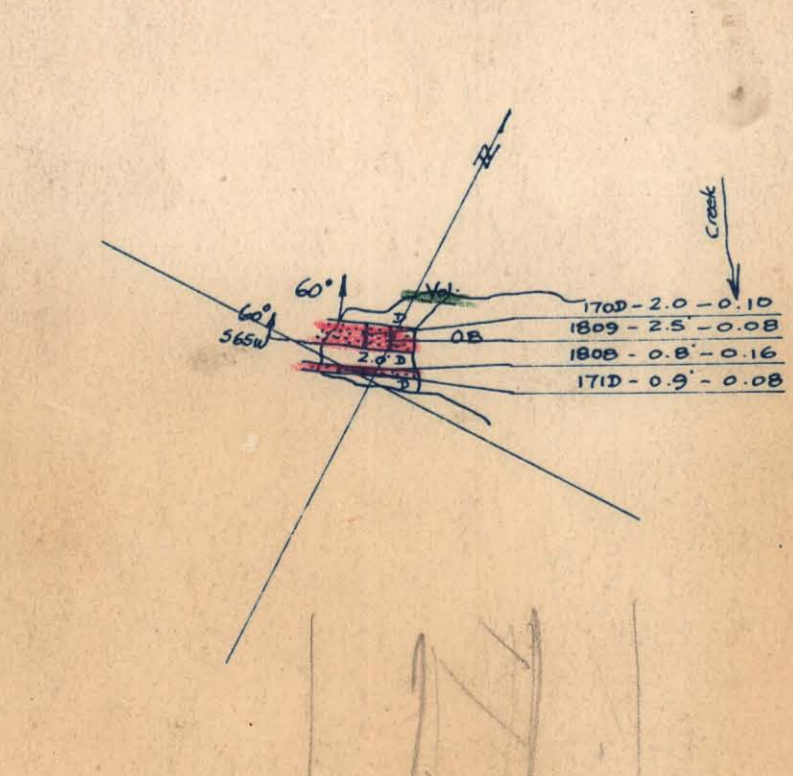

Open Cut 1210E  
Elev. 1173'

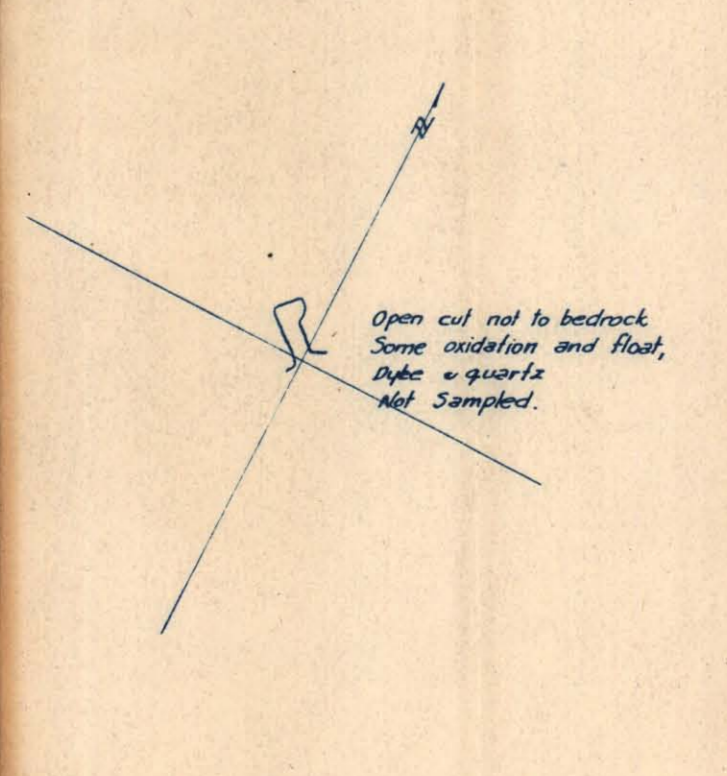

Open Cut 1300E  
Elev. 1148'

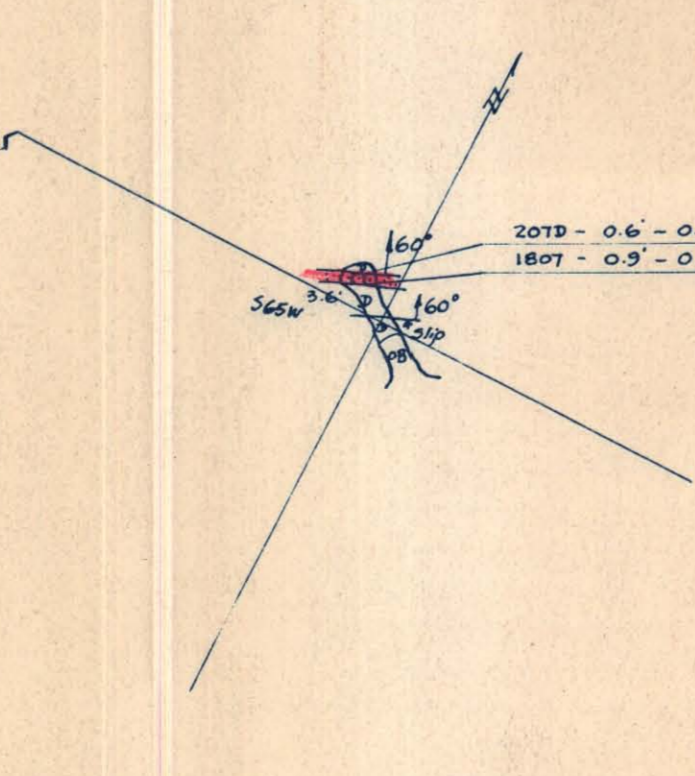

Open Cut 1430E-1440E-(D)  
Elev. 1089-1100'

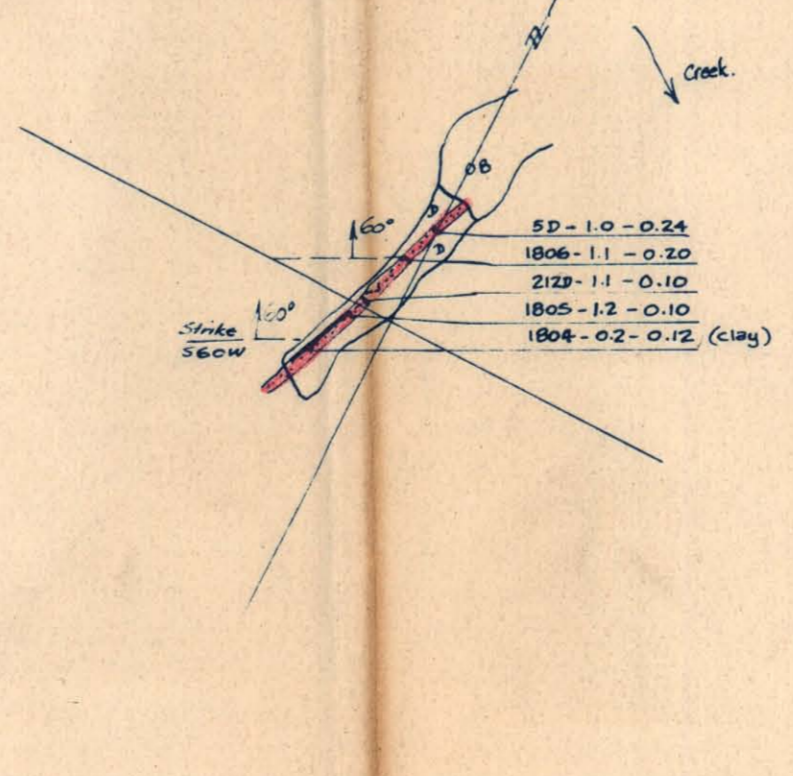

Open Cut 1520E  
Elev. 1055'

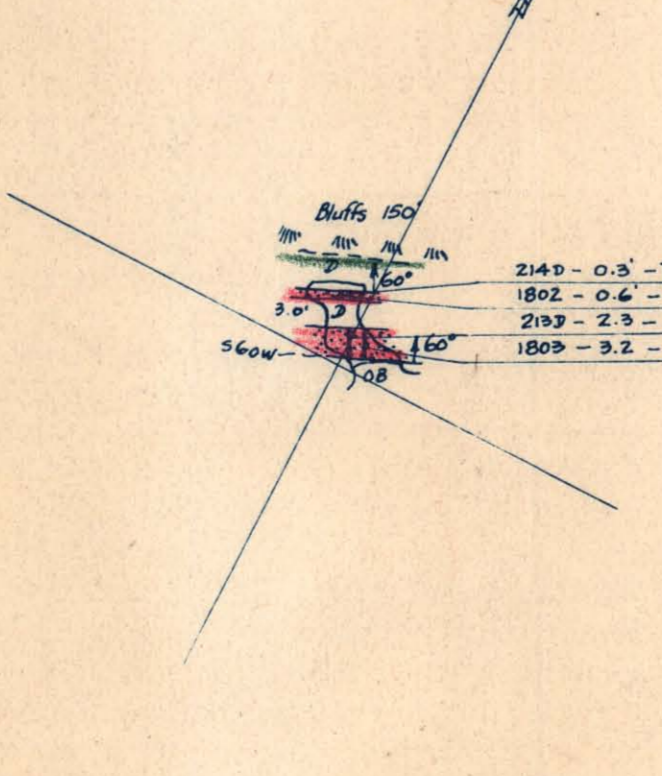

Open Cut 1580E  
Elev. 1040'

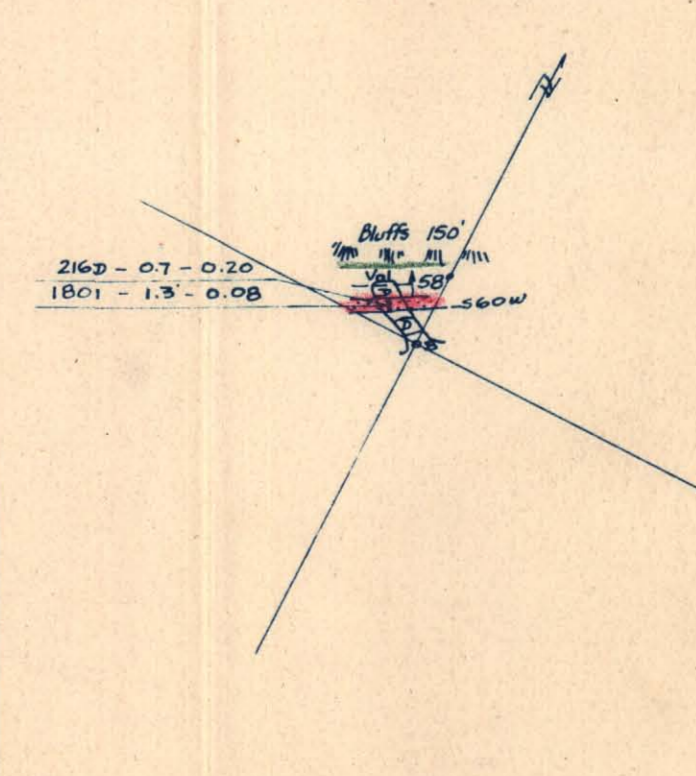

OPEN CUT ASSAY DETAIL  
NUMBER "A" VEIN

Tranquil Creek Option, Privateer Mine Ltd. N.P.L.  
West Coast, Vancouver Island, B.C.

Scales: 1" = 100'  
1" = 20'

PROPERTY FILE

Notes: Sample number - Width sampled - Oz gold per ton

1801 - 1.5' - 0.08

With report by  
A.M. Richmond  
Mining Engineer  
Vancouver, B.C.  
June, 1947

92F/4E  
92F041