

July 5, 2001

Alan R. Francis  
2292 East Island Highway  
NanOOSE Bay, B.C. V9P 9A8

Dear Alan:

Enclosed please find the following data (which I will also e-mail to you) from our field excursion to the Rock Claims on June 6, 2001:

- Photo Album (not in email due to file size limitations)
- Sample Description and analytical highlights (no significant values)
- Complete analytical report (excerpt from Acme File #101781 including standard)

The analytical results from the samples are somewhat encouraging as they show elevated (not really high) values of zinc (Zn), silver (Ag) and manganese (Mn). The most visually interesting sample, 187523, also shows elevated molybdenum (Mo), nickel (Ni) and cobalt (Co). These are all positive indicators, which along with the favourable geology, suggest that you are working in a prospective area for massive sulphide deposits, specifically with those of the Besshi type. Good luck with your prospecting efforts, and let me know if I can assist you in any way.

Regards,



Jacques Houle, P.Eng.  
Regional Geologist - Southwest B.C.  
phone (250) 751-7372  
fax (250) 751-7373  
Jacques.Houle@gems9.gov.bc.ca

---

THE GOVERNMENT OF BRITISH COLUMBIA IS AN "EMPLOYMENT EQUITY EMPLOYER"

---

**Ministry of  
Energy and Mines**

Southwest Regional Office  
Mines Branch  
Energy and Minerals Division

Mailing Address:  
2080B Labieux Road  
Nanaimo BC V9T 6J9

Telephone: (250) 751-7240  
or (604) 660-9363  
Facsimile: (250) 751-7373



Rock Claims - Road B22 North - near sample #187521  
old unreclaimed trenches - June 6, 2001 - J. Houle



Rock Claims - Road B24 North - Alan Francis at Jasper  
occurrence - Sample# 187522 - June 6, 2001 - J. Houle



Rock Claims - Travertine Marble occurrence -Road B18S  
Sample# 187524 - June 6, 2001 - J. Houle



Rock 7 Claim - Quartz-Sericite-Pyrite Schist occurrence  
Sample# 187525 - June 6, 2001 - J. Houle

PROPERTY FILE



Rock Claims - Road B22 North - Quartz-Sericite-Pyrite  
Schist site of Sample# 187521 - June 6, 2001 - J. Houle



Rock Claims - Jasper fragments in schist - June 6, 2001  
J. Houle

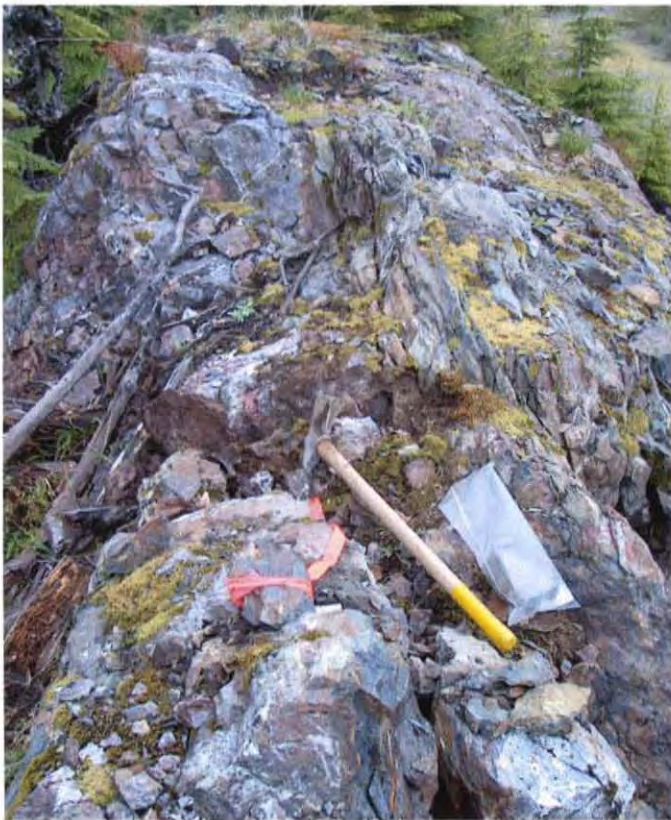

Rock Claims - Qtz-Magnetite-Chlorite-Pyrite Stockwork  
Road B26A - Sample# 187523 - June 6, 2001 - J. Houle



Rock Claims - Al Francis - Travertine Marble occurrence  
Road B18 S. - Sample# 187524 - June 6, 2001 - J. Houle

PROPERTY FILE

JAN 6/87 CANAMIN RESOURCES LTD. (CA-V) <sup>92C 144</sup> GCNL 3

INTERESTING GOLD MINERALS - E. Specogna, president,  
OUTLINED NEAR DUNCAN, B.C reports that prospecting on  
<sup>92C/16E</sup> the Sognidoro claim of  
Canamin Resources Ltd. at Rheinhart Lake in the Sicker  
mineral belt northwest of Duncan on Vancouver Island,  
B.C., has outlined extensive and widespread gold miner-  
alization. Assays of samples taken range in value be-  
tween 1.5 and 5.0 grams per tonne, being 0.04375 and  
0.1458 oz.per ton, respectively. At the epicenter, the  
mineralization is exposed for a width of 300 feet with a  
linear extent of more than 6,000 feet. Lesser mineral-  
ization is exposed in road cuts for several miles to the  
southeast. Boulder floats have been noted so far as  
Canamin's Poly claim. Boulders were also observed on  
the Cow 10 claim which International Cherokee and Vanwin  
are currently exploring.

Unlike Canamin's Villalta property, where younger  
mineralized rock overlies the gold bearing oxides, on  
the Sognidoro the gold mineralization is overlain by  
glacial till. It is believed to be near a major fault  
and to be spatially related to a lineal vent. Other  
known mineralization on the Sognidoro comprises low  
grade gold bearing primary pyrites and a high grade gold  
bearing quartz vein.

Mr. Specogna says several parties are interested in  
joint ventures or flow-through financing on the  
Sognidoro and other Canamin properties.

AR 935

092.R 144

NORTH

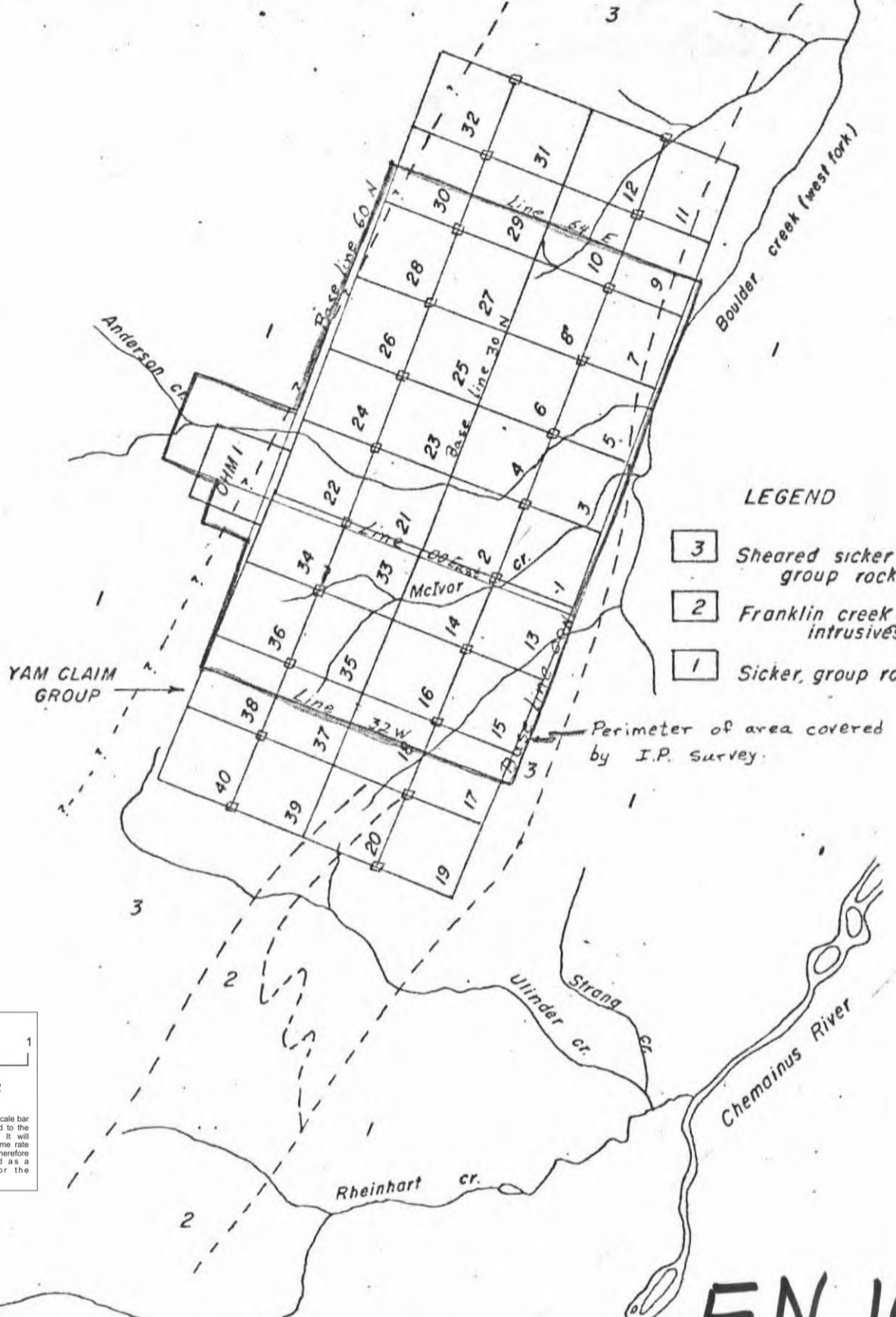

LEGEND

- 3 Sheared sicker group rocks.
- 2 Franklin creek intrusives.
- 1 Sicker, group rocks.

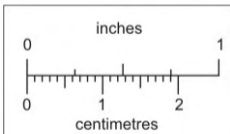

This reference scale bar has been added to the original image. It will scale at the same rate as the image, therefore it can be used as a reference for the original size.

To accompany Geophysical Report on Induced Polarization Survey, Yam-ohm claim Group, Victoria M.D. by G.D. Tikkanen, M.A.Sc., P. Eng. dated October 14<sup>th</sup>, 1965. Ac de Voogd, P. Eng.

EN. 102  
MAP 1.

The Consolidated Mining and Smelting Company of Canada Limited

DRAWN BY: <u>092.R</u>		TRACED BY:	
REVISED BY:	DATE:	REVISED BY:	DATE:

GENERAL GEOLOGY  
YAM CLAIM GROUP

SCALE: 1" = 1/2 mi.

DATE: JAN. 11, 1967

PLATE: 1